

P-38E Lightning

scale 1/72



92141

RS
MODELS

First major production version for the USAAF was the P-38E. It differed from the D-version in having a 37mm cannon with the 15round magazine replaced by a 20mm with 150 rounds. It also had a revised nose section with double the ammunition capacity of earlier versions, improved instrumentation and a revised hydraulic and electric systems, and a SCR-274N radio. Operating in the Aleutians, the 54FS was the first unit to see combat in the Lightning, and the first kills scored by the P-38 were made by pilots in this unit.

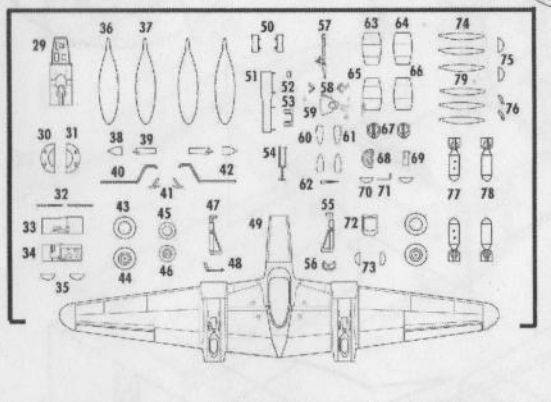
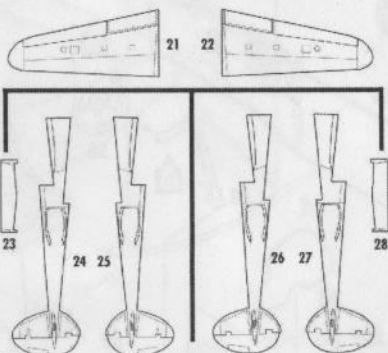
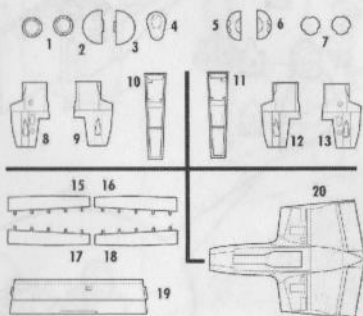

CLEAR PART (C)

RESIN PARTS



COLORS

a Čierna Black	h Červená Red
b Interier, žltá Zinc Chromate White	i Biela White
c Srebrná Silver	j Žltá Yellow
d Plnina Linon	k Pneumaticky Tyres Black
e Koža Leather	l Rezavá Rust
f Hliníková Aluminium	m Temná Seda Dark Grey
g Chromová Chrome	n Kovová Gun metal

LEGEND



ohnout bend

vitrinové lepidlo cyanacrylate glue

odstranit remove

upravit reduce

vrtat open hole

vyrobiť scratch build

obstisk decal

barva color

film

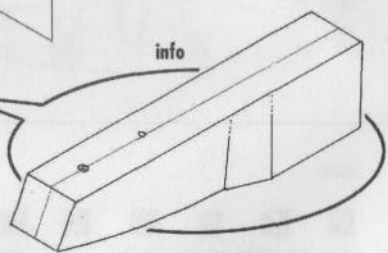
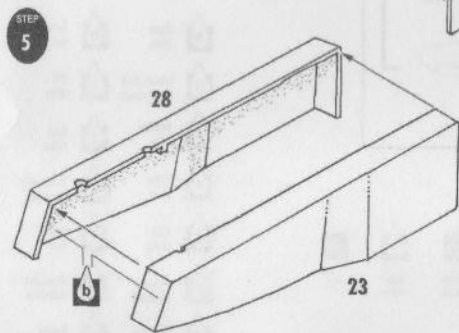
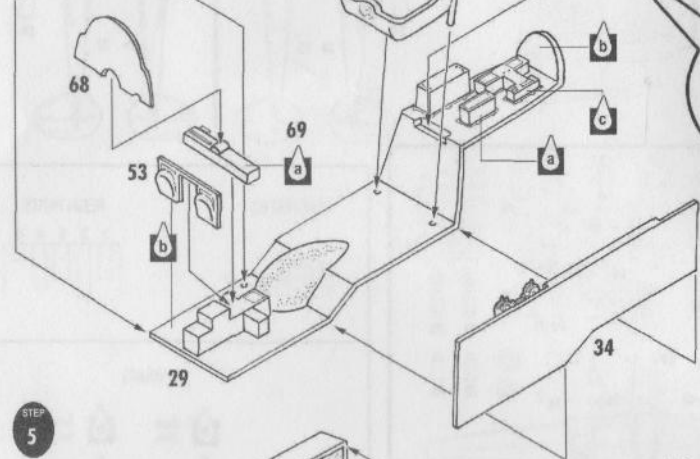
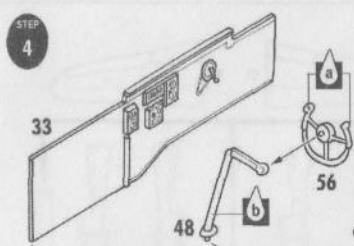
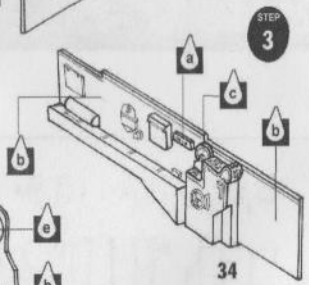
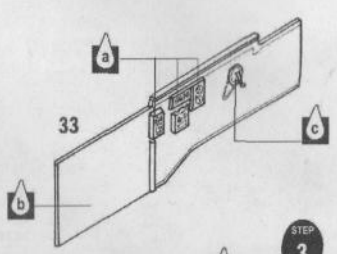
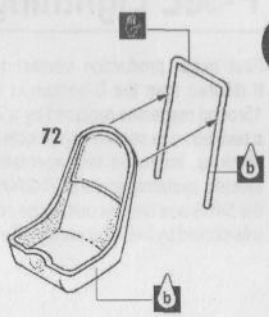
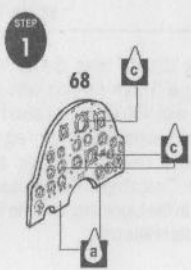

STEP 6

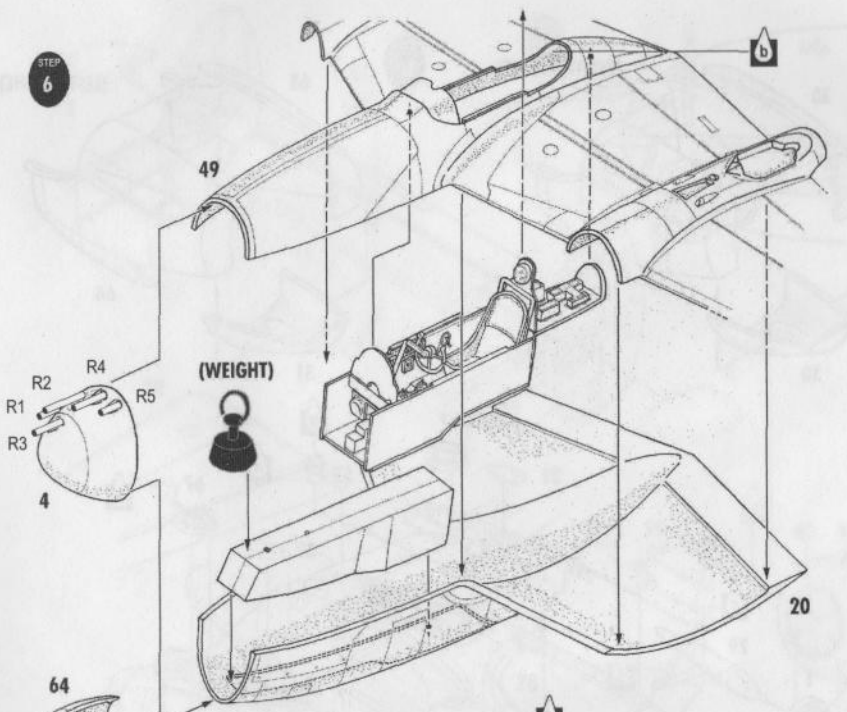

(LEFT TAIL STRUCTURE)

STEP 8

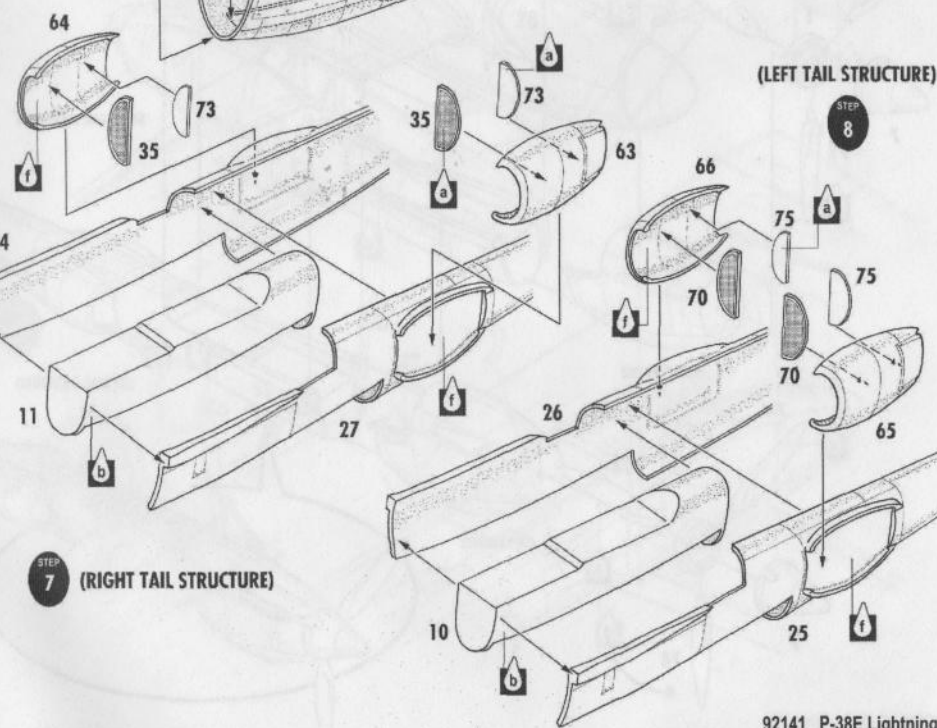

STEP 7

(RIGHT TAIL STRUCTURE)

STEP 9

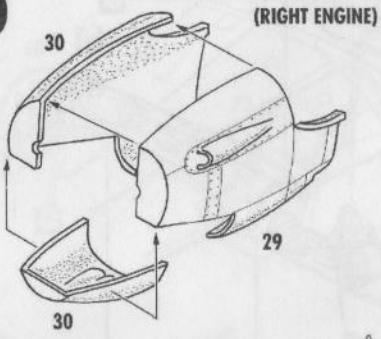

STEP 10

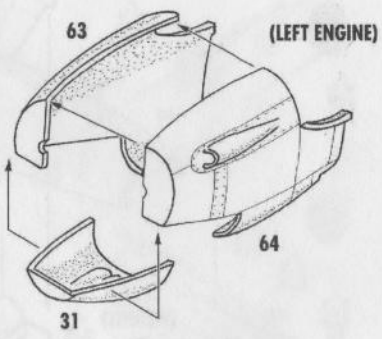

STEP 11

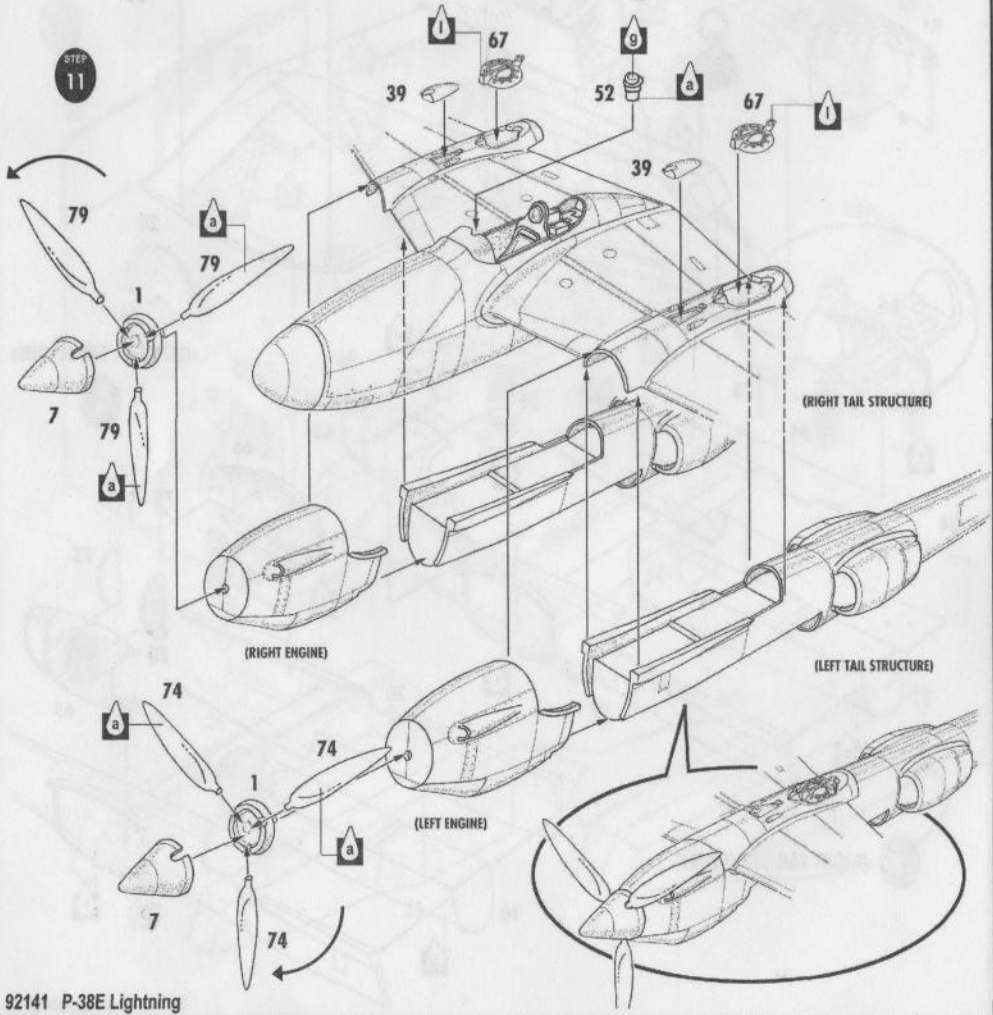

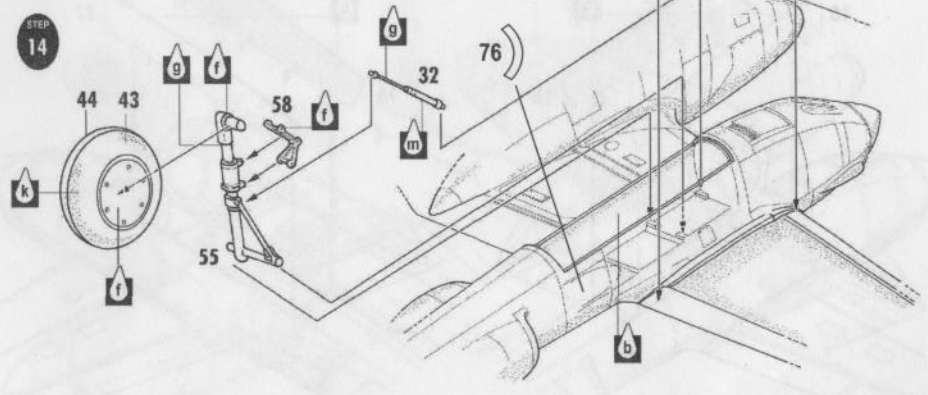
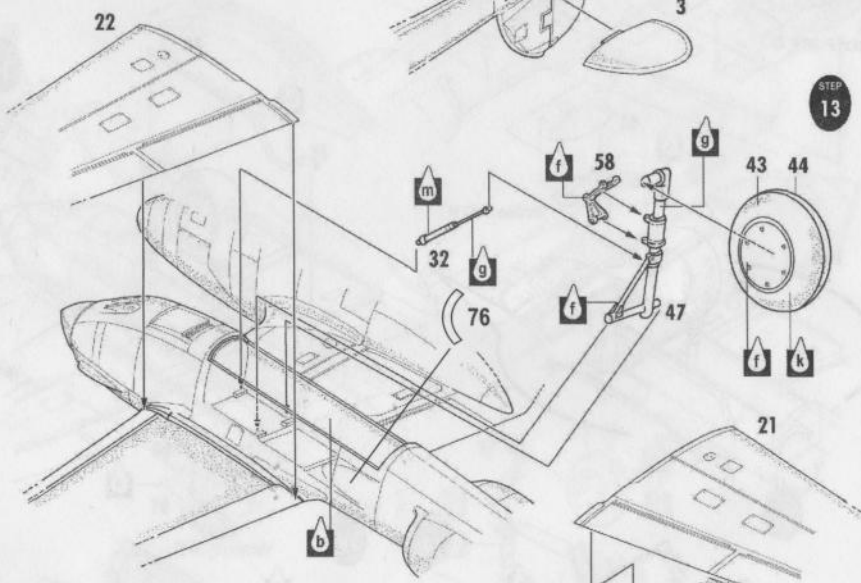
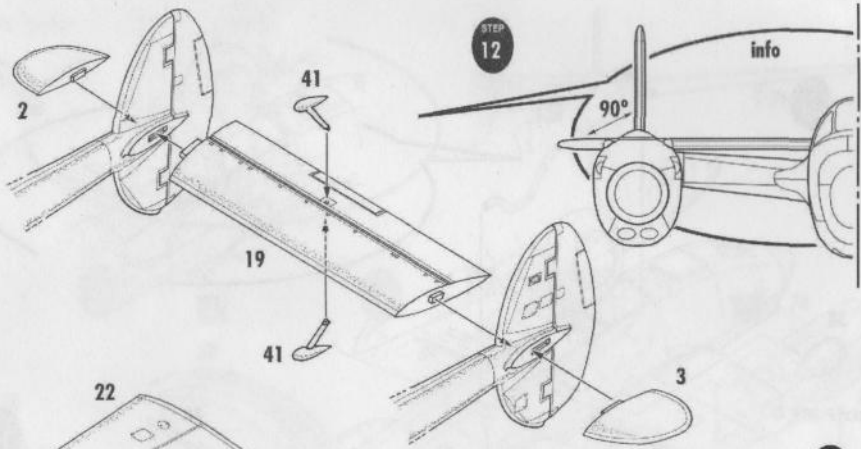

STEP
15

40

b

info

38

Version P-38 F, G

61

a

60

Version P-38 H

info

42

STEP
16

b

38

Version P-38 F, G

60

61

a

Version P-38 H

STEP
17

STEP
18

15

b

16

18

b

17

92141 P-38E Lightning

Drop tanks position

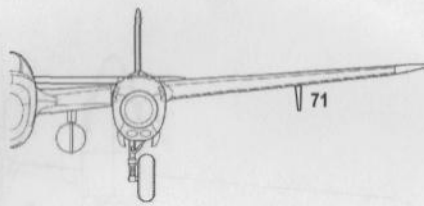
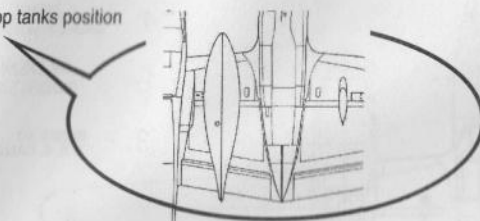

STEP 19

STEP 20

STEP 21

STEP 22

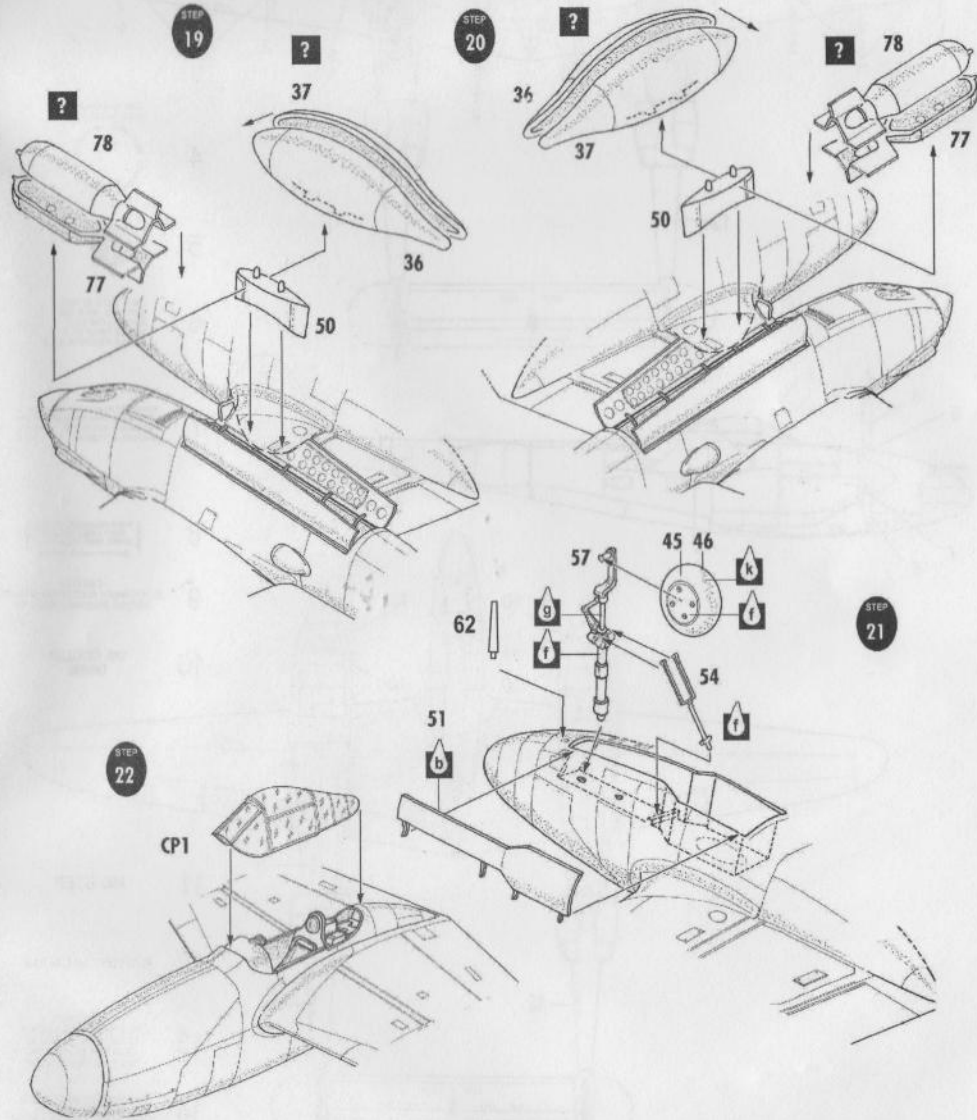

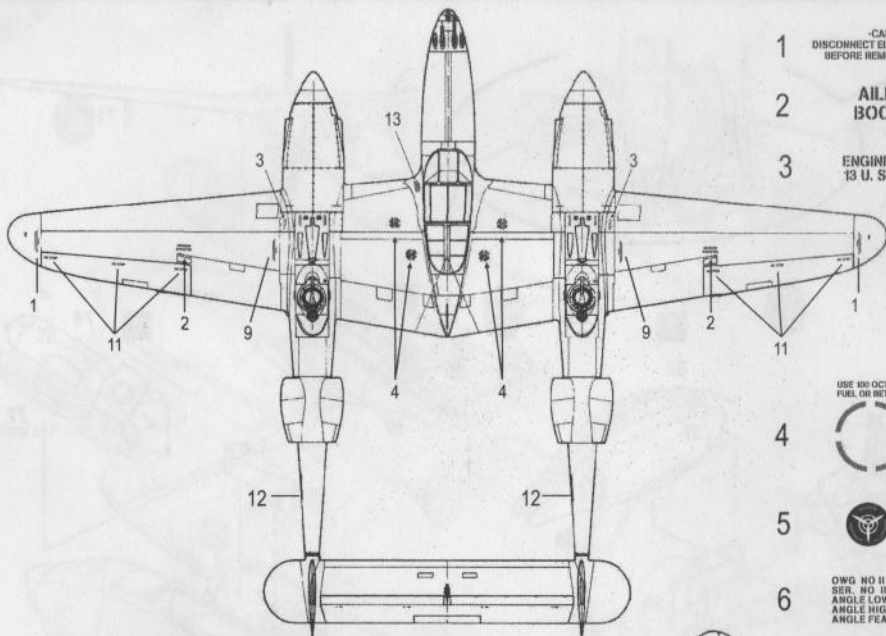

1 -CAUTION-
DISCONNECT ELECTRICAL WIRING
BEFORE REMOVING WING TIP

2 AILERON
BOOSTER

3 ENGINE OIL
13 U. S. GALLONS

USE 80 OCTANE
FUEL OR BETTER



6 OWG NO II III IIII
SER. NO IIII II IIII
ANGLE LOW 23.0
ANGLE HIGH 57.7
ANGLE FLAUGHTER 87.5

7 FURTHEST FORWARD LOAD 148.15
GROSS WT. WHEELS DOWN 131.88
CROSS WT. WHEELS UP 154.71
FURTHER AFT LOAD 116.11

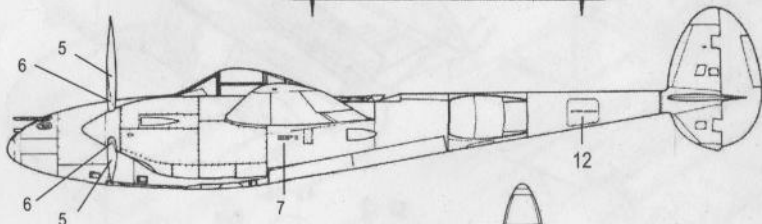

8
WHEN REMOVING BATTERY
CARRY CABLE BY HAND
CARBLS MUST CLEAR HERE

9 -CAUTION-
DISCONNECT ELECTRICAL WIRING
BEFORE REMOVING WING TIP

10 OIL COOLER
DRAIN

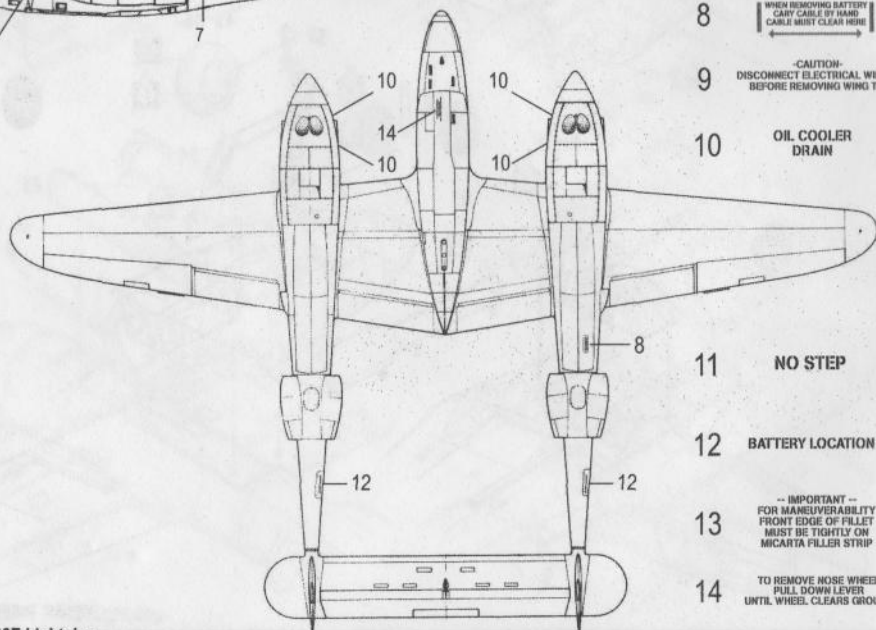

11 NO STEP

12 BATTERY LOCATION

13 - IMPORTANT -
FOR MANEUVERABILITY
FRONT EDGE OF FILLET
MUST BE TIGHTLY ON
MICA/TA FILLER STRIP

14 TO REMOVE NOSE WHEEL
PULL DOWN LEVER
UNTIL WHEEL CLEARS GROUND