

GERMAN HALF-TRACK

sd. kfz. 250/3 8027

1/72 SCALE



KIT 8027

SPECIFICATION

GENERAL

CREW: 6; COMMANDER AND DRIVER, 4 MEN.

BATTLE WEIGHT: 5.7 TONS.

DIMENSIONS

LENGTH OVERALL: 15 FT

HEIGHT: 5 FT

WIDTH: 6 FT 4 1/2 IN.

TRACK CENTRES / WHEEL BASE: 5 FT 3 1/2 IN. / 5 FT 2 IN.

TRACK WIDTH: 8 IN.

ENGINE

MAYBACK HL 42 TUKRM OR TUKRRM PETROL, 6 CYLINDERS IN LINE, 4171 CC. 100 B.H.P AT 2,800 R.P.M.

FUEL: 31 GALLONS IN TANK ON REAR RIGHT HAND SIDE OF FIGHTING COMPARTMENT

ARMOUR

HOMOGENEOUS WELDED AND RIVETED ARMOUR PLATE.

HULL: 14.5 MM. AT 12°

GLACIS: 10 MM. AT 83°

SIDES: 8 MM. AT 40° UPPER, AND 28° LOWER.

REAR: 8 MM. AT 23°

FLOOR: 6 MM. HORIZONTAL.

ARMAMENT: TWO 7.92 MM. MG34.

SPECIAL EQUIPMENT: FU 7 - FU 8 RADIO SETS FOR AIR TO GROUND COMMUNICATIONS.

PERFORMANCE

MAXIMUM ROAD SPEED: 37 M.P.H.

MAXIMUM GRADIENT: 24°

WADING DEPTH: 2 FT 4 IN.

RANGE: 186 MILES ON ROADS; 109 MILES CROSS-COUNTRY



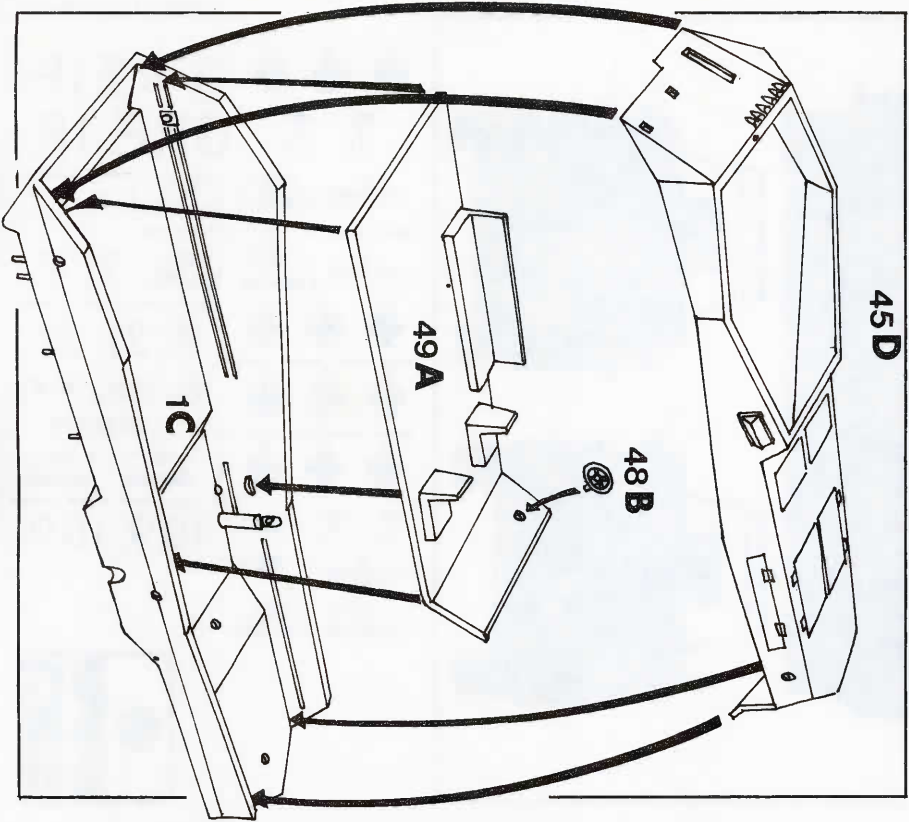
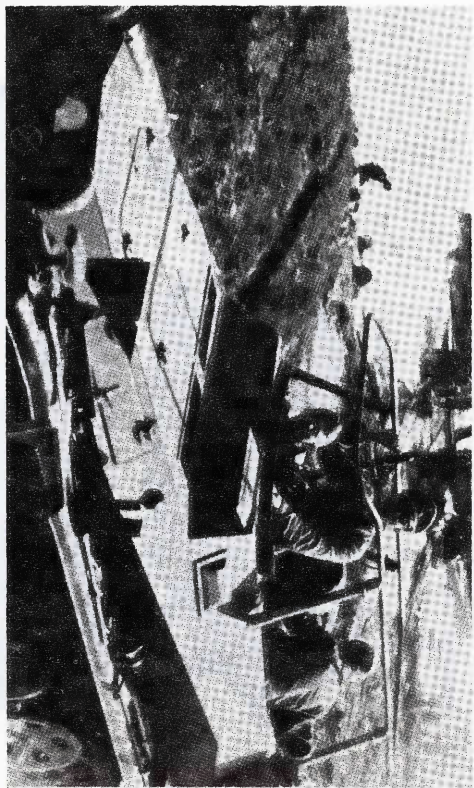
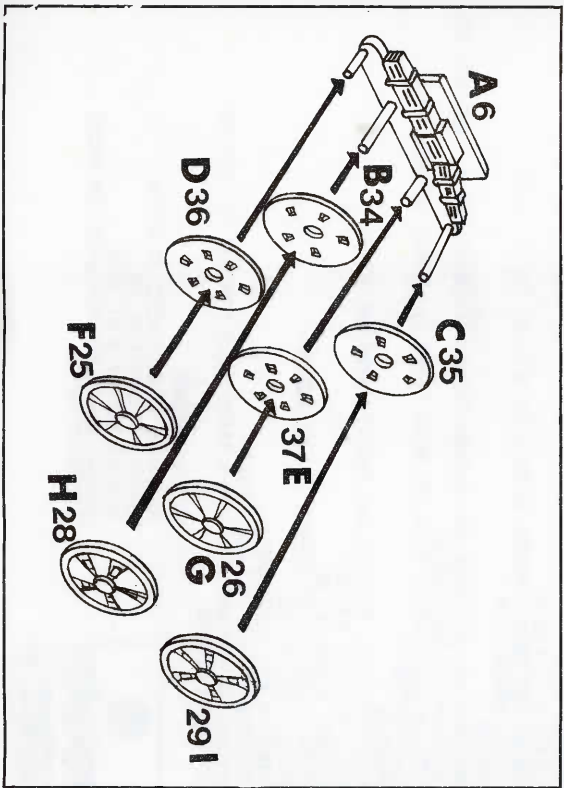
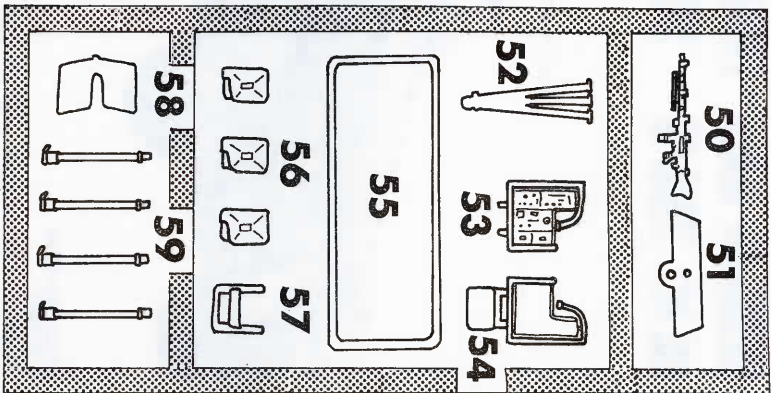
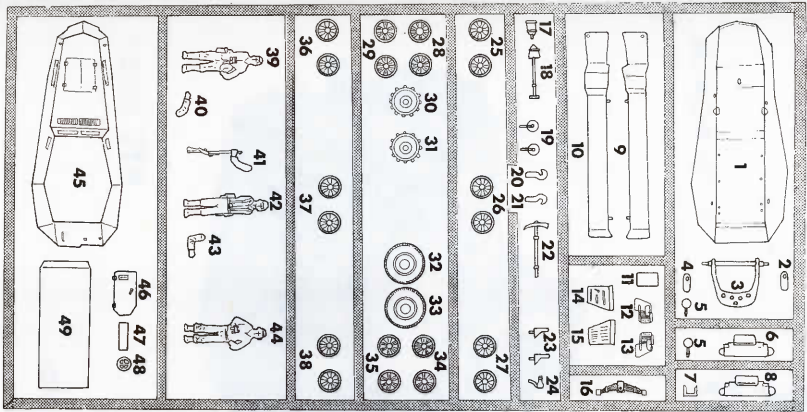

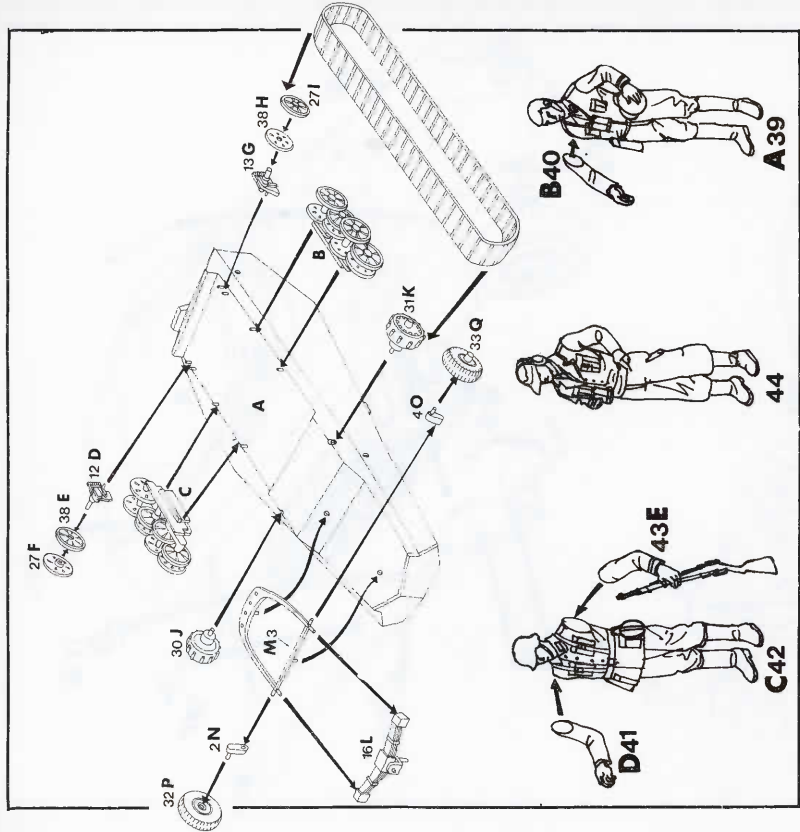



109 109 F

685 050 WH 685 050 WH

WH 685 050 B

XXD XXD

21 F 21 F

683 309 WH 683 309 WH

937 835 WH 937 835 WH

G REIF G

G REIF G

MADE IN ITALY

443 026 WH 443 026 WH

WH 433 026 B

D D

E E

+

+

+

+

+

+

+

+

+

+

+

+

+

+

+

+

+

+

+

+

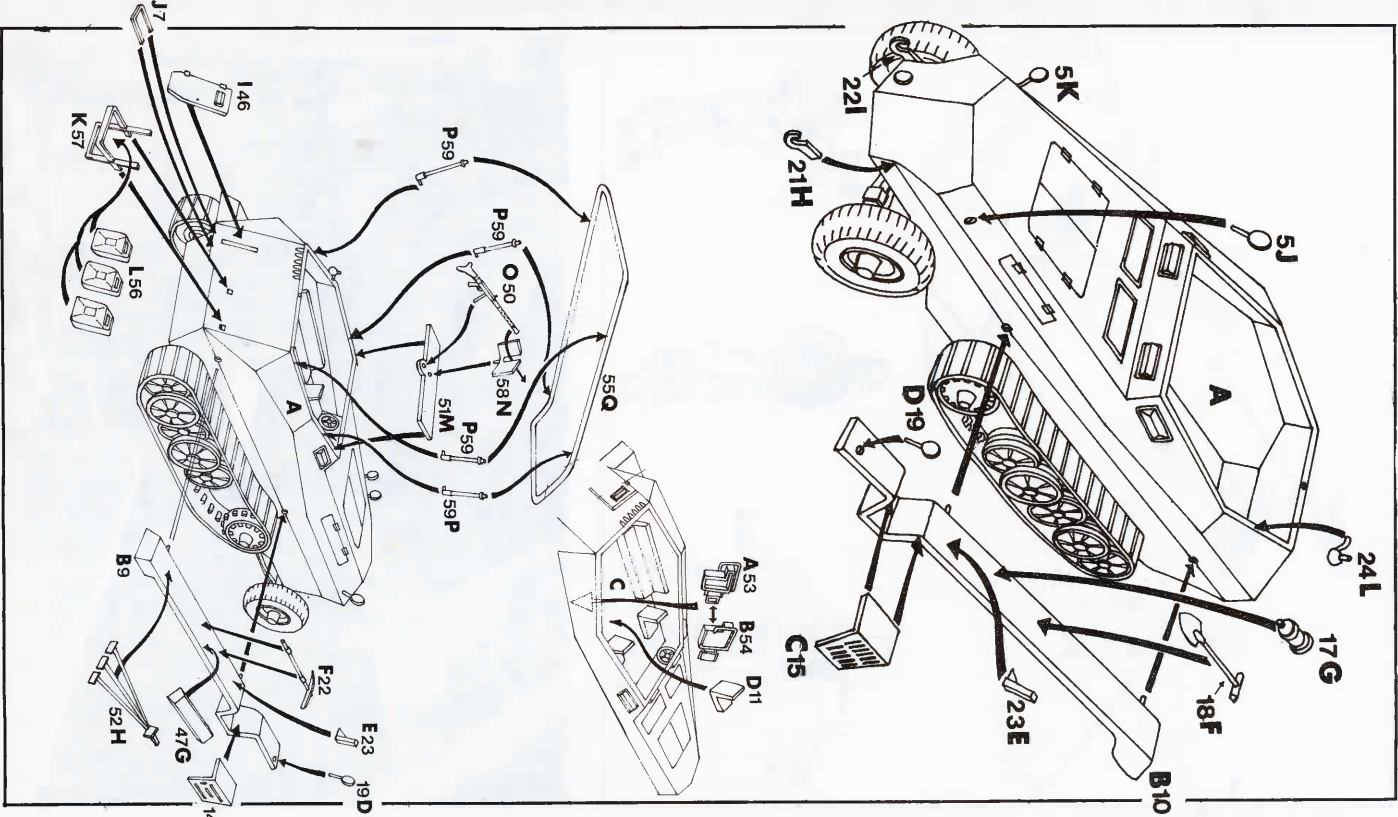
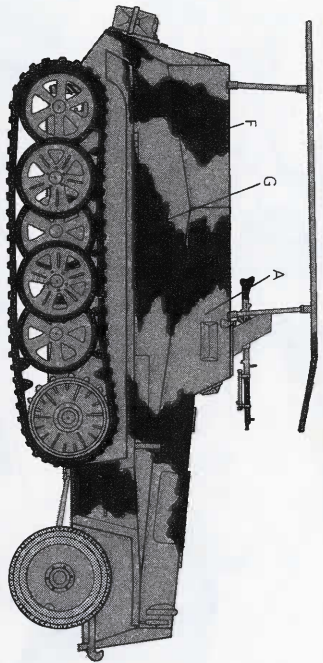
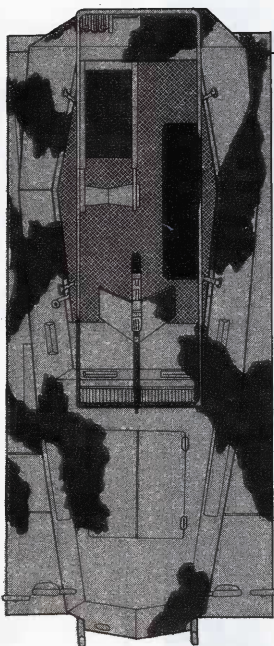
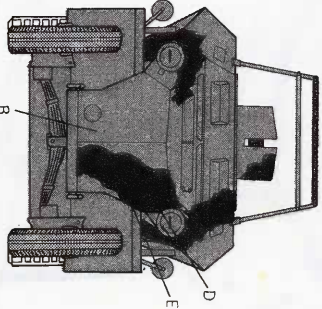
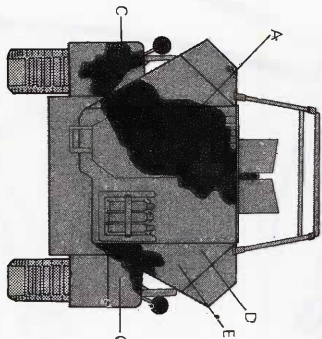

MADE IN ITALY