

PN137 N scale COUNTRY STATION

CHECK LIST

This kit should contain the following:

- 1 x SHEET A. Printed with building parts.
- 1 x SHEET B. Printed with roof parts.
- 1 x SHEET C. Laser cut window and door frames.
- 1 x SHEET D. Laser cut canopy and window sills.
- 1 x Plain grey card with inner strengtheners.
- 1 x GLAZING sheet.
- 1 x Ridge tiles card.
- 2 x INSTRUCTION SHEETS.

READ THROUGH ALL THE INSTRUCTIONS BEFORE YOU START

This is a complex kit that requires particular attention to detail, so proceed with care!

To construct this kit you will need the following:

1. A modellers knife. and a pair of sharp scissors.
2. A steel ruler.
3. Glue - *See glues below.*
4. Ultra Fine Tip Glue Applicator, *see below.*
5. A cutting surface - a sheet of card or cutting mat.
6. Fine point tweezers to hold smaller components.
7. Water colour paints and a very fine brush for painting edges and corners.

METCALFE

Ultra Fine Tip Glue Bottles

These bottles are essential for gluing the smaller components in this kit.

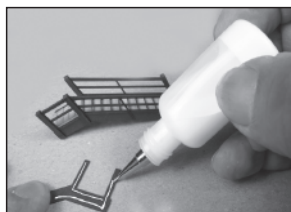

Tiny strips or spots of glue can be accurately laid down with precision.



Always replace the pin after use and store the bottles upside down to keep the glue moist.

GLUES

UHU Solvent Free All Purpose Adhesive Glue Works superbly well in our fine glue applicators. Dries quickly, but allows time for positioning of kit parts as described further on in the instructions.

Also Deluxe Materials 'SPEEDBOND' A fast drying PVA. see www.deluxematerials.com

PLEASE NOTE:

It is VERY important that you follow these instructions in the order shown. There are a lot of tiny components that are easily lost, so only extract them from the base sheets as instructed.

© Copyright 2016. Metcalfe Models & Toys Ltd.

INSTRUCTION SHEET 1

GETTING STARTED

1 EXTRACTING COMPONENTS FROM SHEETS.

To stop the components from falling off the sheets, they are held secure with score lines. These are cuts that only go about 75% of the way through the card.

To release them run the point of your knife along these score lines and they will come seamlessly away.

These score lines are marked with blue arrows:

WARNING, Cut with care using a knife that is not too sharp, this will reduce the risk of the blade running out of the score and cutting into the kit components.

2 MAKE YOUR 'BUILDERS YARD'

As you extract the components from the base sheets they need to be kept away from your working area on a thick piece of card or a tray until needed.

Example of builders yard.

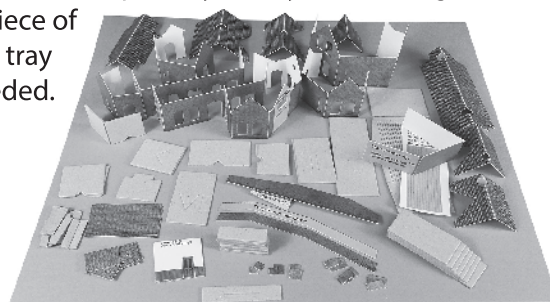

Only extract the components from the sheets as instructed.

If you cut them all out at once, you will end up in a right mess and start losing things.

So lets get started...

Fig.1. GLAZING & WINDOWS.

Start by cutting out all the clear plastic glazing parts. Place them on a piece of dark or black card so they can be seen.

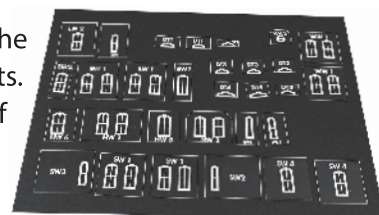

Next carefully push or cut out the laser cut window and door frames from sheet C.

Lay out like this until needed.

Located on SHEET 'A' are the 9 doors that fit behind the door frames above, cut these out as well.

Now start by fitting the doors to the matching door frames.

Test each door in the matching door frame before you glue.

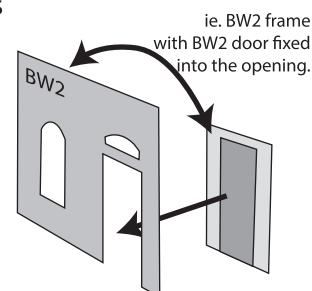
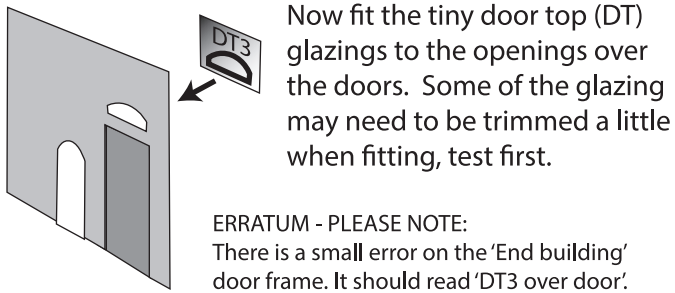
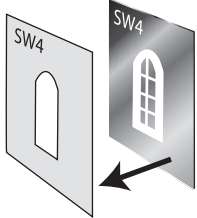

Fig.1. GLAZING & WINDOWS Cont'd.



Now fit the tiny door top (DT) glazings to the openings over the doors. Some of the glazing may need to be trimmed a little when fitting, test first.

ERRATUM - PLEASE NOTE:
There is a small error on the 'End building' door frame. It should read 'DT3 over door'.



Now fit each glazing to its corresponding window frame and when they are all done, place them back on the card as shown above until they are needed.

PLAIN GREY STRENGTHENING CARD

This card contains the bits that fit inside the kit to strengthen and hold it together. They are described here with numbers and a key below. To make sure you don't get them mixed up it is best if you just write these numbers on the components before you extract them.

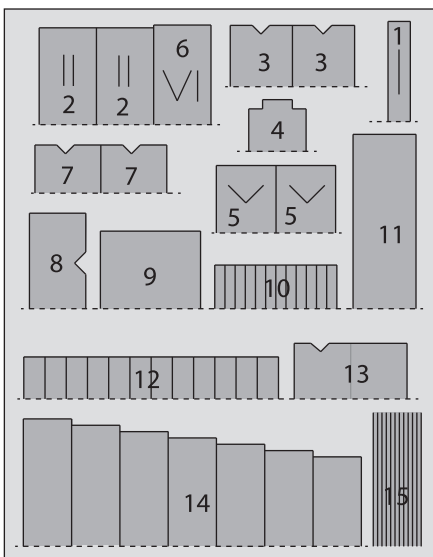

The dotted lines indicate the score lines you need to cut to extract the components from the base sheet.

Key to components:

- | | |
|--------------------------------------------|-------------------------------------------------------|
| 1. House gable support | |
| 2. Platform shelter back wall spacers x 2. | |
| 3. Booking hall wall joiners x 2. | |
| 4. End building ceiling. | 13. Positioning jig for platform shelter back wall. |
| 5. Platform shelter ceilings x 2. | |
| 6. Waiting room ceiling. | 14. Steps for the ramp and stairs to platform height. |
| 7. House inner walls x 2. | |
| 8. Waiting room inner side wall. | 15. Barge board spacers. |
| 9. House inner floor. | |
| 10. Single chimney stack formers x 12. | |
| 11. Booking hall ceiling. | |
| 12. Double chimney stack formers x 12. | |

Now cut out all the components from sheets A & B and all the components from the plain grey strengthening card and place in your builders yard as described on the first page.

PAINING CORNERS & EDGES.

As you proceed with this kit you will notice that the white card this kit is printed on shows through on the edges and corners. To make a perfect job of things these areas look a lot better if they are hidden by painting over them. And this is best done as you are constructing the kit before building, and it is very easily done. All you need is simple set of child's water colour paints and a fine brush.

Mix your colour with lots and lots of water, apx. 1 part paint to 5 parts water, maybe more. TEST ON WASTE CARD FIRST UNTIL YOU HAVE THE CORRECT SHADE AND COLOUR.

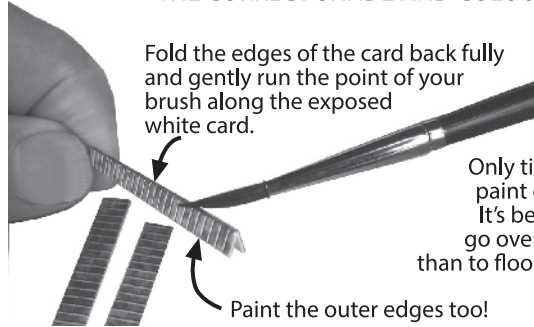

Fold the edges of the card back fully and gently run the point of your brush along the exposed white card.

Only tiny amounts of paint on your brush. It's better to have to go over it a few times than to flood it with paint.

Paint the outer edges too!

Before the paint dries, run your finger along the edge to rub the colour into the absorbent white card. Then wipe away any paint that has run onto the printed surface before it dries.

Remember, you only need to just slightly tint the card with a little colour, DON'T paint a thick solid line down the edges, you will only make it look worse.

Fig.2. BUILDING 'A' Station Master's House.

After painting the corners, fit the windows and the door unit to the ground level openings only. Fit behind each opening so they are centred as shown.

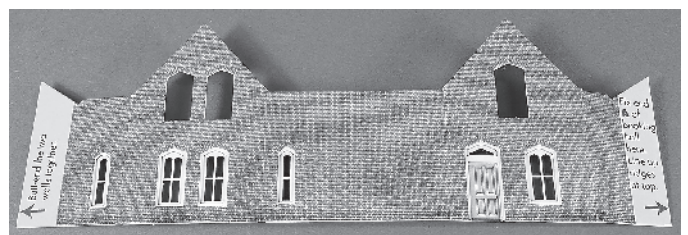

↑ HW4. ↑ HW1. ↑ HW3. ↑ HW6.

Fit the windows with the code numbers as shown above.

Now fit the two grey inner walls, marked (7) on grey card sheet.

Fit with the notches on the top edge

This grey card sticks out past the end of the wall. This is so that it acts as a brace when the walls are folded around and glued. See next photo.

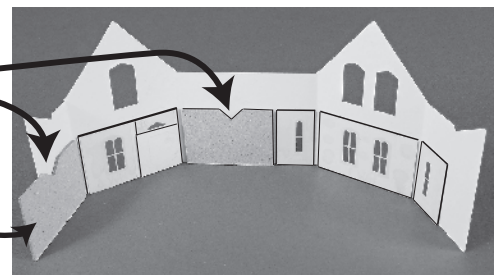
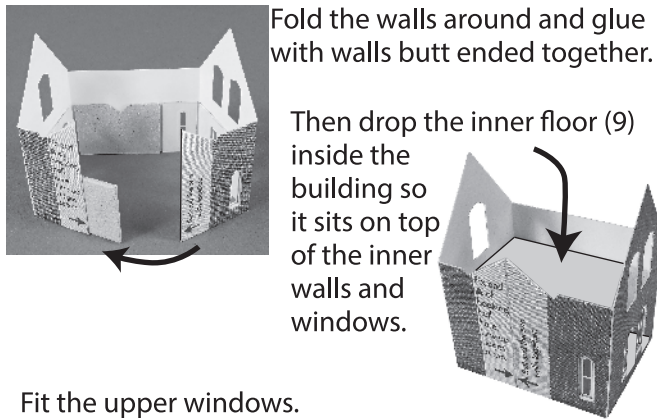

Fig.2. BUILDING 'A' Continued.



Fold the walls around and glue with walls butt ended together.

Then drop the inner floor (9) inside the building so it sits on top of the inner walls and windows.

Fit the upper windows.

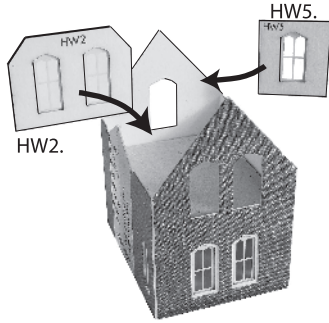

Then pop the plain grey gable wall support card marked (1.) on top of the windows.

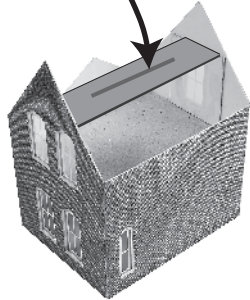
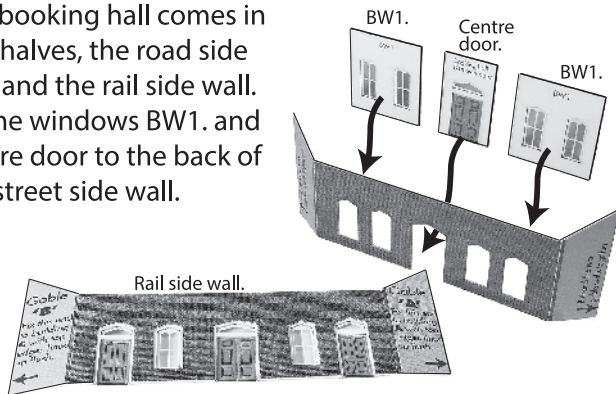

Fig.3. BUILDING 'B' Booking Hall.

The booking hall comes in two halves, the road side wall and the rail side wall. Fit the windows BW1. and centre door to the back of the street side wall.



Then fit the door/window units BW2. and the other centre door to the rail side wall.

Fix two halves together.

Fold the end walls and join them butt ended together using grey wall joiners (3. on grey card) to brace them from the inside.

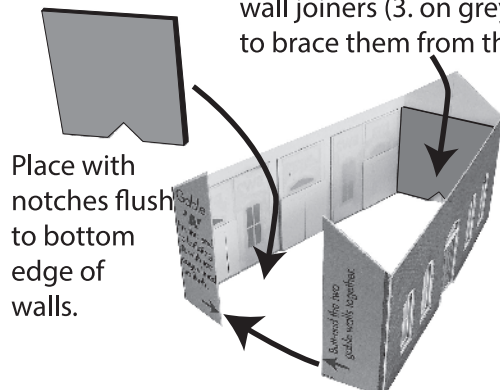

Place with notches flush to bottom edge of walls.

Fig.3. BUILDING 'B' Continued.

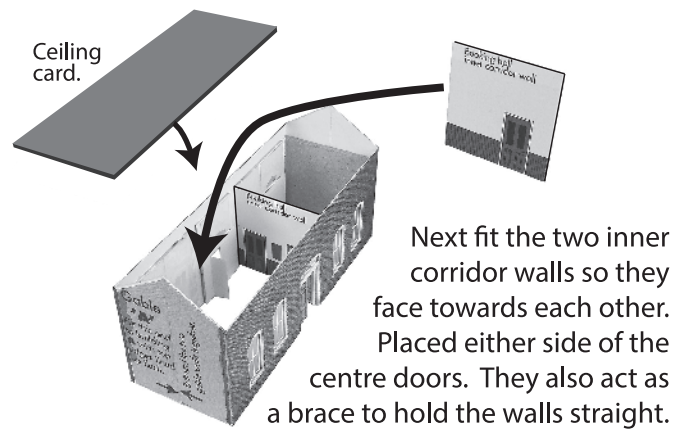

Then drop the ceiling card in, sitting on top of the end braces and windows etc. Grey card marked 11.

Fig.4. JOIN BUILDINGS TOGETHER.

Fit the booking hall to the side of the Station Master's house.

Line up the sloping wall tops flush with each other.

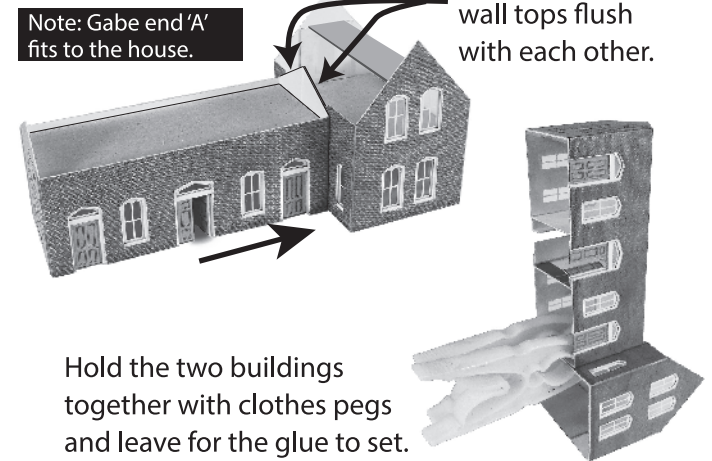

Hold the two buildings together with clothes pegs and leave for the glue to set.

Fig.5. BUILDING 'C' Waiting Room.

Fit the two windows marked BW1. to each gable wall. Fit grey inner wall (marked 8. on grey sheet) with notch to the bottom edge flush with wall.

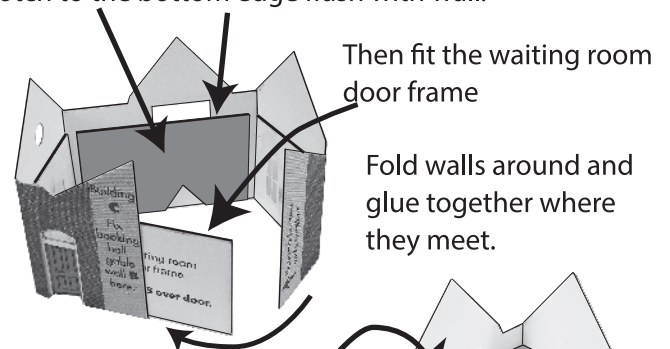

Then fit the waiting room door frame

Fold walls around and glue together where they meet.

Drop in the waiting room ceiling embossed with 'VI' down inside the building (marked 6. on grey card) so that it sits firmly on top of the window frames and inner side walls.

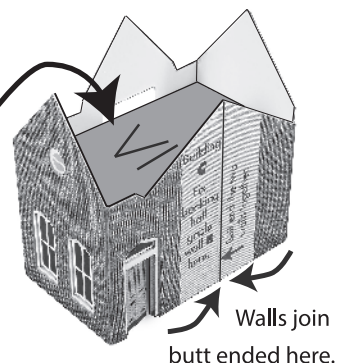

Walls join butt ended here.

Fig.6. FIX BUILDINGS TOGETHER.

Fix the waiting room to the other end of the booking hall in just the same way as the other end.

Making sure the sloping wall tops align flush.



Fig.7. THE END BUILDING.

This tiny building only has three sides and fits with the open end against the side of the waiting room.

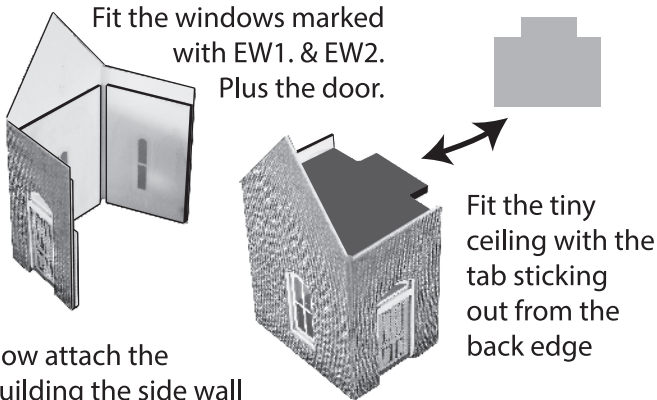

Now attach the building the side wall of the waiting room. The grey tab on the ceiling fits through the hole in the side wall ensuring that it is correctly in line with the main building. Fix the wall ends with tiny spots of glue.

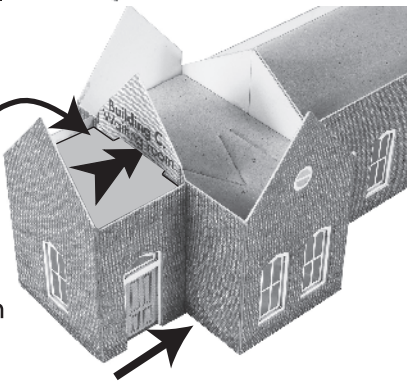

Fig.8. THE ROOFS.

Start with the central booking hall roof. This sits onto the two sloping walls that join the buildings together. Hold down till fast.



The sides then fit between the house and waiting room. Make sure the longer side fits to the rail side, giving an overhanging canopy the full length of the booking hall.

Fig.8. THE ROOFS Continued.

The rest of the roof sections then fit as shown here.

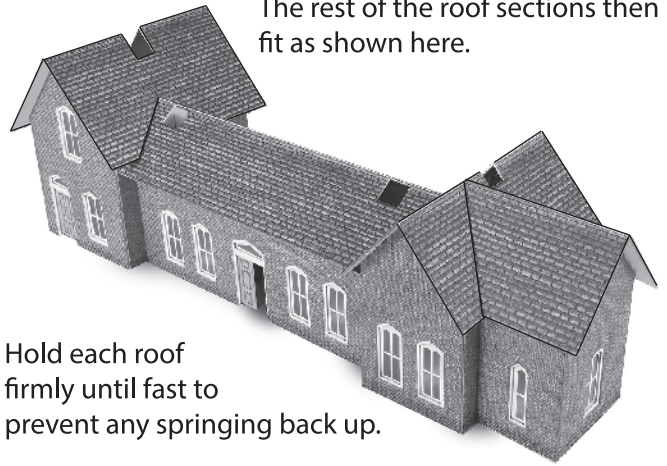

Hold each roof firmly until fast to prevent any springing back up.

Fig.9. BARGE BOARDS.

The barge boards are located on the main sheet 'A'.

To space them out from the gable walls there are thin card strips on both the plain grey card and sheet 'B' cut them all out and place in your builders yard.

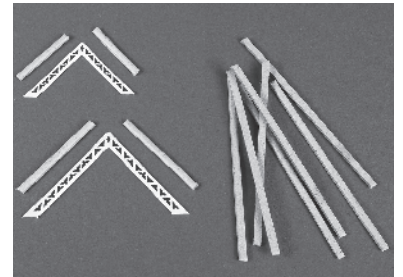

Start by cutting the thick grey strips to length and attach to the gable wall up under the roof overhang. Try the barge board for a fit, and if it needs spacing a little further out, attach some of the thin card spacers.



Now fit the barge board. HINT: Sometimes the roof can peel up a bit from the wall tops. If you cut a tiny nick in the top part here

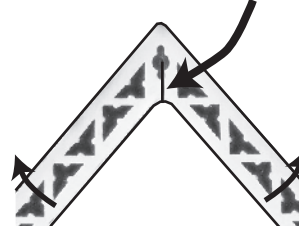

it will allow the lower parts to bend up slightly and fit against the roof hiding any discrepancies.

Fig.10. PLATFORM SHELTER.

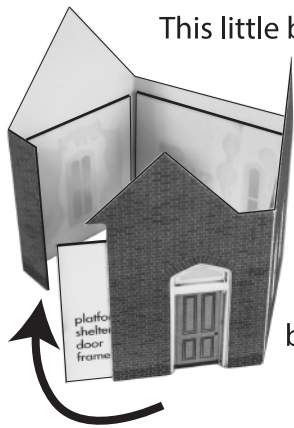

This little building is designed to stand on the opposite platform and is made up of two small waiting rooms linked together with a canopy running between.

Starting with the right hand building, attach the windows SW1. SW2. SW4. and the door.

Fold walls around and fix butt ended together where they meet. Now repeat the process with the process with the left hand building and the remaining windows. Finally, push in the two grey ceiling cards (5) marked with a 'V' down inside the buildings sitting on top of the windows.

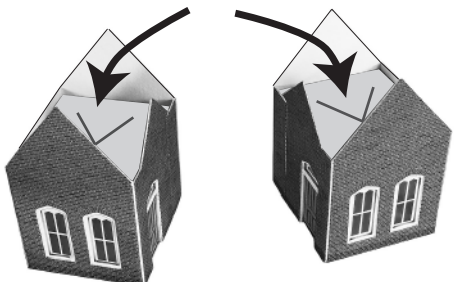

Now assemble the back wall. This is made up of two cards printed with brick effect that sandwich two plain grey cards (marked 2. on grey sheet) and embossed with between them. Glue together making sure all outer edges line up flush

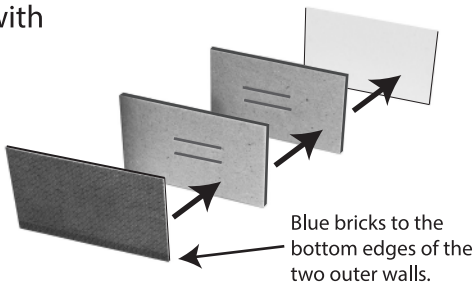

Now the back wall has to be fitted in the correct position against the side walls of the waiting rooms

To position the wall you need this little jig

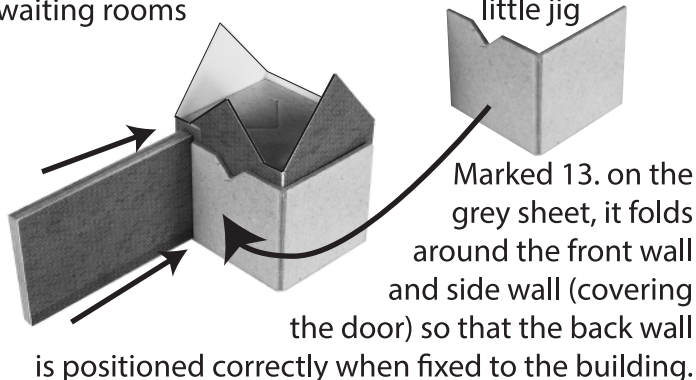

Move the jig across to the left hand building and use it to position the other end of the back wall.

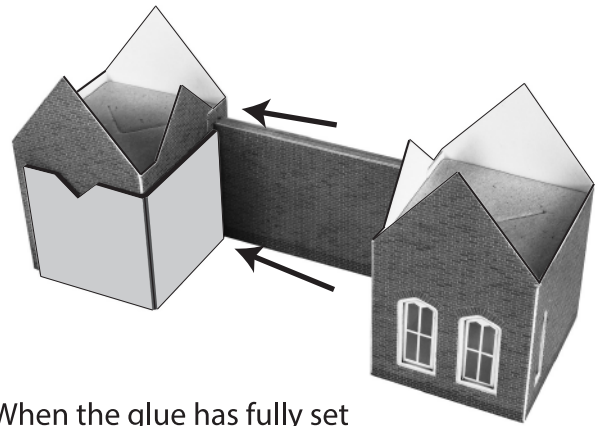

When the glue has fully set fit the centre roof making sure it is seated down on the two inner sloping walls.

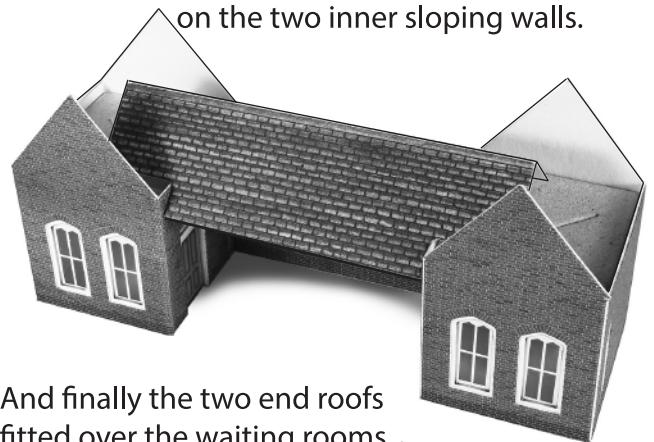

And finally the two end roofs fitted over the waiting rooms.

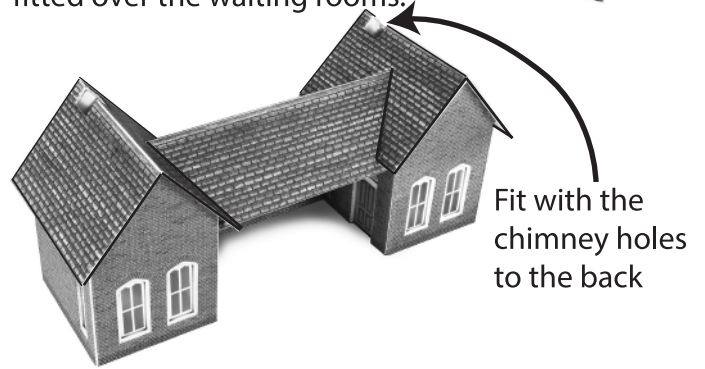

Now fit the barge boards, as you did with the main building.

Fig.11. CHIMNEY STACKS.

Starting with the double chimney stacks.

Take 4 of the grey chimney formers, marked 12. on the grey card and glue them together to form a solid block keeping all edges square and flush.

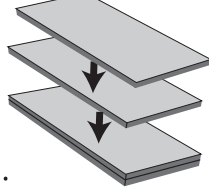

JUST ONE THING TO NOTE:

If you look at the card edges, you will see it is slightly rounded on the top side.

Glue them together so that the rounded edges are facing outwards on each corner, like this.

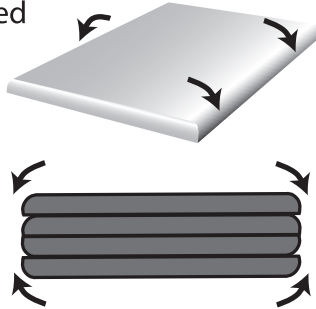

Press together tightly.

Then wrap the chimney brickwork around tightly so the top edge is flush with the grey card former.

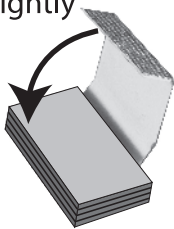

Like this.



The rounded edges described above make it easier to fit the brickwork around the block. It is a tight fit, but with care and a little pressure, it fits perfectly. Don't forget to paint the corners and edges before you start.

Now repeat with the other three double chimneys and then with the single chimney stacks, which fit together in the same way but using the narrower grey card formers marked 10 in the grey card.

CHIMNEY POTS

Care taken with the chimney pots and the stacks makes a world of difference to your finished model, with results much nicer than anything made from plastic.

Cut the terracotta coloured strips below and roll tightly around a metal rod to form a cylindrical shape. Drill bits, nails or even knitting needles can be used for this job. They just need to be about 2mm. diameter.

There are lots of spares so you can practise

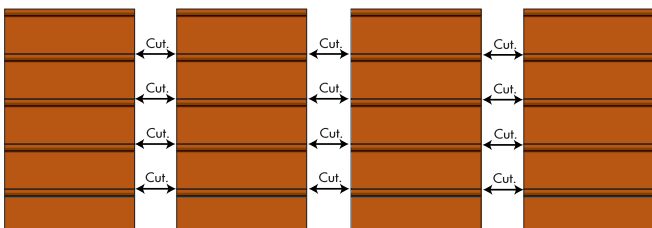

CHIMNEY POTS Continued.

Curl the strip slightly first by dragging it over the edge of your worktop underneath your thumb

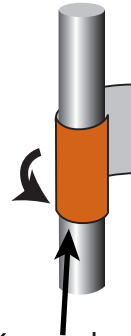
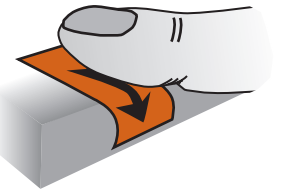

Keep edges straight.

Then roll the strip of pre curled paper around the metal rod. A drill bit is best used: for N scale 2mm. diameter.

Roll up tight and keep rolling until the paper is fully curled around.

Then unroll the end back out just enough to smear with a little glue, then roll back up and hold tight until the glue has set.

Mount the pots on to the chimney capping stones before fixing to the main chimney stacks.

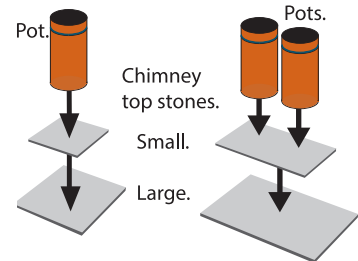

Attach the chimney tops to the stacks and then drop them into the holes in the roofs.

They can be a bit of a tight fit so ease them in gently, no need to glue.

Fig.12. THE RIDGE TILES.

If anything finishes the roof tops off perfectly, it's the ridge tile strips.

Paint the scorelines down the centre and the edges of the card before you fit them, as described earlier.

Cut the angles to fit where the roof ridges meet. This is easy done by folding the ridge strip in half and then cutting a 45° angle as shown here.

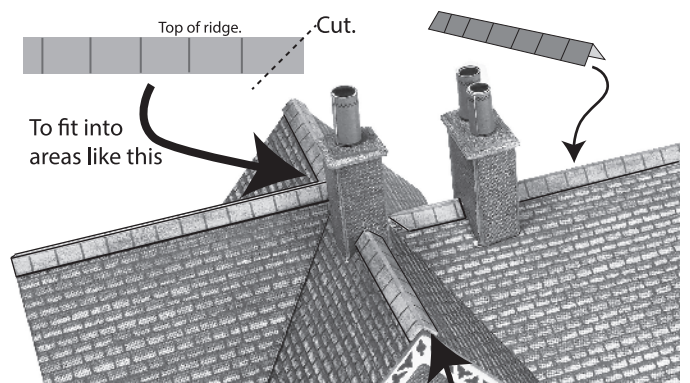

Don't forget to paint these edges too.

Fig.13. PLATFORM RAMP & STEPS.

We are often asked 'How do the little people get from street level up to the entrance of the station'. So we now include a small set of steps with a ramp for use with our PN110 and PN135 platform kits.

There are 7 grey strips each slightly different in length (marked 14 on grey card). Glue them one on top of the other with back and side edges flush and squared up.

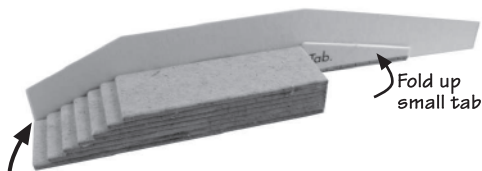
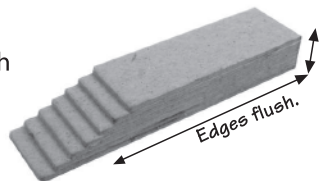

Glue the steps on to the outer wall. Line up the edge of the bottom step with the wall end.

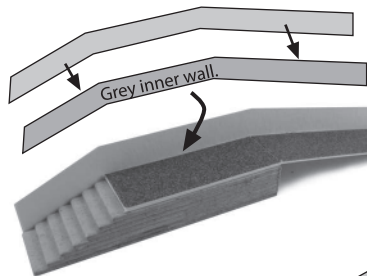

Fit the tarmac top with the yellow tabbed end sitting on the top step.

Then fit the grey inner wall followed with the inner printed brick wall.

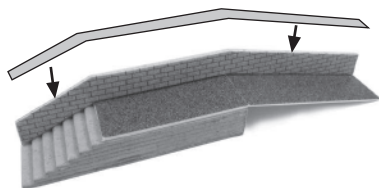

Finally, top off the wall with the capping stone strip. cut to length to fit.

SEE NEXT PAGE FOR HINTS ON FITTING TO PLATFORM.

Fig.14. LASER CUT COMPONENTS

We now get to sheet D which has some very small laser cut components which are listed below.

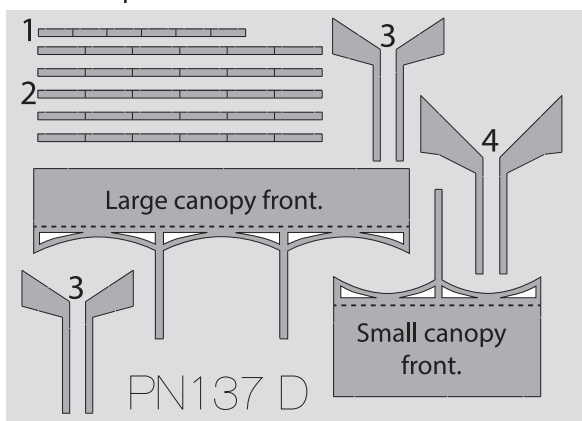

Key:

1. Small window sills x 1 strip of six.
2. Large window sills x 5 strips of six = 30 total.
3. inner posts for large canopy x 4.
4. Inner posts for small canopy x 2.

Carefully extract these components by cutting the tiny pips that hold them in the base sheet. Hold up to the light and you will see where they are. Place in builders yard until needed.

Fig.15. WINDOW SILLS.

With fine point tweezers, pick up a sill and place tiny TINY spots of glue on the back side using the Ultra-fine Tip Glue Applicator and then place just below the bottom edge of a window.

Before the glue sets, move the sill into position so it is sitting with its top edge level with the bottom of the window opening. Press gently to fix and repeat with all the other windows.

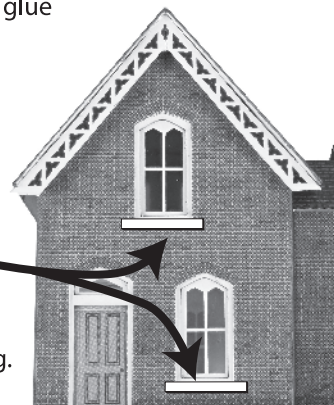

NOTE:

You may prefer to do this job just after fitting the windows, whilst the walls are still flat, but if you have already built the buildings and are reading this for the first time, then you must not have read through the instructions as requested on sheet 1. So unfortunately you'll have to do it this way.

Fig.16. CANOPY FRONTS.

These are the posts and front bits that hold the canopy roof up. We'll start with the larger double posted one.

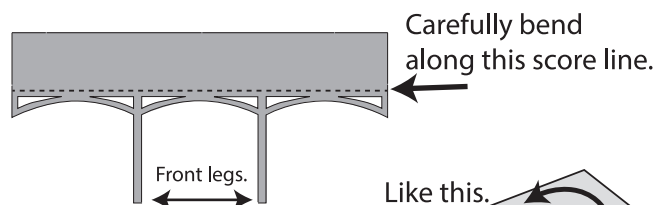

This top tab that folds over and fits up under the roof after the inner posts have been fitted.

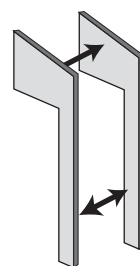
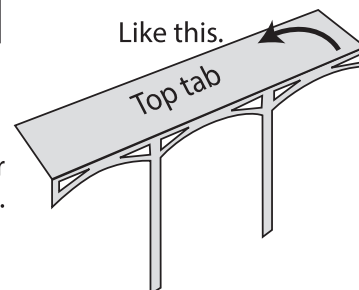

Take the four smaller inner posts marked 3. on laser sheet and glue them together in pairs to make two sets of posts double thickness.

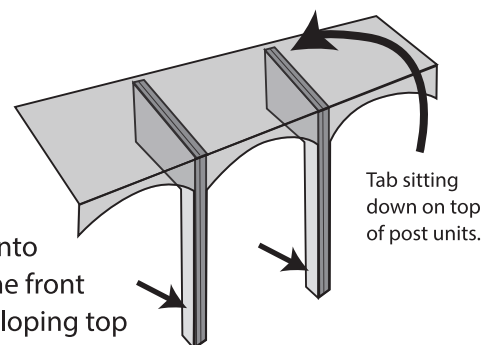

Fit the posts onto the backs of the front legs with the sloping top section supporting the top tab. This holds it at the correct angle for fitting under the canopy roof. see over.

Fig.17. FIT THE CANOPY FRONTS.



Now fit the canopy front up under the overhanging roof pushing it up as far as it will go.

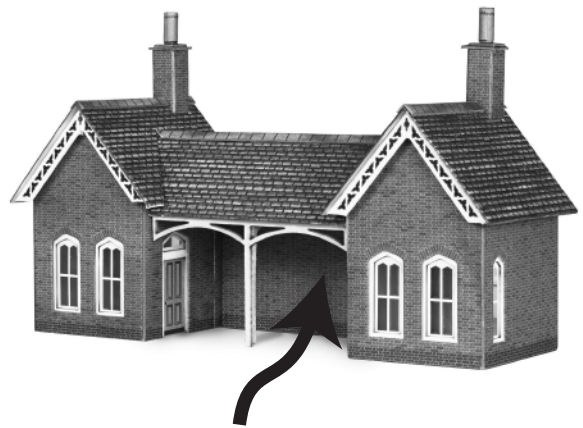

The single post canopy front goes together in the same way and fits up under the roof as far as the ridge.

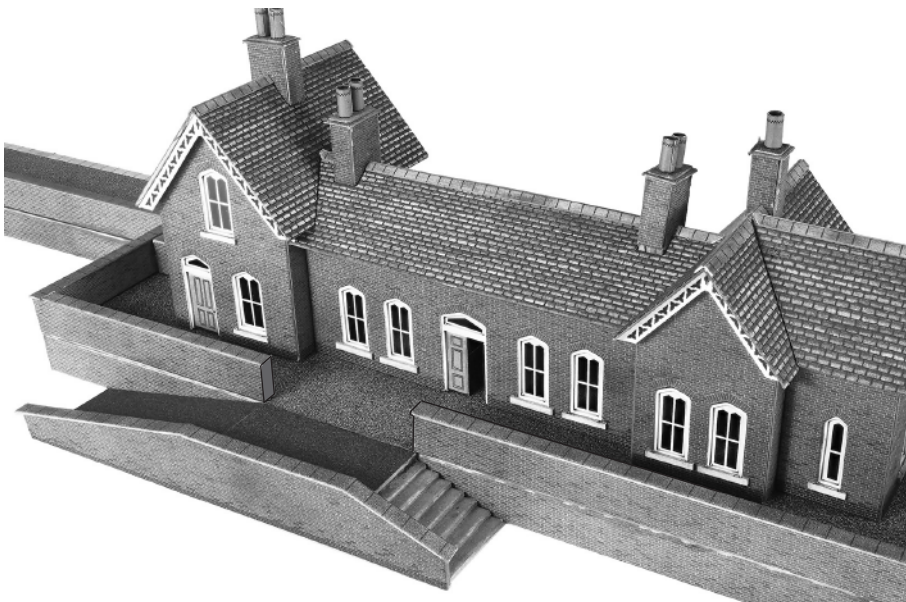

Just one last note

When it comes to the fitting the ramp-cum-steps around the back of your station, this is roughly what it should look like.

With the PN110 Platform kit used to stand your station on and walled around the back with an opening at the top of the ramp.