



Eurofighter TYPHOON twin seater

04855-0389

© 2013 BY REVELL GmbH. A subsidiary of Hobbico, Inc.

PRINTED IN GERMANY



Eurofighter TYPHOON twin seater

Das Eurofighter-Projekt begann 1984: Großbritannien, Deutschland, Italien und Spanien vereinbarten die gemeinsame Entwicklung eines Mach-2-Kampflugzeugs, das die unterschiedlichen bei den jeweiligen Luftstreitkräften noch im Einsatz befindlichen Strahlflugzeuge aus den 70er Jahren ersetzen sollte. Vor dem Bau von sieben Entwicklungsflugzeugen durch das Eurofighter-Konsortium entwarf und flog British Aerospace 1986 zunächst den EAP-Demonstrator (Experimental Aircraft Programme), um zahlreiche Designvorschläge für das Eurofighter-Projekt zu testen. In Deutschland hob dann am 27. März 1994 das erste echte Entwicklungsflugzeug ab, das erste britische folgte zehn Tage später. Den Entwicklungsflugzeugen folgten dann fünf sog. Instrumentierte Serienflugzeuge für laufende Tests und die weitere Entwicklungsarbeit. Nach einigen politischen Neuüberlegungen umfasste die erste Serientranche schließlich 180 Flugzeuge für Deutschland, 232 für Großbritannien, 121 für Italien und 87 für Spanien. Bis Anfang 2013 wurden mehr als 350 Eurofighter ausgeliefert. Dank des großen Anteils an Kohlefaserkomponenten und anderen hochmodernen Materialien ist der – in der britischen Luftwaffe häufig einfach Typhoon genannte – Eurofighter sehr leicht und verfügt über hervorragende Stealth-Eigenschaften. Das absichtlich instabile Flugzeug ist dank seiner digitalen vierkanaligen Flugsteuerung äußerst kontrollierbar und wendig. Die zweiseitigen Varianten verfügen über dieselben Kampffähigkeiten wie die einsitzigen und wurden ausschließlich für Schulungszwecke verwendet, bis spezielle Geschwader für den Luft-Boden-Einsatz aufgestellt wurden. Das „Glas“-Cockpit ist mit der modernsten Avionik ausgestattet und bietet anstelle der herkömmlichen Zeigerinstrumente drei große Multifunktionsbildschirme. An Steuerknüppel und Schubregler sind fernere Knöpfe und Schalter angebracht, damit der Pilot möglichst wenig die Hände von der Steuerung nehmen muss. Später wurden unter anderem noch ein Helmdisplay und eine Sprachsteuerung entwickelt. Der Pilot sitzt auf einem zero-zero-fähigen Mark-16-Schleudersitz von Martin-Baker. Der Pilot kann während des Flugs durch die Wahl der Waffe die Einsatzfähigkeit optimieren, mit dem leistungsfähigen Radar können gleichzeitig mehrere Ziele in großer Reichweite (außerhalb des Sichtbereichs) erkannt und verfolgt werden. Die 13 Außenlastpositionen des mit AIM-120-AMRAAM- und Meteorraketen bewaffneten Eurofighters können auch Kurzstreckenwaffen wie etwa Sidewinder oder Iris-T-Raketen sowie Langstrecken-Kraftstofftanks aufnehmen. Bodenangriffseinsätze können mit ungenelkten ebenso wie mit lasergelenkten Bomben durchgeführt werden. Auch die Luftbetankung ist standardmäßig möglich. Der Einsatz des Eurofighters in den Streitkräften der vier Partnerländer begann 2003. Das Flugzeug wurde außerdem nach Österreich, Saudi-Arabien und in den Oman verkauft. Der von zwei Eurojet-EJ200-Turbofans mit je 60kN (13,500 lb) Schub ohne und 90 kN (20,200 lb) mit Nachbrenner angetriebene Eurofighter erreicht bei maximaler Flughöhe eine Höchstgeschwindigkeit von 2.390 km/h (1,480 mph).

Spannweite: 10,95 m (35ft 11in.) Länge: 15,96 m (52ft 4in.)

Eurofighter TYPHOON twin seater

The Eurofighter project began in 1984 when Great Britain, Germany, Italy and Spain agreed to jointly develop a Mach 2 fighter aircraft that would replace the various 1970's era jets they were then operating. Before the building of seven development aircraft by the Eurofighter Consortium, British Aerospace designed and flew the EAP (Experimental Aircraft Programme) technology demonstrator in 1986. This proved many of the design ideas for the Eurofighter project and the first true development aircraft flew in Germany on 27 March 1994, followed by the first British aircraft 10 days later. The development aircraft were followed by five Instrumented Production Aircraft, full production standard aircraft for ongoing tests and development work. After some political rethinking, initial production batches comprised 180 aircraft for Germany, 232 for Great Britain, 121 for Italy and 87 for Spain. Over 350 Eurofighters had been delivered by the beginning of 2013. Comprising a large percentage of carbon fibre composites and other state-of-the-art materials, the Eurofighter (known as Typhoon in Royal Air Force service) is stealthy and light weight. The intentionally unstable airframe is highly manoeuvrable being controlled through a four channel digital flight control system. The twin seat variants have all the combat capabilities of the single seat version and were used solely for training until the dedicated air-to-ground squadrons became operational. Including the latest avionics technology, the "glass" cockpit features 3 large multi-function displays in place of the traditional dials found in earlier aircraft. The control column and throttle also feature a multitude of buttons and switches, greatly reducing the need for the pilot to remove their hands from the controls. Later developments include a helmet mounted display for the pilot and direct voice command. The pilot sits on a Martin-Baker Mk.16 zero-zero ejection seat. Mission performance can be optimised by pilot selection whilst in flight and the powerful radar can detect and track multiple targets at extreme (beyond visual) range. Equipped with AIM-120 AMRAAM and Meteor missiles, the Eurofighter's 13 external stores locations can also carry short range weapons, such as Sidewinder and Iris-T, together with long-range fuel tanks. Ground attack missions make use of both free fall and laser guided bombs. Air refuelling capability is also standard. Squadron service in the four partner nations began in 2003 and sales have also been made to Austria, Oman and Saudi Arabia. Powered by two Eurojet EJ200 turbofans, each rated at 60kN (13,500 lb) dry (90 kN, 20,200 lb with afterburner) the Eurofighter has a maximum speed of 2,390 km/h (1,480 mph) at high high altitude. Wingspan: 10.95m (35ft 11in.) Length: 15.96m (52ft 4in.)

Form hergestellt und im Eigentum von Revell GmbH. Wiederrechtliche Nachahmungen werden gerichtlich verfolgt.
 Ce produit est propriété de la société Revell GmbH. Toute utilisation ou duplication frauduleuse fera l'objet de poursuites en justice.
 Modelado y en propiedad de Revell GmbH. Imitaciones ilícitas serán perseguidas por la ley.
 Forma prodotta da Revell GmbH e di proprietà della stessa impresa, la quale procederà legalmente contro ogni imitazione abusiva.
 Mallon Revell GmbH valmistama ja omisuutena. Laittomaan kopiointiin tulkaan puuttumaan oikeudellisiin toimin.
 Formen er produceret og er i Revell GmbH. Efterligning uden tilladelse vil bli sjeanlagt for rettelig forlagesje.
 Produkcja i prawa własności firmy Revell GmbH. Nielegalne podrobienie jest zabronione pod odpowiedzialnością sądowną.
 Model Revell GmbH ilmausntun mllkiyell altonda imal edillimligt. Kamuna sykin takinler mahkemee takip edilecektir.
 A forma e stătuată și e în tulajdonig birtakosa a Revell GmbH. A pogrešene ufanzatkotak est harszilytanysal brosszlylag vltokig.

Model manufactured by and property of Revell GmbH. Illegal imitations are subject to prosecution.
 Vorm vervaardigd door en eigendom van Revell GmbH. Onrechtmatige nabootsingën worden gerechtelijk vervolgd.
 Formas produzidas e de propriedade da Revell GmbH. Cópias não autorizadas serão processadas juridicamente como determinado na lei.
 Modellen tillverkad av och ällör Revell GmbH. All kopiering beivras enligt lagen om upphovsrätt.
 Formen er fremstillet af Revell GmbH som også har ejendomsret. Lovstridige efterligninger straffes.
 Modeli izdelovana i v lastnosti lastništva firme Revell GmbH. Preizvovalne poddelni presredujejo v sudske in pravne postopke.
 H formig katsozozs jottogel kol terijzbe ottog i btozokozs ihs Revell GmbH. Cs. perztozozs mltogel vo katoz.ikevtsi btozokozs.
 Taz by "ylyvden" form Revell GmbH a e. gijn vassitovon. Prati nezakoznyj m parodobnenijem se bude post.govat sudni cestou.
 Forma je proizvedena in je v lastništva Revell GmbH. Neovlačne kopije bodo pravno kažnjene.

Vor dem Zusammensetzen gut durchlesen!

D: Achtung: Jedes Teil ist nummeriert (1). Reihenfolge der Montageschritte beachten. Benötigte Werkzeuge: Messer und Feile zum Entfernen und Entgraten der Teile (2) Gummiband, Klebeband und Wäscheklamern zum Zusammenhalten der geklebten Einzelteile (3). Plastiktülle in einer milden Wäschemittelung reinigen und an der Luft trocknen, damit der Farbanstrich und die Abziehbilder besser haften. Vor dem Ankleben prüfen ob Teile passen, Klebstoff sparsam auftragen Chrom und Farbe an den Klebeflächen entfernen. Kleine Teile anstreichen, bevor sie vom Rahmen entfernt werden (4) (5). Farben gut durchtrocknen lassen, erst dann den Zusammenbau fortsetzen. Jedes Abziehbildmotiv einzeln ausschneiden und ca. 20 Sekunden in warmes Wasser tauchen. Das Motiv an der bezeichneten Stelle vom Papier abschneiden und mit Lösspapier andrücken.

NL: OPGELET: Voor de montage eerst goed de handleiding lezen. Elk onderdeel is genummerd (1). Let op de montagevolgorde. Benodigd gereedschap: mes en vijl voor het afbramen van de onderdelen (2); elastiek, plakband en wasknijpers voor het bij elkaar houden van de gelijmde onderdelen (3). Plastic onderdelen met een zacht afwasmiddel reinigen en vanzelf laten drogen, zodat de verf en de decals beter hechten. Controleer voor het lijmen of de onderdelen passen; lijm dan opbrengen. Chrom en verf van de lijmvlakken ver wijderen. Kleine onderdelen verven voordat ze van het raam worden verwijderd (4) (5). Verf goed laten drogen, dan pas verdoeren met de montage. Elke decal afzonderlijk uitsnijden en ca. 20 sec. in warm water dopen. De decal op de aangegeven plaats van het papier schuiven en met vloeipapier aandrukken.

GB: ATTENTION: Read the instructions thoroughly prior to assembly. Each component is numbered (1). Adhere to specified sequence of attention. Tools required: knife and file for removal of components from frame (2); rubber band, adhesive tape and clothes pegs for clamping components together after applying adhesive (3). Clean plastic components in a mild detergent solution and allow to air-dry so that paint and transfers adhere better. Prior to applying adhesive, check to see whether the components fit together; apply adhesive sparingly. Remove chrome and paint from the contact surfaces. Paint small components before removing them from the frame (4) (5). Allow paint to dry well, and only then continue to assemble. Cut out each transfer individually and immerse in warm water for approx. 20 seconds. Slide transfer off paper and into designated position, then press on with blotting paper.

F: ATTENTION : lisez bien la notice de montage avant de commencer. Chaque pièce est numérotée (1). Respectez l'ordre des opérations. Outils nécessaires : couteau et lime pour ébarber les pièces (2); élastiques, ruban adhésif et pinces à linge pour maintenir les pièces collées (3). Nettoyez les pièces en matière plastique dans une solution douce de produit de lavage et faites-les sécher à l'air afin que la peinture et les décalcomanies tiennent mieux. Avant de mettre la colle, vérifiez si les pièces s'adaptent bien les unes aux autres; mettez peu de colle. Enlevez le chrome et la peinture de surfaces de collage. Peignez les petites pièces avant de les détacher de la grappe (4)(5). Laissez bien sécher la peinture avant de poursuivre l'assemblage. Découpez chaque décalcomanie séparément et plongez-la dans de l'eau chaude pendant 20 secondes environ. A l'endroit marqué, faites glisser le motif pour le séparer du papier et pressez-le sur l'emplacement avec du papier buvard.

E: ¡Atención! Antes de comenzar con el ensamblaje, leer detenidamente las instrucciones. Cada pieza va numerada (1). Téngase en cuenta el orden de operaciones del ensamblaje. Herramientas necesarias: Cuchilla y lima para desbarbar las piezas (2). Cintas de cinta adhesiva y pinzas de ropa para sujetar las piezas pegadas (3). Lavar las piezas de plástico en una solución de detergente suave y dejar que se sequen al aire para mejorar así la adhesión de la pintura y de las calcomanías. Antes de aplicar el pegamento comprobar si las piezas quedan correctamente adaptadas. Aplicar el pegamento sin excederse. Alejar de las superficies de pegado el cromado y la pintura. Pintar las piezas pequeñas antes de desprenderlas de su sujeción (4) (5). Antes de proseguir con el ensamblaje, dejar que se sequen bien la pintura. Recortar las calcomanías una por una y sumergirlas durante unos 20 segundos en agua caliente. Deslizar del papel la calcomanía en el lugar adecuado y oprimirla colocando encima de ella papel secante.

I: ATTENZIONE: Prima dell'assemblaggio leggere attentamente le istruzioni di montaggio. Ogni pezzo è numerato (1). Tener presente la successione delle fasi di assemblaggio. Attrezzi necessari: coltello e lima per togliere la sbavatura dai pezzi (2); nastri adesivi e mollette da bucato per tenere insieme i pezzi singoli dopo averli incollati (3). Lavare i particolari in plastica con un detergente delicato e lasciarli asciugare all'aria, per una migliore adesione dello strato di colore e della figura decalcolabile. Prima di incollare, verificare che i pezzi si abbinano bene tra di loro; applicare il collante con parsimonia. Togliere cromo e colore dalle superfici da incollare. Dipingere i piccoli accessori sul supporto prima di rimuoverli (4) (5). Far seccare bene la vernice prima di proseguire con l'assemblaggio. Ritagliare singolarmente ogni figura ed immergerla in acqua tiepida per 20 secondi circa. Applicare il motivo nella posizione segnata e tamponarlo con carta assorbente.

S: OBS: Läs instruktionerna noga igenom innan du sätter modellen samman. Vardera detalj är nummerad (1). V g beakta följden i sammansättningsstegen. Verktyg, som du kommer att behöva : kniv och fil för att skrapa detaljerna rena (2), gummiband, tejp och klädnyppor för att hålla samman de limmade detaljerna (3). Rengör plastdelarna i en mild tvättmedelslösning och torka dem i luftren för att lack och dekaler skall hålla bättre. Kolla, om detaljerna passar ihop innan du klistar dem och använd limmet sparsamt. Avlägsna krom och lack från tygorna, som kommer att limmas ihop. Måla de små detaljerna innan du avlägsnar dem från ramen (4) (5). Låt lacket riktigt torka igenom innan du fortsätter med sammansättningen. Skär av varje dekalmotiv enkelt och doppa det i varmt vatten i ca 20 sekunder. Flytta motivet bort från papperet genom att trycka vid det angivna stället och tryck fast med löskrappor.

DK: BEMÆRK: Inden sammensætningen begynder, skal byggevejledningen læses godt igennem. Hver del er nummereret (1). Rækkefølgen af monteringsstrimene skal overholdes. Nødvendigt værktøj: Kniv og fil til afgratning af delene (2); gummibånd, tape og tøjknapper til at holde de kledede (3) enkeltdele sammen. Plastikdelene renses i en mild sæbeopløsning og lufttørres så malingen og overføringsbillederne bedre kan hæfte. Inden påførelsen kontrolleres om delene passer; limen påføres sparsommeligt. Krom og farve fjernes fra klebefladerne. De små dele males inden de fjernes fra rammen (4) (5). Lad farven tørke godt inden sammensætningen fortsættes. Opskriv billedernes motiver skæres ud enkeltvis og dyppes ca. 20 sek. i varmt vand. Skub motivet fra papiret og tryk det fast med trækrappor.

GR: ΠΡΟΣΟΧΗ: Πριν τη συναρμολόγηση, διαβάστε καλά τις οδηγίες. Κάθε εξάρτημα είναι αριθμημένο (1). Προσέξτε τη σειρά των βημάτων συναρμολόγησης. Απαιτούμενα εργαλεία: μαχαίρι και λίμα για τη λείανση των εξαρτημάτων (2), λαστιλένια ταινία, κολλητική ταινία και νανταλάκια για τη συγκράτηση των κολλημένων μεμονωμένων εξαρτημάτων (3). Καθαρίστε τα πλαστικά εξαρτήματα μέσα σε ένα "μαλακό" καθαριστικό διάλυμα και στεγνώστε τα στον αέρα, ώστε να υπάρξει καλύτερη πρόσφυση του χρώματος και των χαλκομαγιών. Πριν το κόλλημα, ελέγξτε αν ταιριάζουν μεταξύ τους τα εξαρτήματα. Επαλείψτε οικονομικά την κόλλα. Απομακρύνετε από τις επιφάνειες επικάλυψσης, χρώμα και βαφή. Βάψτε τα μικρά εξαρτήματα, πριν απομακρυνθούν από το πλαίσιο (4) (5). Αφήστε τα στεγνωθούν καλά τα χρώματα και ύστερα συνεχίστε τη συναρμολόγηση. Κόψτε ξεχωριστά το κάθε μοτίβο των χαλκομαγιών και βουτήξτε το σε ζεστό νερό για περί 20 δευτερόλεπτα. Απομακρύνετε το μοτίβο από το χαρτί, στο σηματοδομένο σημείο και πιέστε το με το σουπόχαρτο.

N: OBS! Läs noga igenom monteringsanvisningen för sammanbyggingen. Hver del er nummereret (1). Folg rekkefølgen på monteringsstrimene. Nødvendigt verktoy: Kniv og fil for fjerning av grader på delene (2), gummibånd, tape og klesklyper for å holde sammen de limede enkeltdelene (3). Rengjør plastdelene i mildt såpevann og la dem lufttørke, slik at fargen og bildene sitter bedre. Før pålimning må det kontrolleres om delene passer: ta på litt lim. Fjern krom og farge på klebeflatene. Mal de små delene før de fjernes fra rammen (4) (5). La fargene tørke godt før sammenmonteringen fortsettes. Skjær ut hvert av motivene for seg og legg dem i varmt vann i ca. 20 sekunder. Skyv motivet fra papiret på det merkede stedet og trykk på med trekkpapp.

P: ATENÇÃO: Antes de iniciar a montagem leia atentamente o manual de construção. Todas as partes componentes são numeradas (1). Abster-se para a sequência das etapas de montagem. Ferramentas necessárias: Faca e lima para aparar a rebordura das peças (2); elástico, fita adesiva e molas de roupa para sustentar as peças (3) durante o colagem. As peças de material plástico devem ser limpas numa solução fraca de detergente e secas ao ar, de forma que a demão de tinta e o decalques tenham uma boa adesão. Antes de colar, verificar se as peças encaixam; utilizez a cola em pequena quantidade. Eliminar o cromado e a tinta das superfícies a serem coladas. Não passar cola nas peças que ainda se encontram fixas na grade do material plástico. Pintar as peças pequenas antes de retirá-las da grade (4) (5). Deixar a tinta secar completamente para depois continuar com a montagem. Cortar separadamente cada um dos decalques e mergulhá-los em água morna durante aproximadamente 20 segundos. Decalcar os motivos do papel na posição indicada e secar com mate-borrão.

FIN: HUOMIO: Lue rakennusohjeet huolellisesti ennen kokoonpanoa. Jokainen osa on numeroitu (1). Huomioi osien oikea asennusjärjestys. Tarvittavat työkalut: Veitsi ja villa osien ylimääräisten nursetien poistamiseen (2); kuminauha, teippiä ja pyykkipoikia yhteentuluttajien osien paikallampitämiseksi (3). Puhdisti muoviosat miedolla pesuaineliuoksella ja anna niiden kuivua itsestään, jotta maali ja siirtokuvat tarttuvat niihin paremmin. Tarkasta ennen liimausta, että osat sopivat toisiinsa; levitä liimaa säästeliäästi. Poista kromaus ja maali limpinnoista. Maaila pienet osat ennen kuin irrotat ne pidaraimeista (4) (5). Anna maalin kuivua kunolla ennen kuin jatkat kokoonpanoa. Leikkaa jokainen siirtokuva erikseen ja upota lämpimään veteen n. 20 sekunniksi. Irrota kuvio paperin merkitystä kohdasta samalla painamalla imupaperi kuvion toista puolta vasten.

Read before you start!

RUS: Внимание: Перед сборкой хорошо прочитать руководство по монтажу. Каждая деталь пронумерована (1). Соблюдать последовательность монтажа. Необходимые рабочие инструменты: нож и напильник для зачистки деталей (2); резиновая лента, клейкая лента и зажимы для сушки белья для прижимания склеиваемых отдельных деталей (3). Детали из пластика очистить в растворе мягкого моющего средства и высушить на воздухе для того, чтобы краска и переводные картинки лучше прилипали. Перед приклеиванием проверить, подходит ли детали: клей нанести экономно. Хром и краску удалить с поверхностей склеивания. Небольшие детали покрасить перед тем, как они будут удалены из рамок (4) (5). Краску необходимо хорошо просушить, только после этого продолжать сборку. Каждую соответствующую переводную картинку отдельно вырезать и примерно на 20 секунд окунуть в теплую воду. На обозначенном месте картинку отделить от бумаги и прижать промокательной бумагой.

PL: UWAGA: Przed składaniem przeczytać dokładnie instrukcję montażu. Każda część jest ponumerowana (1). Zwrócić uwagę na kolejność przeprowadzania poszczególnych punktów montażowych. Potrzebne narzędzia: nóż oraz pilnik do usunięcia zadziórów z poszczególnych elementów (2); taśma gumowa, taśma klejowa, klamerki do bielizny dla przytrzymania sklejonych elementów (3). Wymyć plastikowe części w wodzie z delikatnym środkiem myjącym oraz osuszyć na powietrzu, aby zapewnić lepszą przylepność farby oraz kalkomanii. Sprawdź przed przyklejaniem, czy dane elementy pasują do siebie; nanosić klej oszczędnie. Usunąć chrom oraz farbę z powierzchni przeznaczonych do klejenia. Małe elementy pomalować jeszcze przed wycięciem z ramki (4) (5). Farbę dobrze wysuszyć, dopiero potem kontynuować składanie części. Wyciąć pojedynczo każdy z motywów kalkomanii i zanurzyć na 20 sekund w ciepłej wodzie. Ściągnąć motyw z papieru na oznaczone miejsce i docisnąć bibułą.

TR: DÝKÝAT: Model yapýmına baýlamadan önce aýıklamaly dykkatlice okuyunuz. Modelde kullanylan her parçaya bir numara verilmiştir (1). Montaj yapýmıny syrasýna dykkat ediniz. Gerekli el aletleri: Parçalary baýly bulunduklary çerçeveden çýkarmak için maket býçáýy ve çapaklýrýn almak için eýe (2). Yapýbtýry sürükdüny sonra parçalaryny yapýbmasy iç in bir arada tutmalya arayan paket lastiýli, selo teyp ve camaýyý mandaly (3). Boyanyñ ve çýkarmalaryny daha iy aly yapýbmasy ve kalýcý olmasý için plastik parçalary deterjanly suya temizleyip odada kurumalya býrkýnyz. Yapýbtýry sürümden önce parçalaryny karþýlýkly olarak birbirlerine tam uyup uymadyýny kontrol ediniz, ýapýbtýryýlacak ýuzeylerde boya kalýntýny ve krom varsa temizleyiniz. Yapýbkaný idareli kullanyñyz. Küçýk parçalary baýly bulunduklary çerçeveden çýkarmadan önce boyaynyz (4) (5). Boya iyice kuruduktan sonra montaja devam ediniz. Her çýkartmaly önce kaýýdy ile bilrikte kesiniz ve ýýk suya 20 saniye kadar bekletiniz. Çýkartmaly model úzerinde yapýbtýryýlacak ýuzeyde kounuz, úzerinden kurutma kaýýdy ile hafífce bastýryñken çýkartmalyny alyndaký kaýýdy yavabça çekiniz.

CZ: POZOR: Před sestavením montážního návodu důkladně pročíst. Každý díl je očíslovan (1). Dbejte na pořadí montážních kroků. Potřebné nástroje: Nůz a pilník k odstranění výrůnků na dílech (2); pryzová páska, lepicí páska a kolíčky na prádlo pro přidržování lepených jednotlivých dílů (3). Díly z plastické hmoty vyčistíte v roztoku jemného pracího prostředku a nechat vyschnout na vzduchu, za účelem zajištění lepší přilnavosti barevného nátěru a obtisků. Před nalepením zkontrolovat, zdali díly lečují; lepidlo nanášet úsporně. Chrom a barvu na lepených plochách odstranit. Malé díly natřít před jejich odstraněním z rámu (4) (5). Barvu nechat dobře proschnout, teprve potom pokračovat v sestavení. Každý motiv obtisknu jednotlivě vyřiznout a ponořit do teplé vody na dobu přibližně 20 sekund. Motiv na označeném místě z papíru odsunout a přitlačit pomocí stírachého papíru.

H: FIGYELEM: Az összelállítás előtt az építési útmutatót alaposan át kell olvasni. Minden alkatrészt számmal lát-tak el (1). A szerelési lépések sorrendjére ügyelni kell. Szükséges szerszámok: kés és reszelő az alkatrészek sor-játlanításához (2); gumiszalag, ragasztószalag és ruhaecsigák az összeragasztott alkatrészek megtartásához (3). A műanyag alkatrészeket lagy mosószerees oldatban kell tisztítani és a levegőn kell megszáritani, hogy a festék-bevonat és a matricák jobban tapadjanak. A felragasztás előtt ellenőrizni kell, hogy az alkatrészek összeillenek-e; a ragasztóanyagot takarékosan kell felhordani. A krómot és festéket a ragasztási felületekről el kell távolítani. A kisméretű alkatrészeket a keretből történő eltávolítás előtt be kell festeni (4) (5). A festékeknek hagyni kell jól megszáradni, az összeszerelést csak ezután szabad folytatni. Minden matrica-motívumot egyesével kell kivágni és kb. 20 másodpercre meleg vízbe kell áztatni. A motívumot a megjelölt helyen a papírról lecsúsztatni és itatospa-pírral felnyomni.

SLO: OPOZORIO: Pred pričetkom sestavljanja preberi navodila zaEuporabo. Vsak del je označen (1). Pri sestavljanju upoštevaj navodila po točkah. Potrebno orodje: nožek in pilica zalocevanje delov (2), elastična, lepljiva trak in ključnice za perilo za držanje zlepljenih delov (3). Plastične dele očisti z blagim praškom in posuši da se sloji barve in nalepke boljše prilejejo. Pred lepljenjem obvezno preveri, če se deli pravilno prilegajo. Previdno nanesi lepilo. Iz površine, na katere nanašaj lepilo, najprej odstrani krom in barvo. Manjše dele pobarvaj preden jih odstraniš iz okvirja (4)(5). Barva naj se dobro posuši preden nadaljuješ s sestavljanjem. Vsako nalepko izreži in potopi vtoplotno vodo (cca. 20 sekund), jo odstrani iz papirja, položi na odgovarjajoče mesto in pritisi s pivnikom.

SK: POZOR: Pred začatím stavby si pozorne preštudujte stavebný návod. Každý diel je očíslovaný (1). Dbajte na poradie montážnych krokov. Potrebne nástroje: Nôž a pilník na oddelenie dielov z rámečka a ich začistenie (2), gumický do viasov, lepiaca páska štipec na prádlo, pre pridževanie jednotlivých lepených dielov (3). Díly zEplastu odmastit vEšlabbšom roztoku čistiacieho prostriedku (saponátu) aEnechať uschnúť na vzduchu za účelom lepšej príľnavosti lepidla, farieb aEnalepiek. Pred lepením skontrolovať, či díly lečujú. Lepidlo nanašať úsporne. Chrom aEfarbu na lepených miestach opatrne odstrániť. Malé diely nafaľbiť ešte pred ich odobratím z rámečka (4) (5). Farby nechať dobre zaschnúť, až potom pokračovať vEzostavovaní. Každú nálepku vystrihnúť jednotlivito aEponoriť do vlažnej vody približne na 20 sekund. Nálepku na príslušnom mieste modelu presunúť zEžnosného papiera aEmiernie ju pritlačiť kEjovrchu nosným papierom.

RO: ATENTIE! CITITI INSTRUCTIUNILE CU ATENTIE INAINTE DE ASAMBLARE. FIECARE COMPONENTA ESTE NUMEROTATA. ASAMBLATI IN ORDINEA INDICATA PE SCHEMA. PIESELE SE DESPRIND DE PE RAMA CU UN CUTTER.BAVURILE SE INLATURA CU O PILA FINA. CURATATI PIESELE CARE SE IMBINA DE GRASIMII,URME DE VOPSEA SI CURATATI CU O SOLUTIE DE DETERGENT. VOPSTI PIESELE MICI INAINTE DE DESPRINDEREA DE PE RAMA. LASATI VOPSEAU SA SE USUCE BINE SI NUMAI APOI CONTINUATI ASAMBLAREA. TAIATI FIECARE TRANSFER INDIVIDUAL SI IMERSATI IN APA CALDA CCA 20 SEC. TRANSFERATI IN POZITIA DORITA APOI PASATI CU O HARTIE. FOLOSITI NUMAI ADEZIVI SI VOPSELE REVELL.

BG: ВНИМАНИЕ! Следвайте указаната схема. Всяка част е номерирана. Спазвайте те последователността на етапите на сглобяването. Необходими инструменти: нож и пила за отстраняване или изпиляване на отделните части; гумена лента, лейкопласт и шипки за пране за да задържите заедно съединените части след залавяването им. Пластмасовите те елементи да се почистват в слаб разтвор от вода и перилен препарат, да се изпиляват и да се оставят да изсъхнат, за да се постигне по-добро слепване на боята и ли воденката. Нанесете боята върху малките части преди да ги от делите от шаблона. Оставете боята да изсъхне преди да продължите със сглобяването. Преди нанасяне на лепливото изсъгърте те боята от повърхностите за слепване. Преди залавяване проверете дали ча стите насват идеално. Нанесете малко лепило. Изрежете по отделно всяка е дна ваденка и я потопете в топла вода за около 20 секунди. Отлепете ваденка та от указаното място на хартията и я попитете леко с попитвателната хартия.

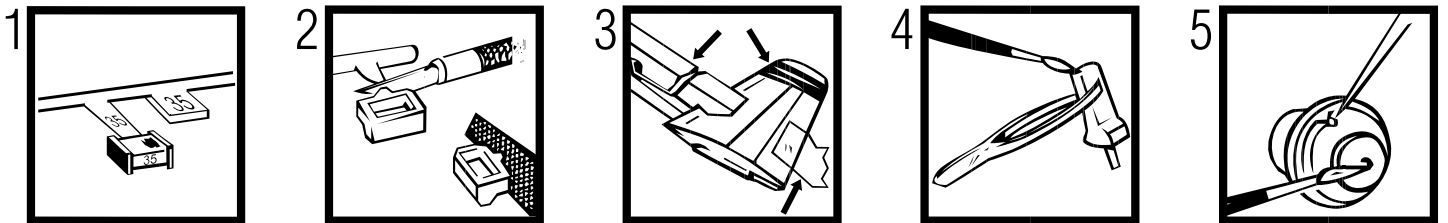

Verwendete Symbole / Used Symbols

Bitte beachten Sie folgende Symbole, die in den nachfolgenden Baustufen verwendet werden.

Veuillez noter les symboles indiqués ci-dessous, qui sont utilisés dans les étapes suivantes de la montage.

Sivance tener en cuenta los símbolos facilitados a continuación, a utilizar en las siguientes fases de construcción.

Si prega di fare attenzione ai seguenti simboli che vengono usati nei susseguenti stadi di costruzione.

Huomioi seuraavasti symbolit, jotta käytetään seuraavissa kokoonamisvaiheissa.

Lesz merke til symbolene som benyttes i monteringsstrinnene som følger.

Proszę zwracać uwagę na następujące symbole, które są użyte w ponizszych etapach montażowych

Daha sonra montaj basamaklarında kullanılanlacak olan, aşağıdaki sembollere lütfen dikkat edin.

Kérjük, hogy a következő szimbólumokat, melyek az alábbi építési fokokban alkalmazásra kerülnek, vegyék figyelembe.



Abziehbild in Wasser einweichen und anbringen

Soak and apply decals

Mouiller et appliquer les décalcomanies

Transfer in water even laten weken en aanbrengen

Remojar y aplicar las calcomanías

Pôr de molho em água e aplicar o decalque

Immergere in acqua ed applicare decalcomanie

Blöt och fäst dekalerna

Kostuta siirtokuvaa vedessä ja aseta paikalleen

Fukt motivet i varmt vann och för det över på modellen

Dypp bildet i vann og sett det på

Переводящую картинку намочить и нанести

Zmieszczyć kalkomanie w wodzie a następnie nakleić

βουτήξτε τη χαλκομανία στο νερό και τοποθετήστε τη

Çikartmayı suda yumuşatın ve koyun

Obtisk namocit ve vodě a umístit

a matrică în apă caldă și felhelyezni

Preslikać potopiti u vodu in zatem nanašati



Zur Anbringung der Abziehbilder empfohlen

Recommended for affixing the decals

Recommandé pour l'application des décalcomanies

Aanbevolen voor het aanbrengen van de transfers

Recomendado para fijar las calcas

Posição recomendada para aplicar os decalques

Raccomandato per applicare le decalcomanie

Rekommenderas för montering av dekaler

Апђетелес тил пассатинг и пласинг аf decals

Репомендуется использовать для фиксации переводных картинок на поверхности модели

Zaleśanie do nanoszenia kalkomanii

Συνιστάται για την επόχλευση των ετικετών.

Dekallerin yapıştırılmasında kullanılması tavsiye edilir

Připravek na zlepšenie prínavosti nálepek

Matrica légytő

Priporočljivo za pritrjevanje nalepk

Oporučené na zlepšenie prínavnosti nálepek

RECOMANDAT PENTRU APLICAREA ACTIVILURILOR

Подходящо за фиксация на картинки върху повърхността на модела



Kleben

Glue

Coller

Lijmen

Engomar

Colar

Incollare

Limmas

Liimaa

Limes

Lim

Клеить

Przykleić

κόλλημα

Υαρίστμα

Lepeni

ragasztani

Lepiti



Nicht kleben

Don't glue

Ne pas coller

Niet lijmen

No engomar

Não colar

Non incollare

Limmas ej

Älä liimaa

Skal IKKE limes

Ikke lim

Не клеить

Nie przyklejać

μη κολλάτε

Υαρίστμα μην

Nelepit

nem szabad ragasztani

Ne lepiti



Wahlweise

Optional

Facultatif

Naar keuze

No engomar

Alternado

Facoltativo

Valfritt

Vaihtoehtoisesti

Valgfritt

Valgfritt

На выбор

Do wyboru

εναλλακτικά

Seçmeli

Voitelineä

tetészes szerint

način izbire



Klebeband

Adhesive tape

Dévidoir de ruban adhésif

Plakband

Cinta adhesiva

Fita adesiva

Nastro adesivo

Tejp

Teippi

Tape

Tape

Клейкая лента

Tasma klejaca

κόλλητική ταινία

Υαρίστμα bandi

Lepici páska

ragasztószalag

Traka za leplimo



Klarsichtteile

Clear parts

Pièces transparentes

Transparente onderdelen

Limpiar las piezas

Peca transparente

Parte transparente

Genomsiktig detaljer

Λεπίπκνύατ όσαt

Glasskare deler

Gjennomsiktige deler

Προζαρήνες detali

Elementy przezrocyste

Παφανή εξαρτήματα

Sefal parçaları

Průzračné díly

átetsző alkatrészek

Deli ki se jasno viede



Gleichen Vorgang auf der gegenüberliegenden Seite wiederholen

Repeat same procedure on opposite side

Opérer de la même façon sur l'autre face

Dezelfde handeling herhalen aan de tegenoverliggende kant

Realizar el mismo procedimiento en el lado opuesto

Repitir o mesmo procedimento utilizado no lado oposto

Stessa procedura sul lato opposto

Upprepa proceduren på motsatta sidan

Toista sama toimenpide kuten vieressällä sivulla

Det samme arbejde gentages på den modsatliggende side

Gjenta prosedyren på siden tværs overfor

Повторять такую же операцию на противоположной стороне

Taki sam przebieg czynności powtórz na stronie przeciwnej

επαναλάβετε την ίδια διαδικασία στην απέναντι πλευρά

Aynı işlemi karşı tarafta tekrarlayın

Stejný postup zopakovat na protilehlé straně

ugyanazt a folyamatot a szemben található oldalon megismételni

Ístí postopek ponoviti in na suprotni strani



Abbildung zusammengesetzter Teile

Illustration of assembled parts

Figure représentant les pièces assemblées

Afbeelding van samengevoegde onderdelen

Ilustración piezas ensambladas

Figura representando peças encaixadas

Illustrazione delle parti assemblate

Bilden visar delarna hopsatta

Kuva yhteenliitetystä osista

Illustrasjonen viser de sammensatte delene

Illustrasjon, sammensatte deler

Изображение смонтированных деталей

Rysunek złożonych części

απεικόνιση των συναρμολογημένων εξαρτημάτων

Birleştirilen parçaların şekli

Zobrazeni sestavených dílů

összeállított alkatrészek ábrája

Slika slopljenega dela



Mit einem Messer abtrennen

Detach with knife

Détacher au couteau

Met een mesje afsnijden

Separar con un cuchillo

Separar utilizando uma faca

Ilustrazione dello strumento

Skär loss med kniv

Irrota veitsellä

Adskilles med en kniv

Skjær av med en kniv

Отделять ножом

Odciać nożem

διαχωρίστε με ένα μαχαίρι

Bir bıçak ile kesin

Oddélti pomoci nože

kés segítségével leválasztani

Oddéliit z nožem



Bauteile trocknen lassen

Allow the parts to dry

Laisser sécher les pièces

Oderdelen laten drogen

Dejar secar las piezas

Deixar secar os componentes

Far asciugarsi i componenti

Ilustra osien kuivata

La delene tørke

Lad komponenterne tørre

Låt byggdelarna torka

Дать деталям высохнуть

Części pozostawić do wyschnięcia

Αφήστε τα μέρη να στεγνώσουν

Yapı parçalarını kurumaya bırakınız

Alkatrészeket hagyja száradni

Jednotlivě díly nechte zaschnout

Pustite da sestavni deli posušijo



Anzahl der Arbeitsgänge

Number of working steps

Nombre d'étapes de travail

Numero d'operaciones de trabajo

Het aantal bewerkingen

Número de etapas de trabalho

Numero di passaggi

Antall arbeidsmoment

Työvähdien lukumäärä

Antall arbeidstrinn

Antall arbeidstrinn

Κοличество οπεραції

Liczba operacji

οριθμός των εργασιών

İş safhalarının sayısı

Počet pracovních operací

A munkafolyamatok száma

Številka koraka montaže

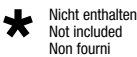

Nicht enthalten

Not included

Non fourni

Behoort niet tot de levering

No incluido

Non compresi

Não incluído

Ikke medsendt

Ingår ej

Ikke inkluderet

Eivät sisäly

Δεν συμπεριλαμβάνεται

He содержитя

Nem tartalmazza

Nie zawiera

Ni vseobvano

Igerisinde bulunmamaktadır

Není obsaženo

Beiliegenden Sicherheitstext beachten / Please note the enclosed safety advice

D: Beiliegenden Sicherheitstext beachten und nachschlagbereit halten.

GB: Please note the enclosed safety advice and keep safe for later reference.

F: Respecter les consignes de sécurité ci-jointes et les conserver à portée de main.

NL: Houdt u aan de bijgaande veiligheidsinstructies en hou deze steeds bij de hand.

E: Observar y siempre tener a disposición este texto de seguridad adjunto.

I. Seguire le avvertenze di sicurezza allegate e tenerle a portata di mano.

P: Ter em atenção o texto de segurança anexo e guardá-lo para consulta.

S: Beakta bifogad säkerhetstext och håll den i beredskap.

FIN: Huomioi ja säilytä ohjeet varoituksesi.

DK: Overhold vedlagte sikkerhedsanvisninger og hav dem liggende i nærheden.

N: Ha alltid vedlagt sikkerhetstekt klar til bruk.

RUS: Соблюдать прилагаемый текст по технике безопасности, хранить его в легко доступном месте.

PL: Stosować się do załączonej karty bezpieczeństwa i mieć ją stale do wglądu.

GR: Προσέξτε τις συντημένες υποδείξεις ασφαλείας και φυλάξτε τις έτσι ώστε να τις έχετε πάντα σε διαθέσιμη σας.

TR: Ekteki güvenli talimatlarını dikkate alıp, bakabileceğiniz bir şekilde muafaza ediniz.

CZ: Dbejte na přiložený bezpečnostní text a mějte jej připravený na dosah.

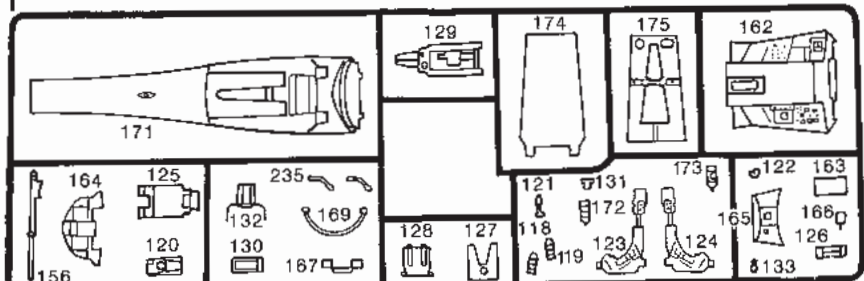
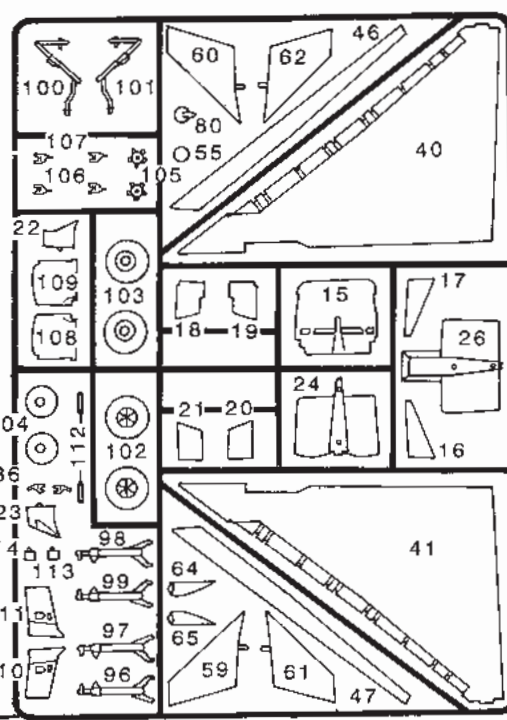
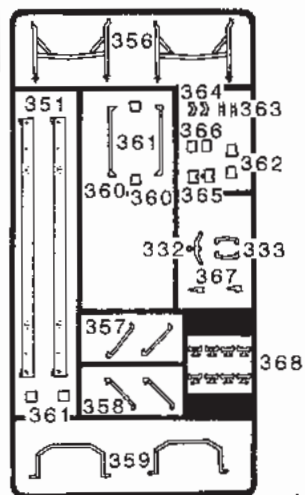
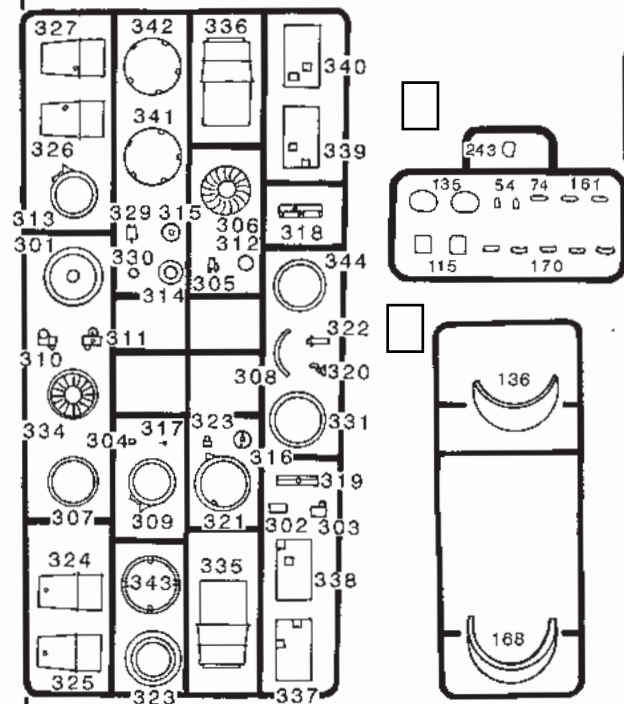
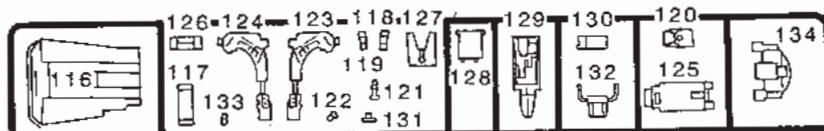
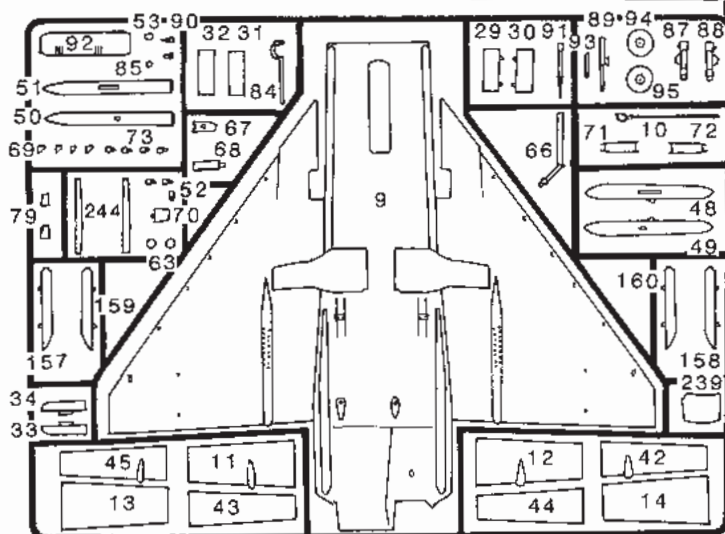
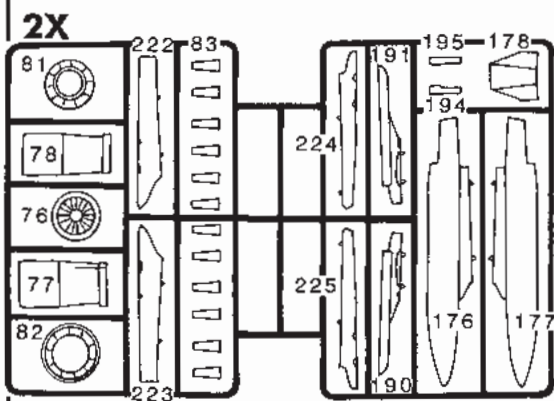
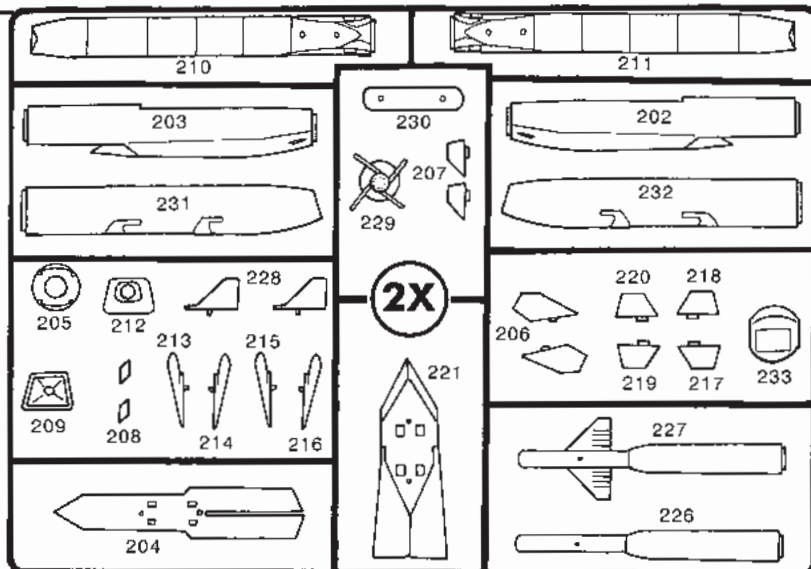
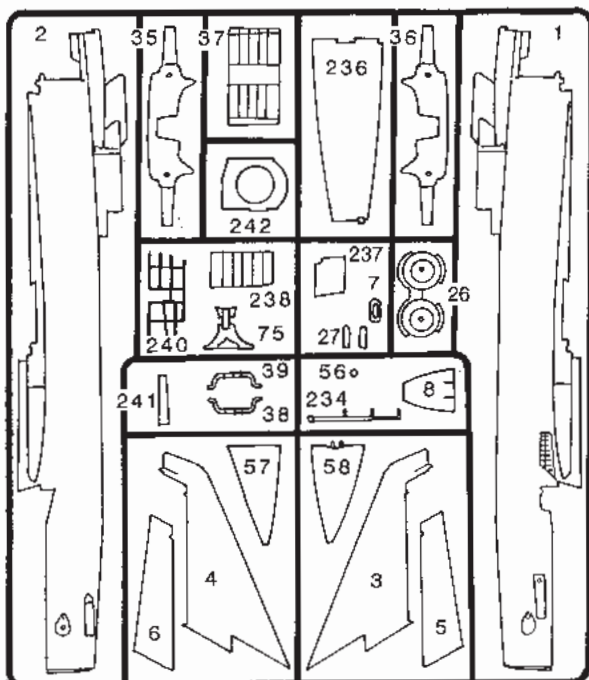

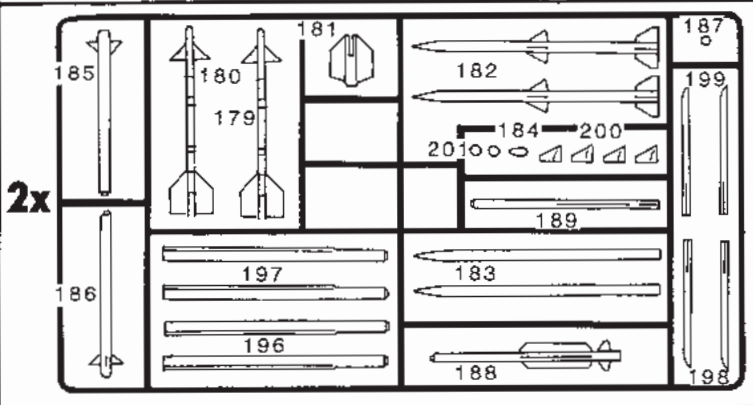

1
2X

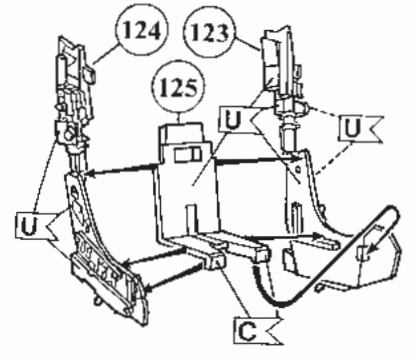

2
2X

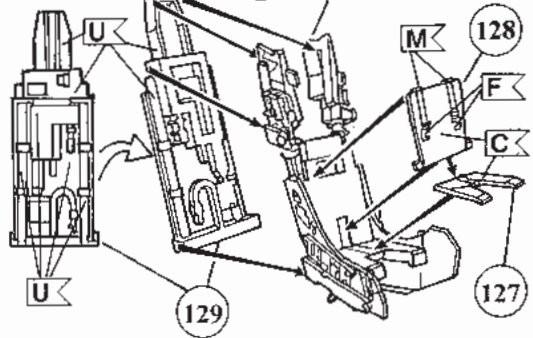

3
2X

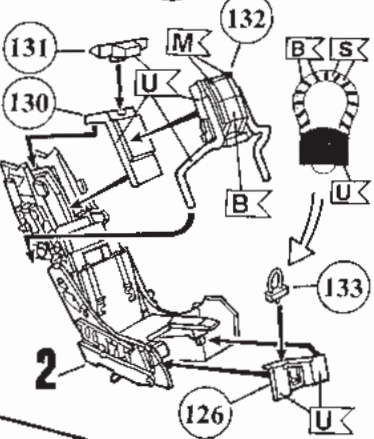

4

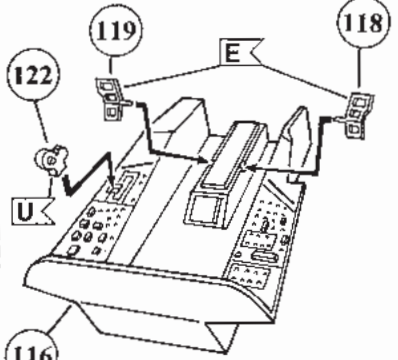

5

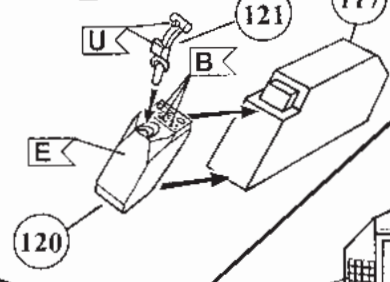

6

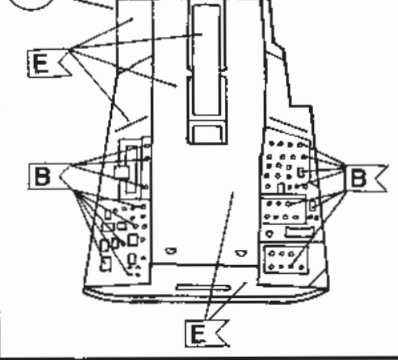
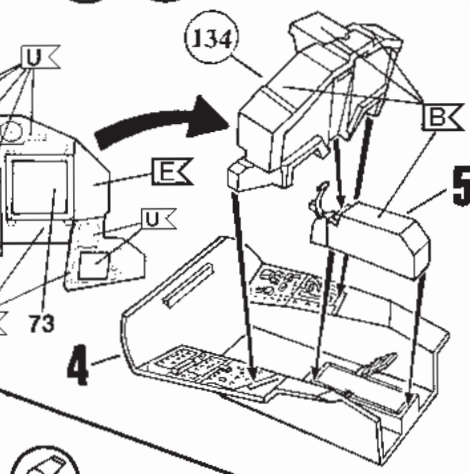

8

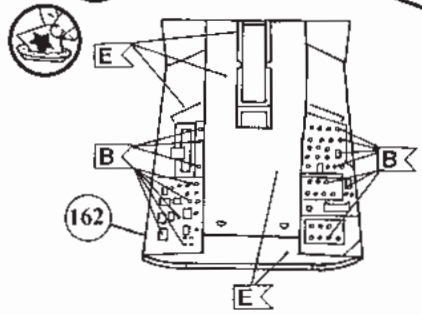

8A

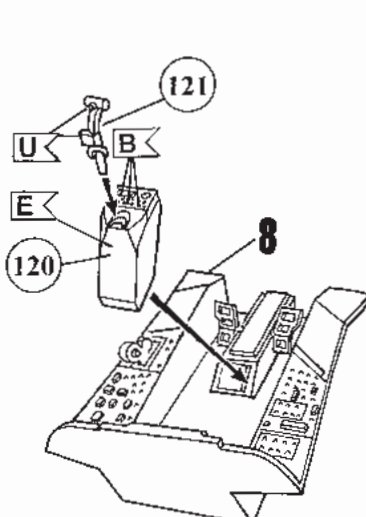

7

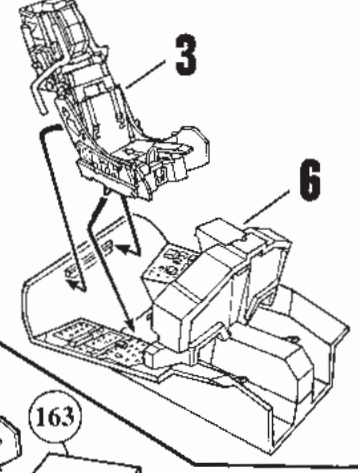

9

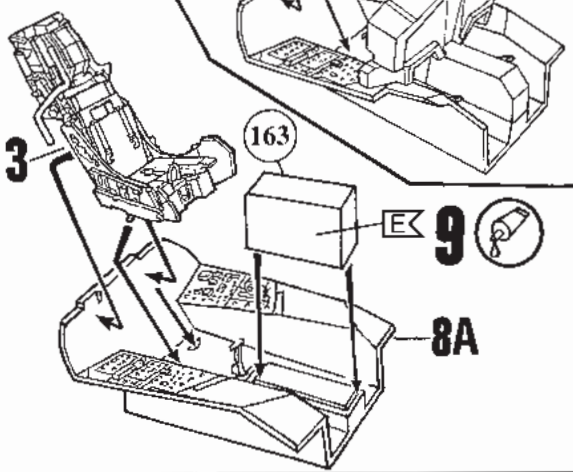

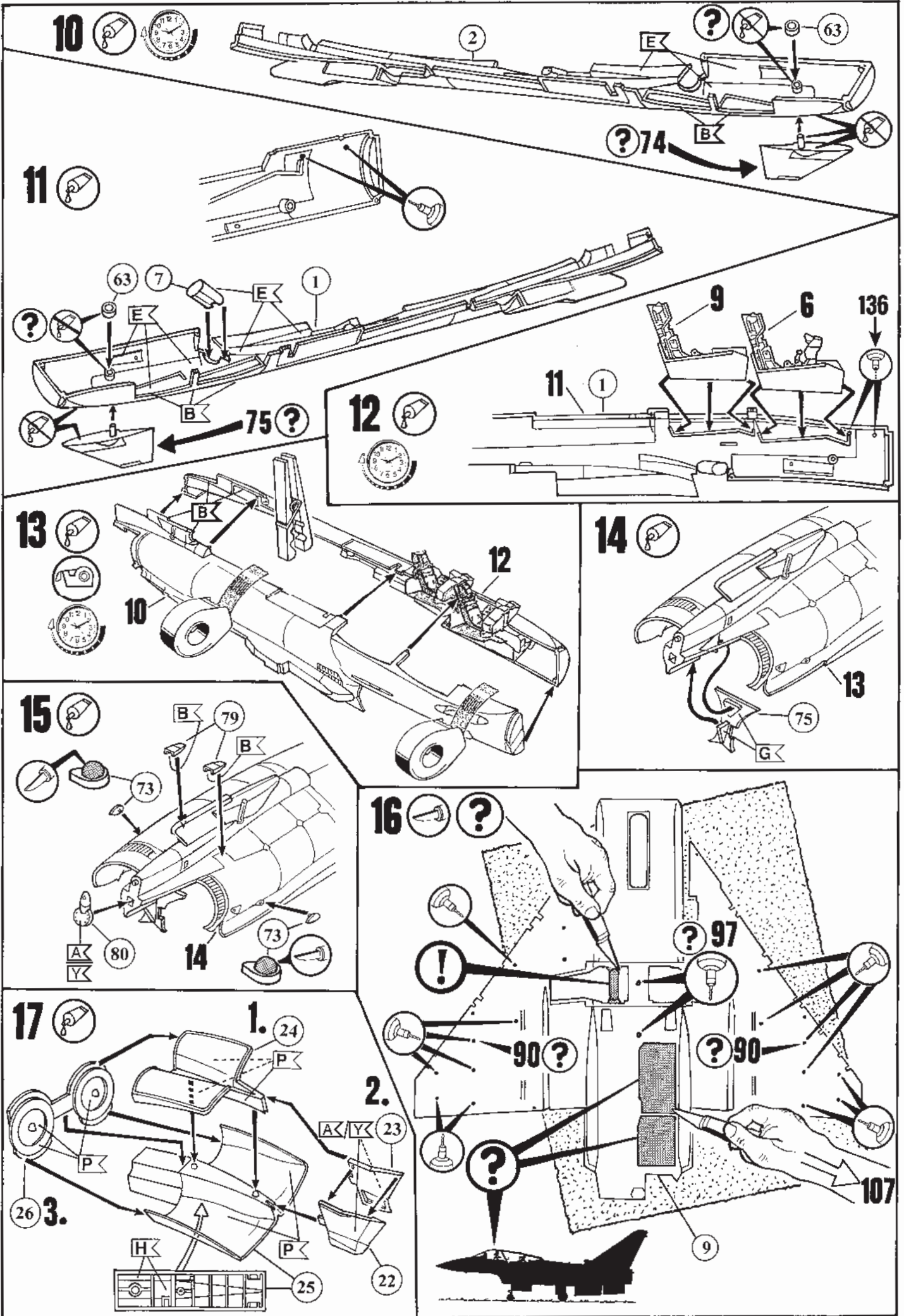

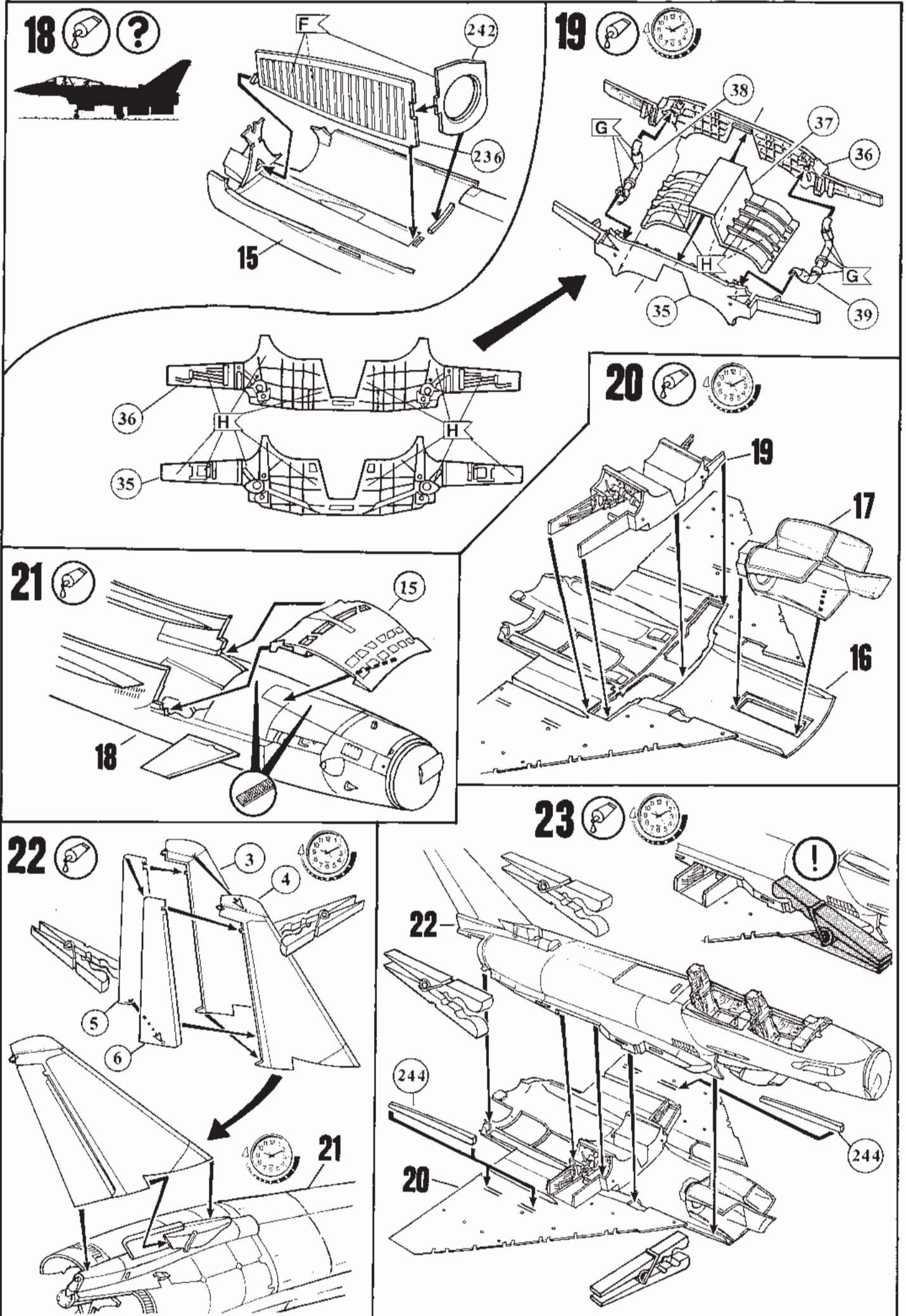

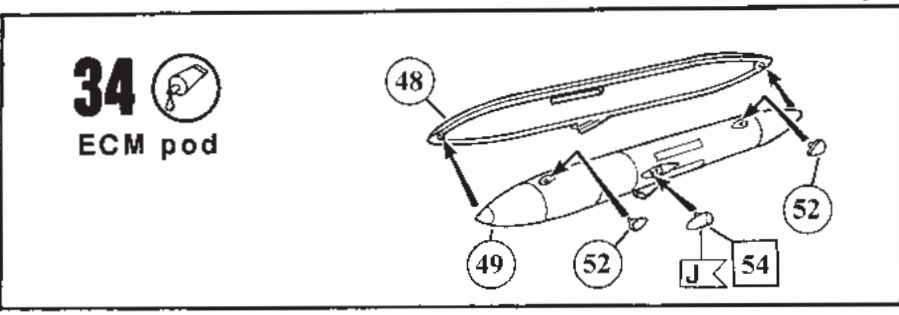
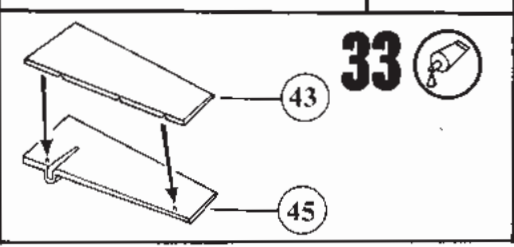
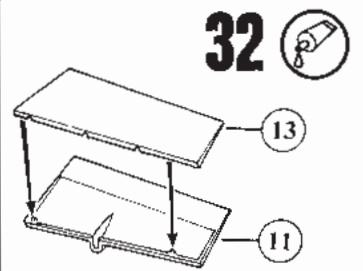
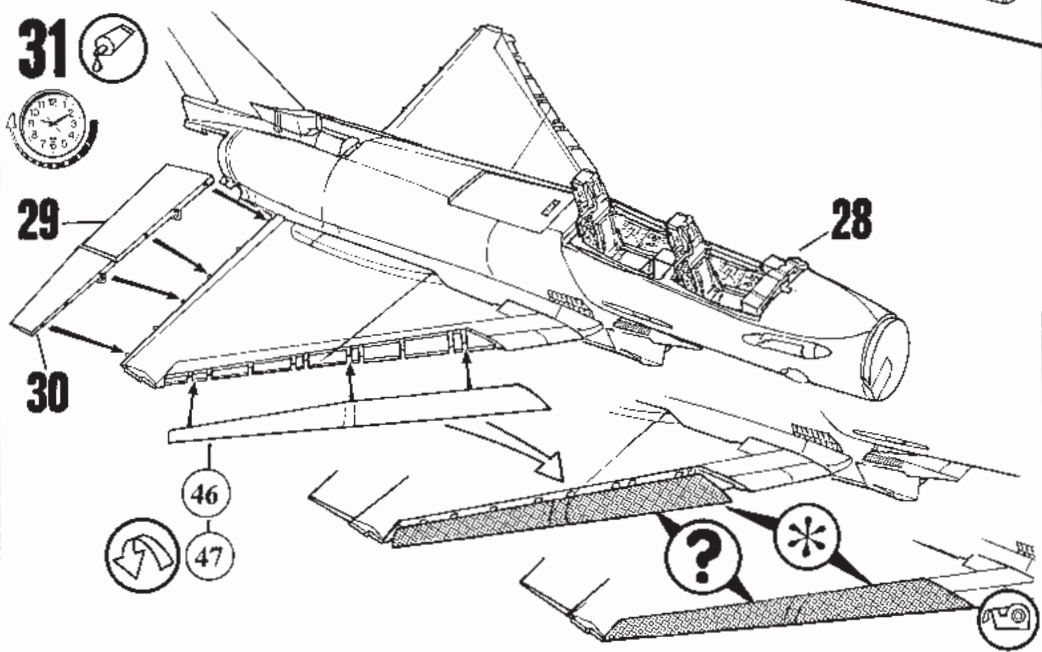
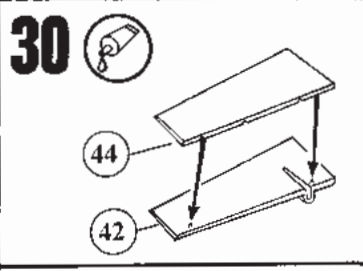
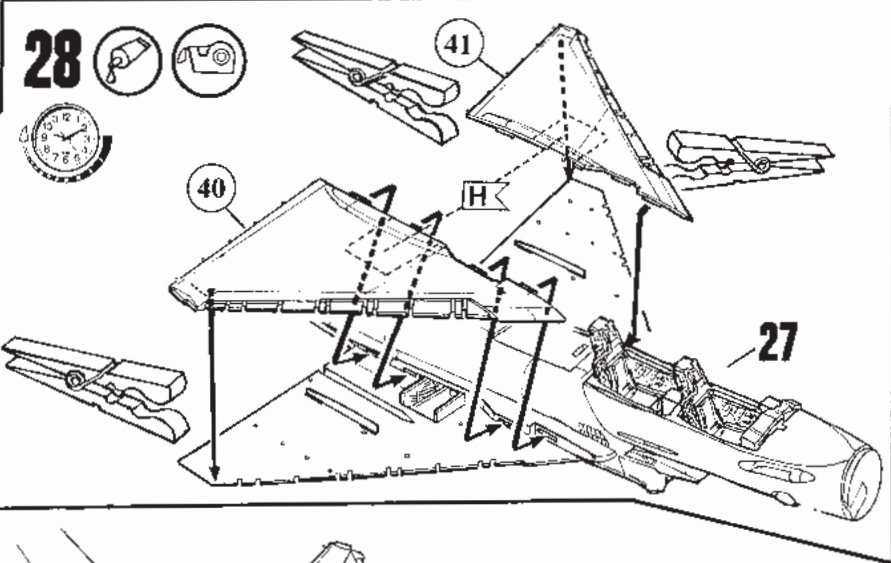
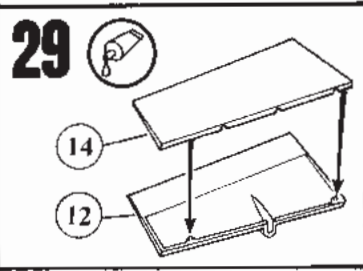
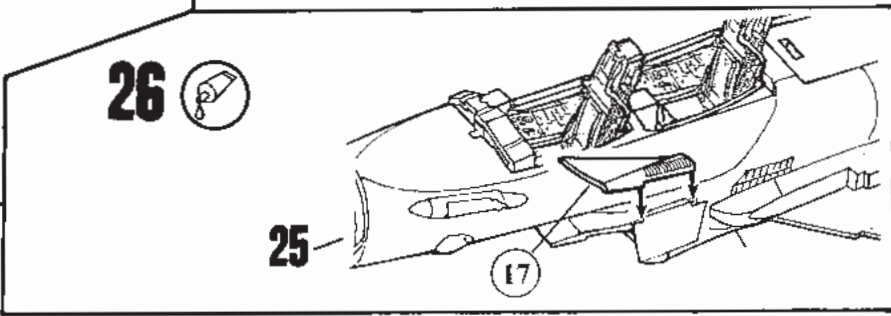
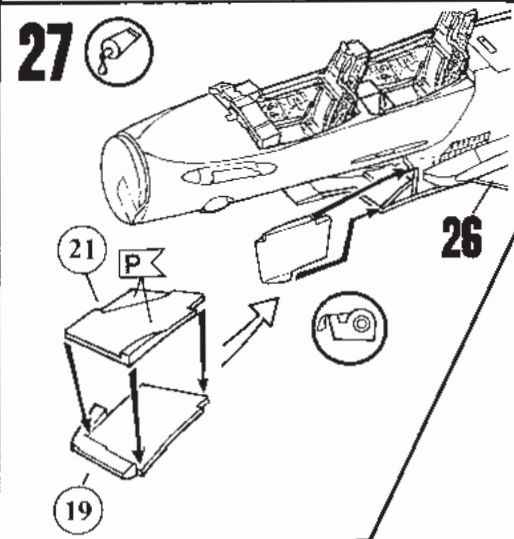
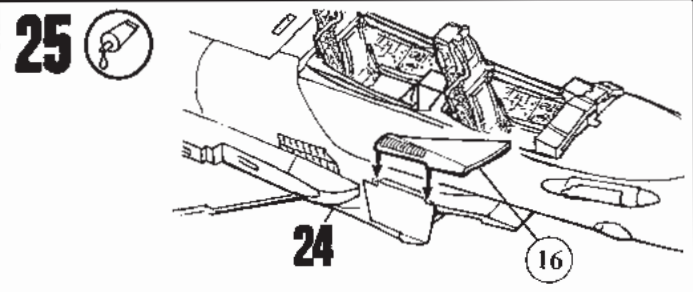
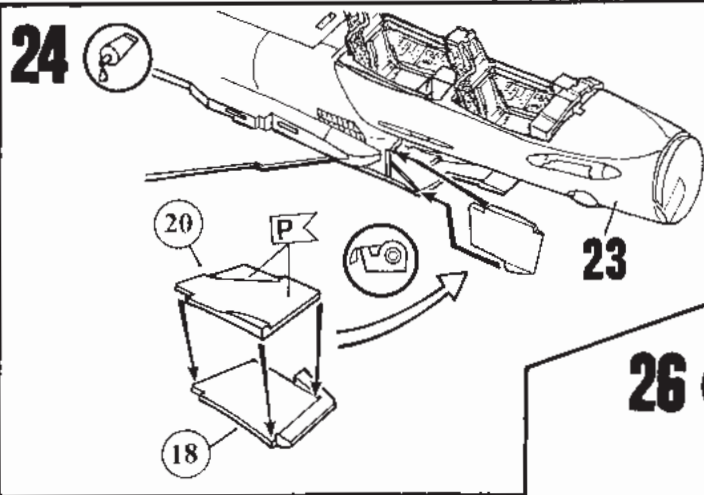

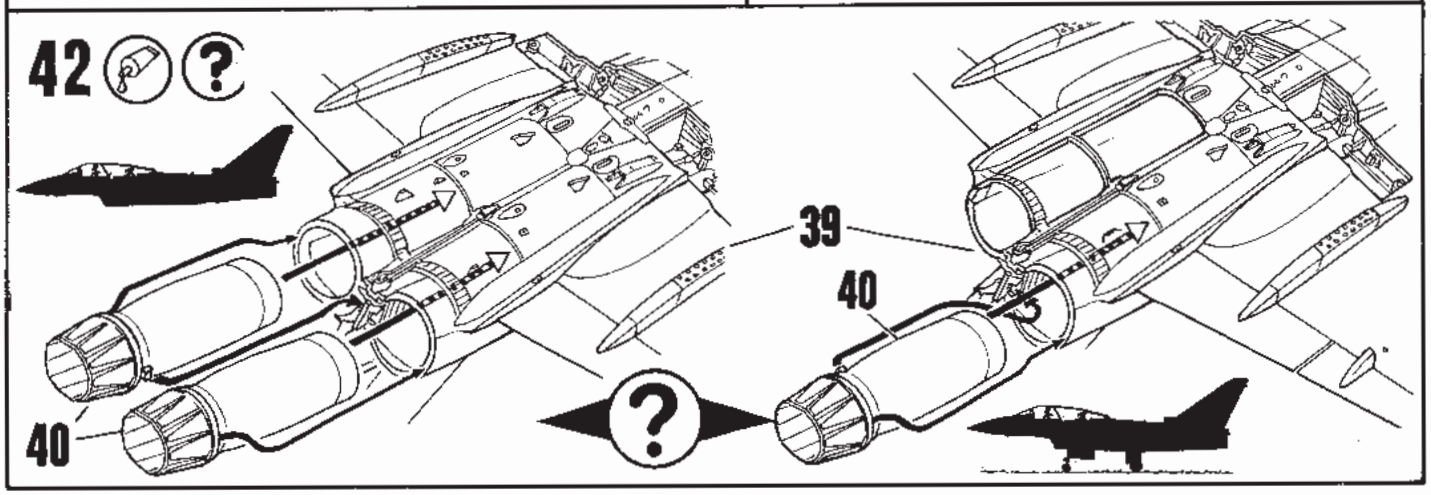
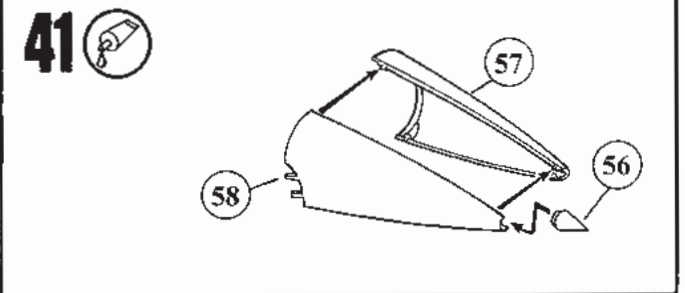
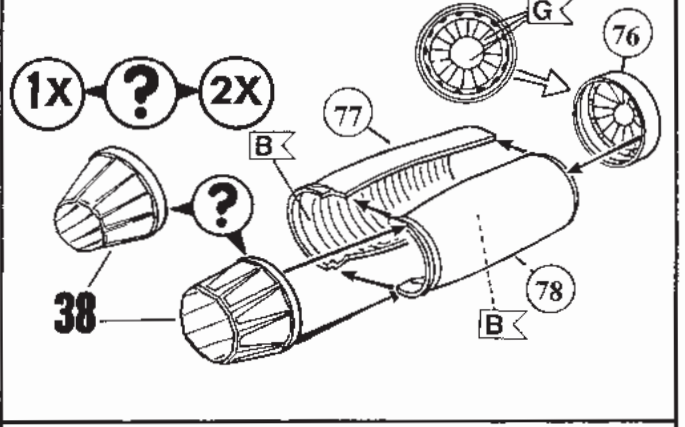
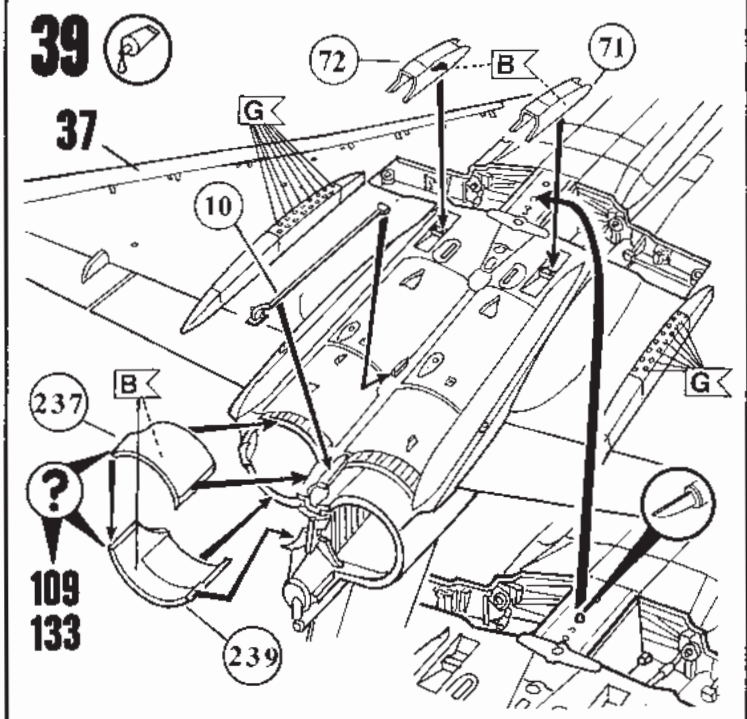
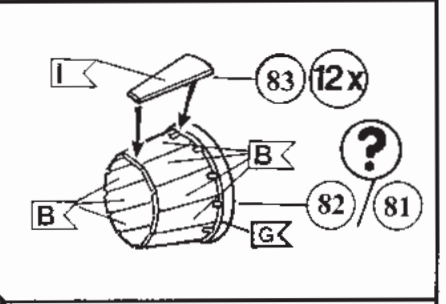
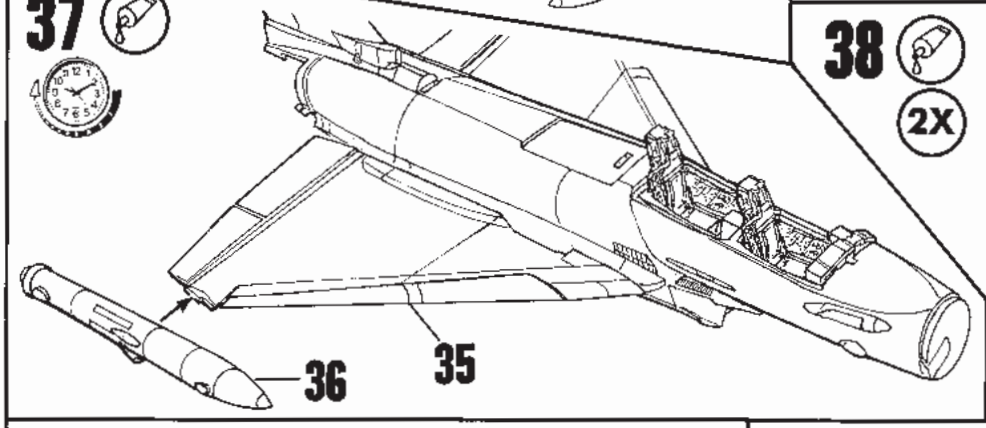
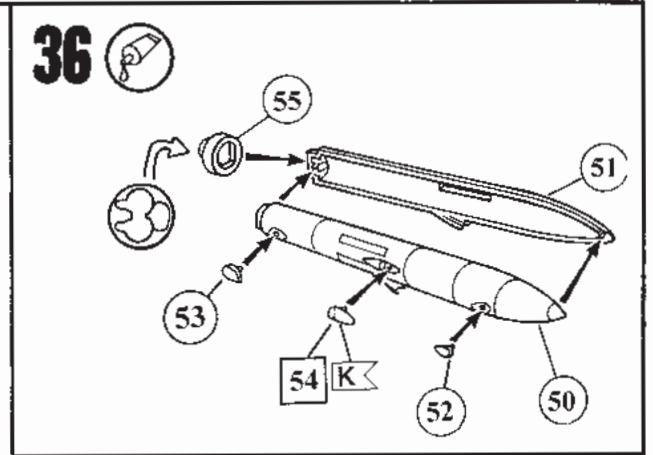
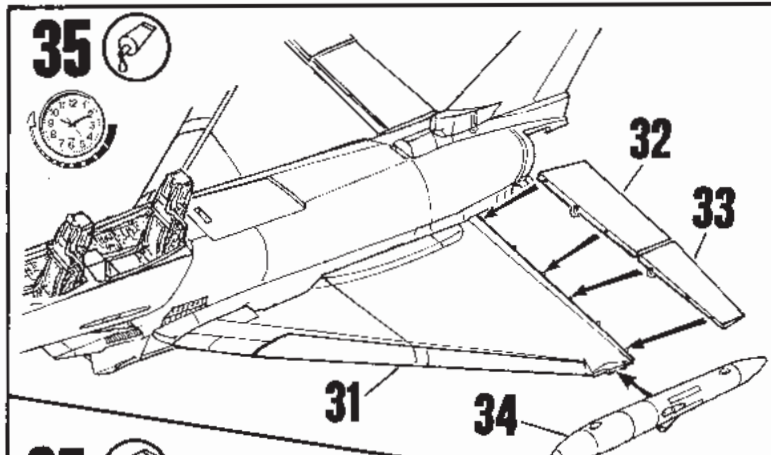

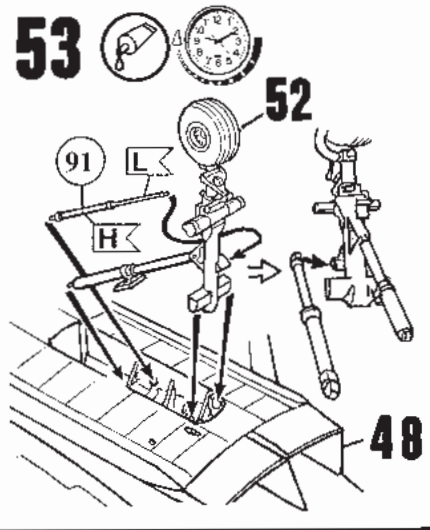
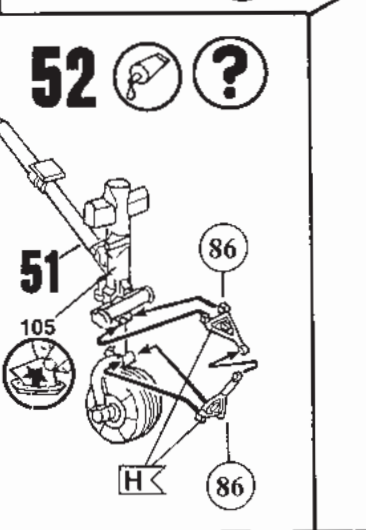
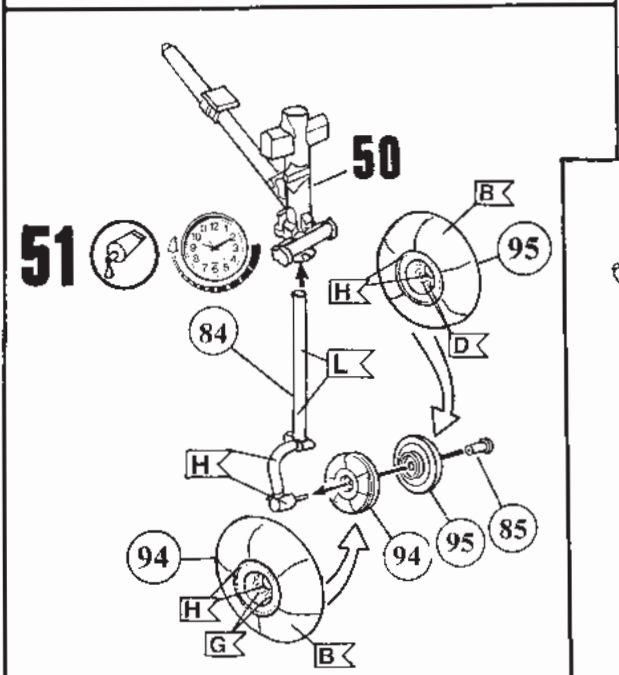
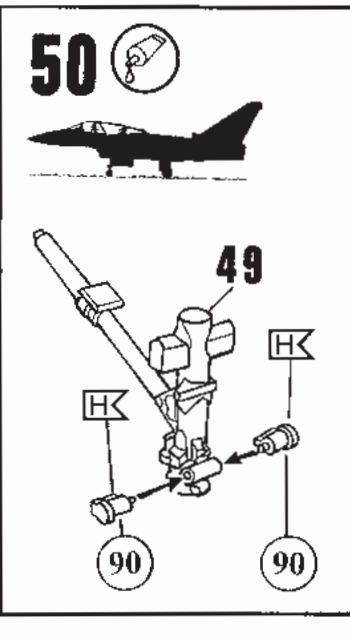
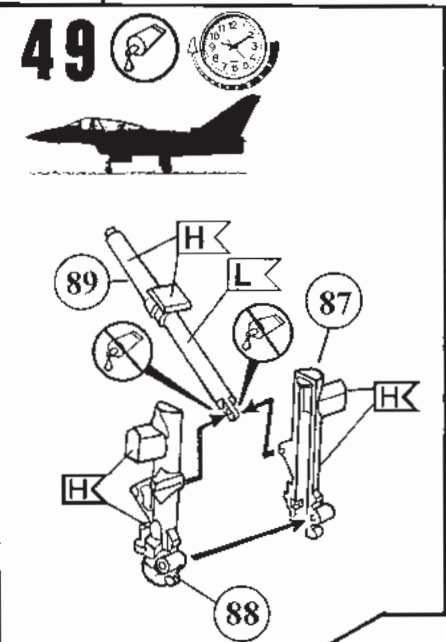
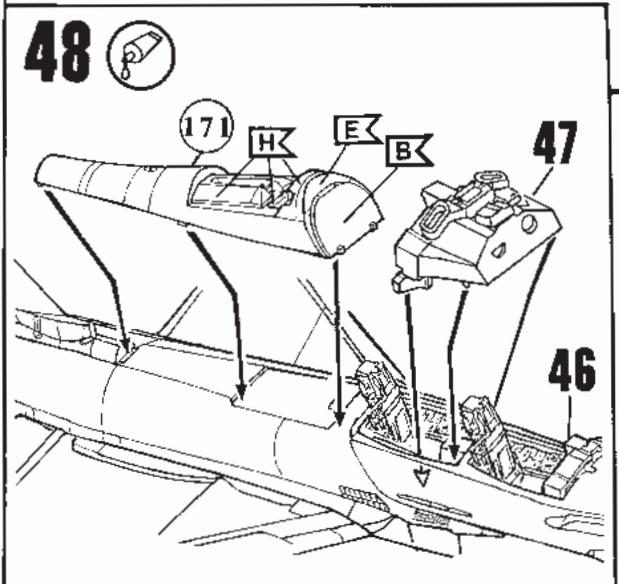
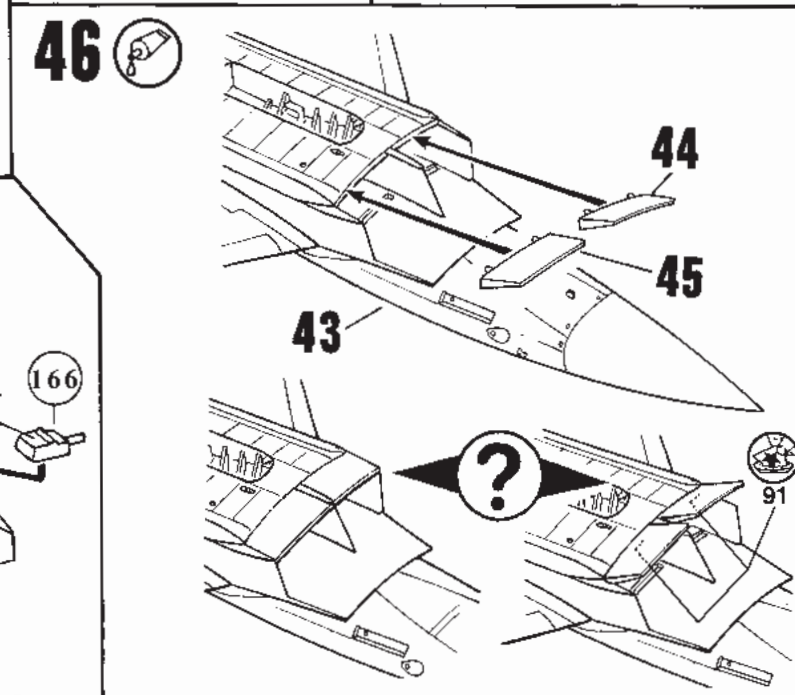
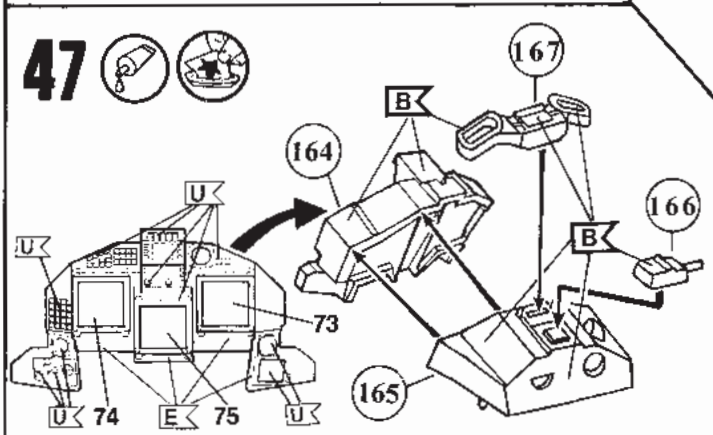
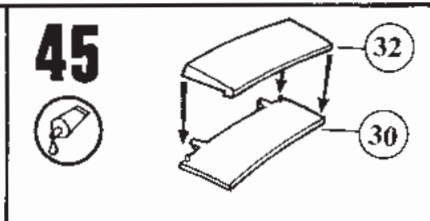
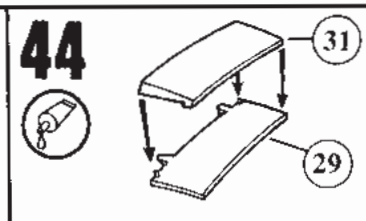
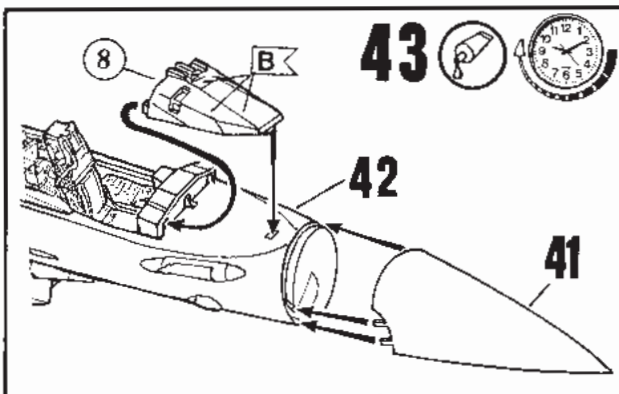

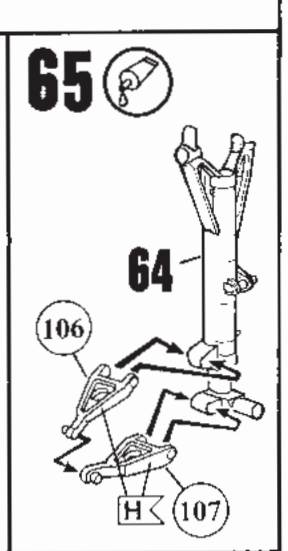
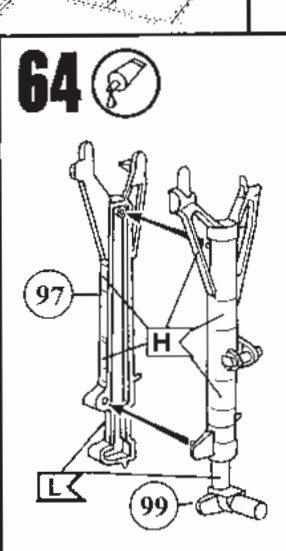
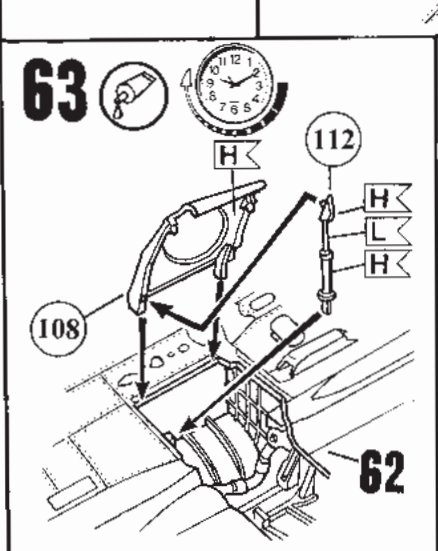
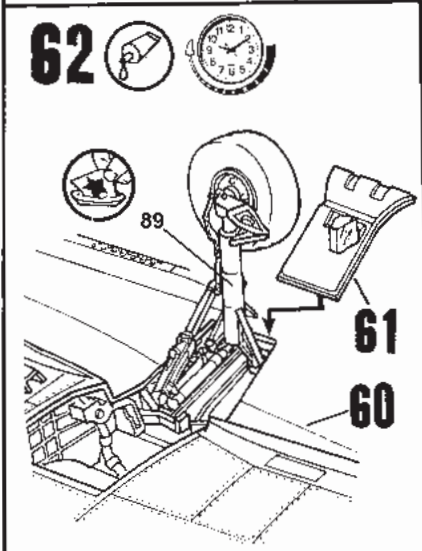
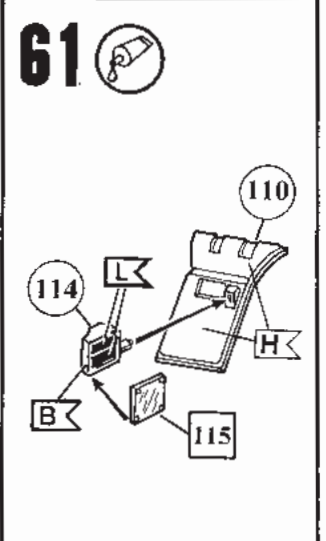
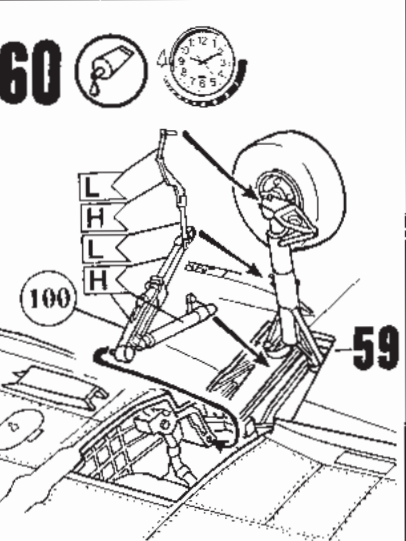
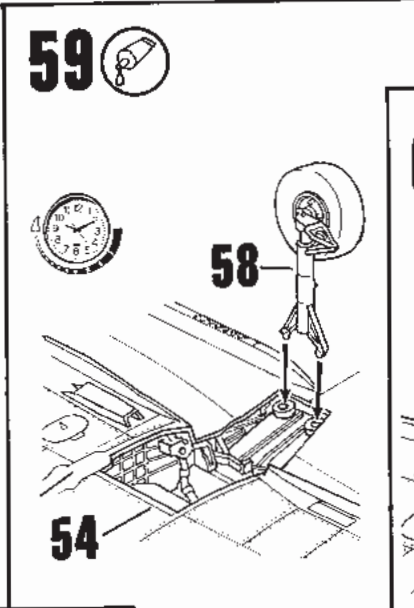
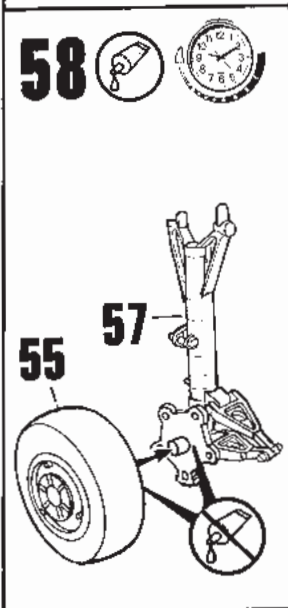
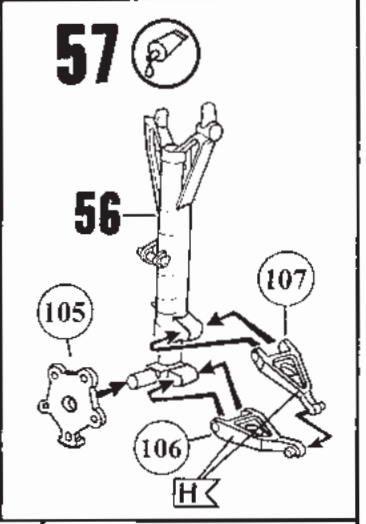
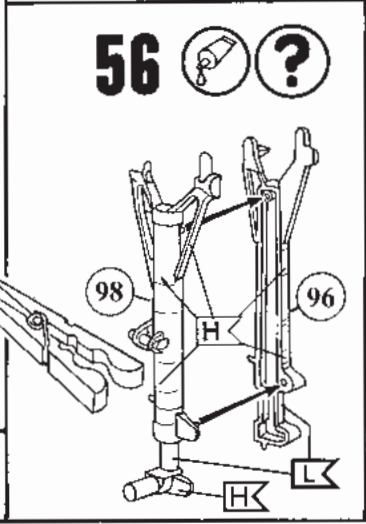
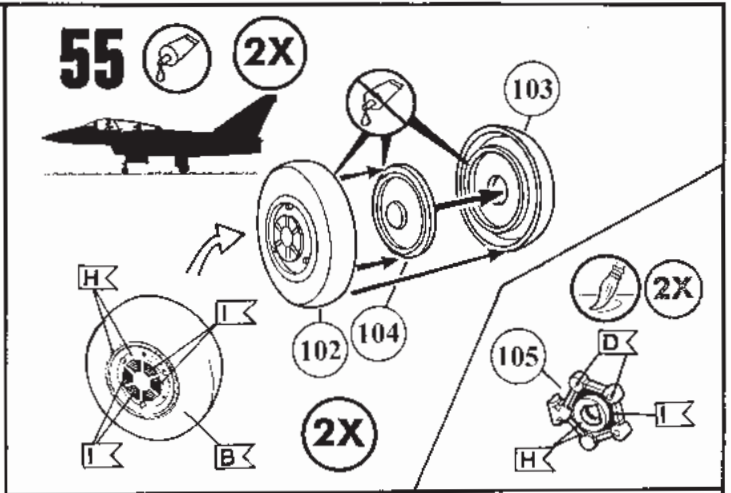
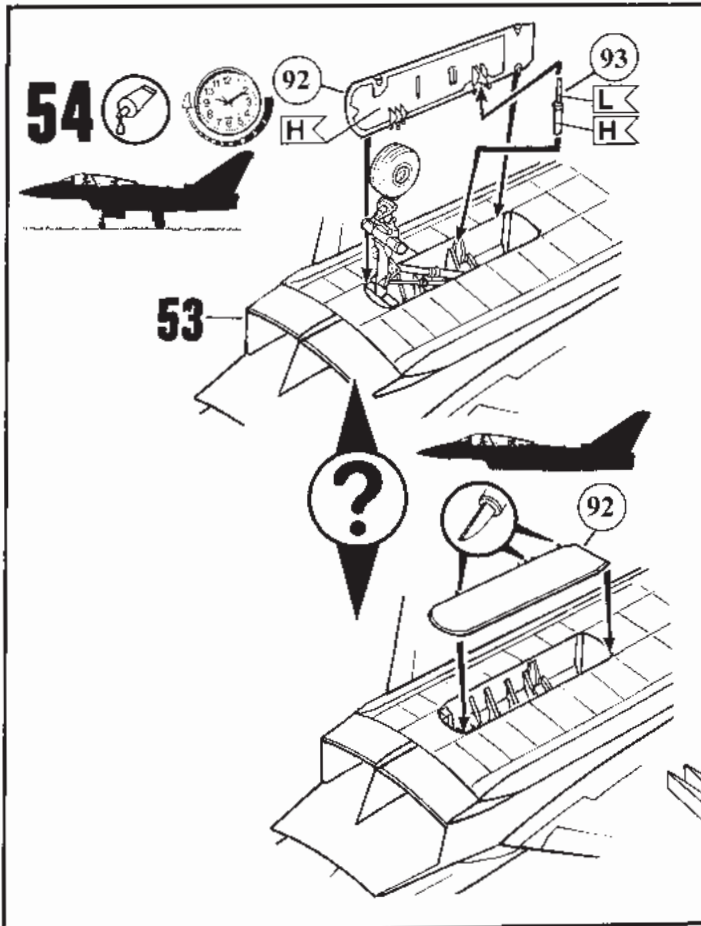

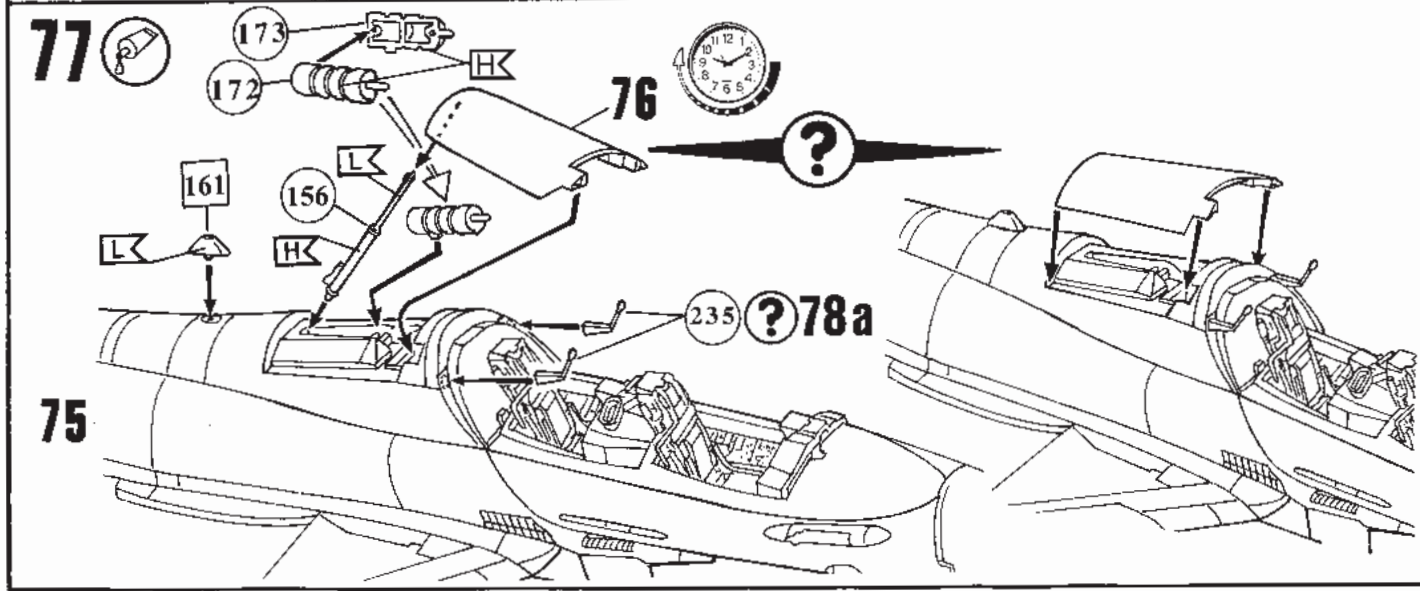
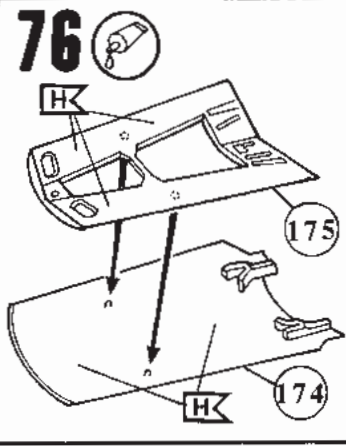
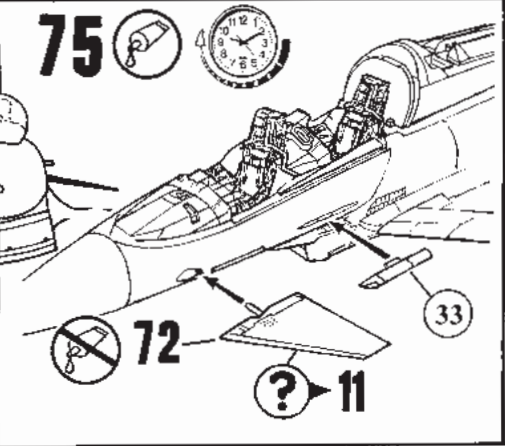
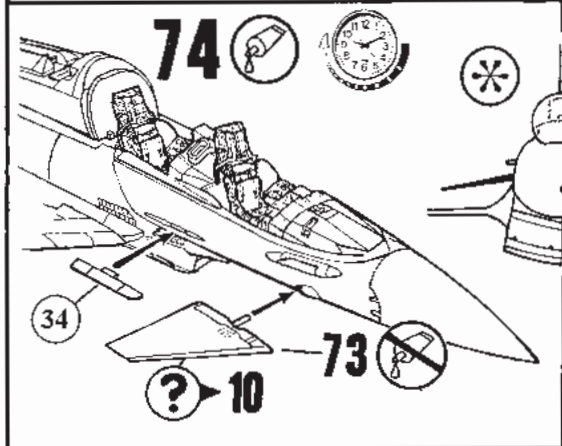
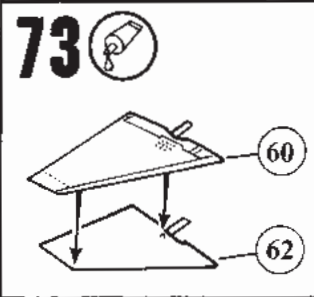
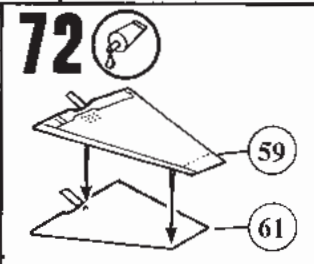
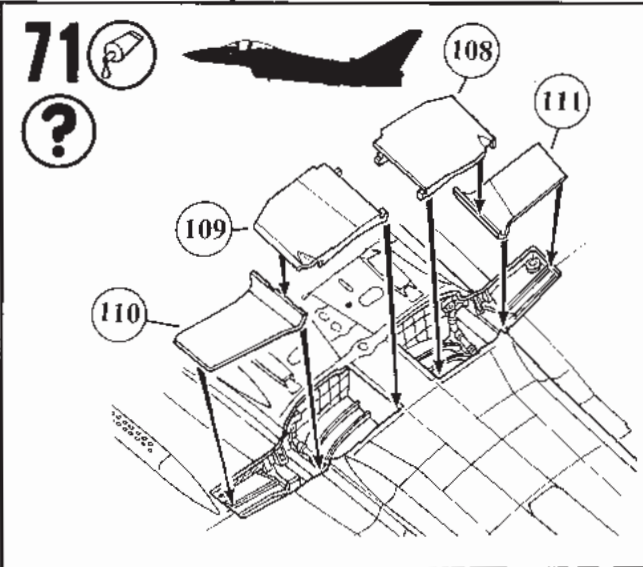
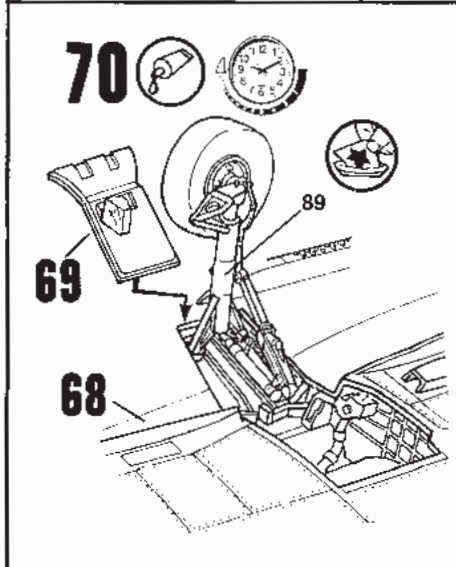
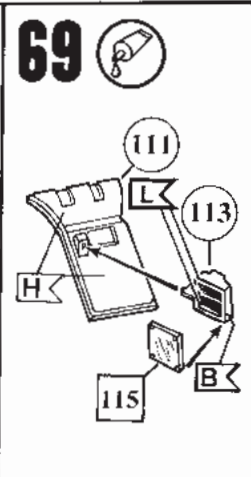
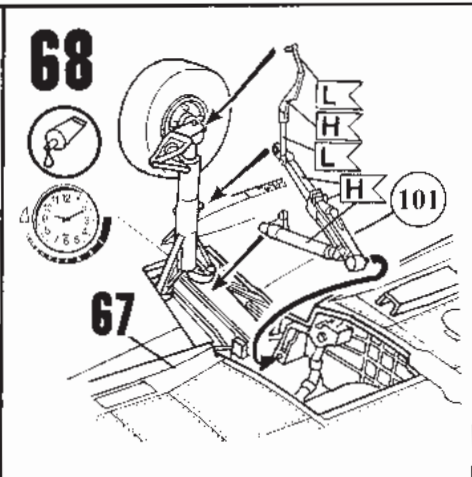
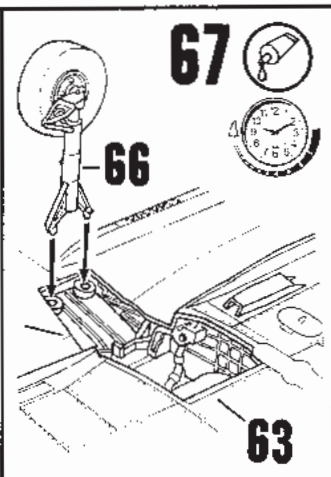
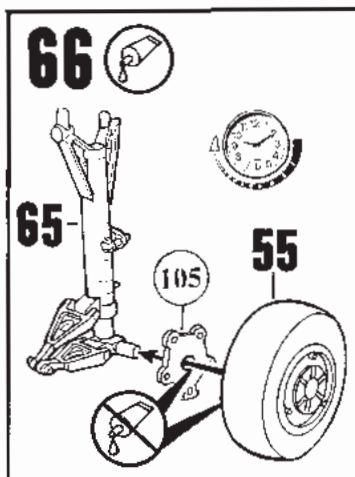

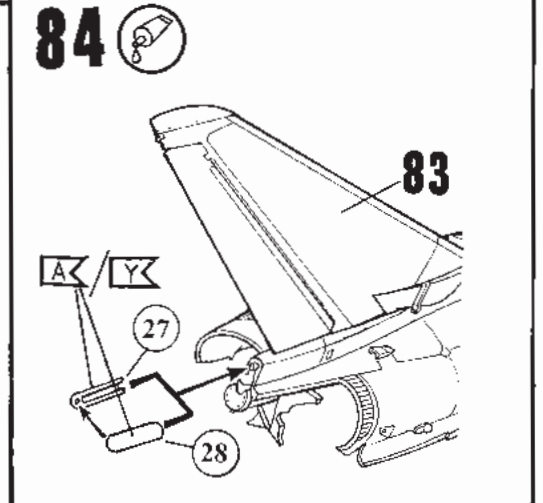
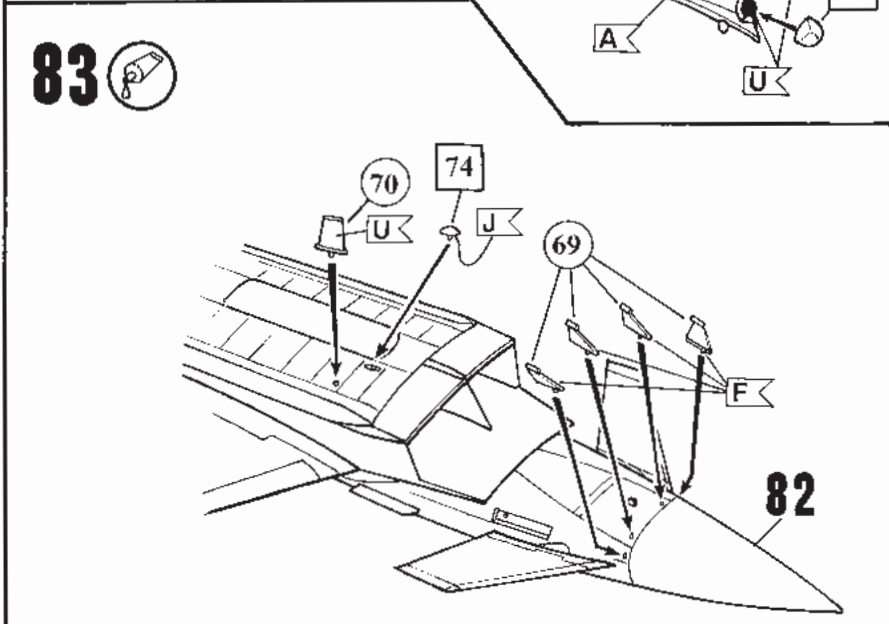
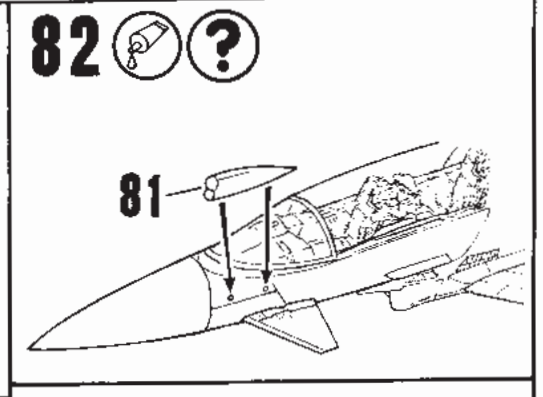
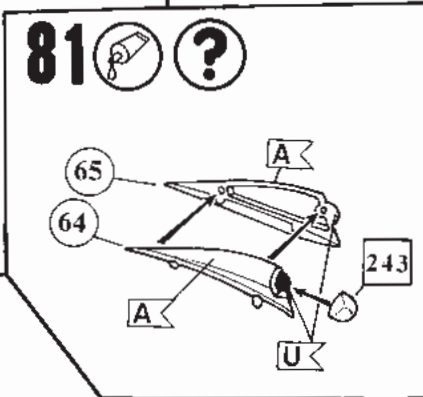
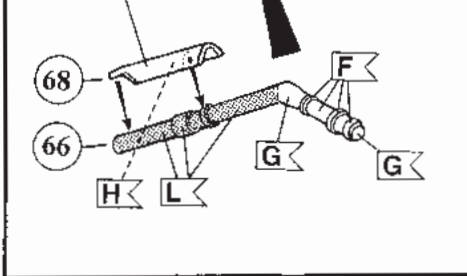
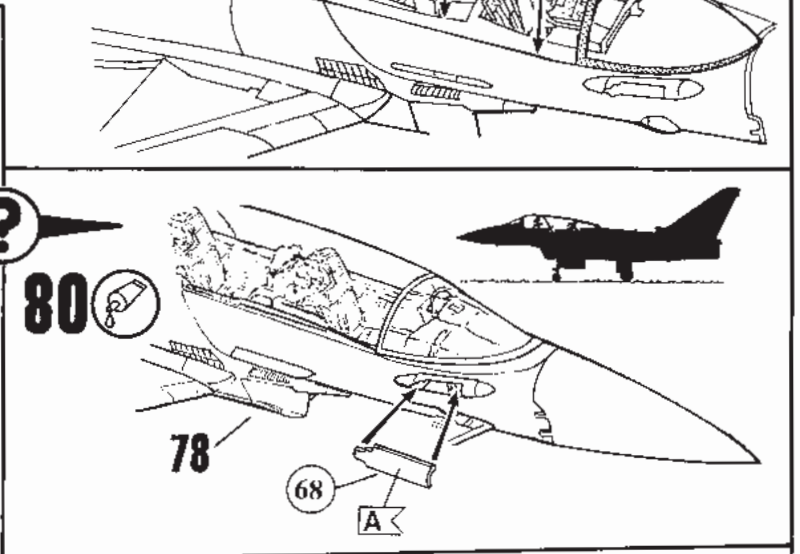
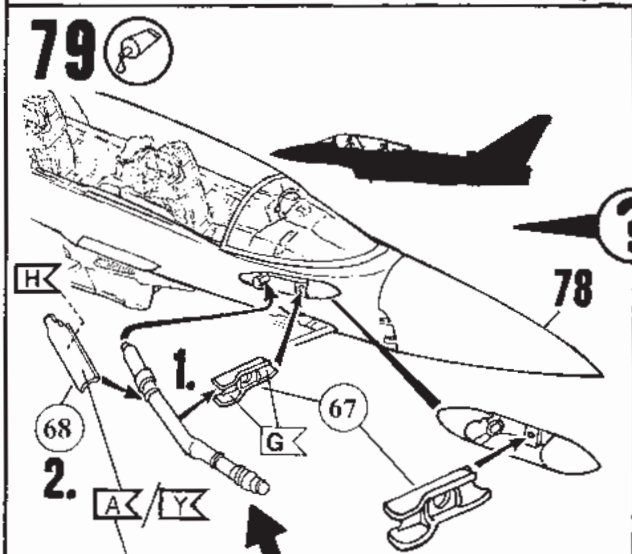
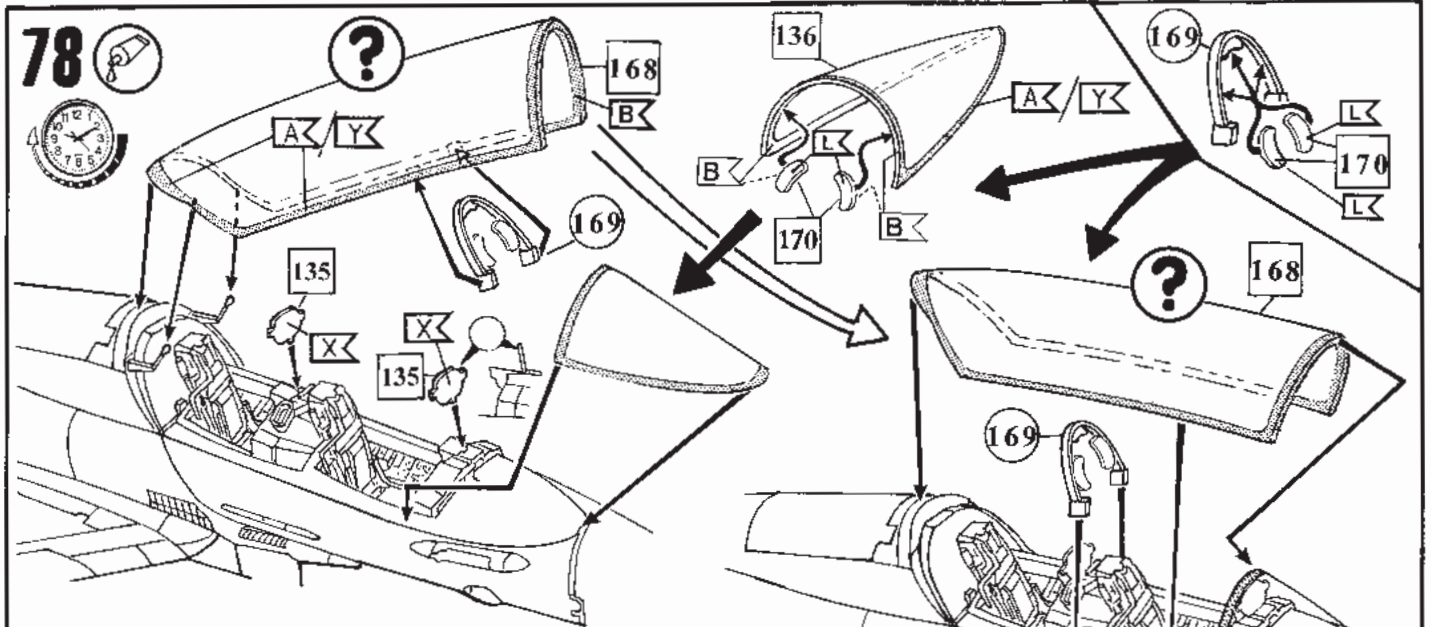

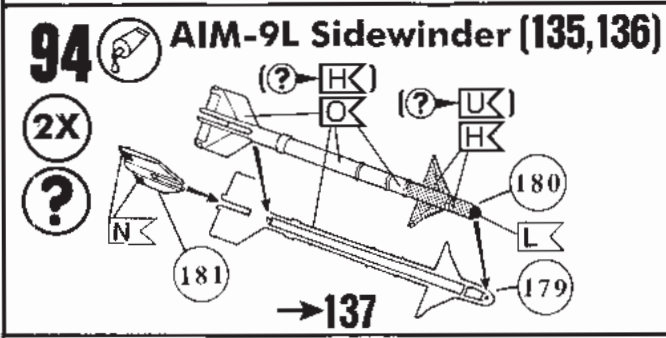
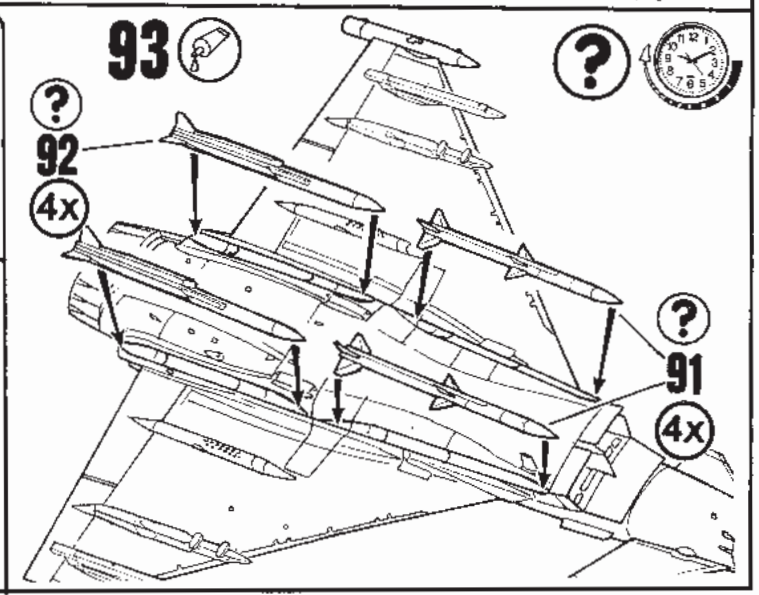
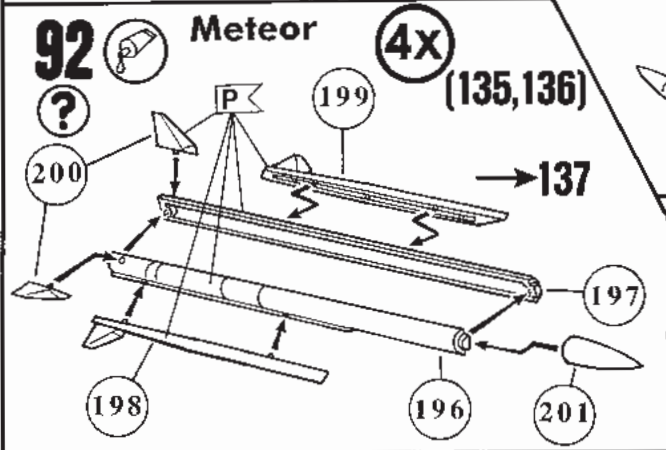
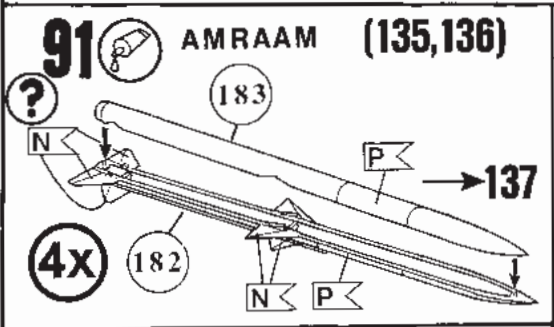
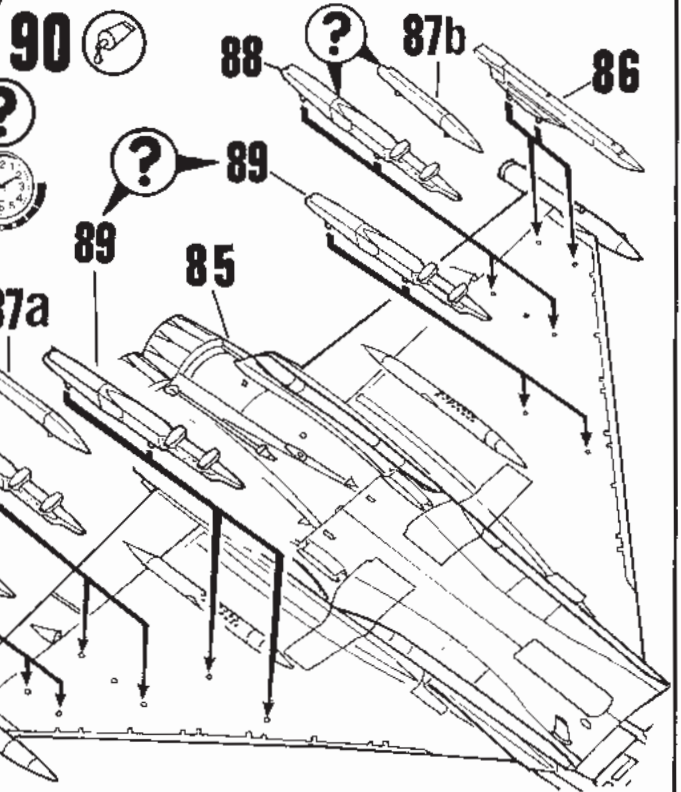
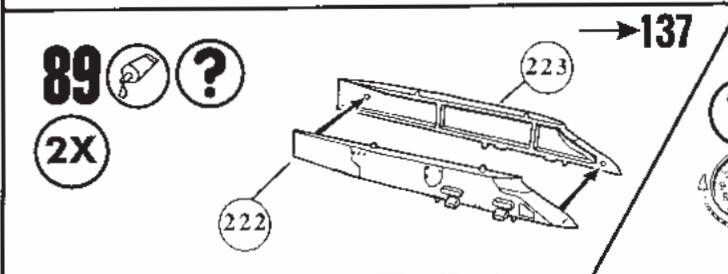
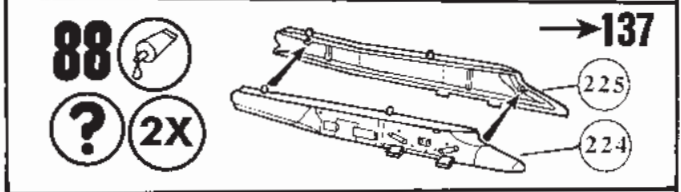
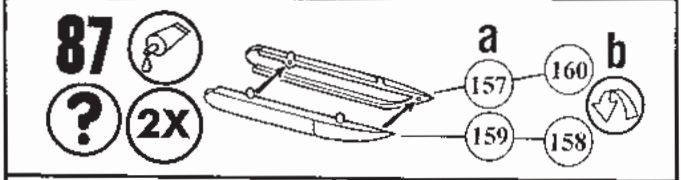
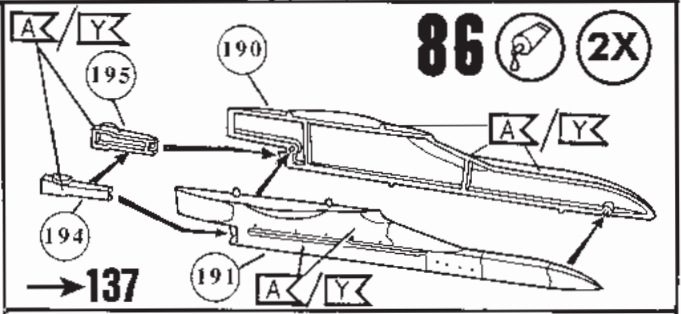
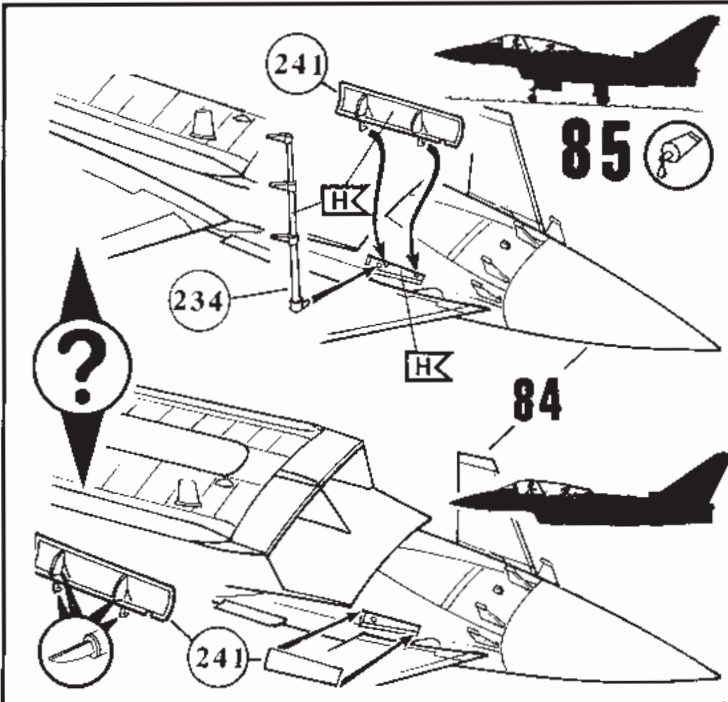

95 (2X) (?) (1X)

1000L TANK (135,136)

(?)

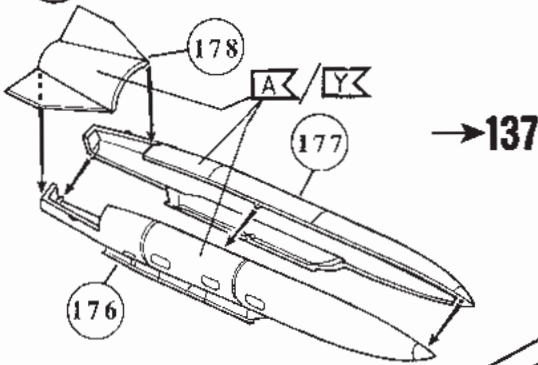

96 (2X) (?)

IRIS-T

(135)

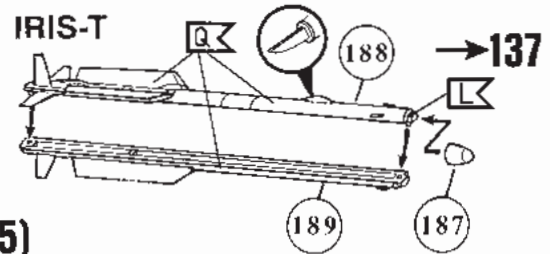

97 (2X) (?)

(?)

95

(?)

96

(?)

95

(?)

96

(?)

95

(?)

96

(?)

95

(?)

96

(?)

95

(?)

96

(?)

95

(?)

96

(?)

95

(?)

96

(?)

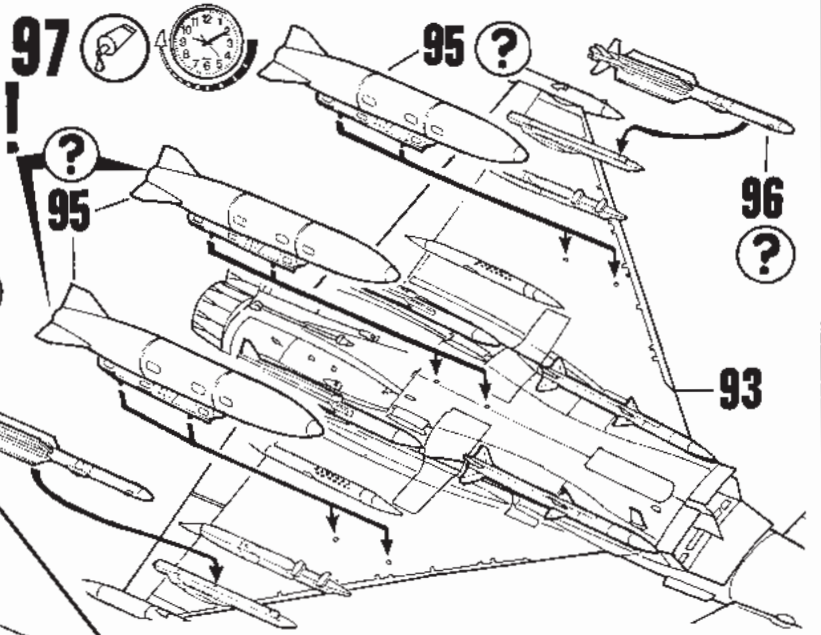

98 (2X) (?)

GBU-24B

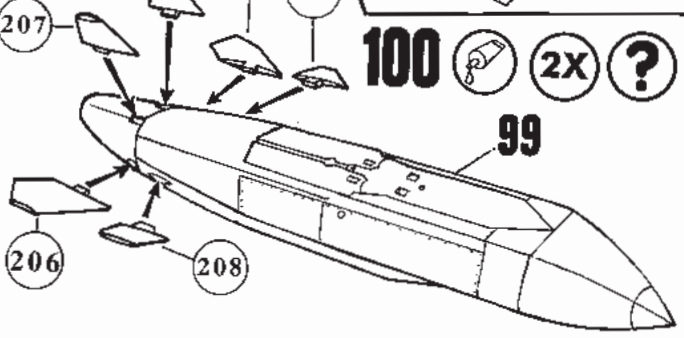
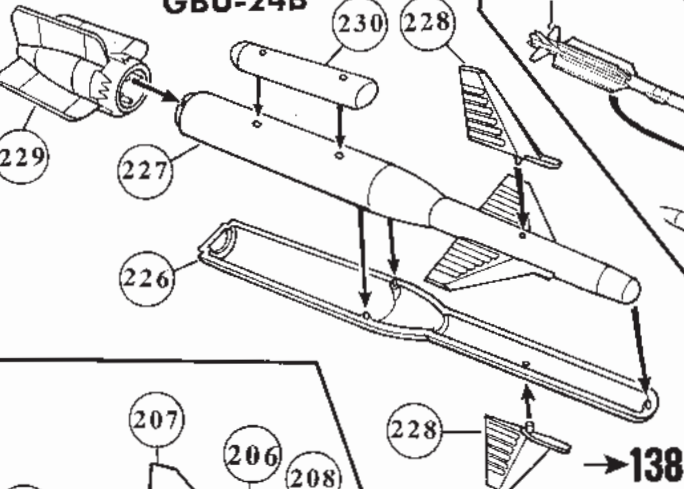

100 (2X) (?)

99

99 (2X) (?)

(136)

Stormshadow

→138

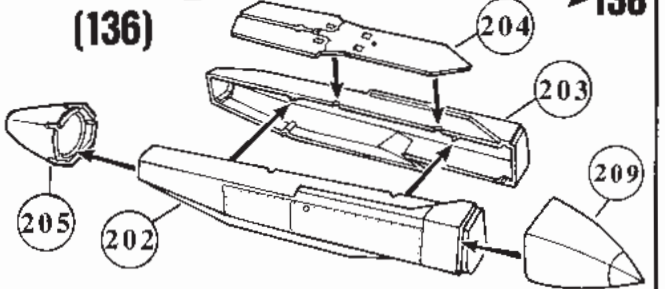

101 (2X) (?) Taurus Pod

(135)

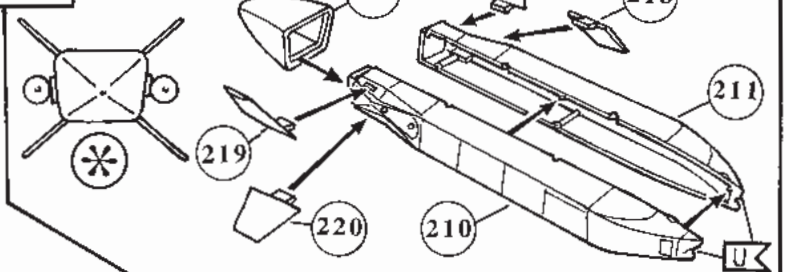

102 (?)

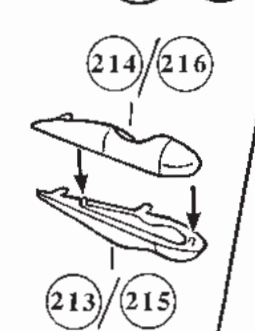

103 (2X) (?)

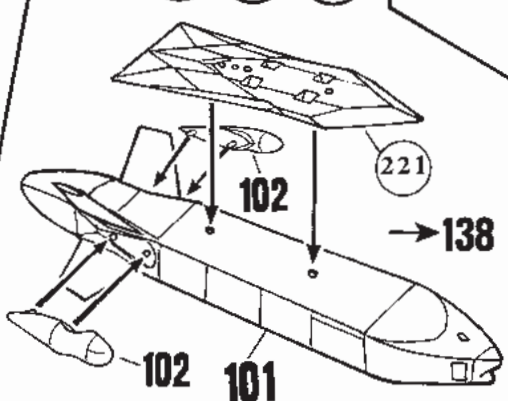

104 (?) German Recce Pod

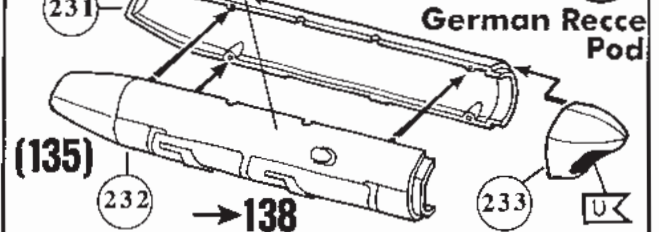

105 (136) P 185 186 184 L
 ? 2X ?
 AIM-132 ASRAAM
 → 137

106 ? ?
 RAF

107 ?

240 F 238 F 16

108 ? ? ?
 German A.F.

109 ? ?

94 96 104 103 106 107

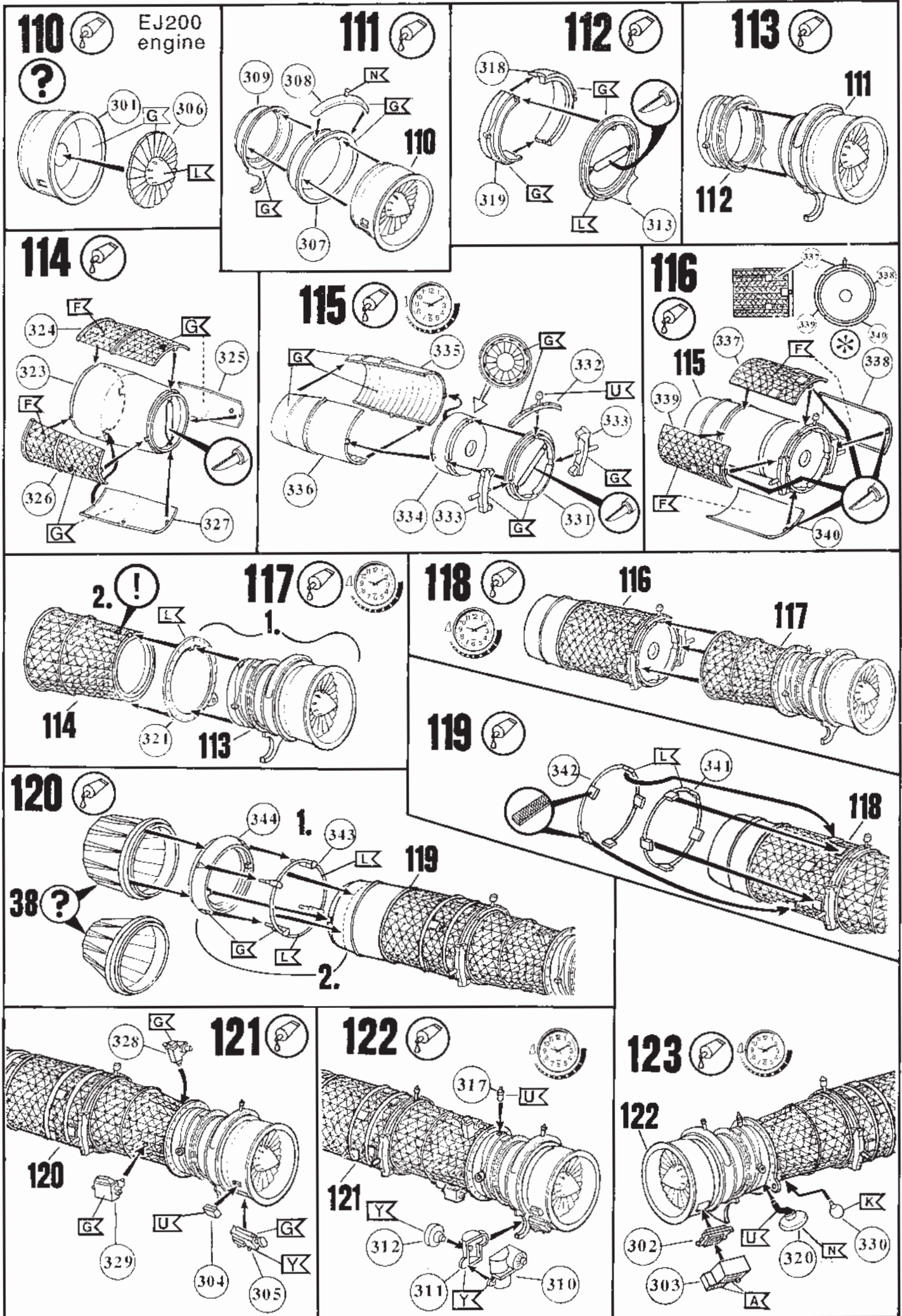

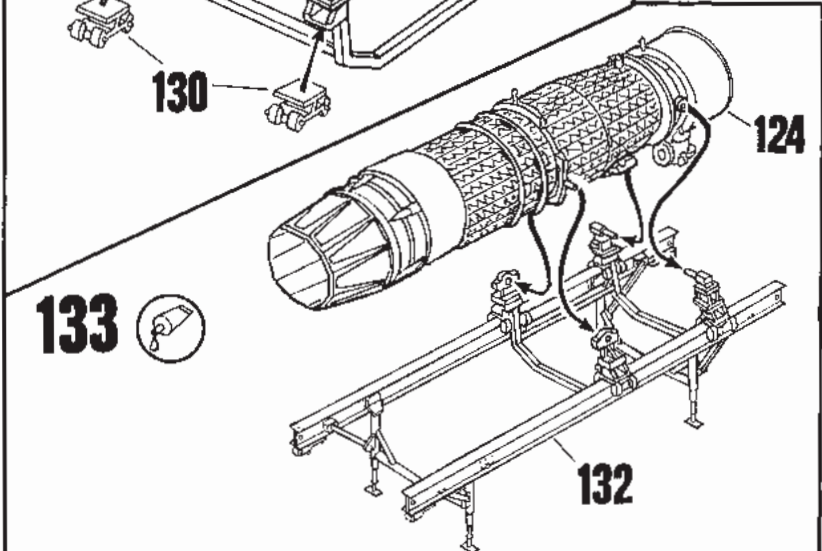
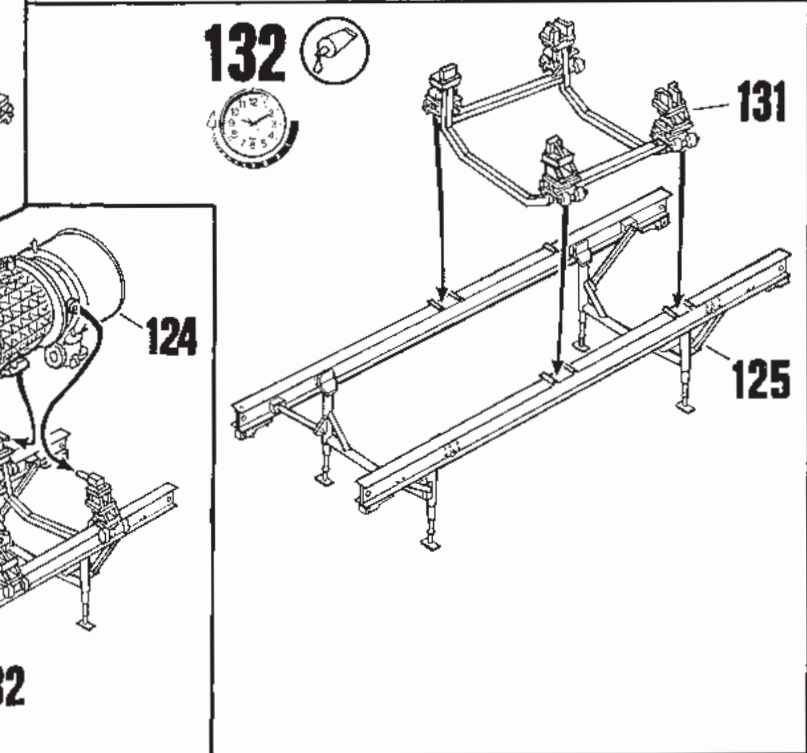
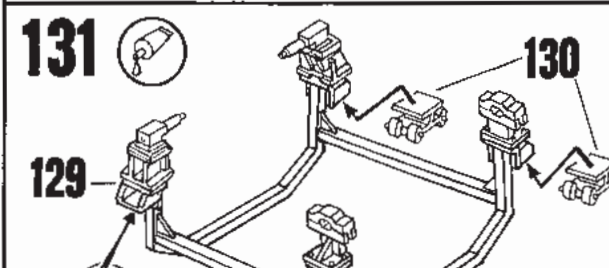
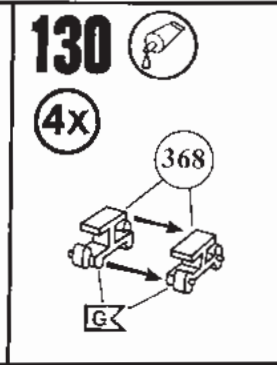
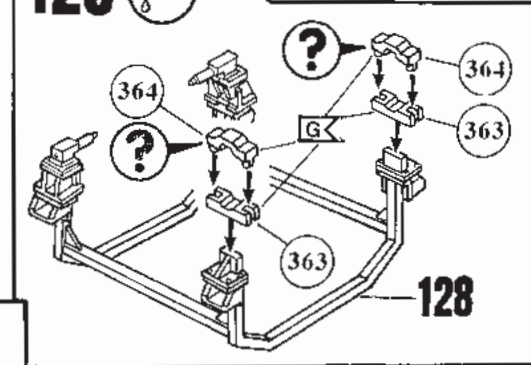
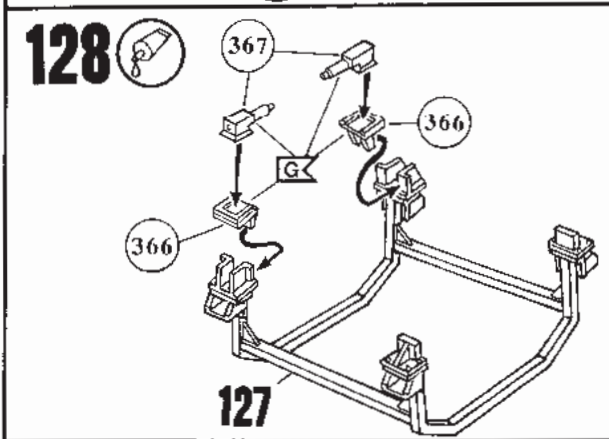
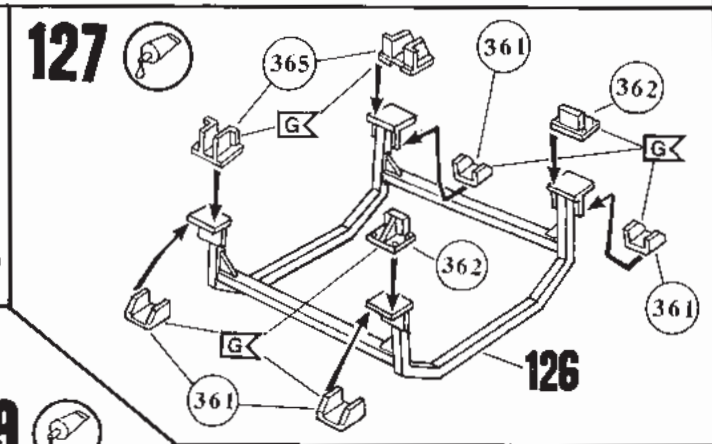
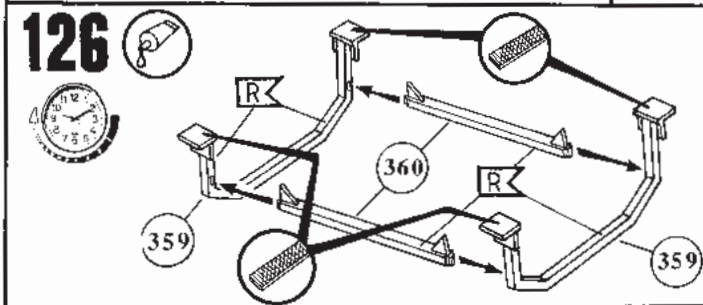
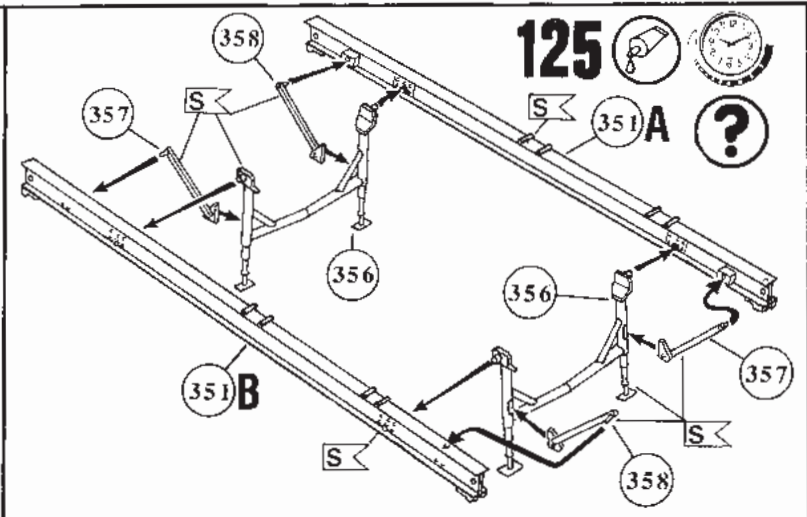
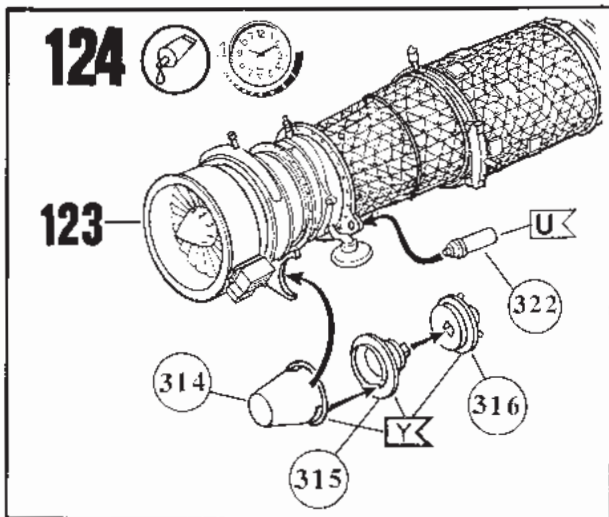

Eurofighter Typhoon - Common to both versions

134

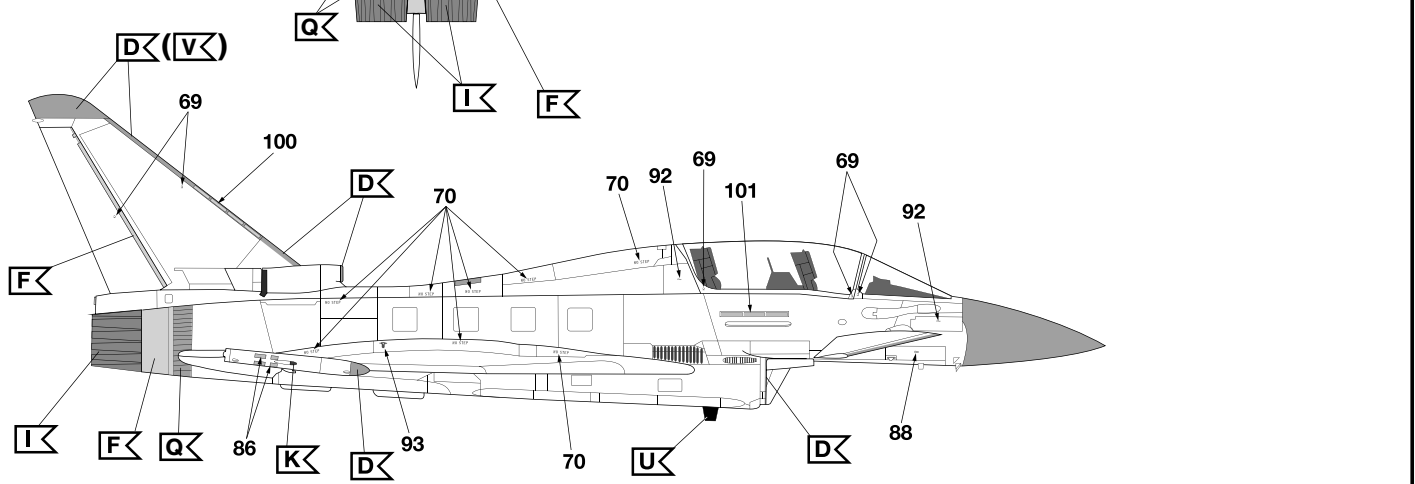
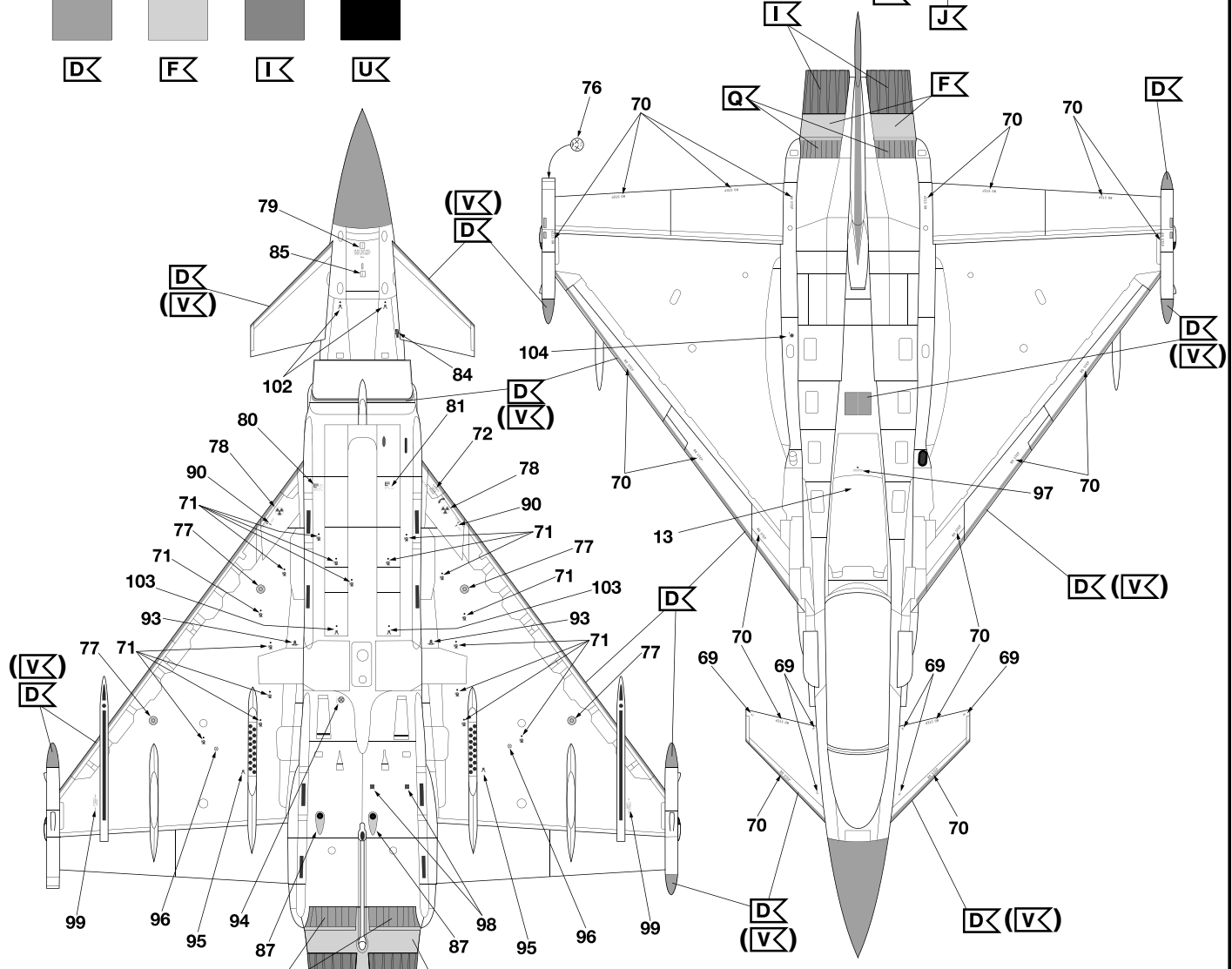
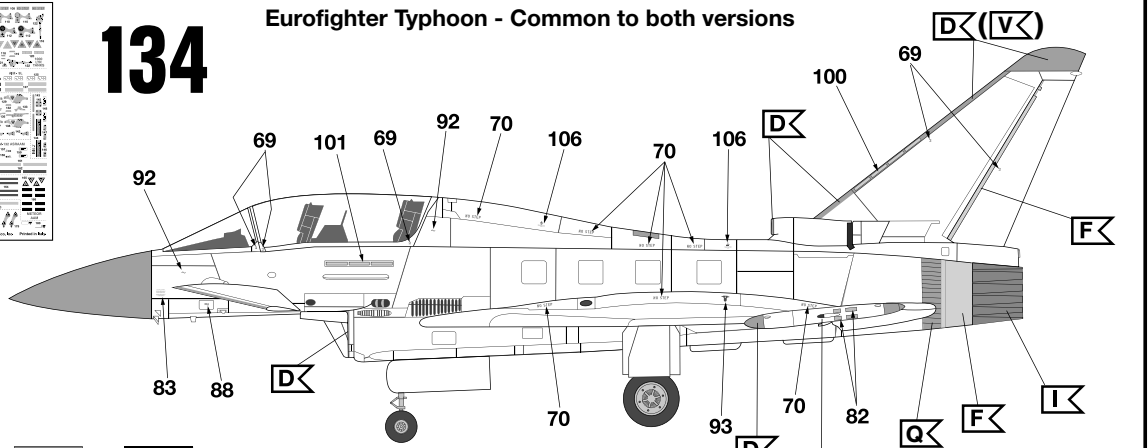
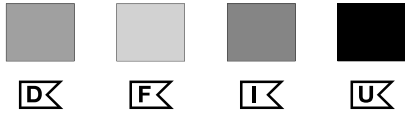
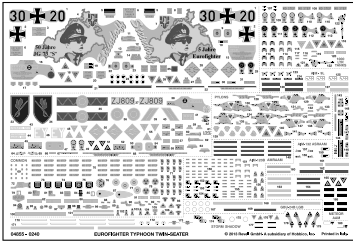

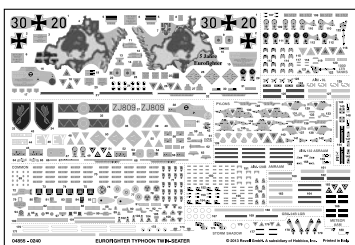

135

Eurofighter, Jagdgeschwader 73 "General Steinhoff", Laage, Germany, July 2009

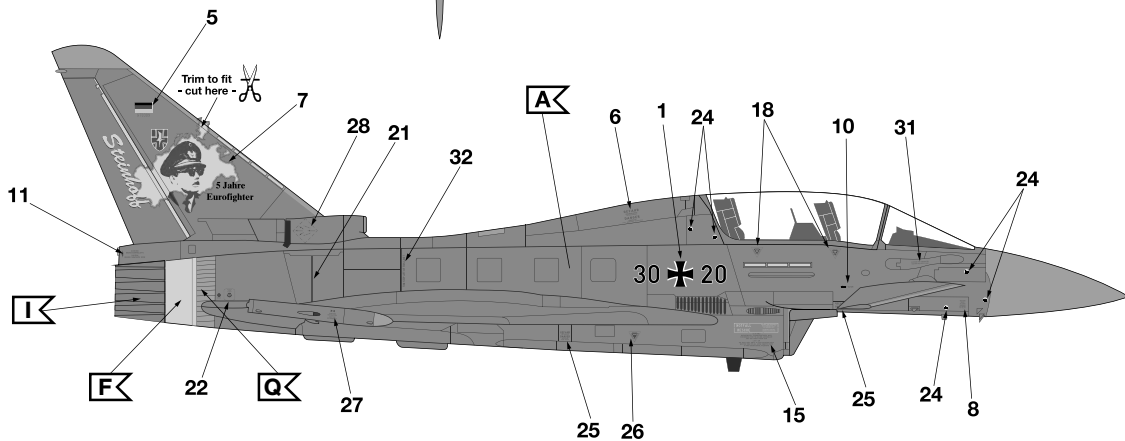
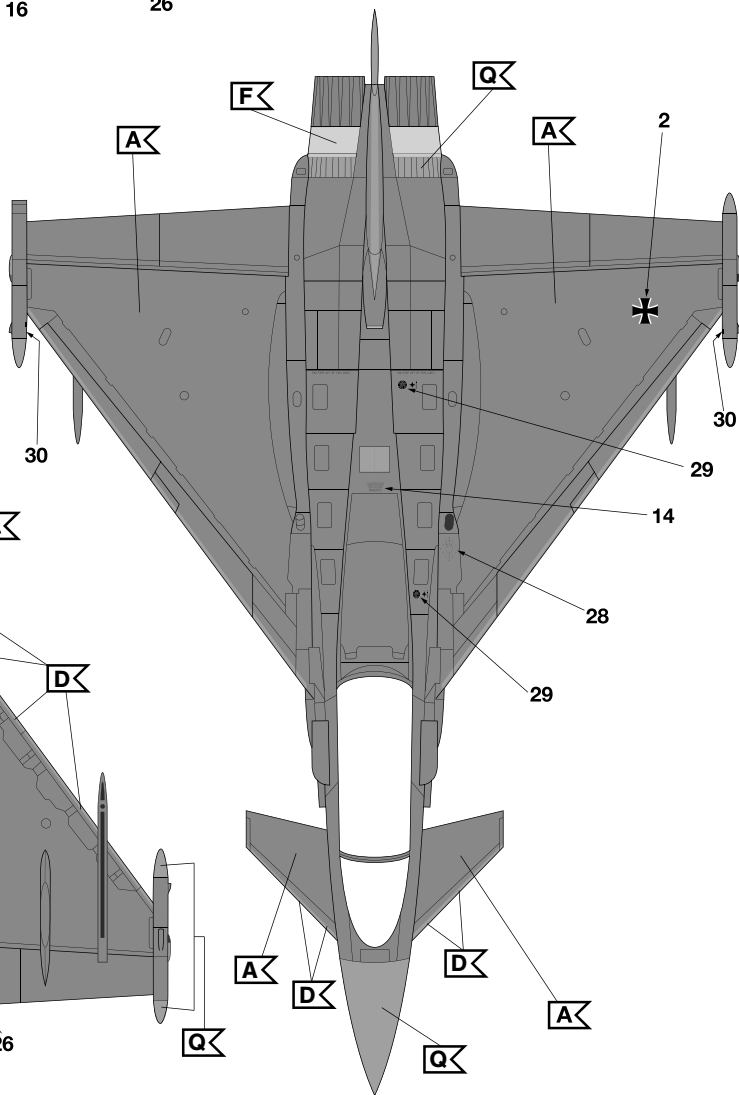
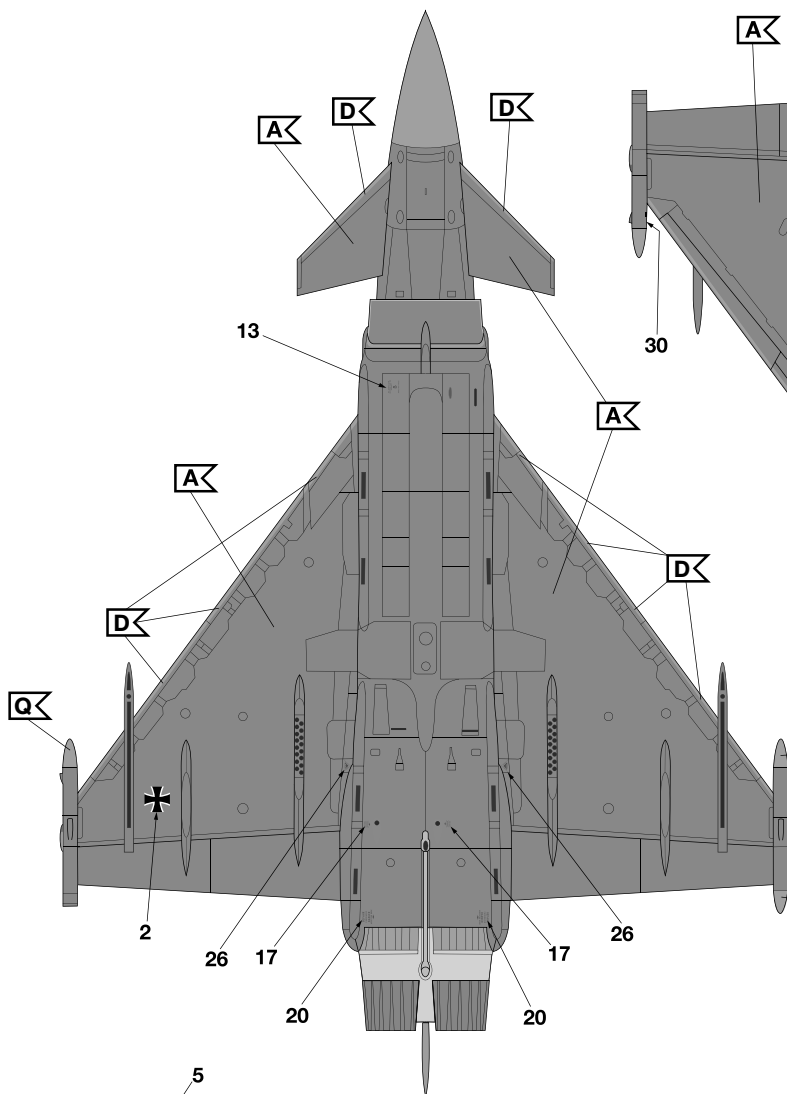
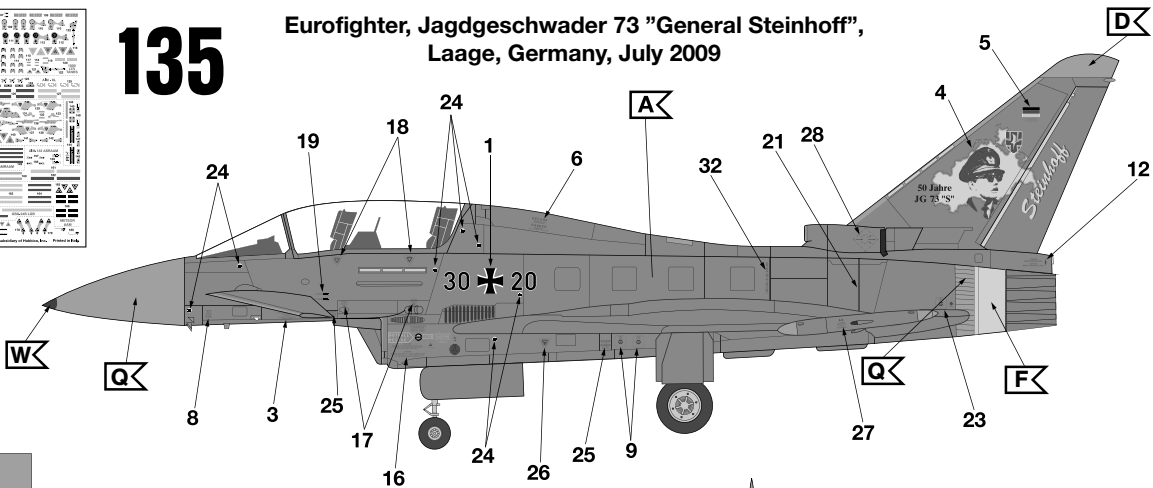
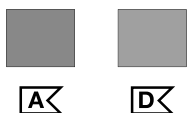

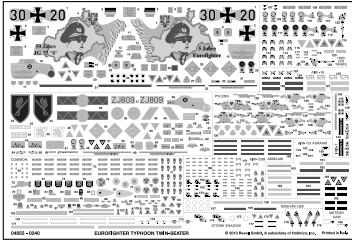

136

Typhoon T.3, No. 6 Squadron, Royal Air Force, Leuchars, Scotland, April 2013



D



Y

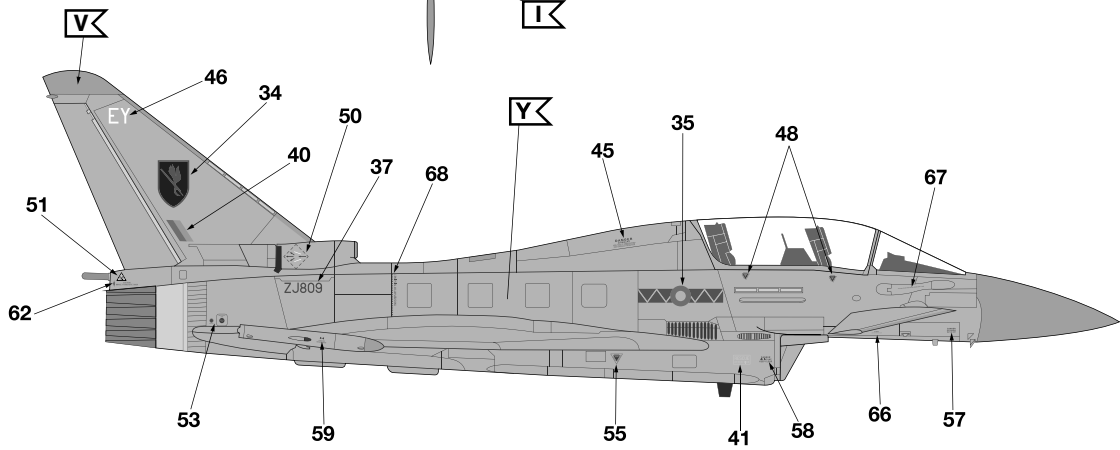
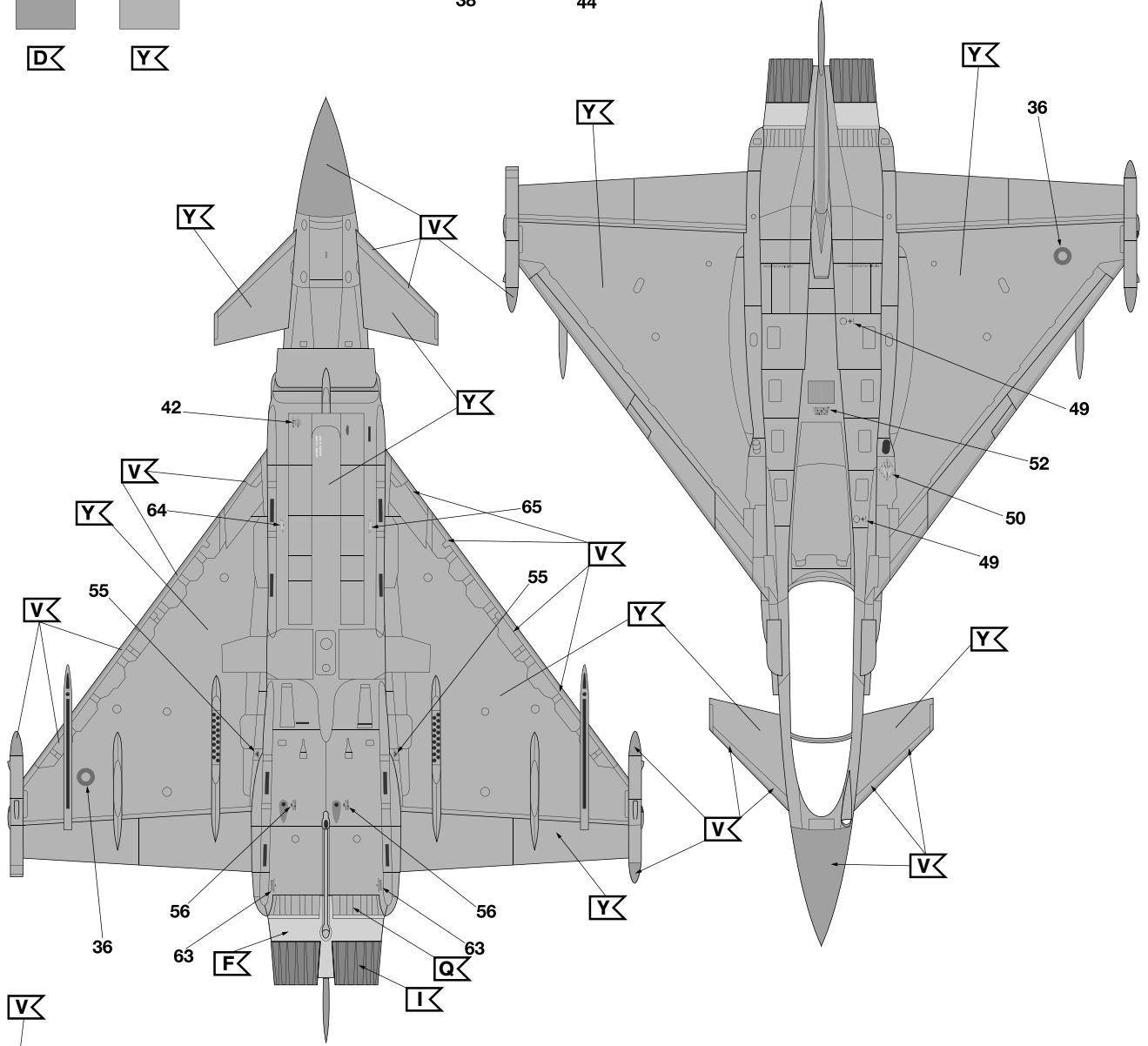
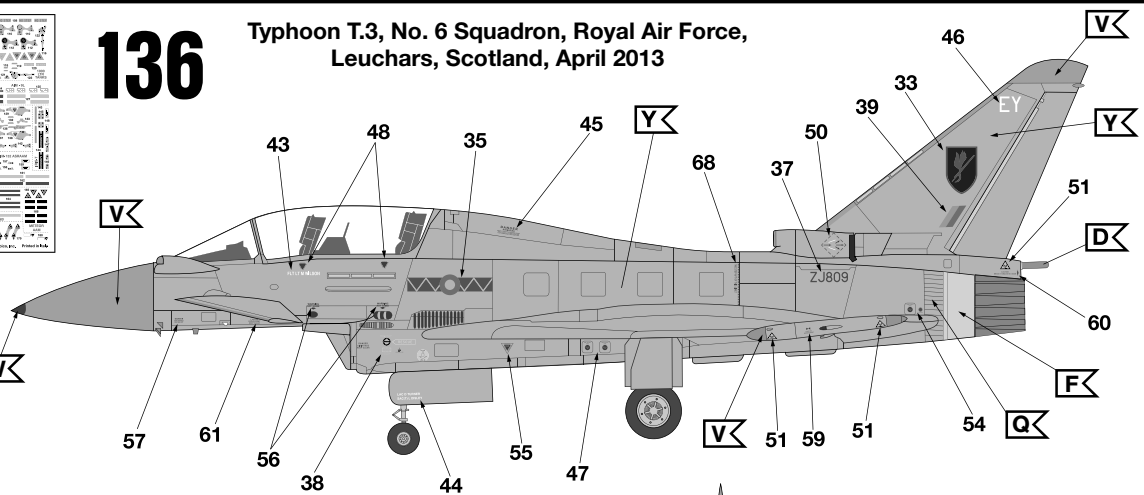

137

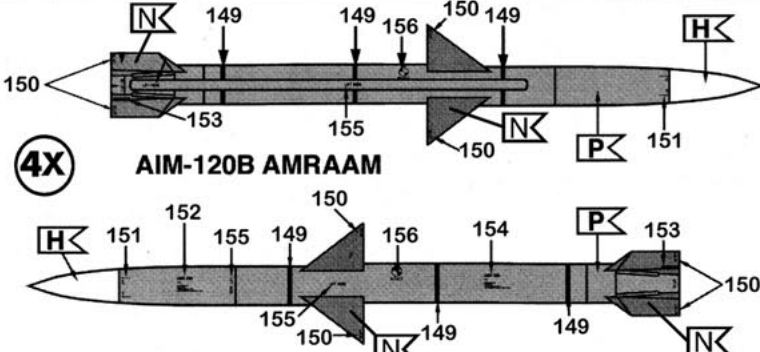
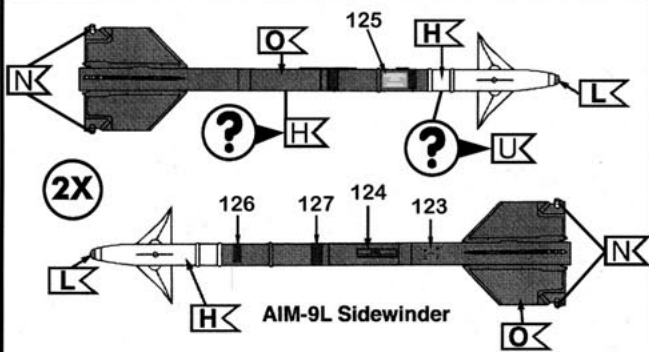
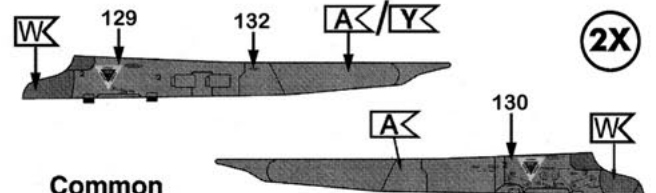
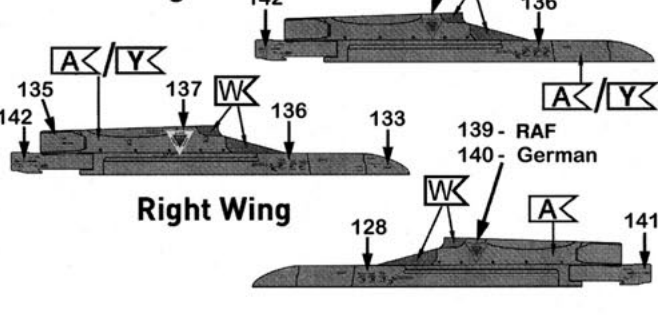
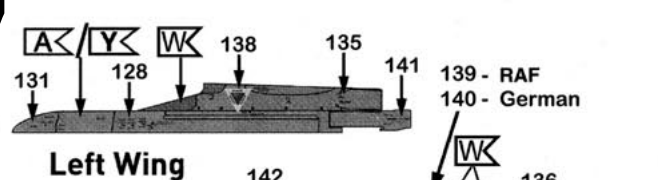
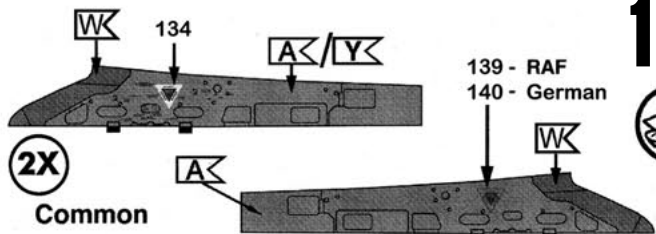

1000 Ltr Tanks - German Air Force

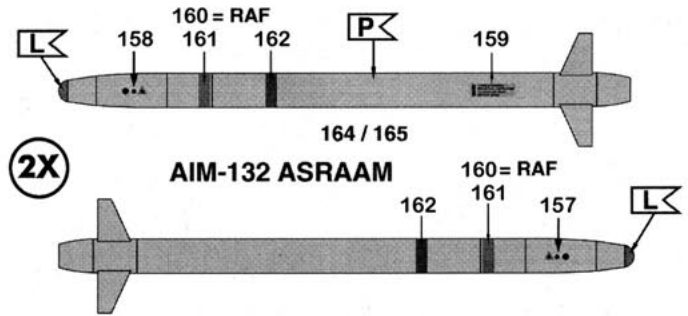
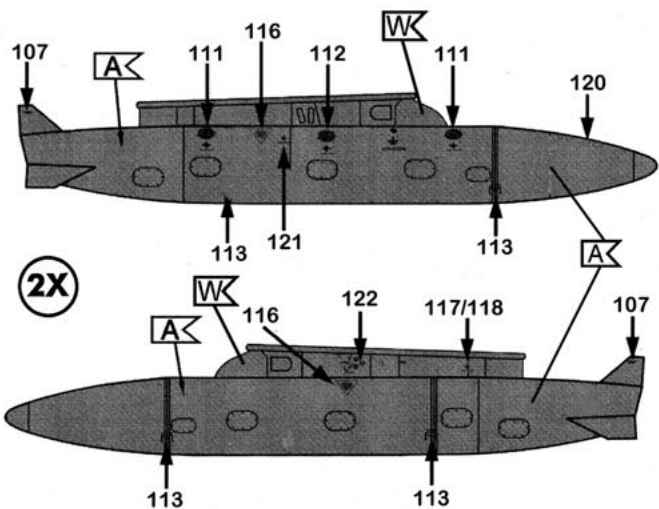

1000 Ltr Tanks - Royal Air Force

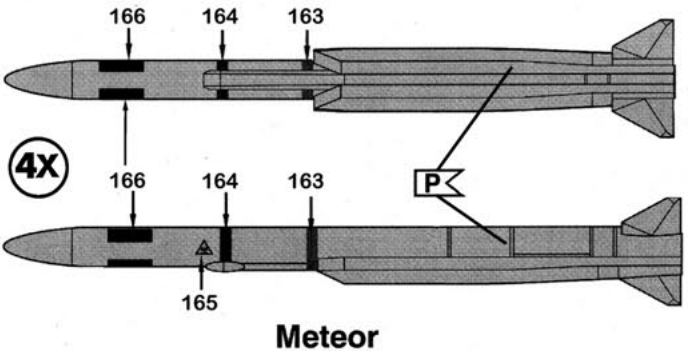
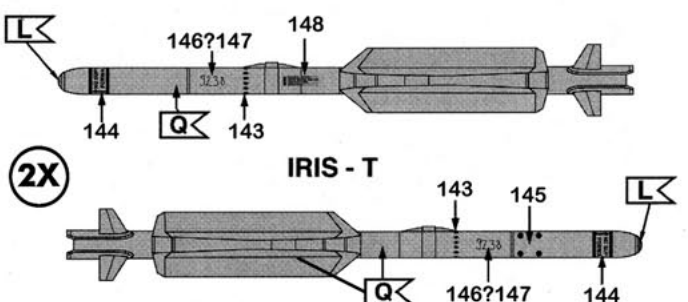
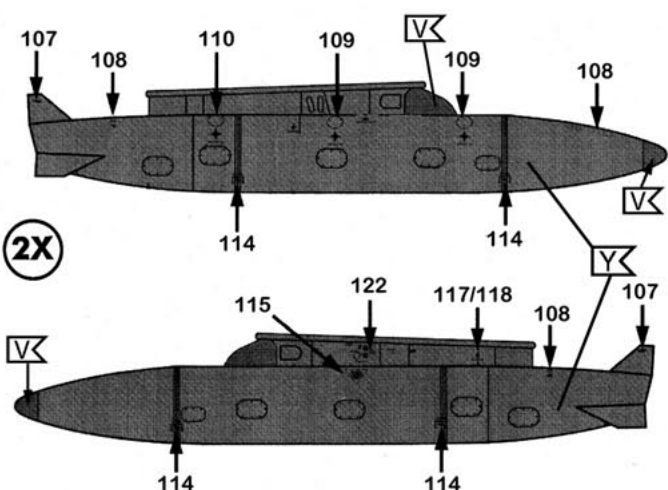

138



German Recce Pod

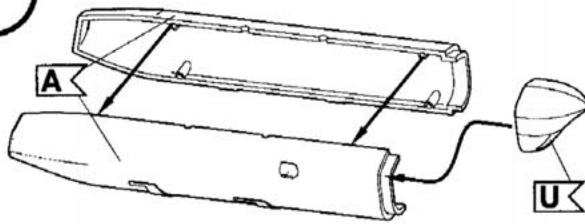

2x

Taurus Pod

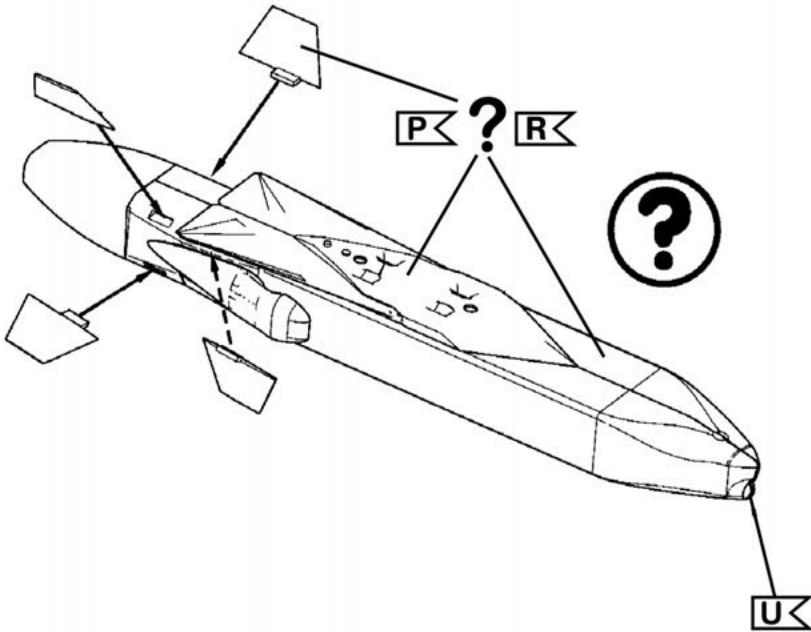

Paveway II LGB

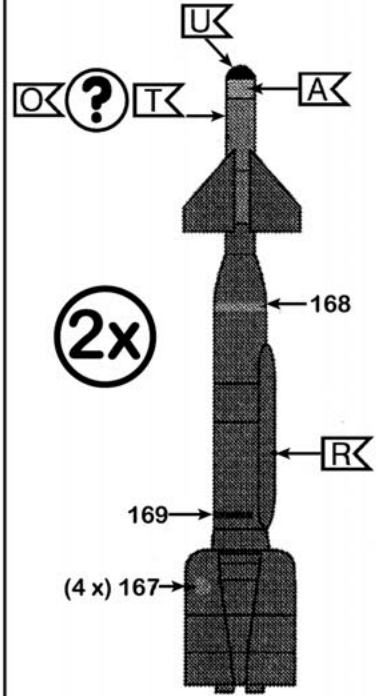

2x

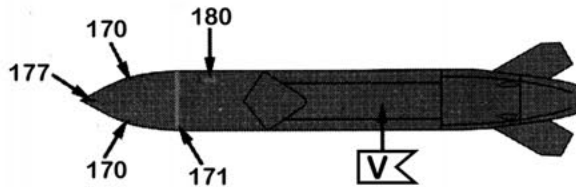
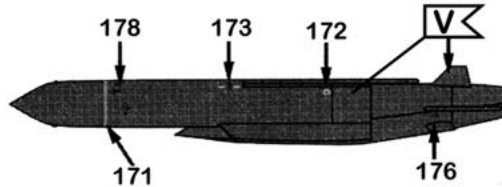

STORMSHADOW

