

# Sd.Kfz.10 (leichter Zugkraftwagen) with Pak.38

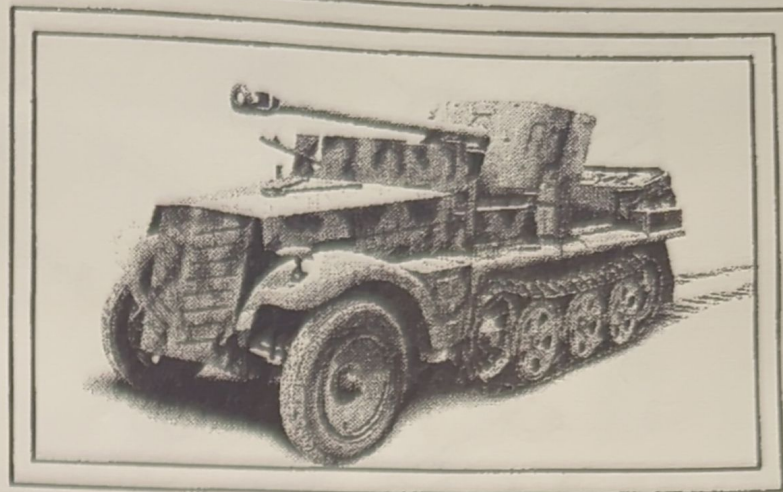

1/72 scale  
Plastic model kit.  
cat. #72243



## Parts

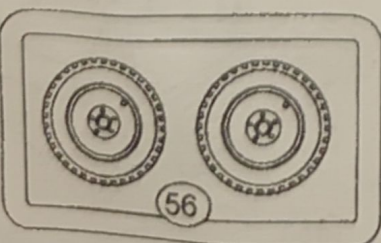
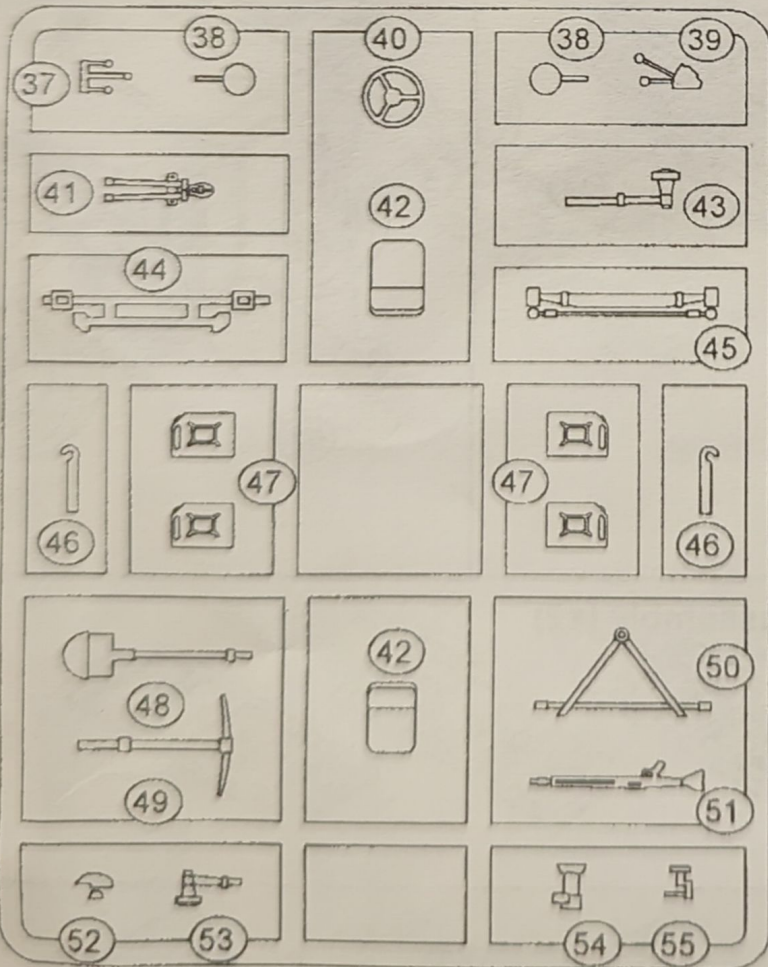
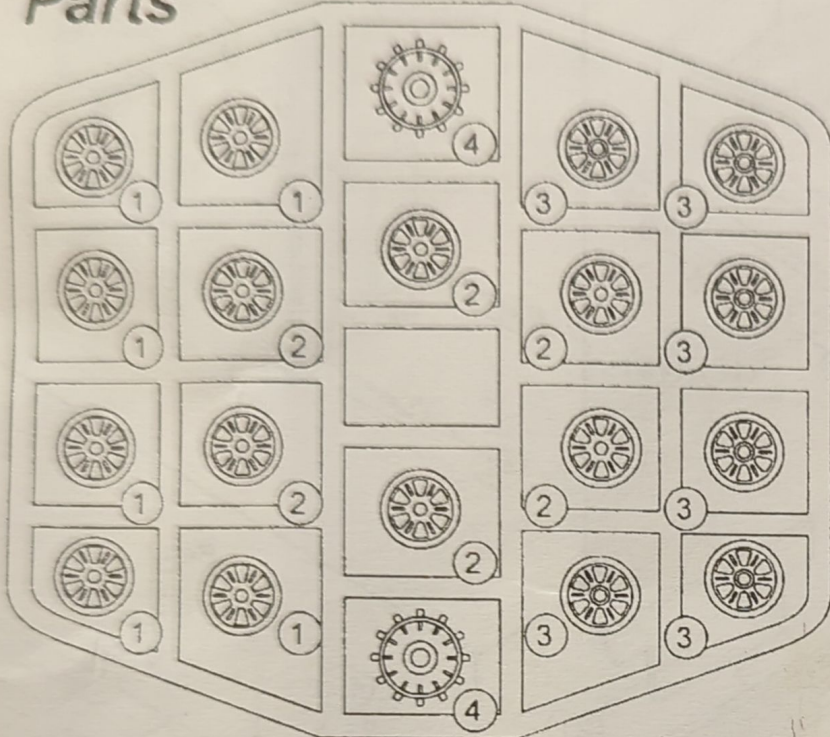

Etched parts NOT shown.

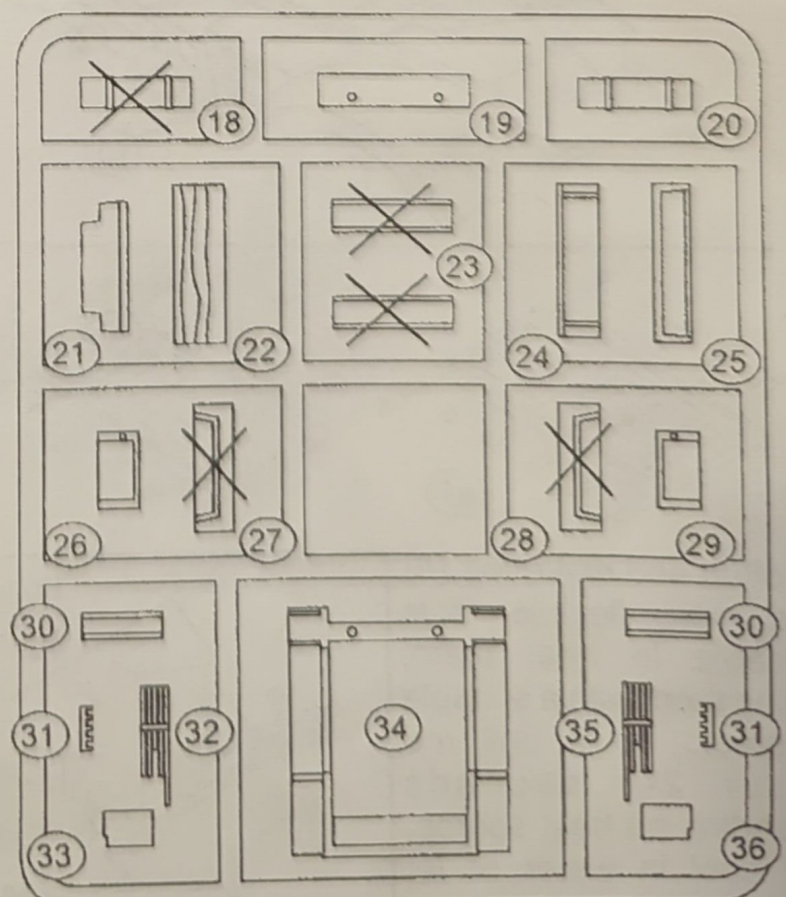
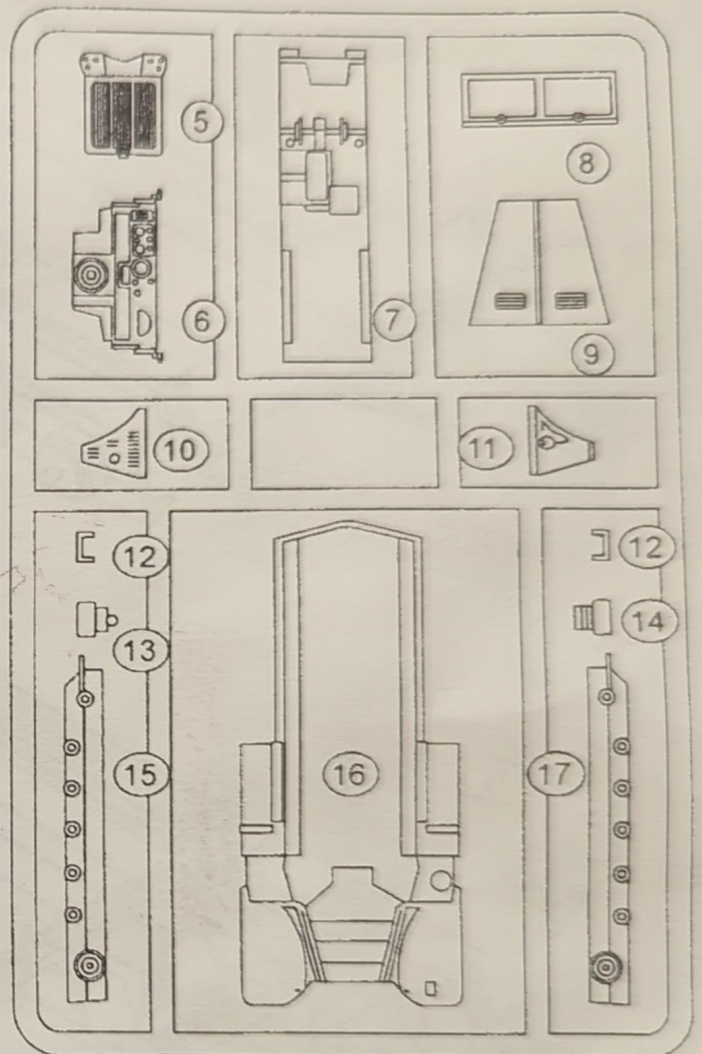



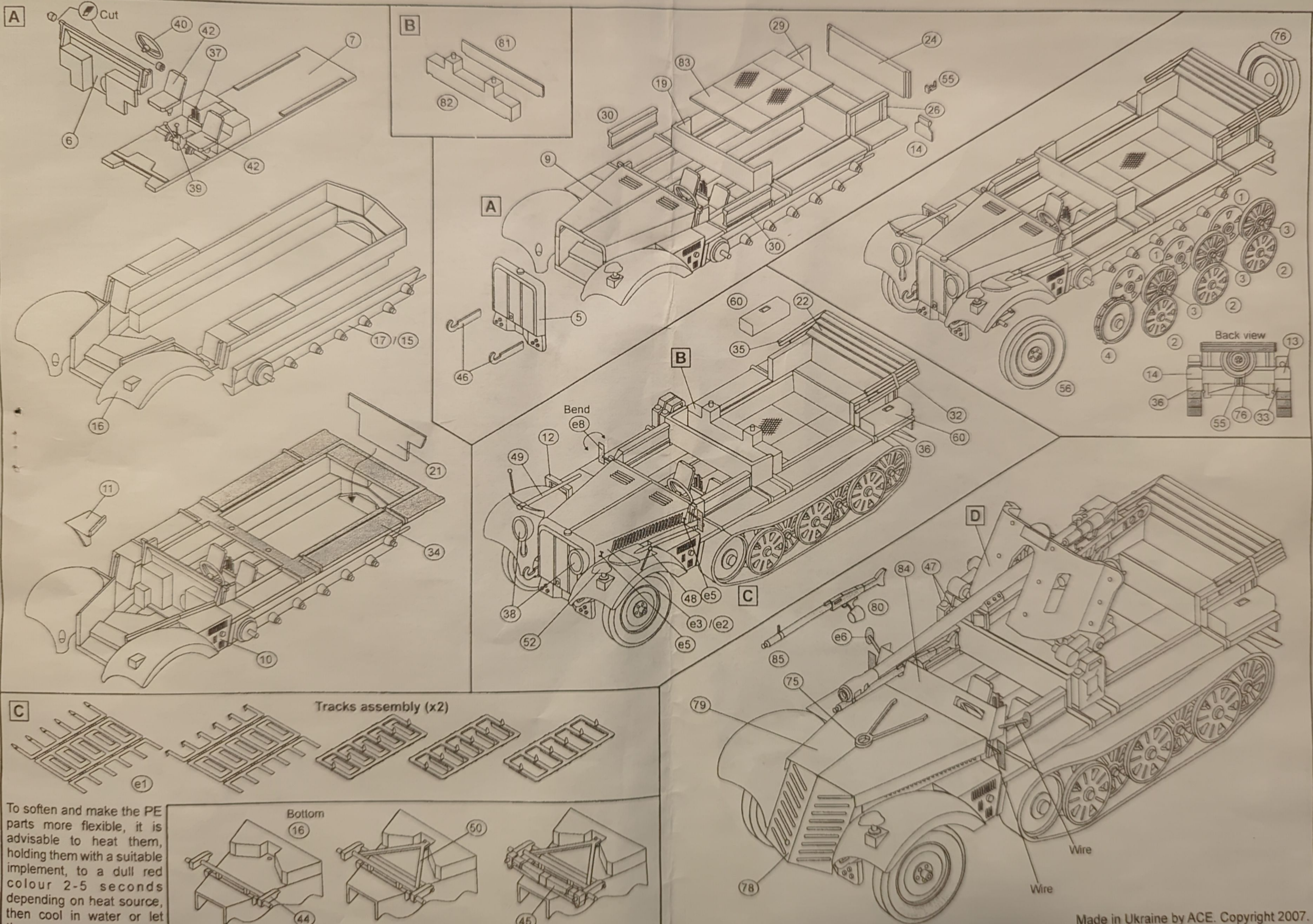

To soften and make the PE parts more flexible, it is advisable to heat them, holding them with a suitable implement, to a dull red colour 2-5 seconds depending on heat source, then cool in water or let them cool naturally.

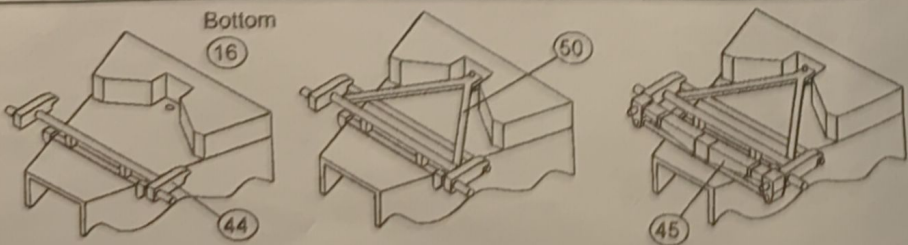



D

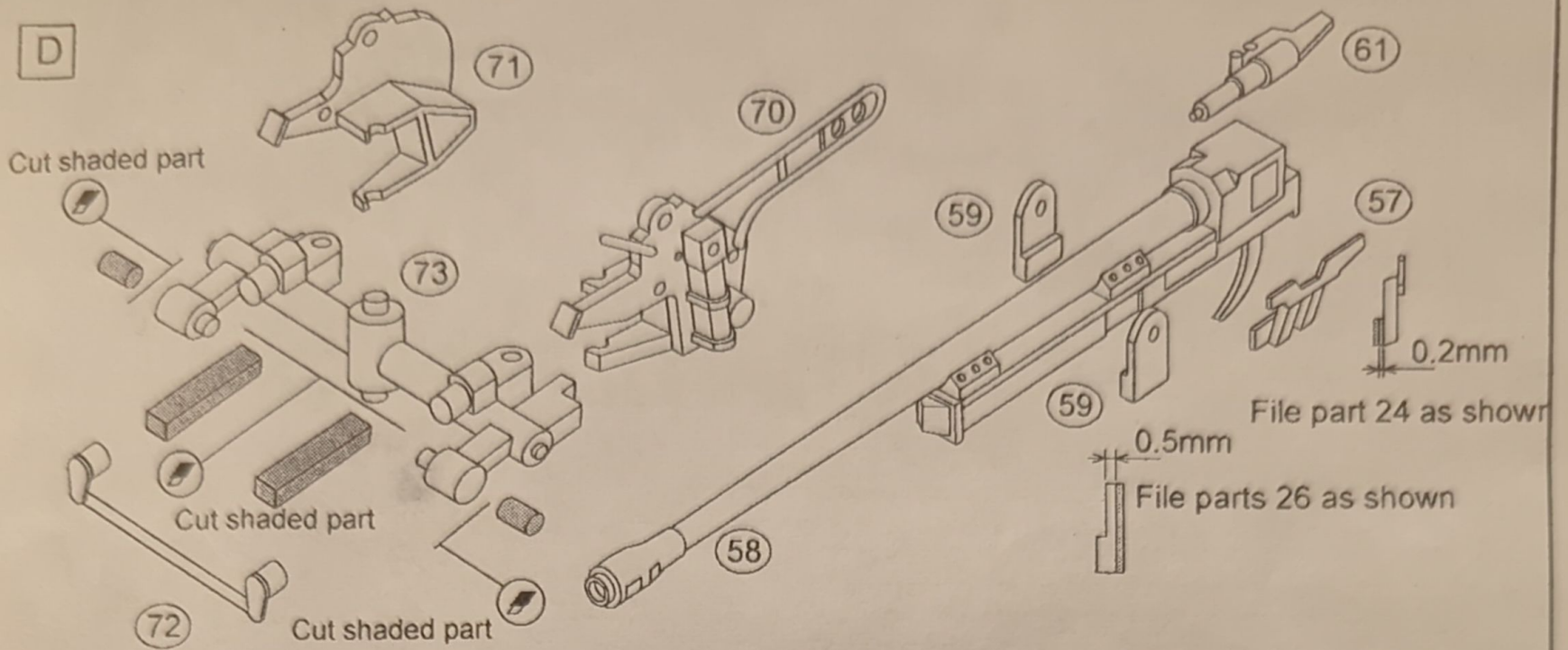

Shield's back view

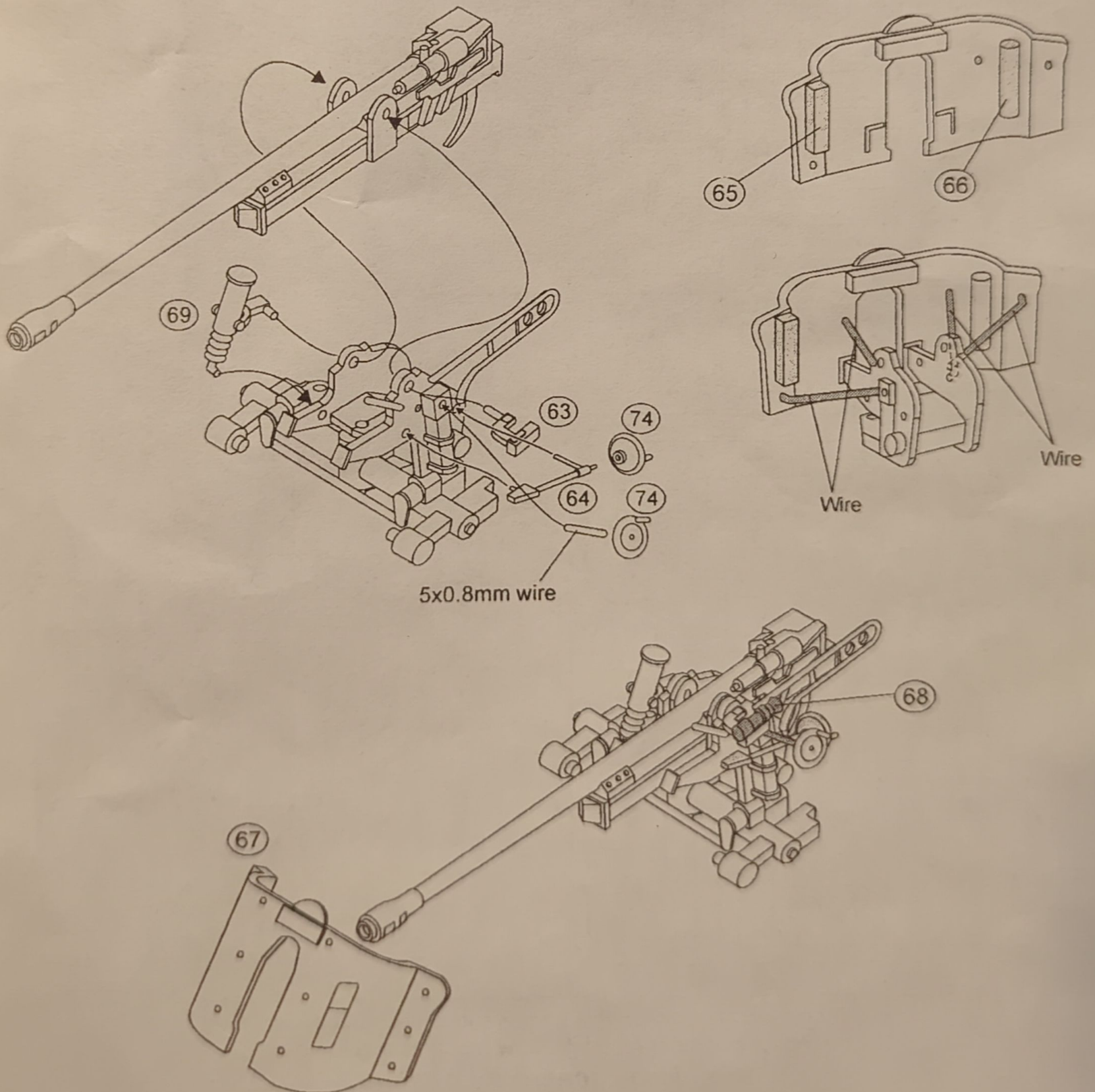



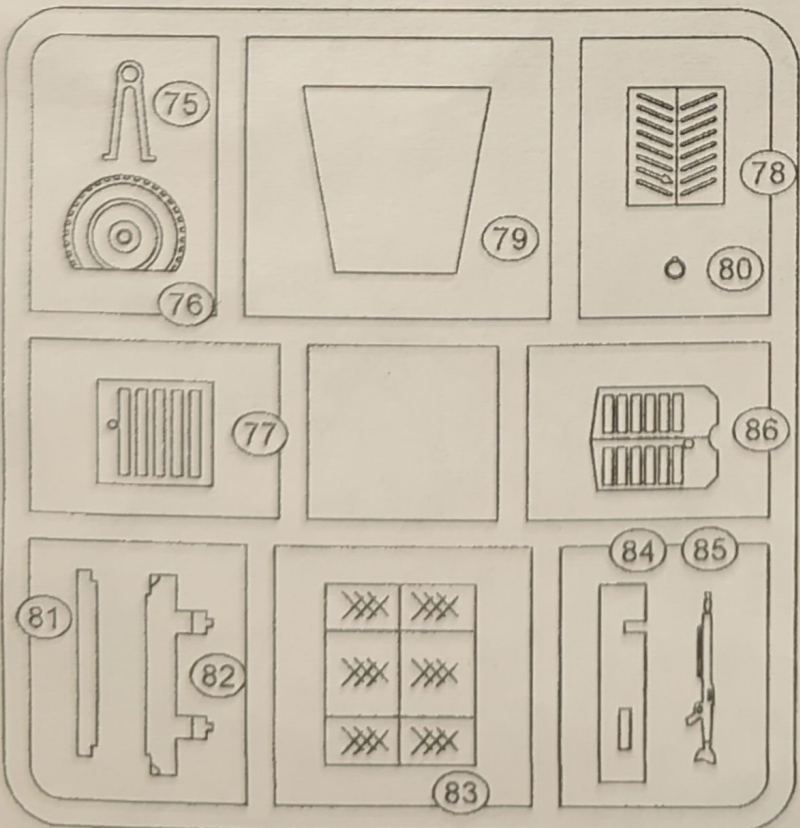
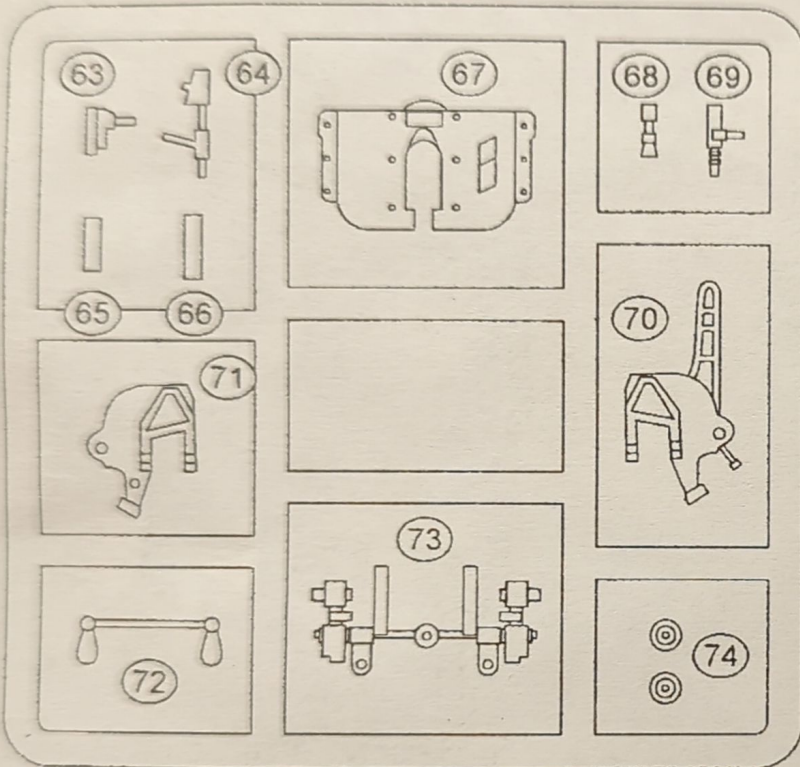
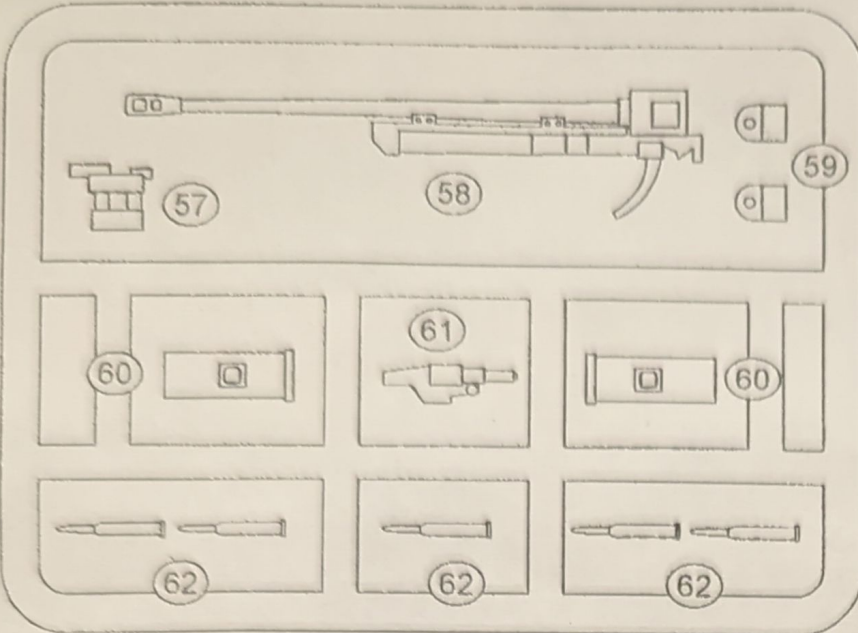

Variants of add-on armor

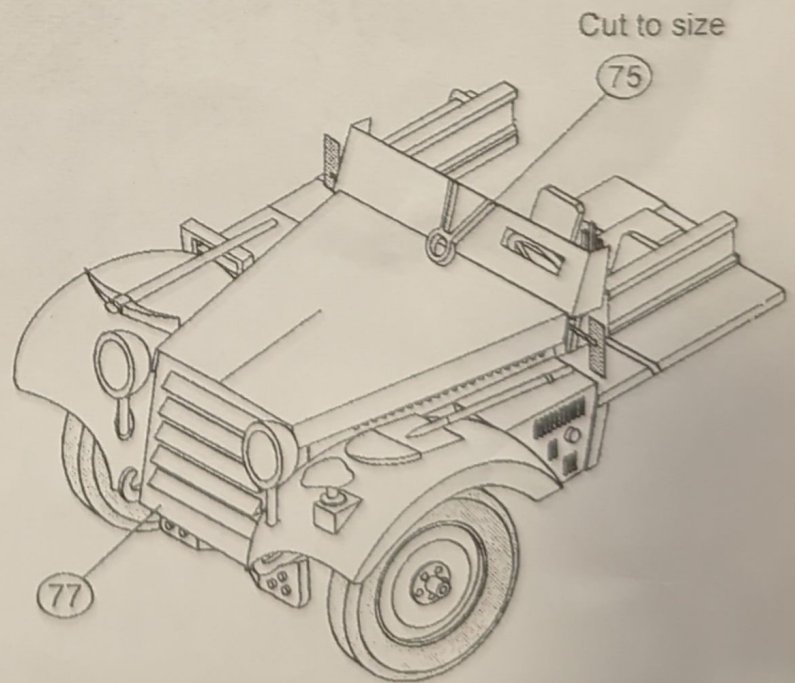
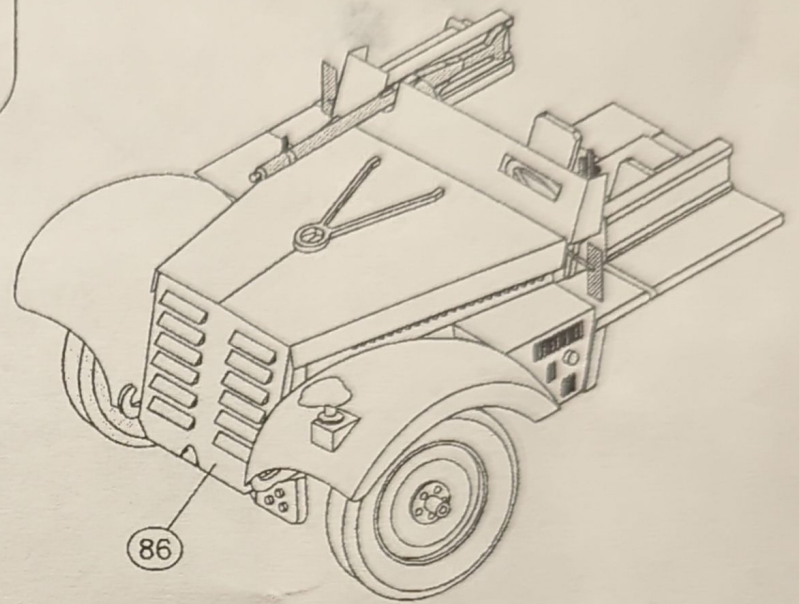

Check for historical photos of this tractor and other vehicles, detailed descriptions of other ACE kits, new products and more at:

<http://www.acemodel.com.ua>

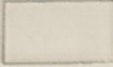
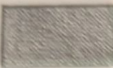
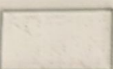
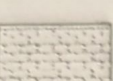

### Painting and markings.

-  -Dark Yellow
-  -Green
-  -Brown
-  -White wash

SdKfz. 10 with Pak.38, 5-th SS Panzer-Division "Wiking", Kovel region. March 1944.  
 SdKfz. 10 с ПАК.38. 5-ая танковая див. СС "Викинг". район Ковеля. 1944.

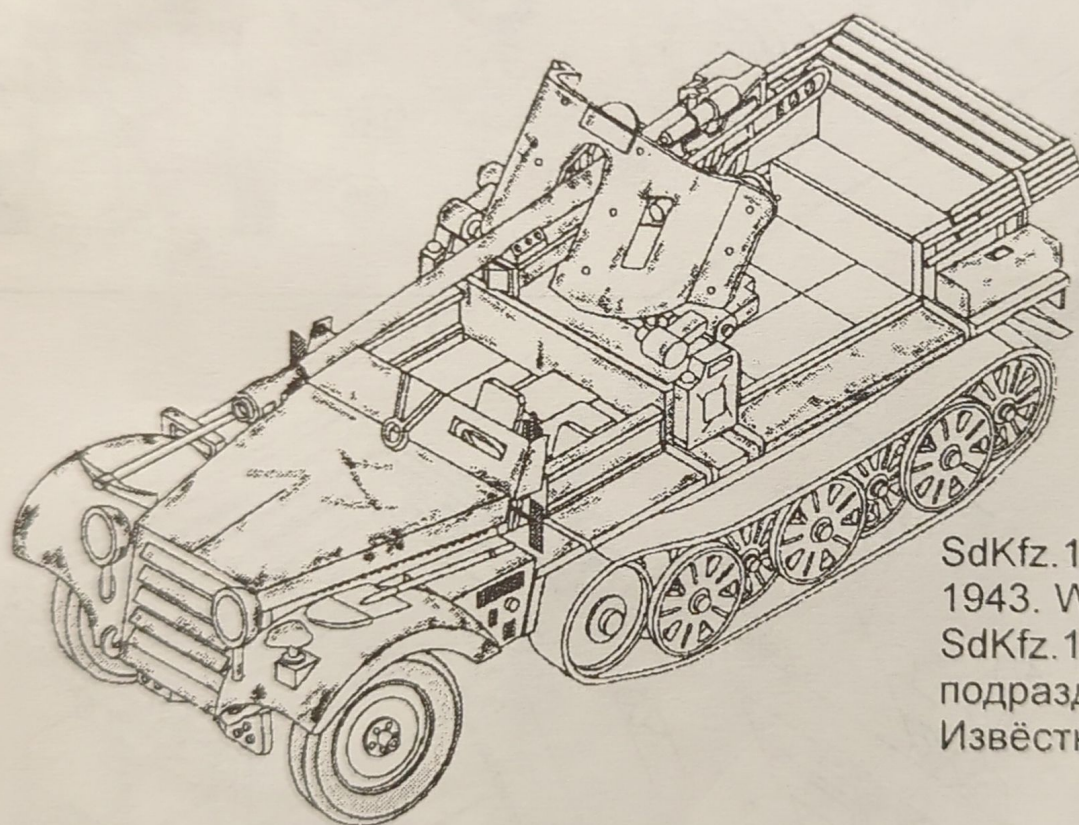
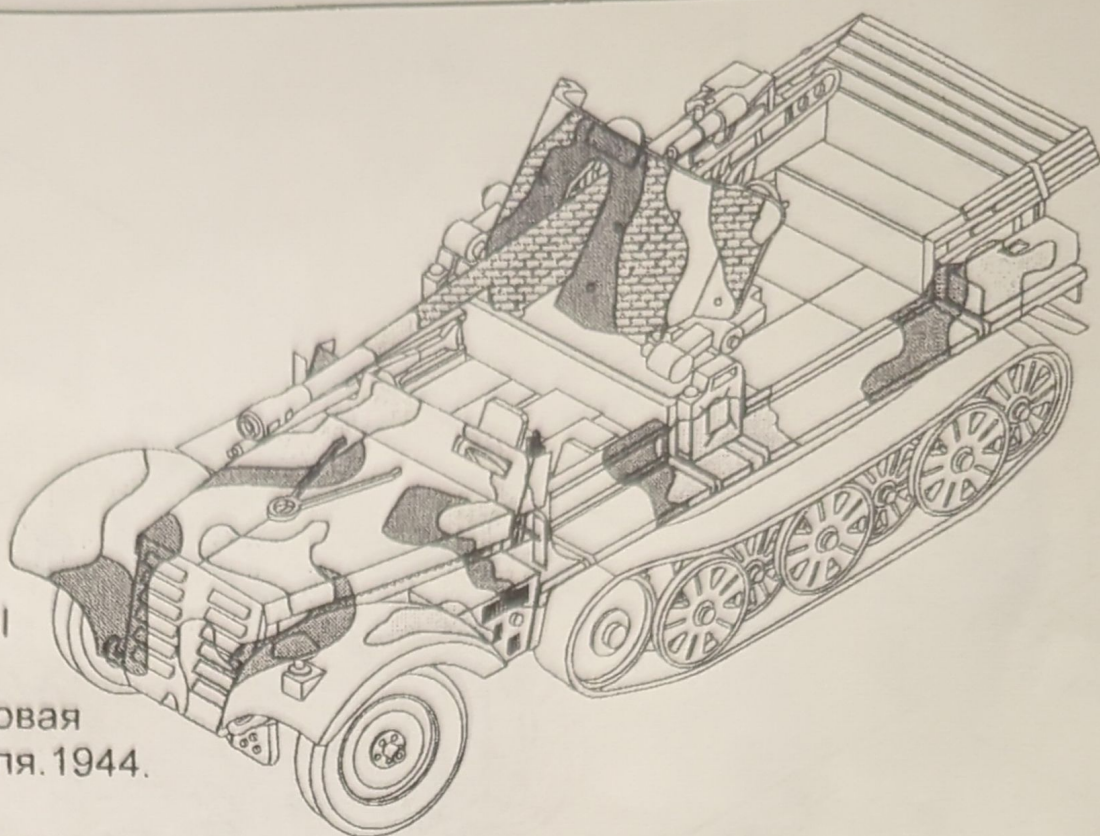

SdKfz. 10 with Pak.38, Russia, winter 1943. White wash over panzer grey.  
 SdKfz. 10 с ПАК.38. неизвестного подразделения. Зима 1943.  
 Извѣстка по танковому серому.

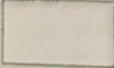
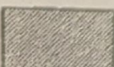
-  -Panzer Grey
-  -Green

SdKfz. 10 with Pak.38, SS Division "Das Reich", Kharkov region. 1944.  
 SdKfz. 10 с ПАК.38. див. СС "Das Reich". Район Харькова. 1944.

