

# AD-3/4 Skyraider



## Skyraider AD-3 and AD-4 over Korea

The Skyraider is a straight wing mono-plane, piston engined propeller aircraft, capable of carrying 10,000lb (4545kg) of under-wing stores on 14 hard-points.

It carried various load-outs made up of napalm tanks, GP bombs from 100 - 2000lb (45 - 909kg), 240lb-260lb (109 - 118kg) fragmentation bombs, HVAR and ATAR rockets, depth-bombs and even torpedoes. Skyraiders could dive-bomb, glide-bomb

and loft or toss-bomb. They were mainly used in close air support roles. Over Korea, sorties were short range as their carriers were based in the Sea of Japan, and Yellow Sea. The AD-4 was the most numerous used. Because of heavy losses and damage

during low-level ops, 0.25 - 0.5inch (6.4 - 12.7mm) aluminium 'bolt-on' armour was fitted externally to the undersides and fuselage of Skyraiders.

AD-3 BuNo 122737, D 504, of VA-923 / CV-31, was flown from the USS Bon Homme Richard in 1951. She had nose art, which was unusual at that time: 'Hefty Betty'. On ops, she could carry 3 x 2000lb (909kg) bombs, although a typical load was 2 x napalm, plus 12 x 250lb (114kg) GP bombs. This aircraft survived the war.

AD-3 BuNo 122799, K 503, of VA-35 / CV-32 flew from the USS Leyte in November 1950, stationed in the Sea of Japan. This was the first Atlantic Fleet carrier sent to Korea, K 503 normally carrying out NATO ops. She was photographed loaded with a

centre-line drop-tank, 2 x 2000lb (909kg) GP bombs, and 6 x 250lb (114kg) GP bombs. This aircraft later served with VA-95 in 1953, and VMA-121 in 1954.

AD-4 BuNo 123820, B 509, VA-195 / CVA-21 flew from USS Boxer in mid 1952. She carried 65 mission markings, and the name: OWENS RL AD3 below the cockpit, on the starboard side. She was pictured with 2 x 1000lb (455kg) bombs on the inner wings, and 12 x 500lb (227kg) bombs on the outer wing hard-points.

AD-4 BuNo 123851, V 503, VA-115 / CV-47, was flying from the USS Philippine Sea in February 1951. The carrier was stationed in the Yellow Sea, operating close-air-support over land, gun-fire spotting, and armed reconnaissance. Aircraft

also hit railway tracks from low-level using delayed-action bombs, and smaller delayed-action 'butterfly bombs'. Delayed action meant aircraft were clear of the explosions and avoided damage. A typical load-out was 2 x napalm, 12 x 260lb

(118kg) fragmentation bombs. This aircraft also had mission markings on the starboard side of the cockpit.

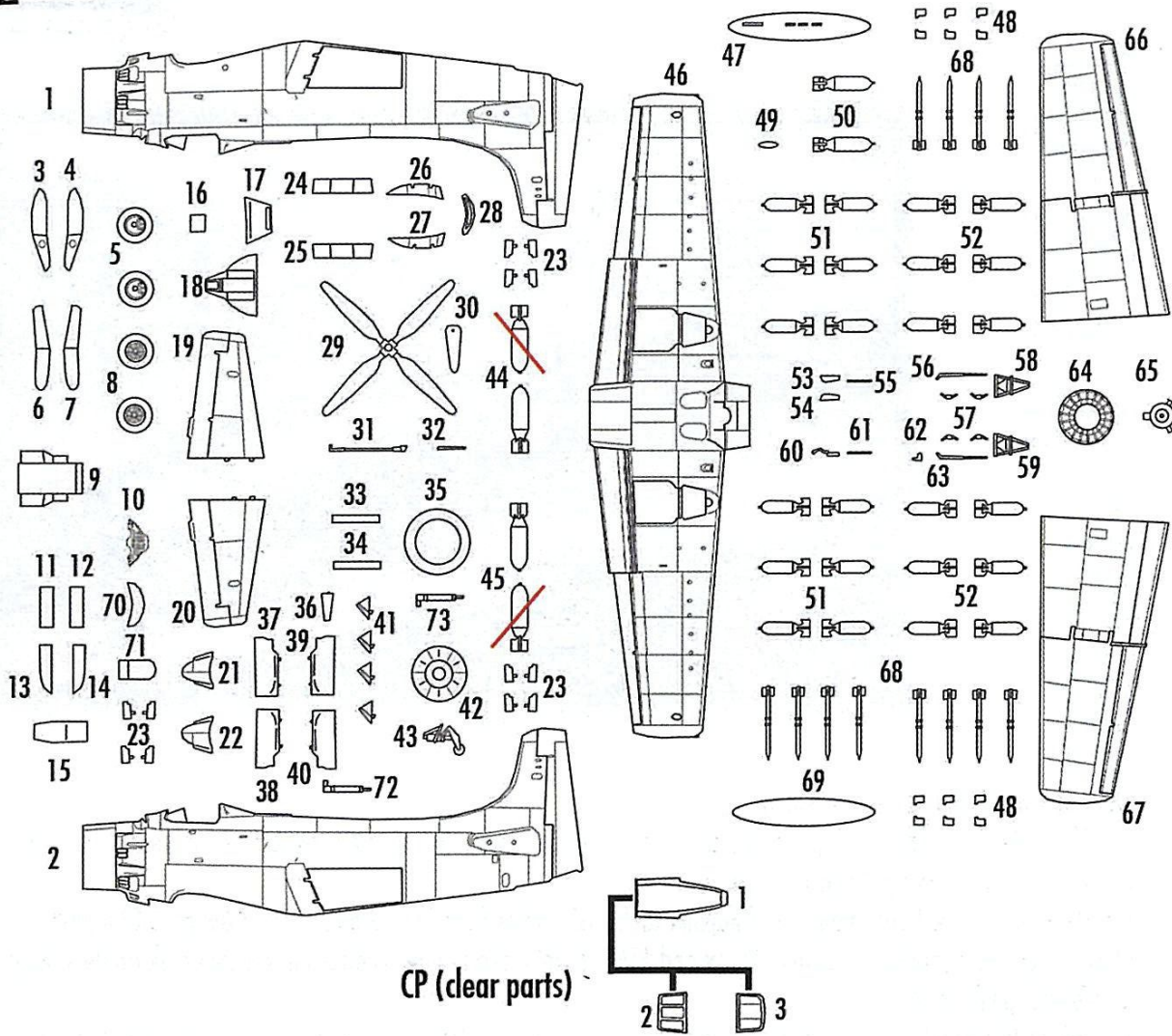

| BARVA/COLOR |  |
|-------------|--|
| (A)         | Lesklá námořní modrá<br>Gloss Sea Blue |
| (B)         | Černá/Black                            |
| (C)         | Stříbrná/Silver                        |
| (D)         | Hliníková<br>Aluminium                 |
| (E)         | Chromová<br>Chrome                     |
| (F)         | Světle šedá<br>Light Grey              |
| (G)         | Interiérová zelená<br>Interior Green   |
| (H)         | Kůže<br>Leather                        |
| (I)         | Kovová<br>Gun metal                    |
| (J)         | Barva pneu<br>Tyres Black              |
| (K)         | Střední šedá<br>Medium Grey            |
| (L)         | Přírodní kov<br>Natural metal          |

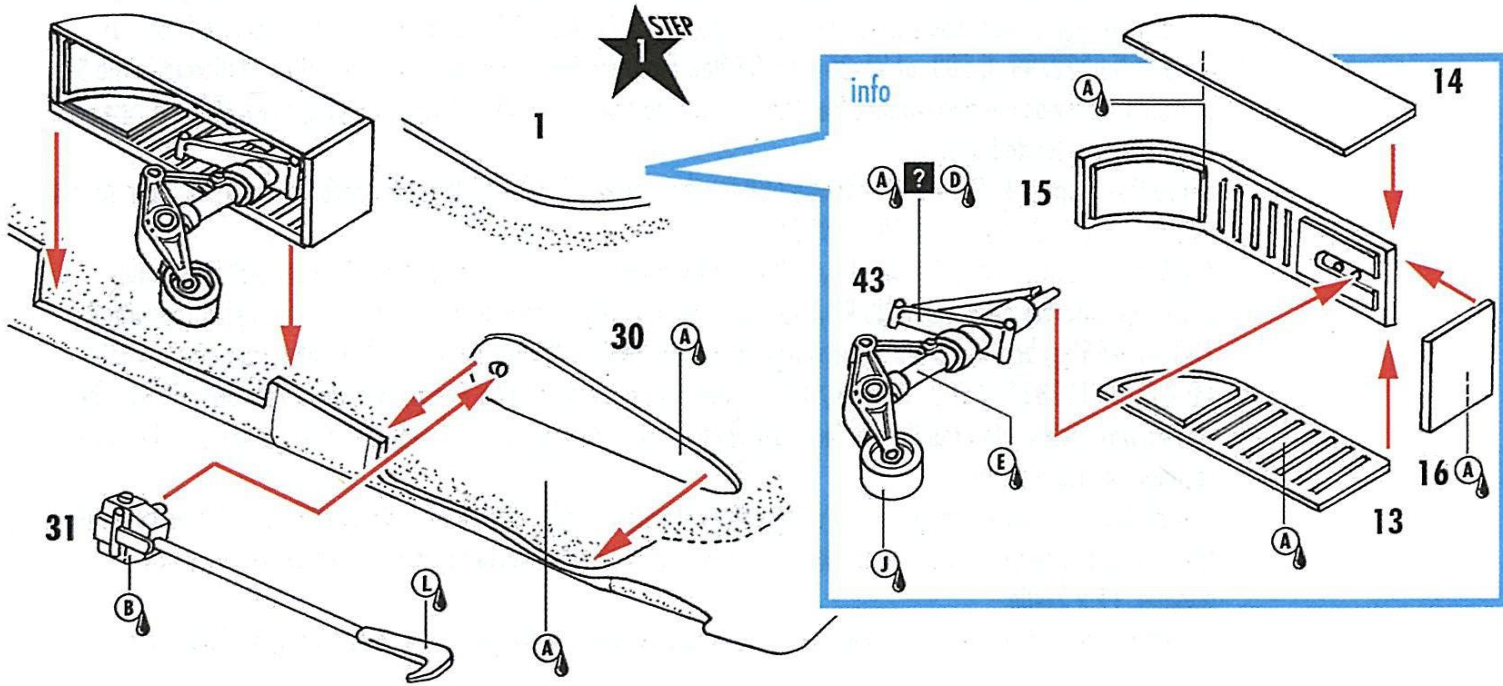
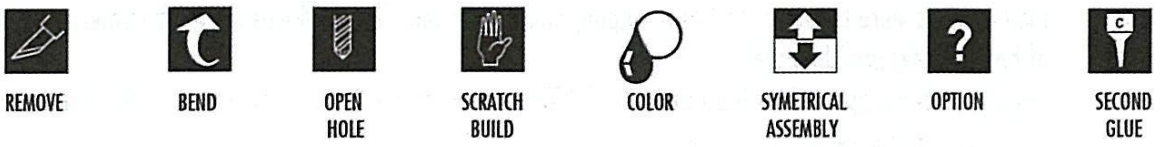

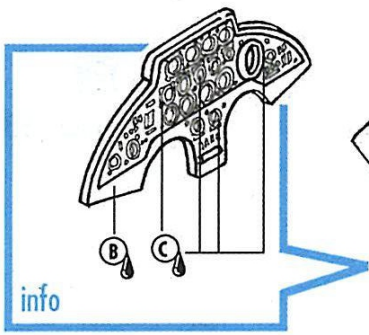

STEP 2

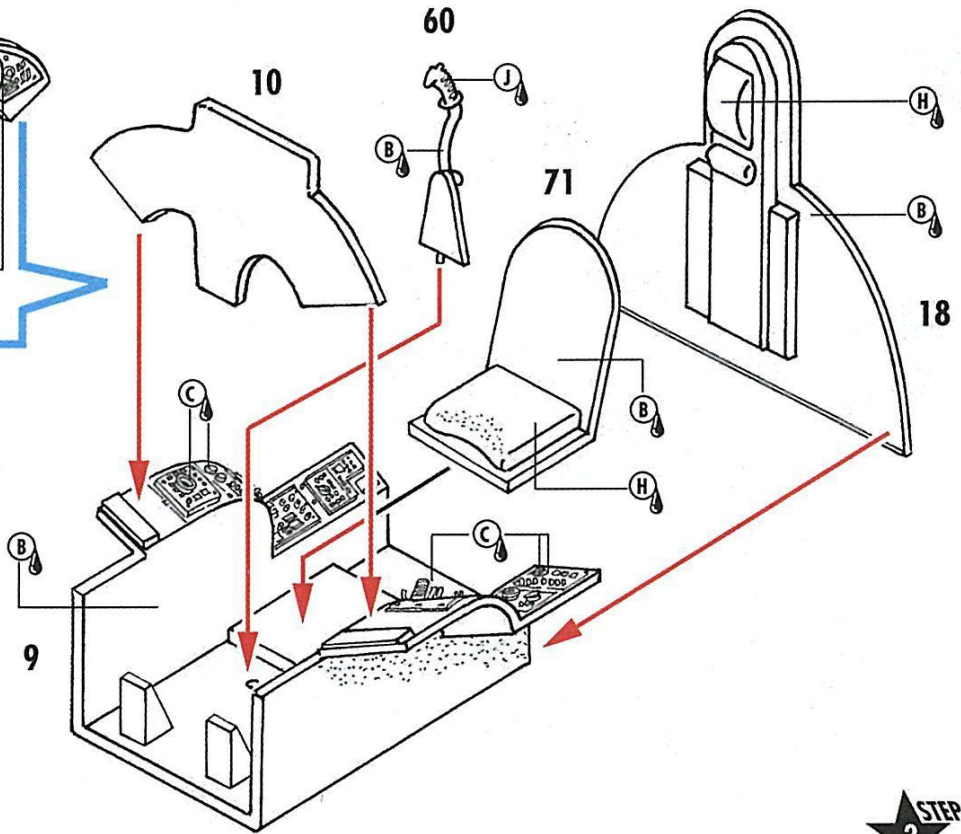

STEP 3

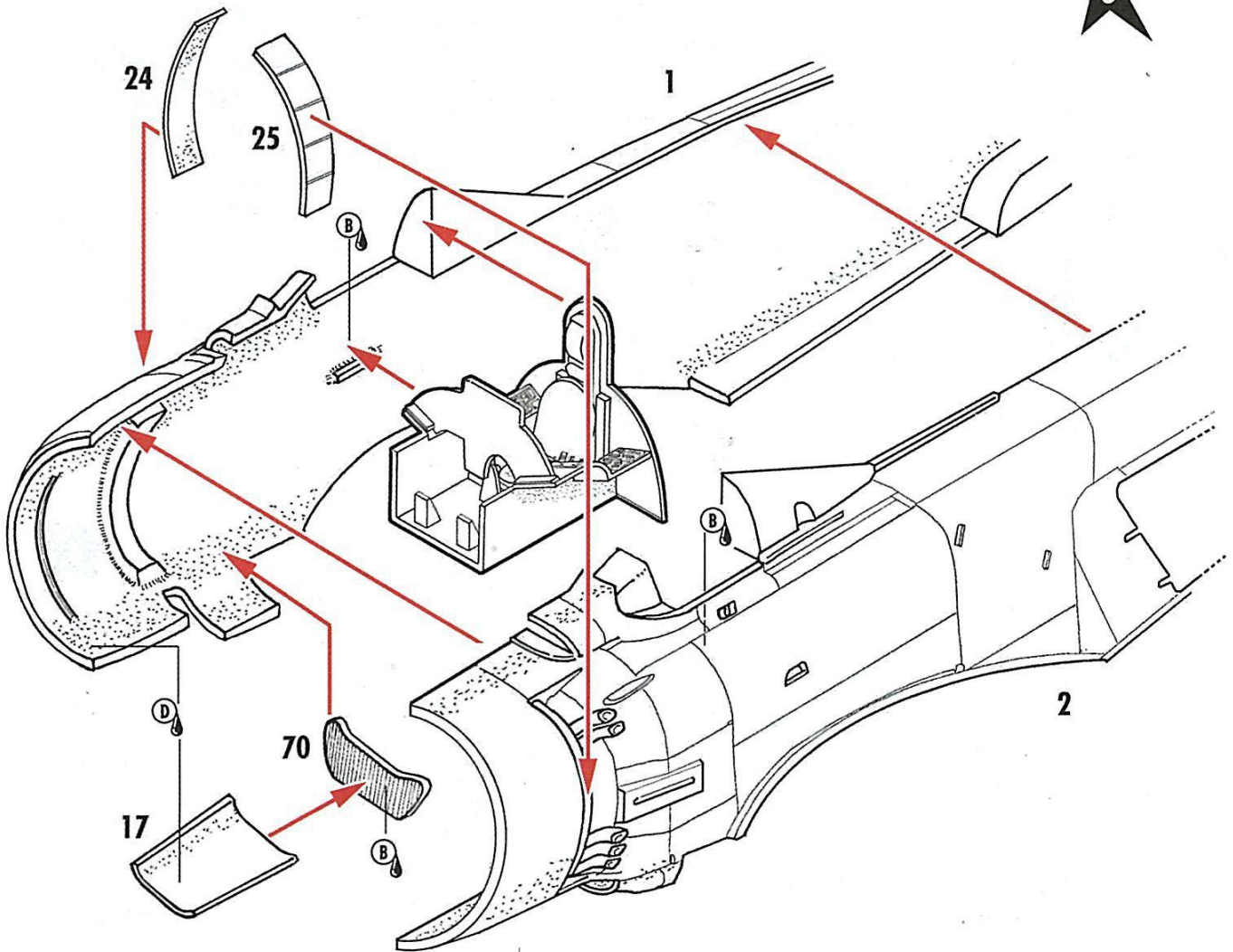

4 STEP

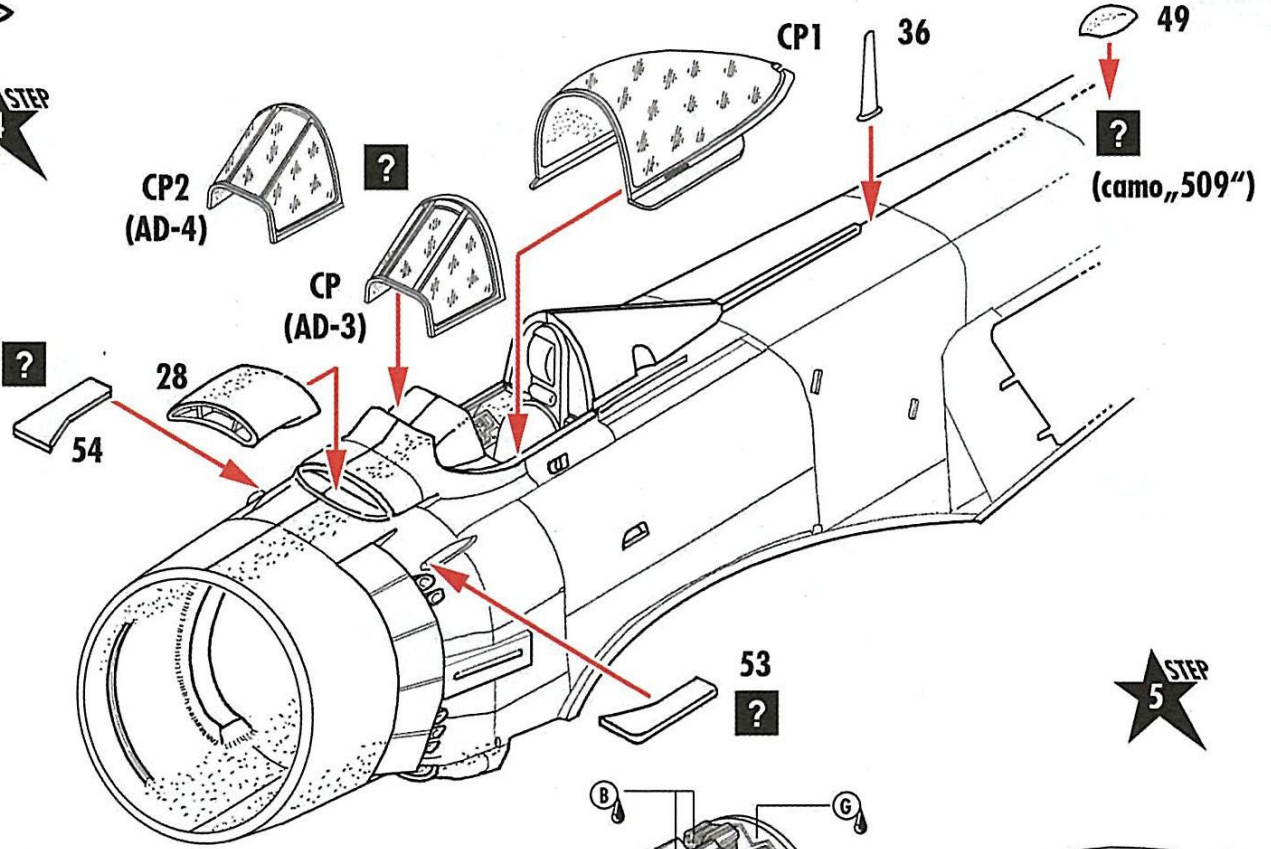

5 STEP

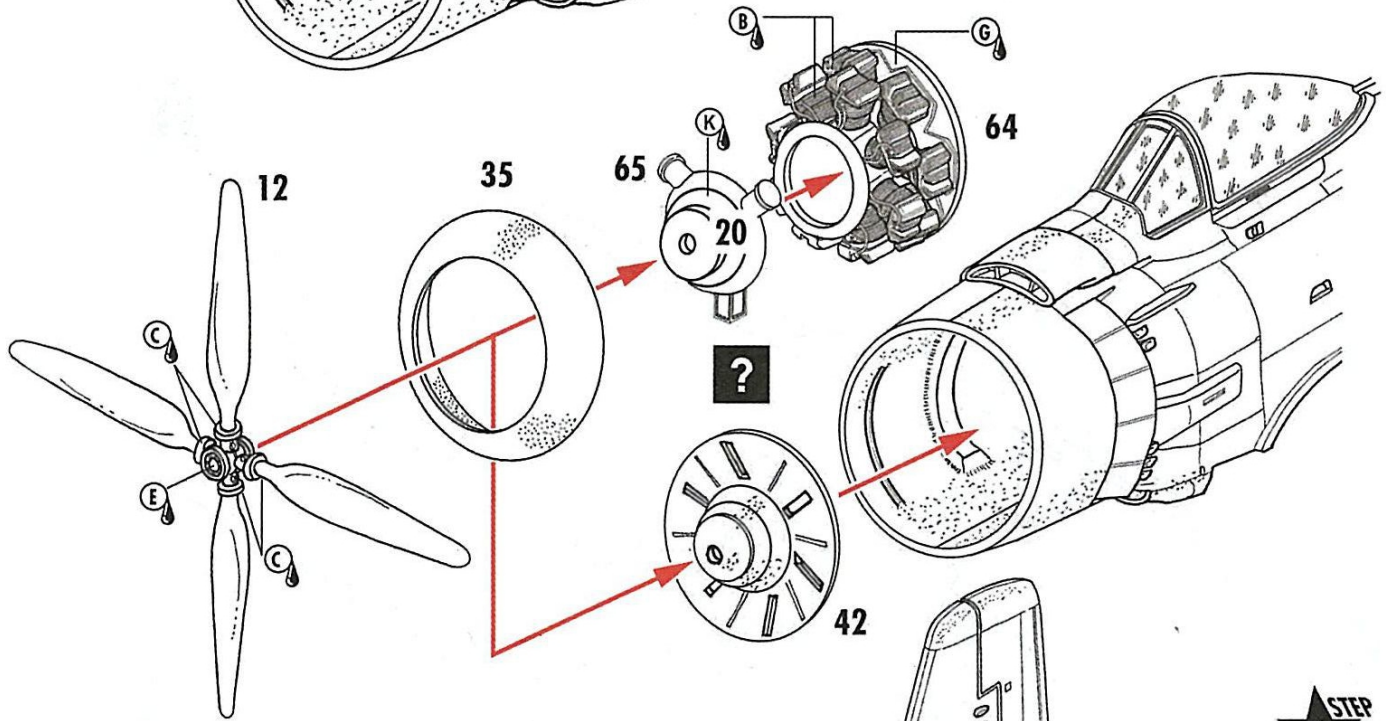

6 STEP

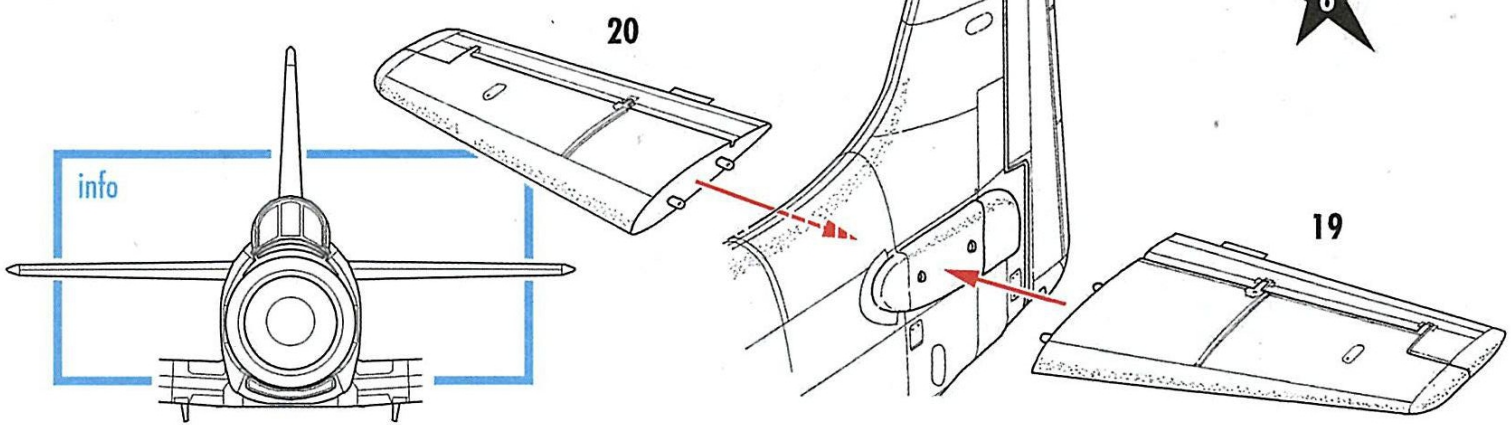

**7** STEP

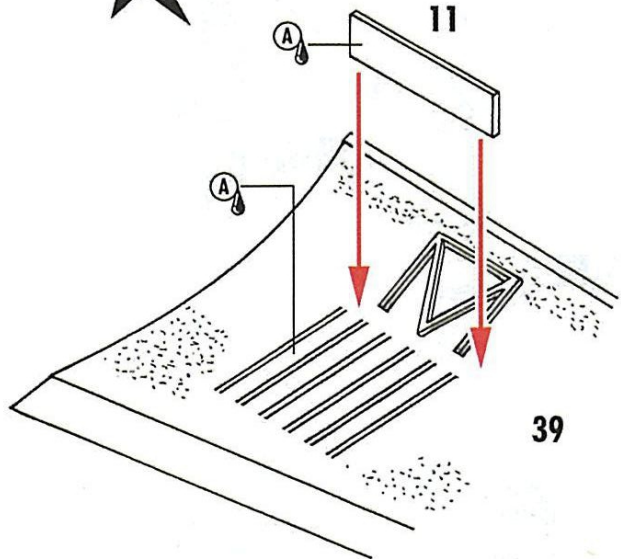

**8** STEP

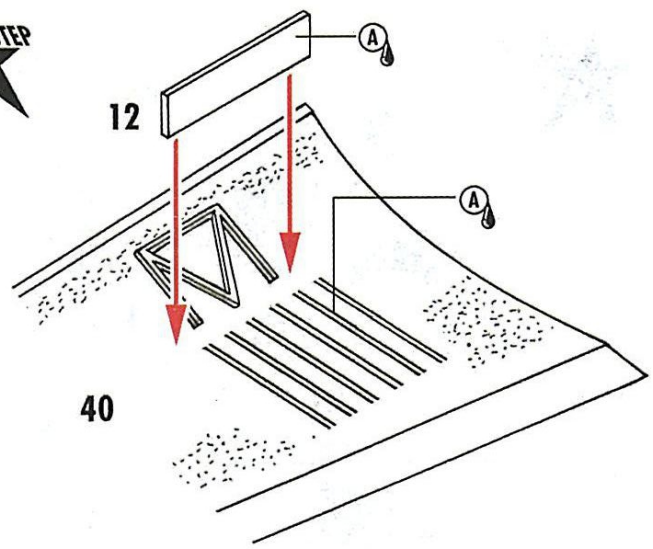

**9** STEP

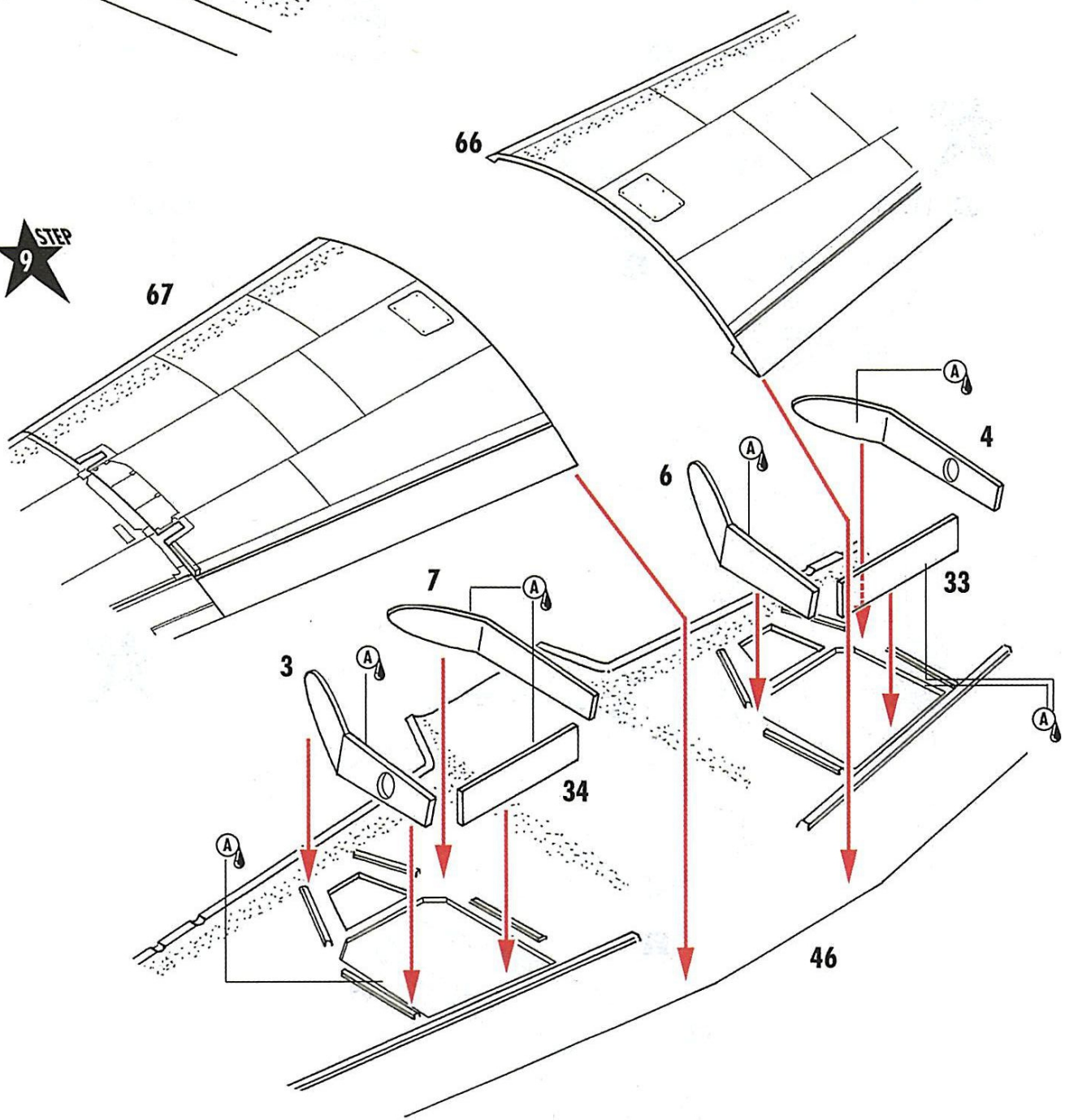

**STEP**  
**10**

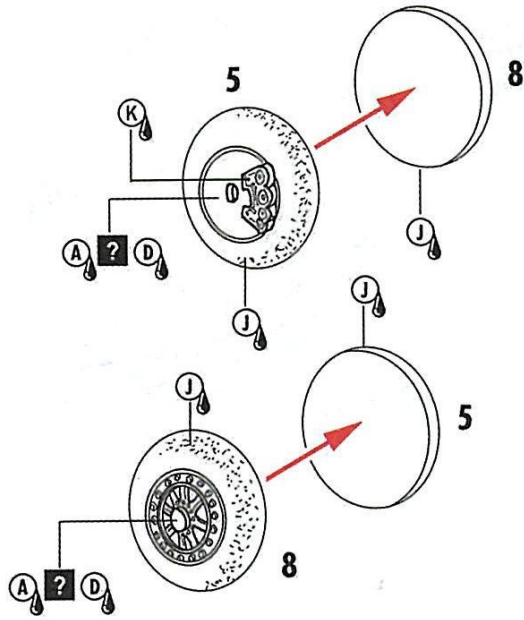

**STEP**  
**11**

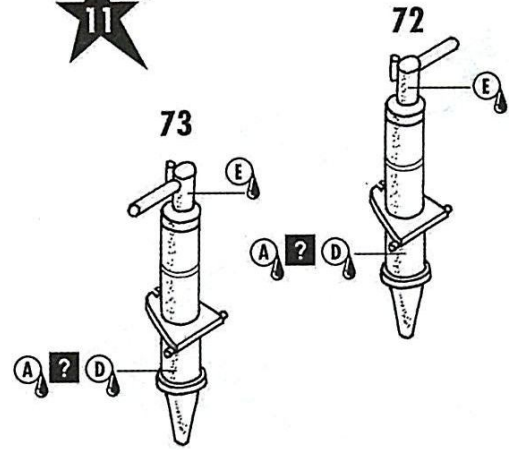

**STEP**  
**12**

**(12x)**

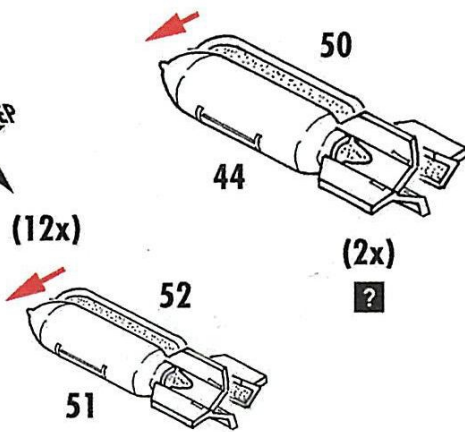

**STEP**  
**13**  
**(2x)**

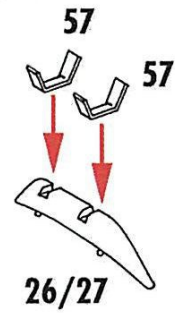

**STEP**  
**14**

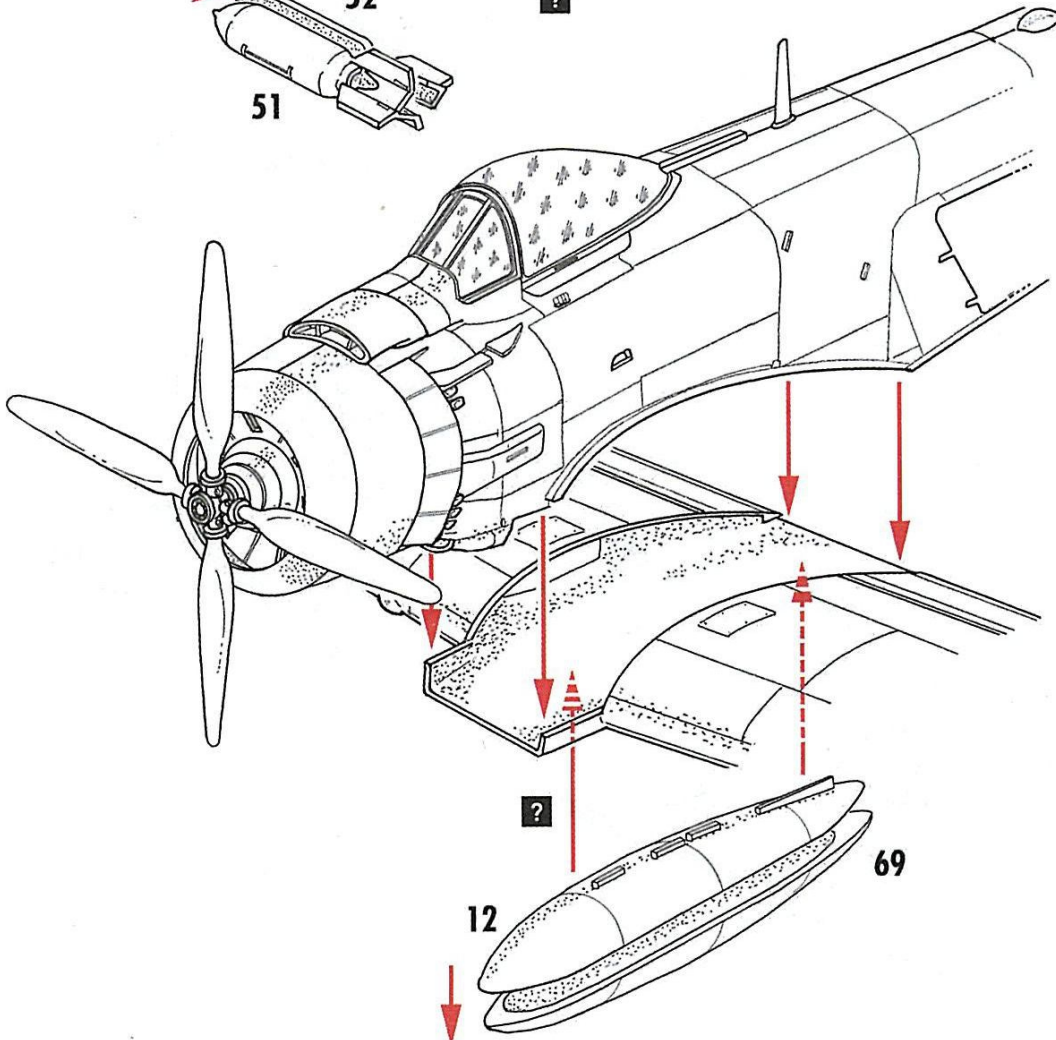

**STEP 15**

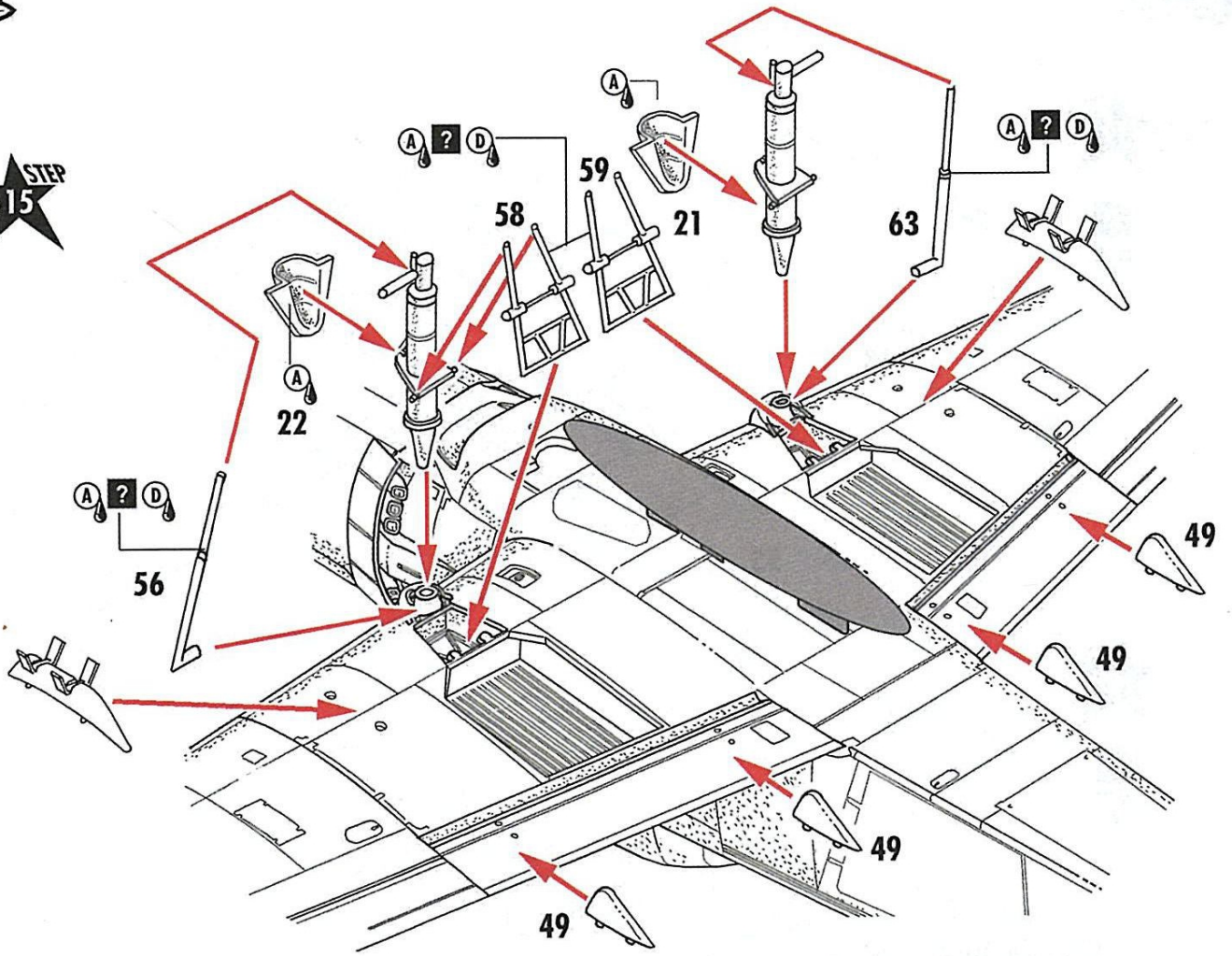

**STEP 16**

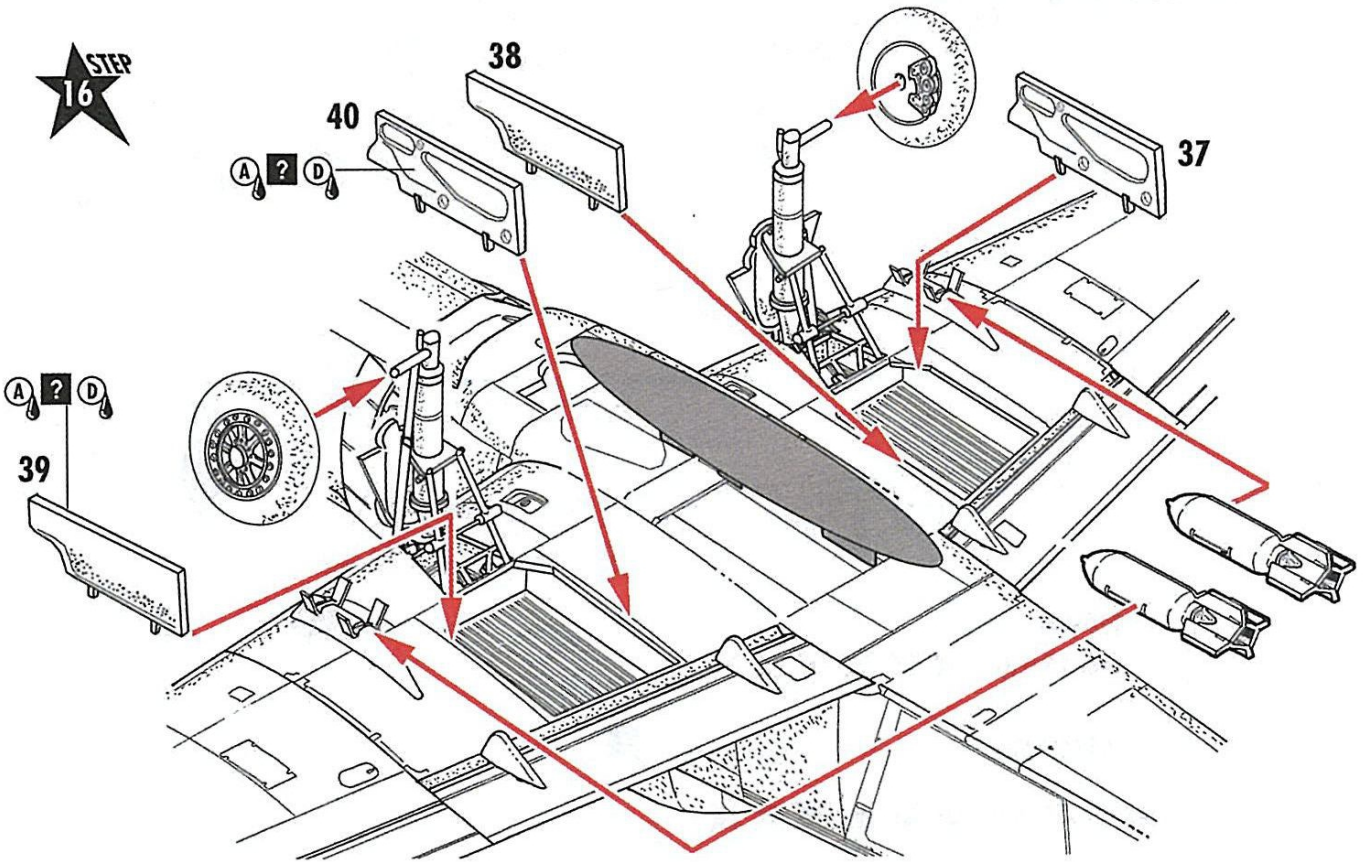

**STEP**  
**17**

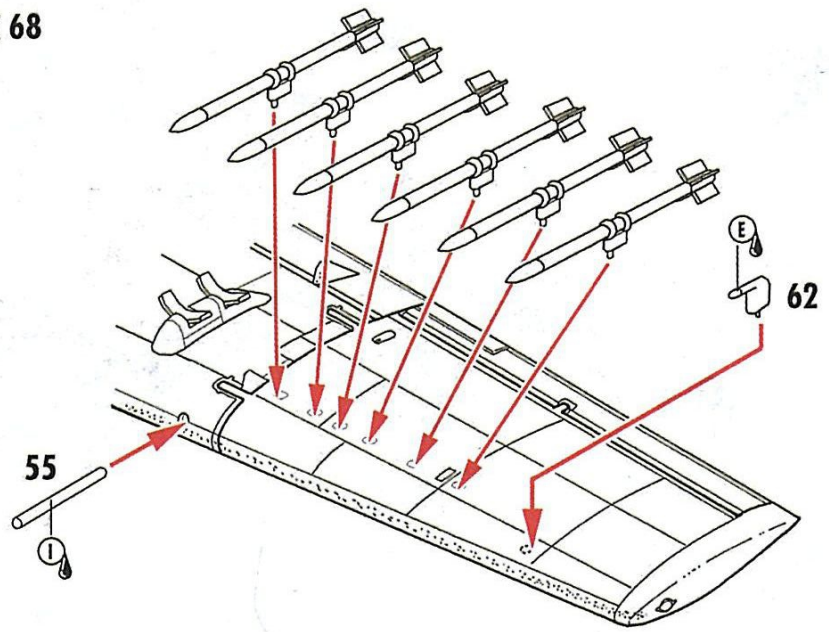
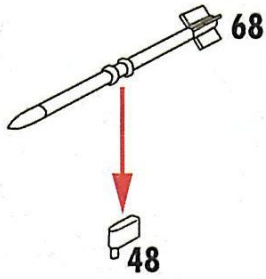

**STEP**  
**18**

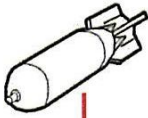

**48**  
**(23 only AD-4)**

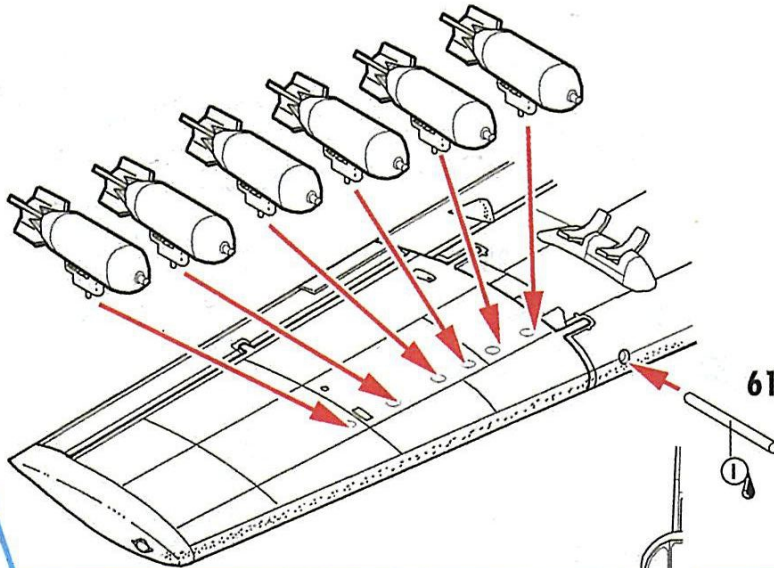

**info**

(47+69) ————— ●

(48/23+68) — ✕ ✕ ✕ ✕ ✕ ✕

(44/45+50) ————— ●

(48/23+51+52) — ✕ ✕ ✕ ✕ ✕ ✕



AD-4 USN, Bu.No 123820, 509B, VA-195, USS Boxer, CVA-21, 1952

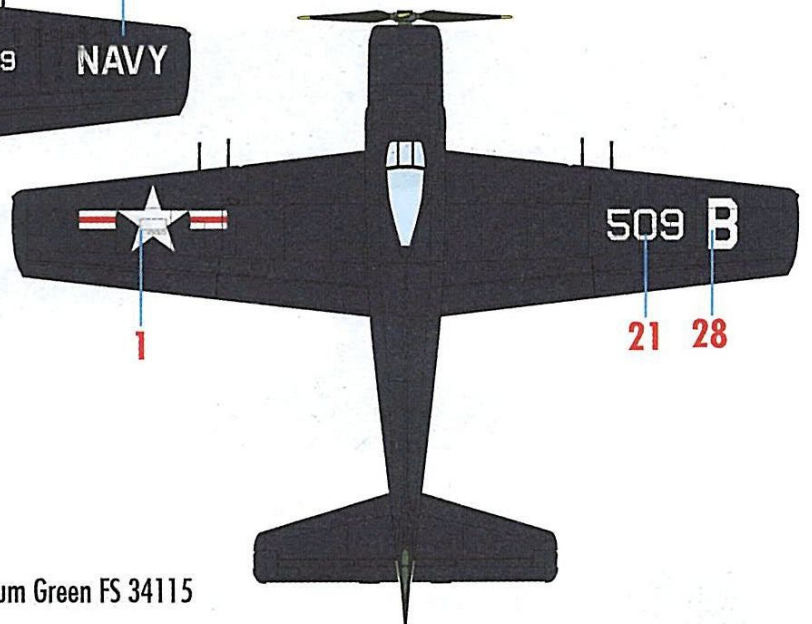
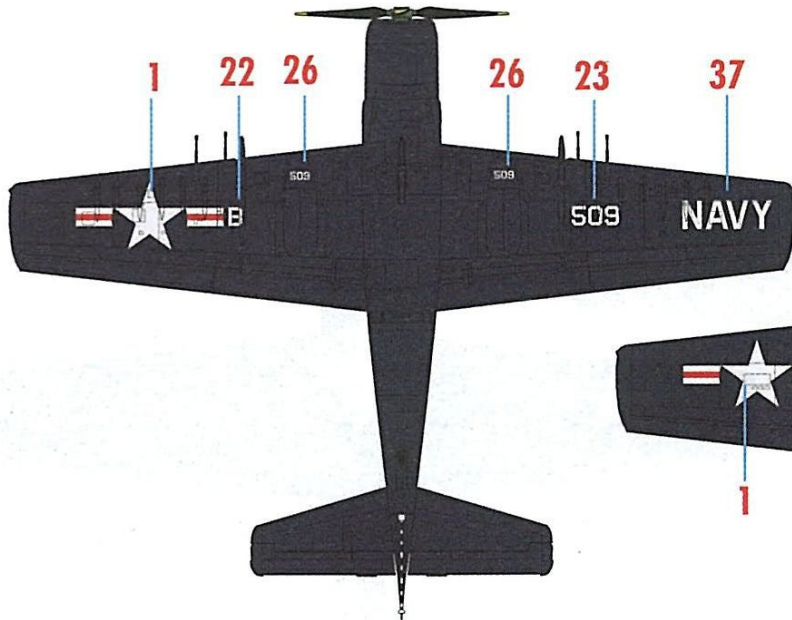
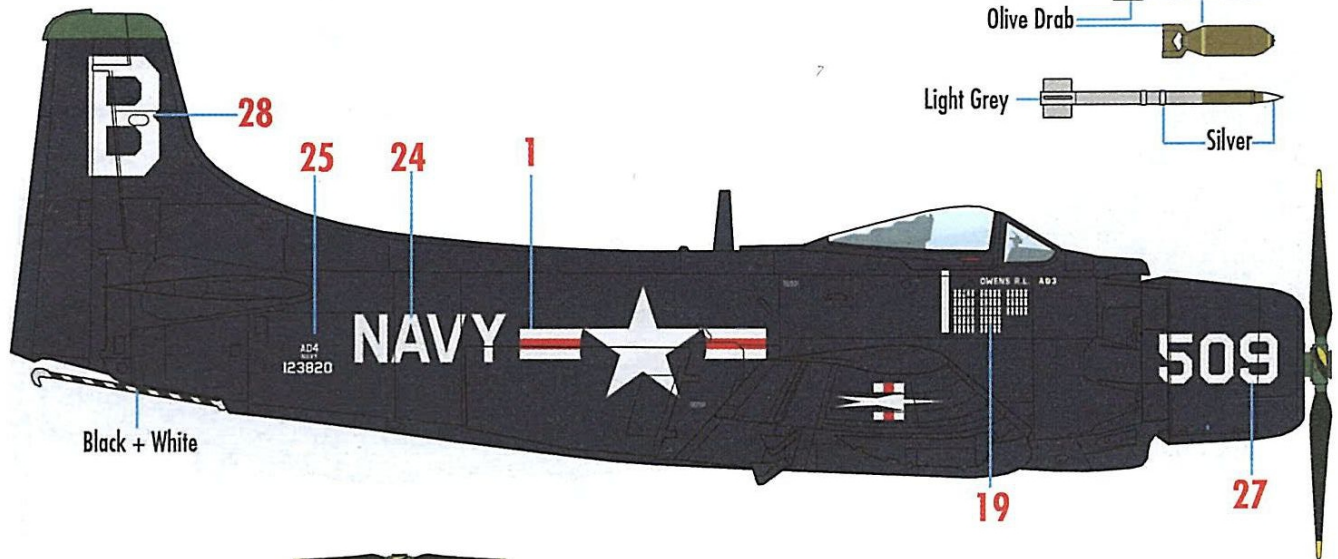
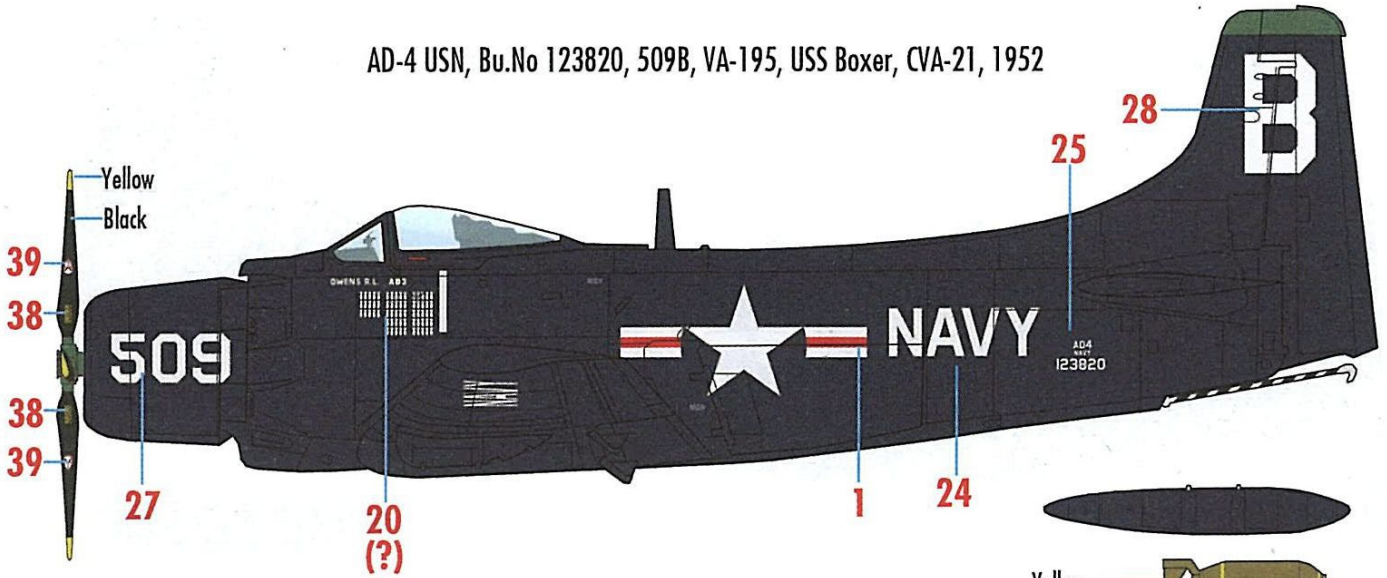

Gloss Sea Blue FS 15042    Gloss Medium Green FS 34115

AD-3 USN, Bu.No. 122737, 504D, Hefty Betty, VA-923, USS Bon Homme Richard, CV-31, 1951

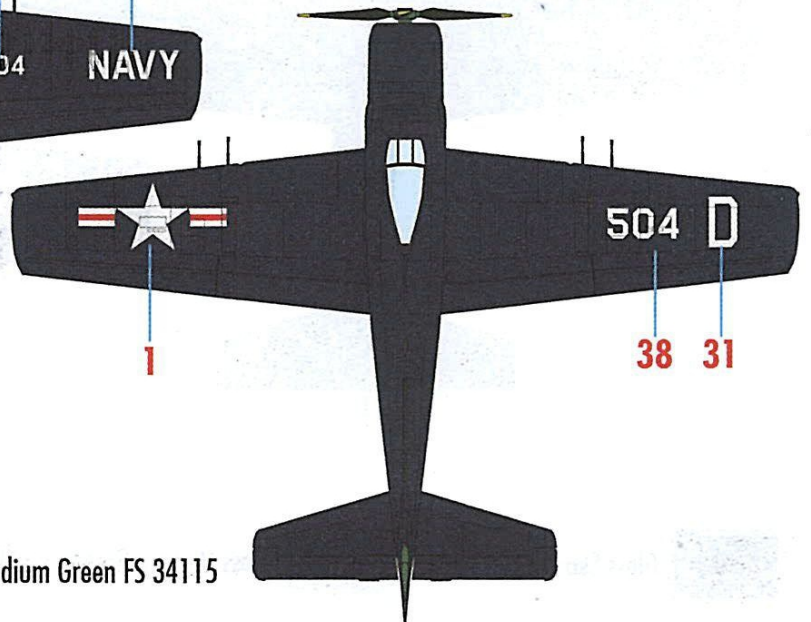
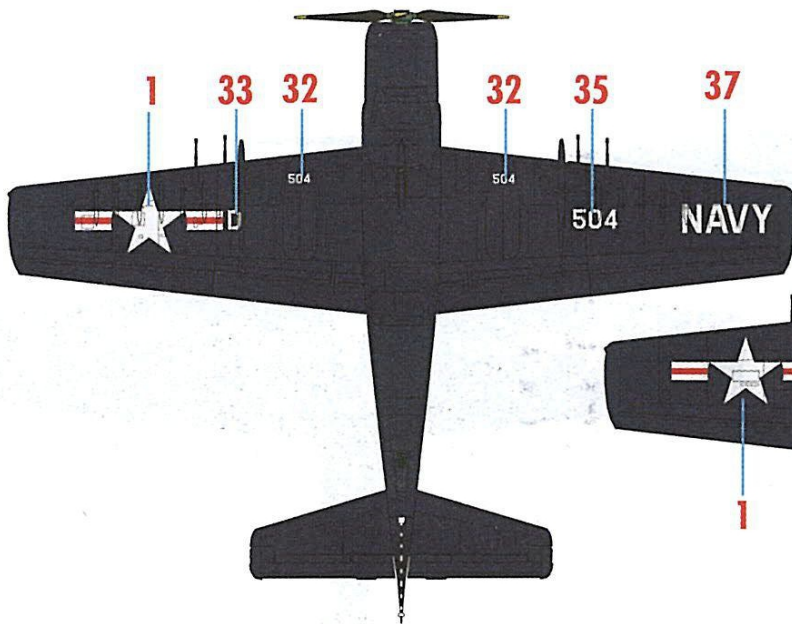
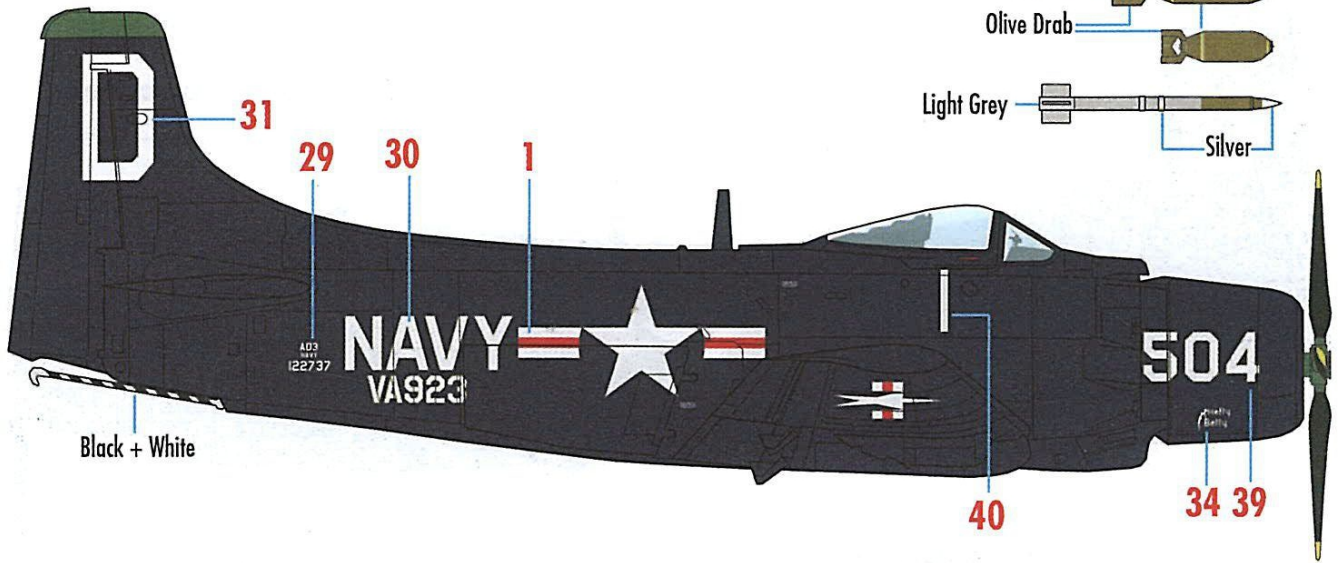
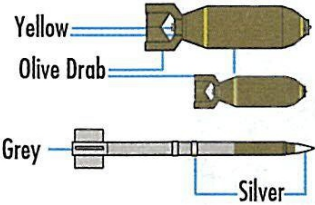
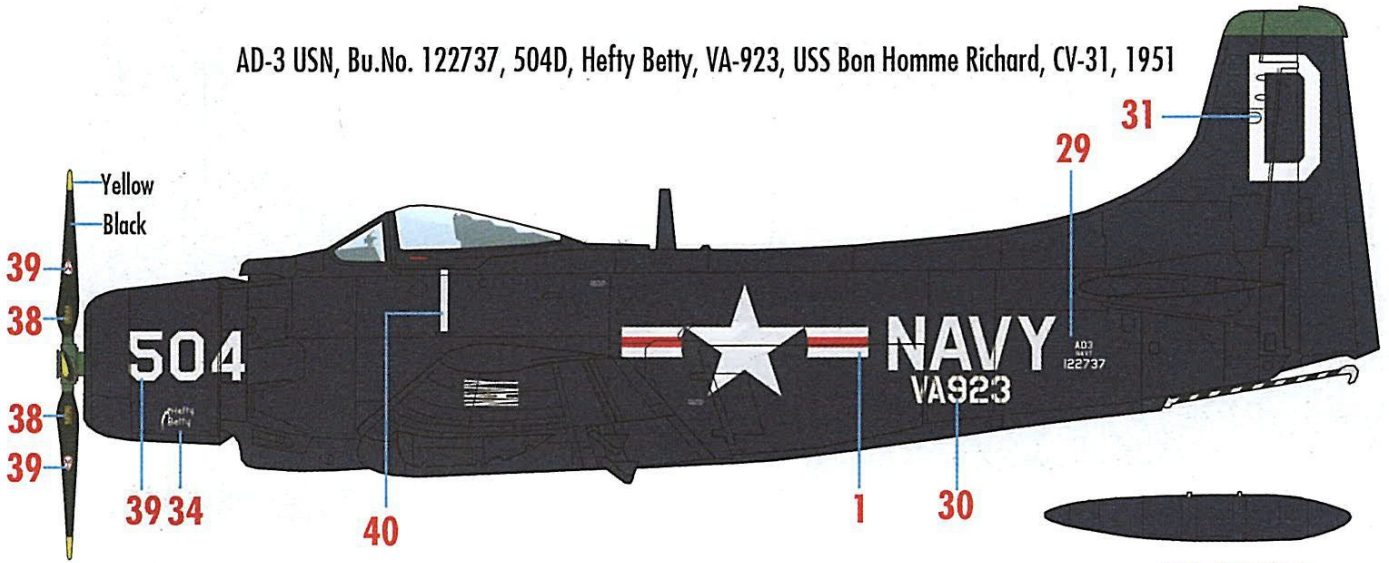

Gloss Sea Blue FS 15042

Gloss Medium Green FS 34115

AD-3 USN, Bu.No 122799, 503K, VA-35, USS Leyte, CV-32, 1950

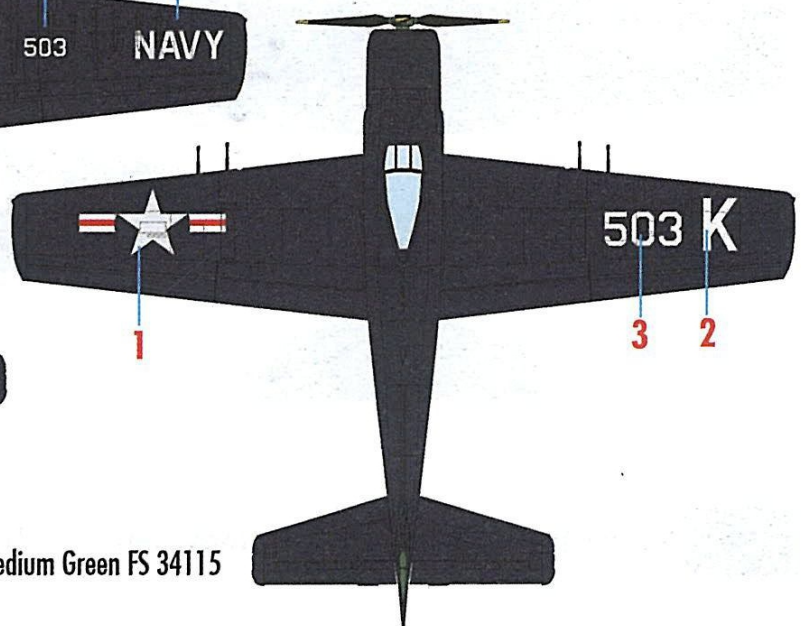
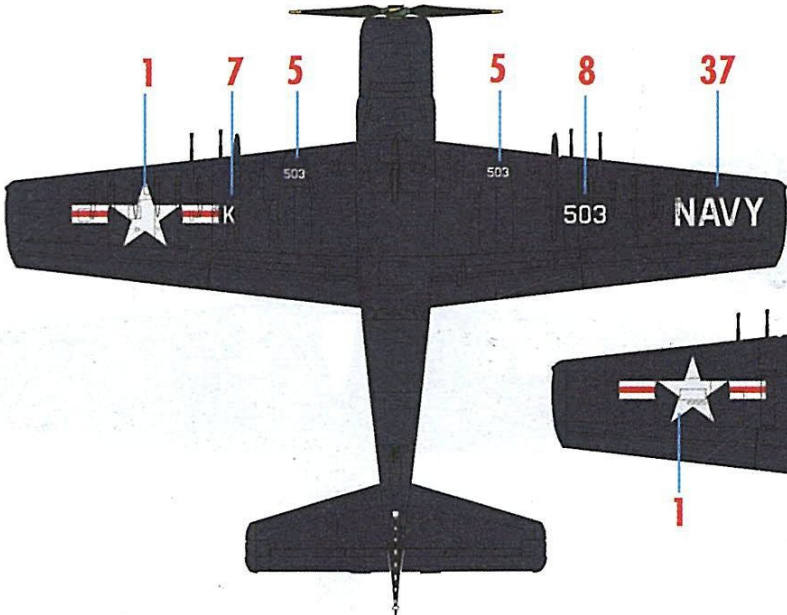
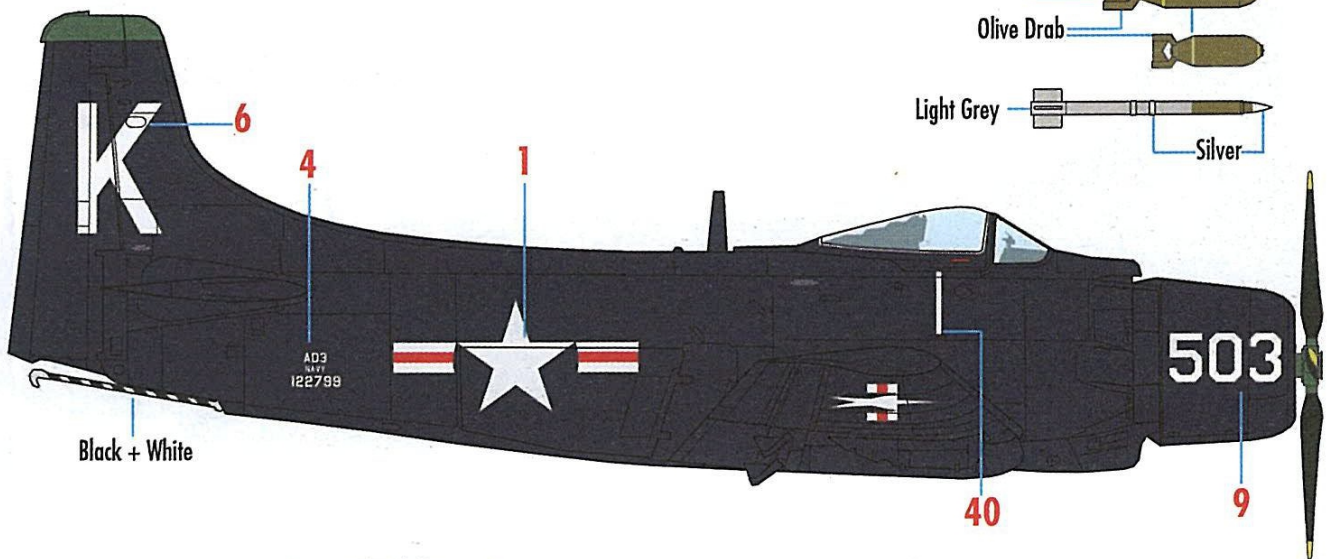
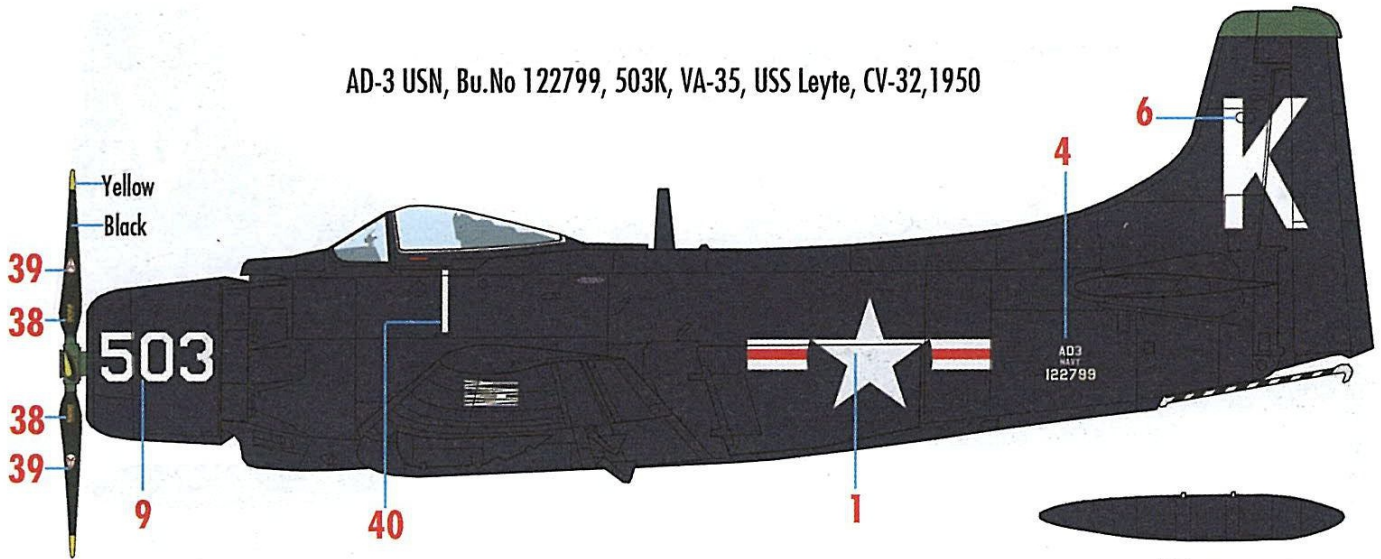

Gloss Sea Blue FS 15042
 
 Gloss Medium Green FS 34115

AD-4 USN, Bu.No 123851, 503V, VA-115, USS Philippine Sea, CV-47, 1951

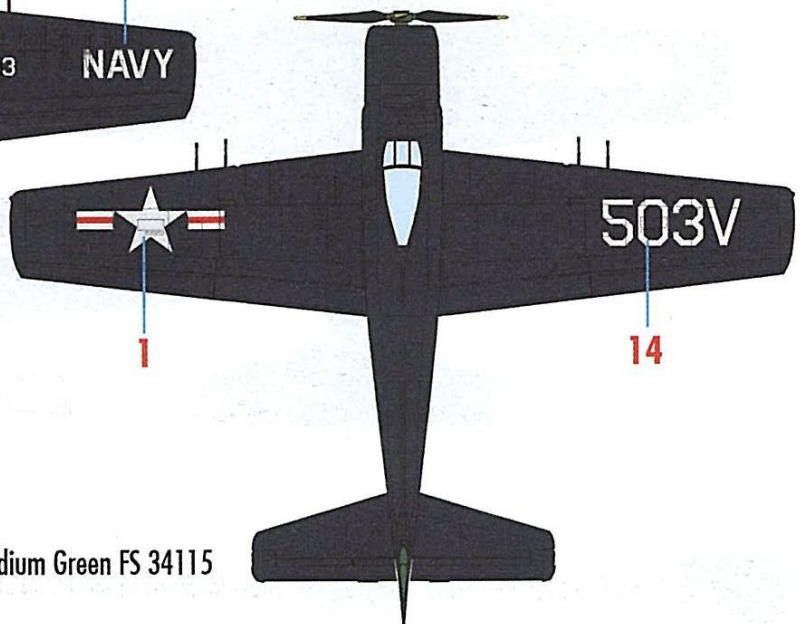
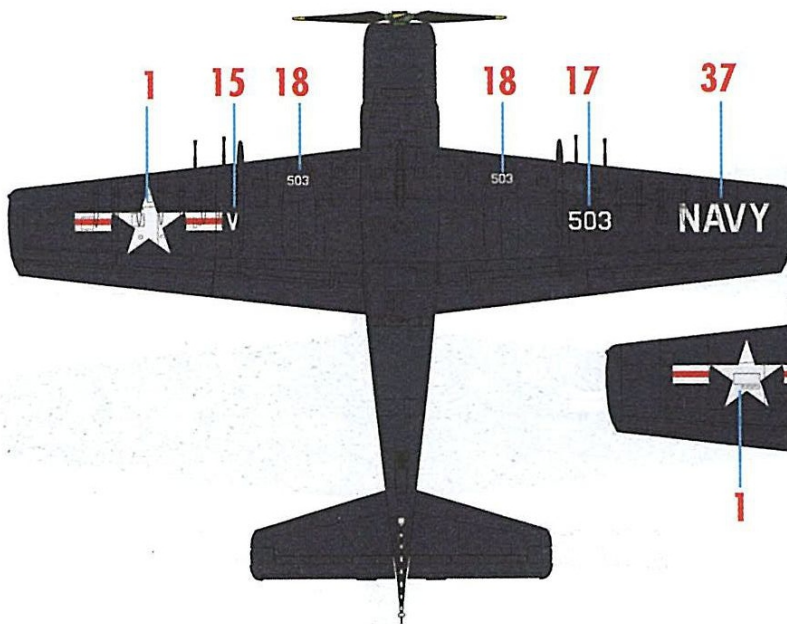
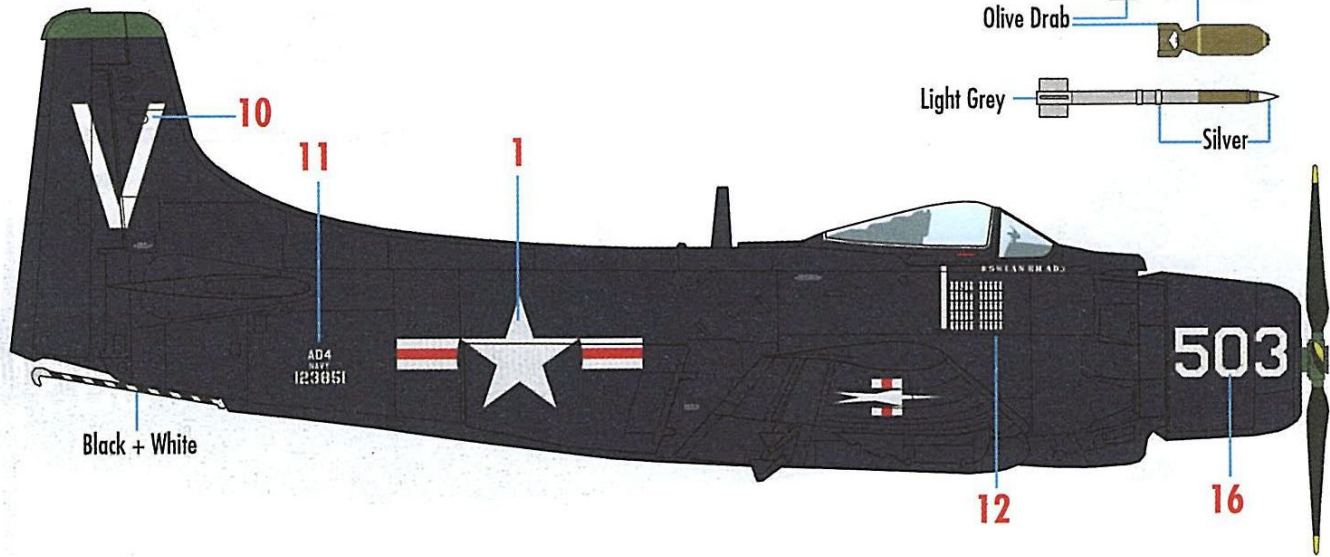
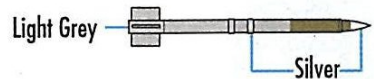
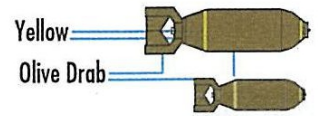
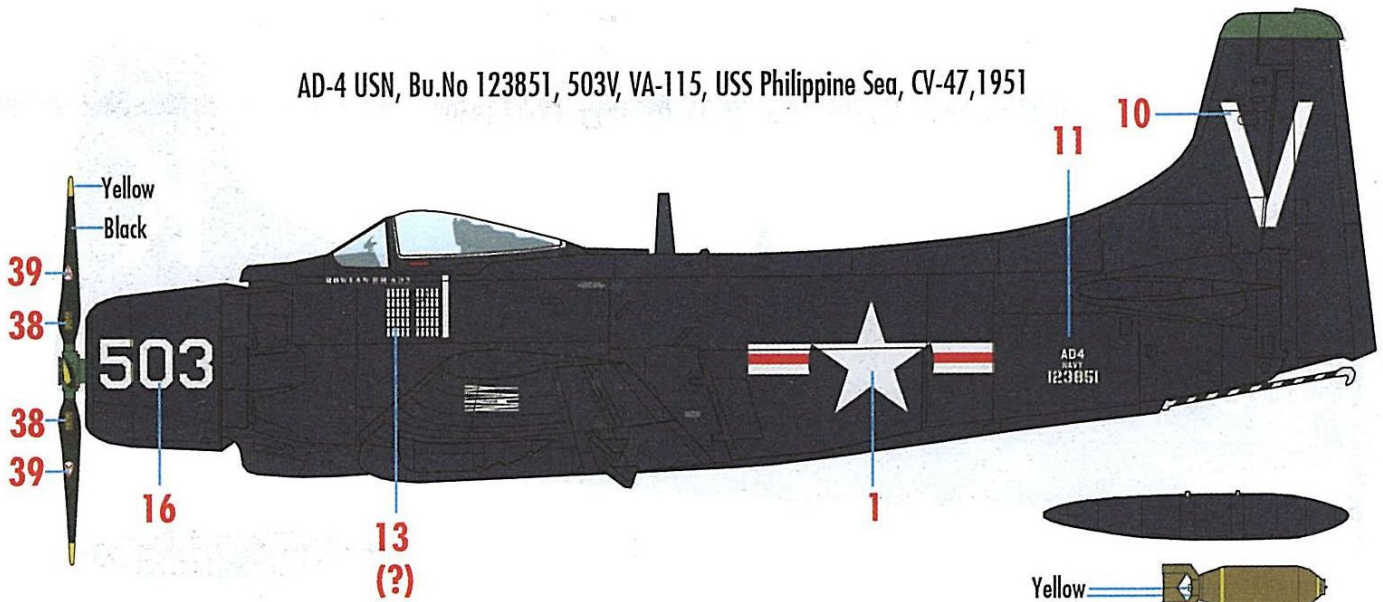

Gloss Sea Blue FS 15042

Gloss Medium Green FS 34115