

1/76th Scale Austin 10 Utility {Communications vehicle}

This vehicle was based upon the Austin 10 car chassis, with the rear passenger section converted to a pick-up style body, with a canvas tilt provided. They were one of the main general communications vehicles, and were to be found at virtually all service installations. They were used by both the RAF and USAAF, by all the British and Commonwealth services, and by US Forces in Europe. Post-war, many survived into civilian use well into the 1960s.

Colour schemes varied - RAF Blue/Grey, dark earth, dark green, dark green with black Mickey Mouse Ear camouflage. The canvas tilts were generally of a lighter shade to the body paintwork. Seat and door trims on earlier vehicles were green or brown rexine material, later vehicles having khaki or dark green canvas covered seats. Tyres black.

This kit is one of a number of 1/76th and 1/72nd army and airfield vehicles available in the Flightpath and Firing Line ranges.



FLIGHTPATH

Trefacwn Fach,
Llanrhian, St. Davids,
Dyfed, SA62 6DP, Wales.

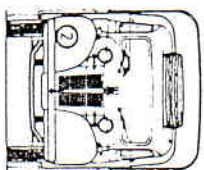
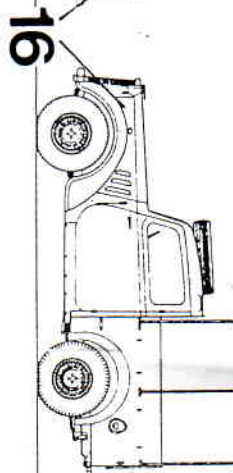
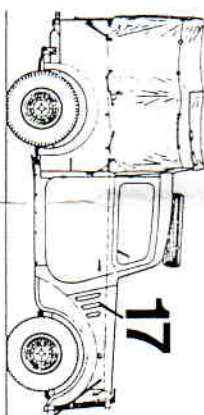
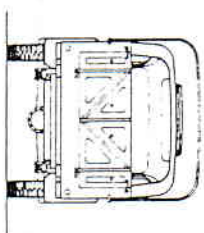

FOLDING SEATS

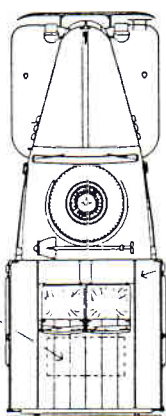

FUEL TANK (under floor)

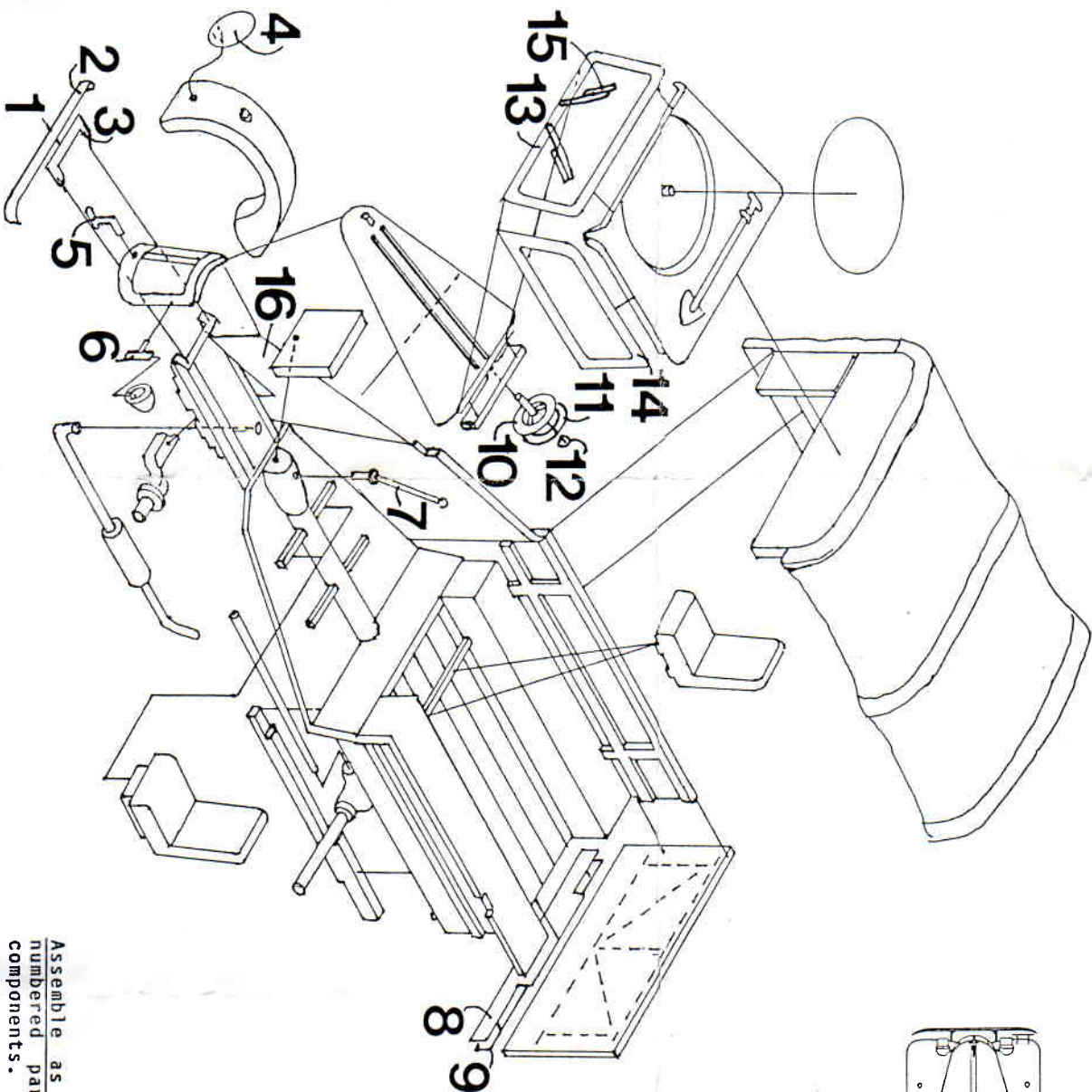

Assemble as per drawings - Note that numbered parts refer only to etched components.