

B. W. MODELS.

HALLAM AIRCRAFT TRACTOR.

It is not known exactly when the Hallam Aircraft Tractor was introduced into RAF service, but it is believed to have been sometime in the 1960's. It was a familiar sight on most if not all RAF Airfields and besides it's main function of Aircraft movement it was also used by the ground staff to move all the various types of towed Ground Support Equipment necessary for the everyday function of aircraft and the airfield. They served through into the 2000 era, with some being disposed of as late as 2009. They served around the world and during their service life have been seen in the various colour schemes used.

GENERAL NOTES.

Please read all the instructions carefully before commencing assembly. Clean all sprue marks and any flash from the pieces before starting and carry out a dry fit of parts before permanently attaching pieces. The model can be assembled using either Superglue, 5 minute epoxy adhesive or Low Melt Solder. The kit contains 25 pieces, including 2 pieces of Acetate for glazing purposes and below is a suggested sequence for assembly.

ASSEMBLY INSTRUCTIONS.

- 1). Fit the internal cab front wall into place, the bottom of the wall being flush with the bottom of the front inner face of the cab.
- 2). Fit the steering wheel to its location point on the top of the dash.
- 3). Fit the hand brake lever to its location point on the cab front panel.
- 4). Fit the 2 seats into place, ensuring that when located, they don't foul the cab sides.
- 5). Fit the cab rear wall into place. Note that it will be necessary to chamfer the rear sides and roof of the cab and the sides and top of the cab rear wall to ensure it fits properly.
- 6). Fit the cab unit onto the body floor.
- 7). Fit the cab roof into place.
- 8). Fit the 2 side boxes to the underside of the body floor, location strips are provided for them to sit against. The vertical face of each box goes to the rear, with the steps facing outwards.
- 9). Fit the rear towing plate into position. The bottom of the plate has the towing brackets right down to the bottom.
- 10). Fit the front towing plate into place. The cut out in the plate goes to the top.
- 11). Fit the wheels to the axles.
- 12). Fit the complete axle units to the body underside. Noting that with the rear wheels, the arrow pattern of the tread should point forwards.
- 13). Fit the hazard beacon to the centre of the roof.
- 14). 3 small spotlights are provided and these were normally fitted, one to each front corner of the roof with the 3rd being mounted on the rear cab outer wall. Location points being provided for all 3.

PARTS LIST.

Cab shell.	Cab rear wall.	Cab front wall unit.	Steering wheel.
Hand brake.	Hazard beacon.	Seat x 2.	Body floor unit
Cab roof.	Side box x 2.	Front towing plate.	Rear towing plate.
Axle x 2.	Font wheel x 2.	Rear wheel x 2.	Spotlight x 3.
Acetate x 2.			

Hallam Aircraft Tractor.

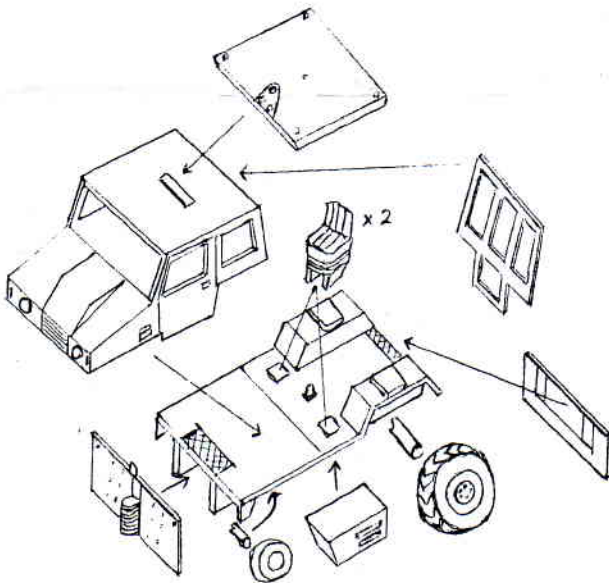
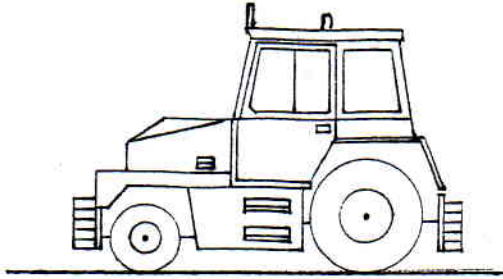

It is hoped you enjoyed building this kit. It is one of an ever increasing range.
If you have any complaint, comments or suggestions for future kits, please contact the address below.
If you require an up to date price list, send an A5 size Stamped Self Addressed Envelope to:-

**B W MODELS, Hillcrest, Kirk Brae, Cuminstown, Turriff,
ABERDEENSHIRE AB53 5YZ**