

# LEYLAND NATIONAL SINGLE DECK BUS Mk I

## 10.3 m SINGLE AND DUAL DOOR VERSIONS

### HISTORICAL NOTES

On the 20th February 1971 Harold Wilson inaugurated the construction of a new factory at Workington built specifically to produce a standard single decker at a rate of 2,000 per year with production to begin in 1971. The factory cost £8 million and initially employed 300 people. The new bus appeared at the Commercial Motor Show at Earls Court in 1970 and stole the show. The Leyland National was born.

London Country initially ordered 70 single door versions and later took a further 77. London Transport referred to the National dual door version as the LS type and went on to take 437 of them. Greater Manchester bought 104 and the National Bus Company bought 500 in one year alone.

In total over 7,700 were built and at one stage were in use with 77 different operators. Many having been sold on the second hand market are still in use today. Production stopped in 1979 when it was replaced with the Mk II Leyland National.

Many versions of the Mk I have been made available in both 10.3m and 11.3m lengths, single, dual or four door, left hand or right hand drive. A choice of engines has been offered; the original versions having the Leyland 500 series engine. They were also available with no roof pod, a short pod or a long pod.

### LIVERY

We suggest the use of Humbrol paint as it is readily available and inexpensive. However, there may be some difficulty in obtaining the Humbrol authentic colour range of paints. We have therefore given the Humbrol paint colour number and in the case of the authentic range an equivalent colour from the Precision Paint range. We should also like to point out that Cherry Scale Paints now produce an excellent range of authentic bus colours. They are supplied in a substantially larger tin than Humbrol and obviously cost more. If not available in your local model shop a stamped, self addressed envelope to Tower Models will bring you a list of available Cherry paints. Use the box artwork as a guide to painting.

**INTERIOR** (all versions) It should be remembered that some of these buses have now been in service for twenty years. They have been repainted and have had the seats recovered. However, when new they were as follows:-

The interior doors and the whole cab area were matt black No.33, the floor was chocolate brown No. 98, the sides up to the level of the lower edge of the window dark earth No. 29 and the sides from the lower edge of the window up were cream No. 103. The ceiling was very light grey No. 40.

The seats tended to vary from operator to operator but generally were as follows.

**LONDON TRANSPORT:** back of seats dark earth No. 29 with the seats themselves Indian red No. HR110 (or Precision B54).

**LONDON COUNTRY:** back of seats dark earth No. 29 with the seats matt emerald green No. 2 matt varnished.

**MANCHESTER:** had the back of the seats light grey No. 40 with the seats themselves orange No. 18 matt varnished. **BLACKPOOL:** had seat backs in grey No. 64 and the seats themselves in orange lining No. 82.

**EXTERIOR LONDON TRANSPORT:** basic body all red No. 19, bumper cream No. HR114 (or Precision B15). The hubcaps are Indian red No. 110 (or Precision B54) and the tyres matt black No.33 Indicator lights are orange No. 18.

**LONDON COUNTRY:** basic body emerald No. 2 with a cream stripe No. HR114 (or Precision B15). The tyres are matt black No. 33 and indicator lights orange No. 18.

**GREATER MANCHESTER:** body is orange No. 18 and ivory No. 41. The wheel hubs are Indian red No HR 110 (or Precision B54) and the tyres are matt black No.33. Indicators orange No. 18.

**BLACKPOOL:** body is emerald No. 2 and ivory No. 41. The tyre are matt black No. 33 and the indicators orange No. 18.

### USE OF TRANSFERS (DECALS)

The box artwork should be used as a guide to the positioning of the transfers. The transfers are of the water slide type. Carefully cut around each decal removing it from the sheet. Soak for a few seconds in luke warm water sliding it off the backing paper. Position it on the model, absorbing excess water with a tissue. They should be allowed to dry for 24 hours and once dry a coat of varnish should be applied to protect them.

The adverts are optional as not all buses carried them. The front route indicator on all versions should be painted gloss black No. 21, the front route destination transfer can then be applied. On the London Transport version the rear route indicator should be painted black and the route number only transfer applied centrally. The London Country rear route indicator was not used. An optional advert is supplied or the panel can be painted either black or green to choice. Manchester did not use a rear route destination so the panel should be painted black. Blackpool also did not use the rear panel so it should be painted black.

Only one set of transfers is supplied per kit, this being indicated by the box artwork. However, transfer sets are available separately direct from Tower Models. An S.A.E. will bring details.

## SAFETY WARNING

All possible care has been taken in the preparation of this kit, the plastic used in it and the transfer set supplied. However young children and small animals should never be allowed to put parts into their mouths. Also keep the polythene bag, glue and sharp modelling tools away from children and animals. The kit including the box, plastic parts, transfers and instructions are all approved to British Standard Regulation EN 71 (BS 5665 parts 1,2 and 3).

## GENERAL NOTES ON ASSEMBLY

Carefully remove parts as required from the sprue using a sharp modelling knife. Trim as necessary ensuring a perfect fit. Use only plastic cement (either the tube, Liquid Poly, Plastic Weld or similar). Apply only the minimum amount of glue and remember that glue will not stick painted parts so ensure that edges to be stuck are clean. It will be necessary to paint the interior parts prior to assembly and glueing as it will not be possible later.

### LIST OF PARTS (see diagrams A,B,C,D,E & F)

- 1 Front end
- 2 Dash board
- 3 Steering wheel
- 4 Drivers side
- 5 Front floor section
- 6 Internal step
- 7 Rear floor section
- 8 Driver's panel
- 9 Seating (single door version only)
- 10 Seating (dual door version only)
- 11 Front bumper
- 12 Rear end
- 13 Rear bumper
- 14 Near side (single door version only)
- 15 Near side (dual door version only)
- 16 Roof
- 17 Long pod (optional)
- 18 Short pod (optional)
- 19 Pod back section (optional)
- 20 Front axle
- 21 Front wheels
- 22 Rear wheel mounting
- 23 Inner rear wheels
- 24 Outer rear wheels
- 25 Rear hub caps
- 26 Front hub caps

### GLAZING PARTS (See diagram G)

- A Front end glazing
- B Drivers side glazing
- C Rear end glazing
- D Front door glazing
- E Near side front glazing
- F Near side centre glazing (single door version only)
- G Centre door glazing (dual door version only)
- H Near side rear glazing
- I Front head lights

**Please note:** Part 14 is only supplied with single door version, part 15 is only supplied with dual door version.

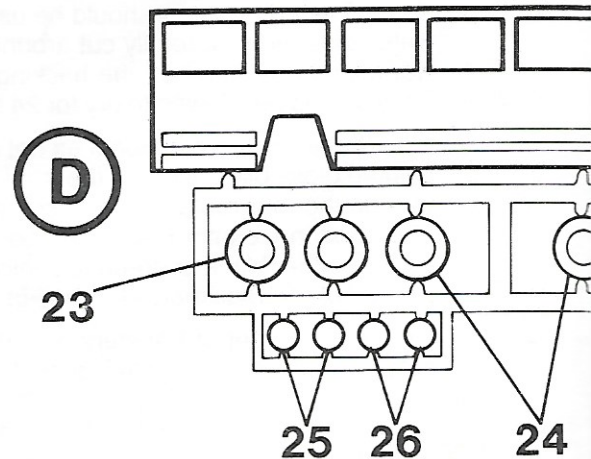
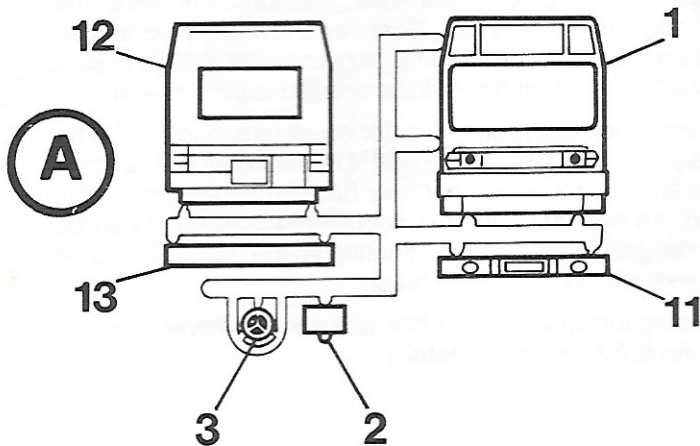
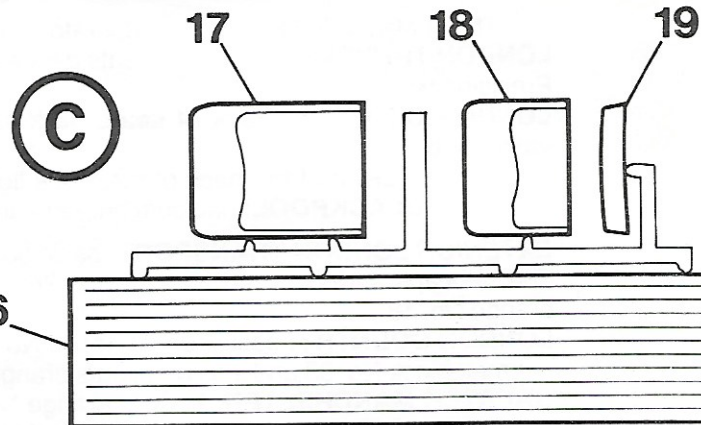
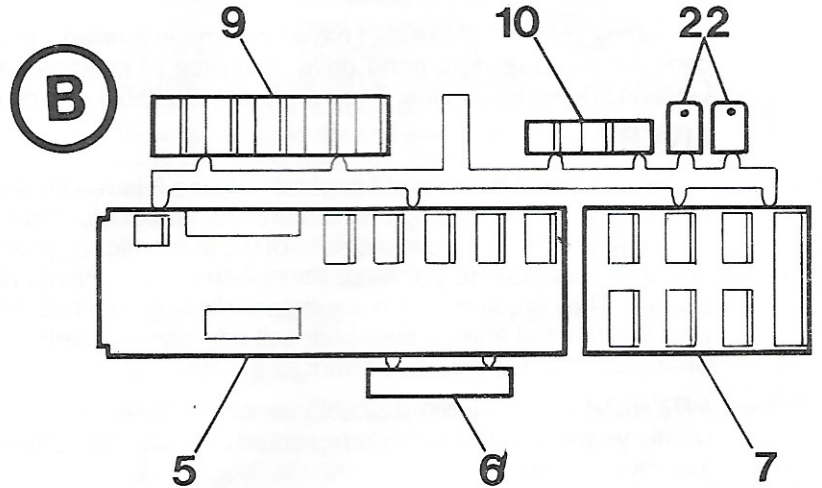

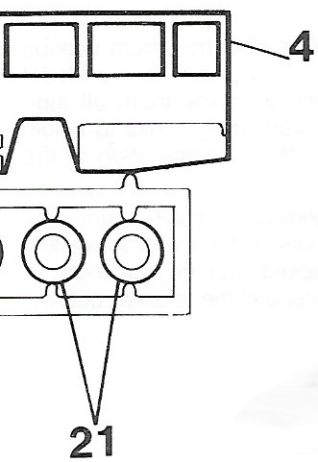
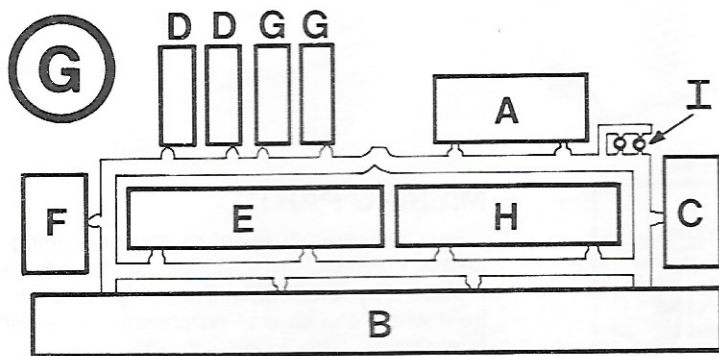
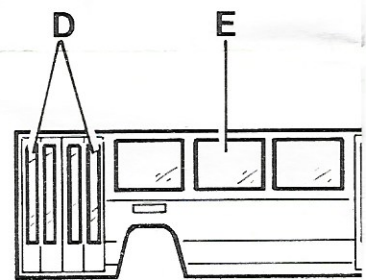
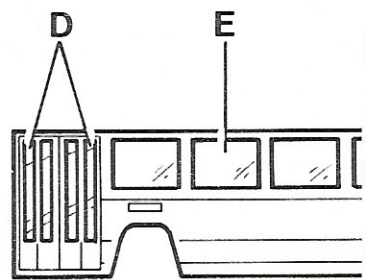
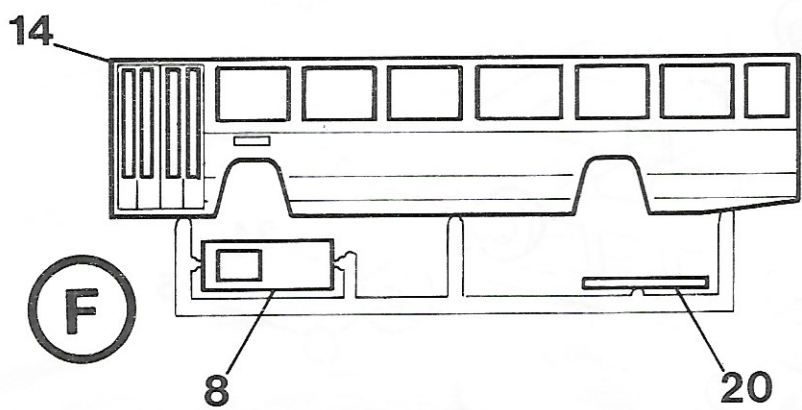
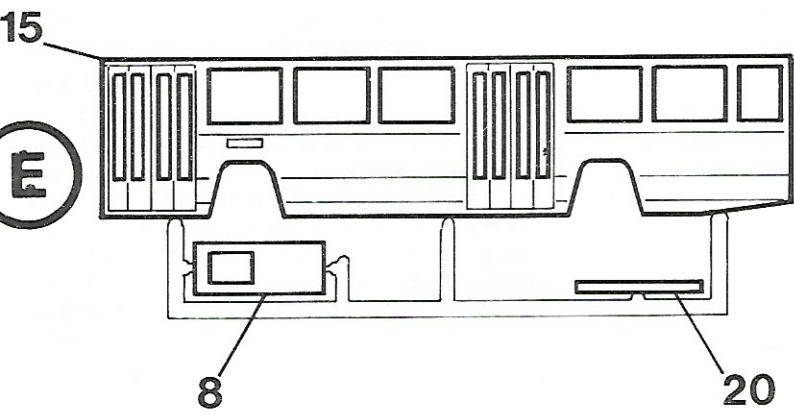

2

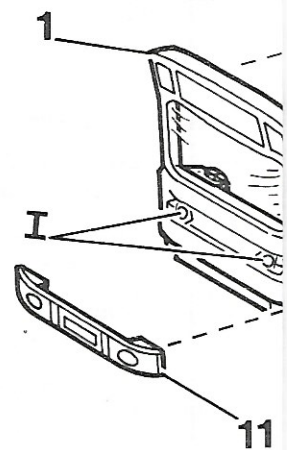

## ASSEMBLY INSTRUCTIONS

Before commencing assembly familiarise yourself with the position of all parts on the sprues. Read the assembly instructions and study the exploded diagrams. Separate each part as it is required from the sprue using a sharp knife. Do not try to pull the parts off the sprue as it will only result in the parts being damaged.

These instructions cover the construction of two versions of the kit, the single door and the dual door. The kits are basically similar with parts **9, 14 and F** being specific to the single door version and parts **10, 15 and G** are specific to the dual door version. The roof pod is optional. The vehicle can be built with a long pod (parts **18 and 19**) or a short pod (parts **18 and 19**) or without a pod.

**SEE DIAGRAM 1:** Fit and glue in place front end glazing part **A** into front end part **1**. Glue steering wheel **3** to dash board **2**. Glue dash board in place as shown in diagram 1. Set aside to dry.

**SEE DIAGRAM 2:** Glue glazing strip **B** to drivers side **4**. Glue part **5** front floor section between the locating ribs on the side **4**. Part **6** the step, fits vertically on top of the rear end of part **5** so that part **7** sits on top of part **6** whilst locating into position on top of the rib at the rear of the side part **4**. Do a trial dry run to check the fit as some trimming of part **6** may be necessary. Glue parts **4, 6 and 7** together. Allow to dry and in the meantime assemble the rear end parts **12, 13 and glazing C**. Fit front bumper **11** and headlights **I** to front end part **1**. Now fit front end **1** to floor **5** and rear end **12** to rear floor **7**. Allow assembly to dry having first checked for a good square fit. Glue part **8** to the back of the driver's seat.

**SINGLE DOOR VERSION ONLY:** Now glue part **9** in place.

**DUAL DOOR VERSION ONLY:** Now glue part **10** in place aligning with the seats on the opposite side.

**SEE DIAGRAM 3**

**SINGLE DOOR VERSION ONLY:** Glue into place glazing **D, E, F and H** on near side part **14**. **ALLOW TO DRY.**

**DUAL DOOR VERSION ONLY:** Glue into place glazing **D, E, G and H** on near side part **15**.

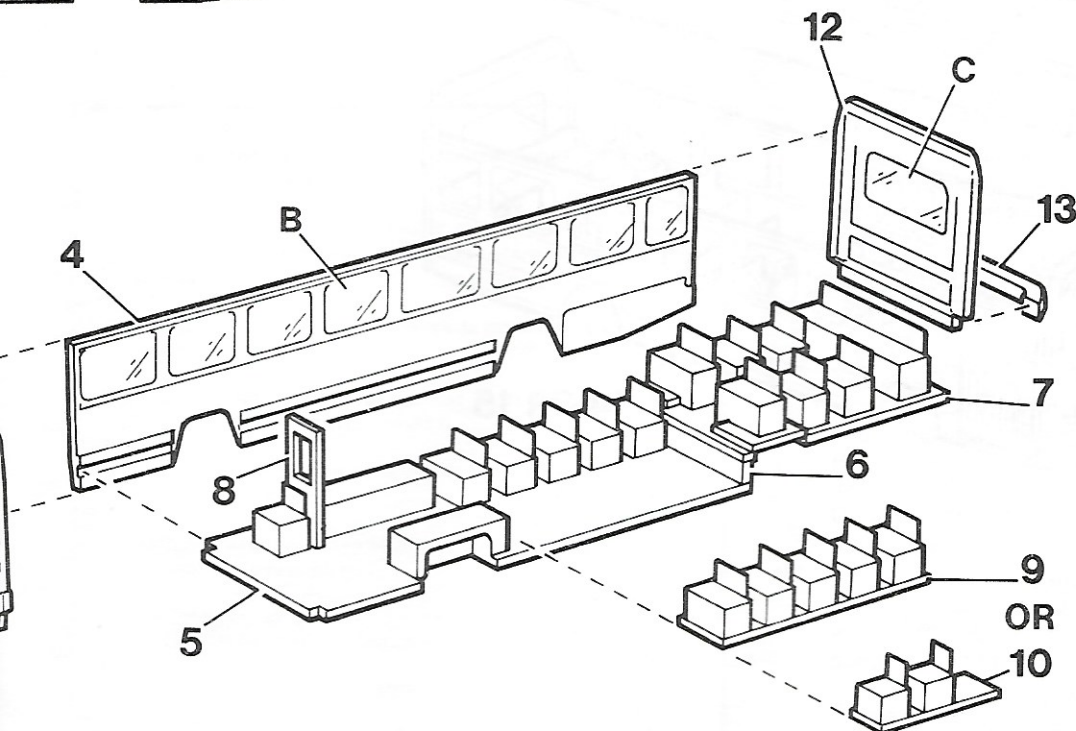
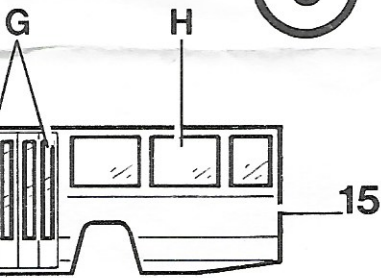
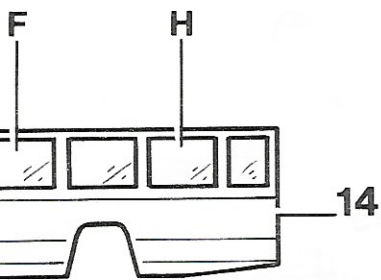
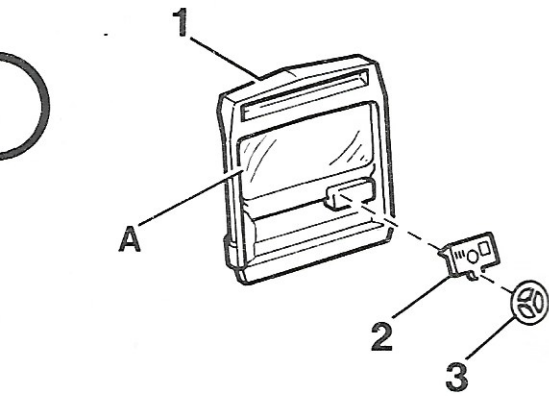

**SEE DIAGRAM 4**

Fit near side either part 14 or 15 to body assembly. Check for a good square fit and glue into place. The roof part 16 can now be glued into place. If required the short or long roof pod can now be assembled and fitted. Allow assembly to dry.

**SEE DIAGRAM 5**

Turn the assembled body upside down. Fit hub caps parts 25 and 26 to the front and rear wheels 21 and 24. The rear wheel mounting part 22 should be glued vertically in place against the locating rib. Allow to dry and in the meantime fit the inner and outer rear wheels parts 23 and 24 together. Now fit rear wheels to part 22. Glue front axle part 20 in place and glue front wheels to the axle. Allow time to dry thoroughly before standing the vehicle on its wheels. Complete painting of all exterior parts and when thoroughly dry apply transfers.

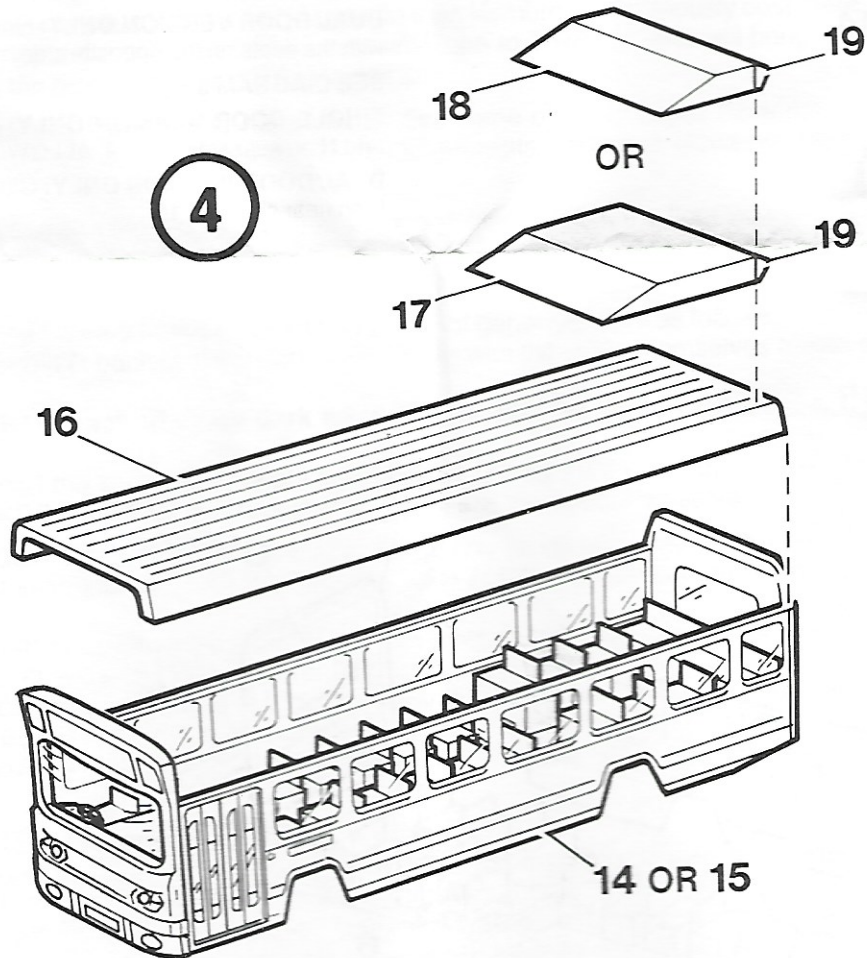

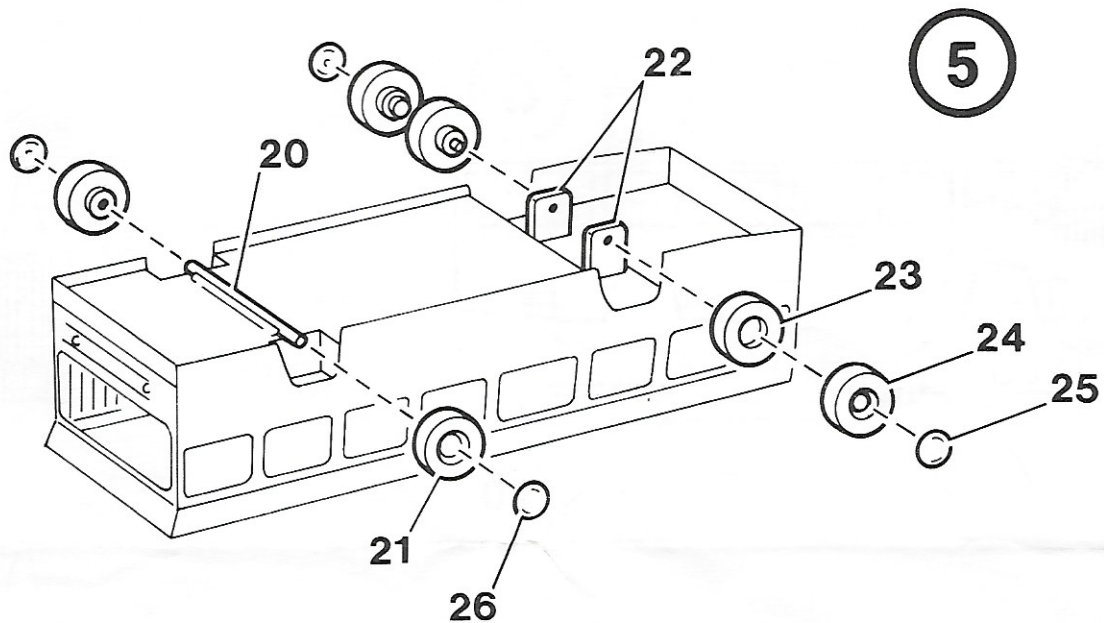

CAUTION: NOT SUITABLE FOR CHILDREN UNDER 3 YEARS.  
CONTAINS SMALL PARTS.

CERTAINS PRODUITE CONTIENNENT DES PIÈCES DE PETITE  
DIMENSION QUI NE CONVIENT PAS À UN ENFANT DE MOINS DE  
36 MOIS.

VORSICHT: NICHT FÜR KINDER UNTER 36 MONATEN - ERHÄLT  
KLEINE TEILE.

PRODOTTO NON ADATTO AI BAMBINI DI ETA INFERIORE AI  
36 MESI. CONTIENE PICCOLLO OGGETTI.

KAN GEVAAR OPLEVEREN VOOR KINDEREN TOT 3 JAAR. BEVAT  
KLEINE ONDERDELEN.

ATENÇÃO: IMPROPRIO PARA CRIANÇAS COM MENOS DE 3 ANOS.  
CONTÉM PEÇAS PEQUENAS.

ATENCION: NO ES CONVENIENTE PARA NIÑOS MENORES DE  
3 AÑOS. CONTIENE PIEZAS PEQUEÑAS.

FORSIGTIGI IKKE EGNET TIL BØRN UNDER 3 ÅR. INDEHOLDER  
SMA DELE.

ΠΡΟΣΟΧΗ: ΔΕΝ ΕΙΝΑΙ ΚΑΤΑΛΛΗΛΟ ΓΙΑ ΠΑΙΔΙΑ ΚΑΤΩ ΤΩΝ ΤΡΙΩΝ ΕΤΩΝ  
ΓΙΕΡΙΧΕΙ ΜΙΚΡΑ ΤΕΜΑΧΙΑ

## MISSING PARTS

In the unlikely event of any part being missing or damaged please contact Tower Models at the address below and we will replace it by return post. There is no point in contacting the dealer from whom the kit was purchased as he will not carry a stock of spare parts. This in no way interferes with customers' statutory rights but does ensure any problems are dealt with quickly and efficiently.

## ACKNOWLEDGEMENTS

Tower Models have received considerable help from various bus enthusiasts, bus modellers and various members of the Model Bus Federation. It would be impossible to thank them all individually but we would wish to express particular thanks to Robin Crimble who gave considerable help with the preparation of the transfer sets.

Tower Models and its associate company Tower Trams produce a range of plastic bus and tram kits. A full list of these kits along with other related products stocked can be obtained by sending a stamped self-addressed envelope to the address below.

**Tower Models,**  
44 Cookson Street, Blackpool, Lancs.  
FY1 3ED England

Tel: (0253) 23797

Partners: D.A. Brewer and C.A. Brewer.