

Good Bye

TORNADO

F.3 ADV

1/48



eduard

LIMITED EDITION

ATTENTION



UPOZORNĚNÍ



ACHTUNG



ATTENTION



注意



Carefully read instruction sheet before assembling. When you use glue or paint, do not use near open flame and use in well ventilated room. Keep out of reach of small children. Children must not be allowed to suck any part, or pull vinyl bag over the head.



Před započítím stavby si pečlivě prostudujte stavební návod. Při používání barev a lepidel pracujte v dobře větrané místnosti. Lepidla ani barvy nepoužívejte v blízkosti otevřeného ohně. Model není určen malým dětem, mohlo by dojít k požití drobných dílů.

INSTRUCTION SIGNS * INSTR. SYMBOLS * INSTRUKTION SINNBILDEN * SYMBOLES * 記号の説明

OPTIONAL
VOLBABEND
OHNOUTSAND
BROUSITOPEN HOLE
VYVRTAT OTVORSYMETRICAL ASSEMBLY
SYMETRICKÁ MONTÁŽREMOVE
ODŘÍZNOUTREVERSE SIDE
OTOČITAPPLY EDUARD MASK
AND PAINT
POUŽIT EDUARD MASK
NABARVIT

PARTS



DÍLY



TEILE



PIĘCES



部品

PLASTIC PARTS

A>

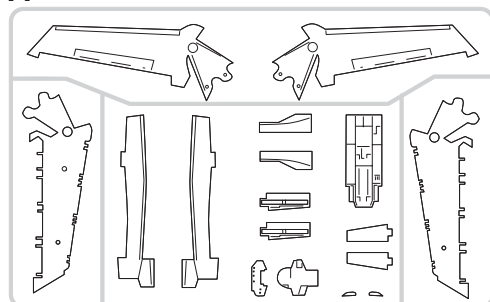

B>

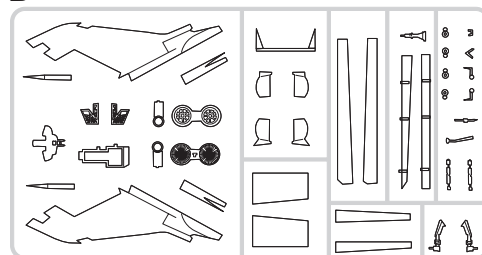

C>

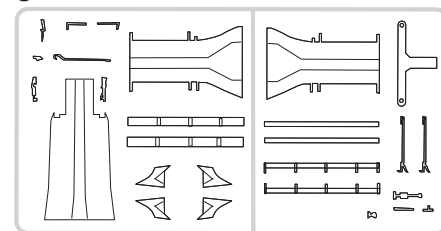

D> 2 pcs.

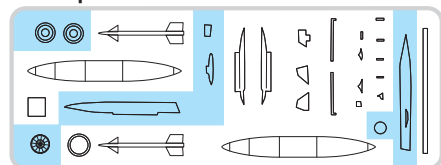

E> 2 pcs.

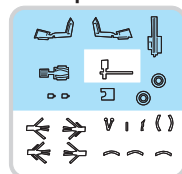

F>

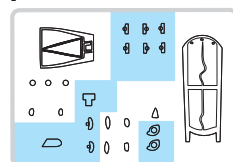

H> 2 pcs.

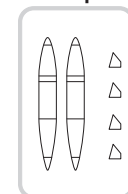

I> 2 pcs.

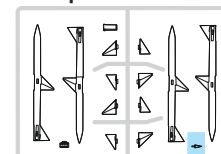

M>

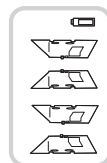

S>

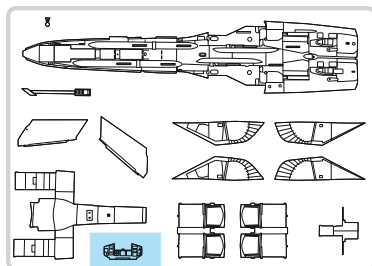

P>

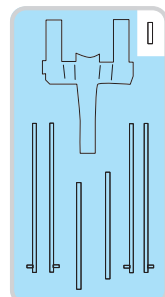

R>

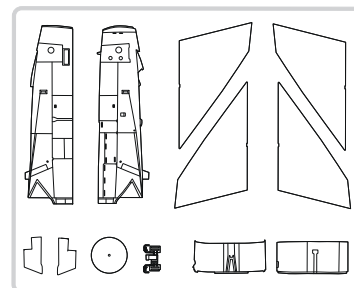
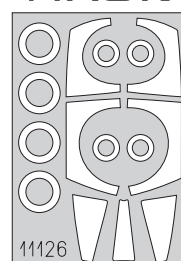
eduard
MASK

PE - PHOTO ETCHED DETAIL PARTS

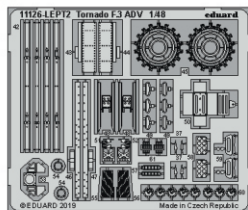
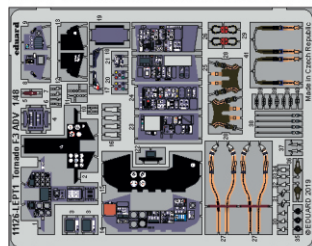

RP - RESIN PARTS

eduard
BRASSIN

R1 2pcs.



R2



R3



R4 2pcs.



R5 2pcs.



R6 2pcs.

R7 2pcs.



R8 2pcs.



R9 2pcs.



FILM



* Use not for use. * Nie wolno mieć kontaktu. * Nicht an die Hand. * -Tyto díly nepoužívejte při stavbě. - 使用しない部品

COLOURS



BARVY



FARBEN



PEINTURE





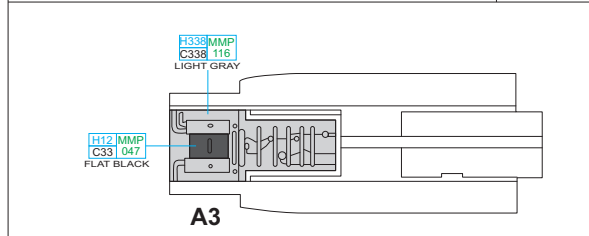
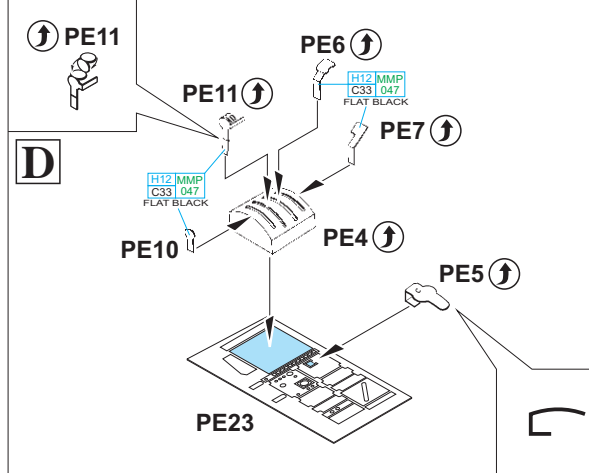
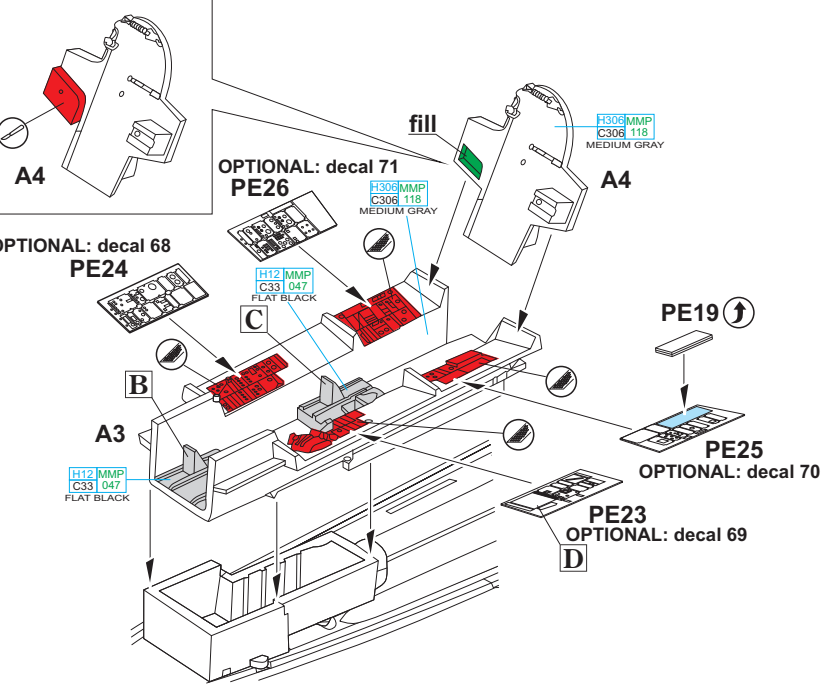
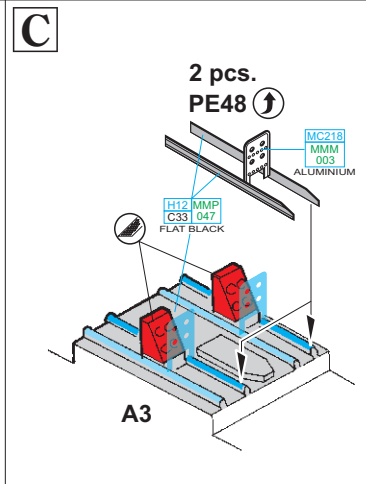
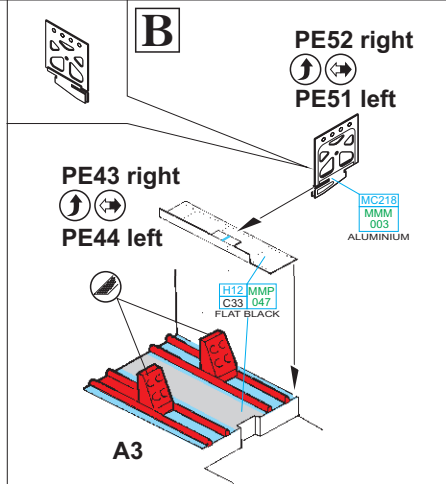
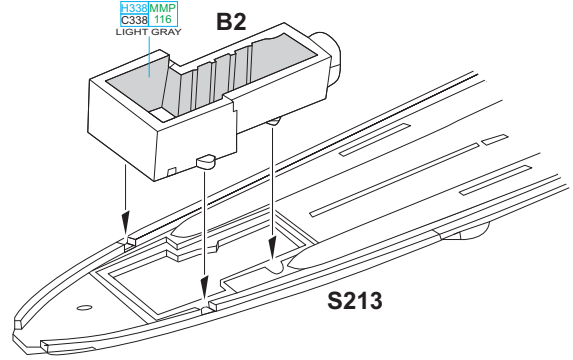
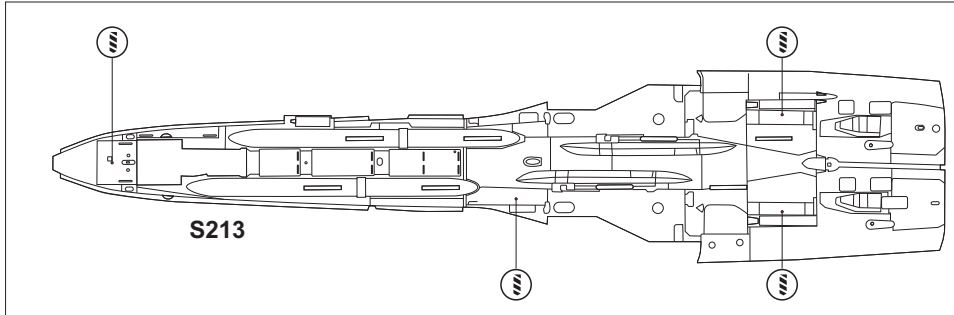
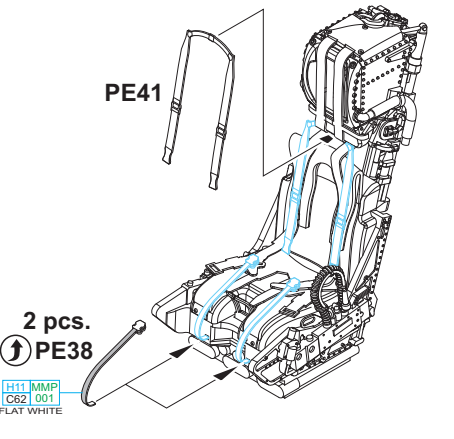
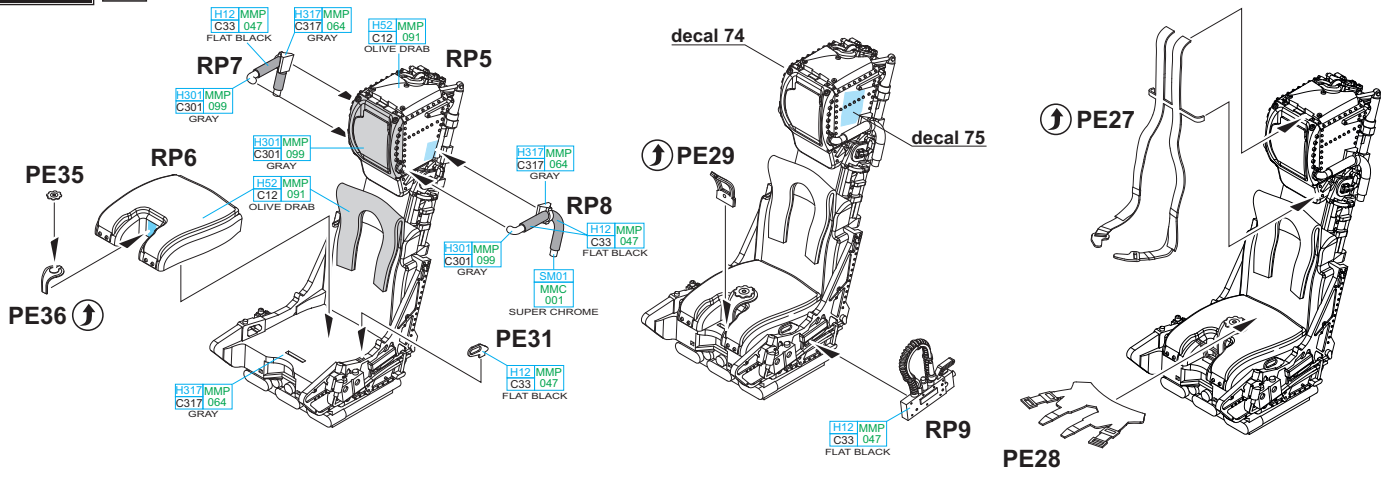

色

GSI Creos (GUNZE)		MISSION MODELS	
AQUEOUS	Mr.COLOR	PAINTS	
H4	C4	MMP-007	YELLOW
H11	C62	MMP-001	FLAT WHITE
H12	C33	MMP-047	FLAT BLACK
H27	C44		TAN
H52	C12	MMP-091	OLIVE DRAB
H77	C137	MMP-040	TIRE BLACK
H90	C47		CLEAR RED
H94	C138		CLEAR GREEN
H301	C301	MMP-099	GRAY
H306	C306	MMP-118	MEDIUM GRAY
H317	C317	MMP-064	GRAY
H327	C327	MMP-101	RED
H331	C331		DARK SEAGRAY

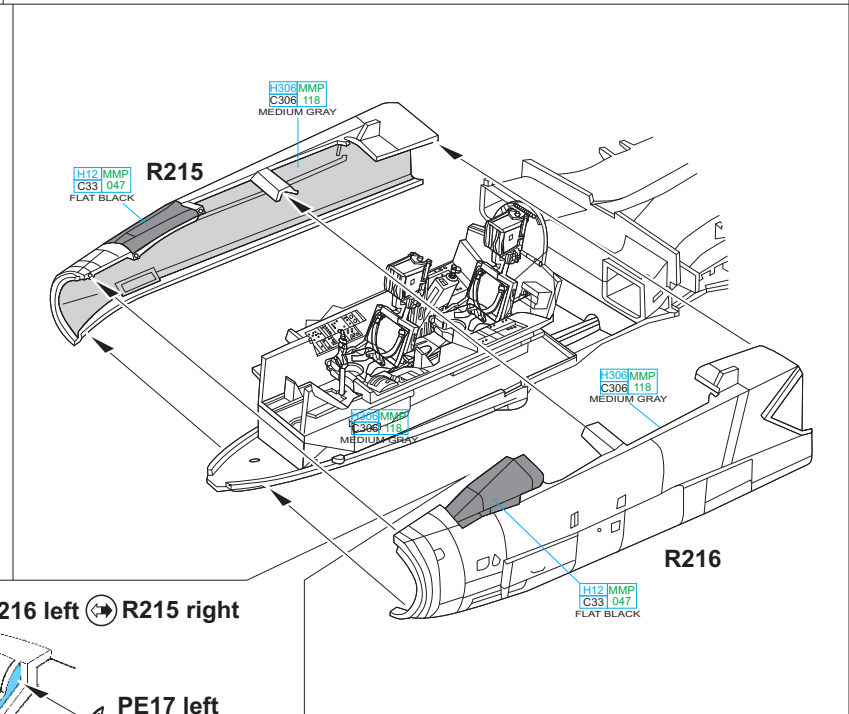
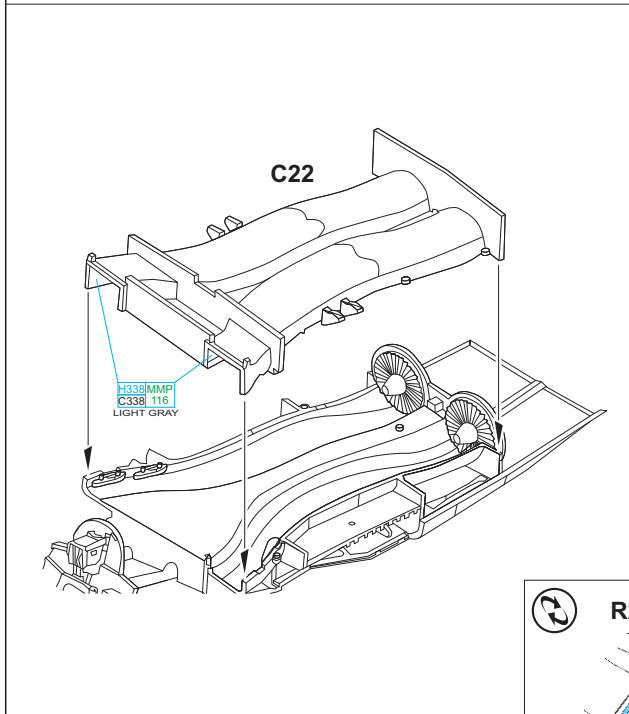
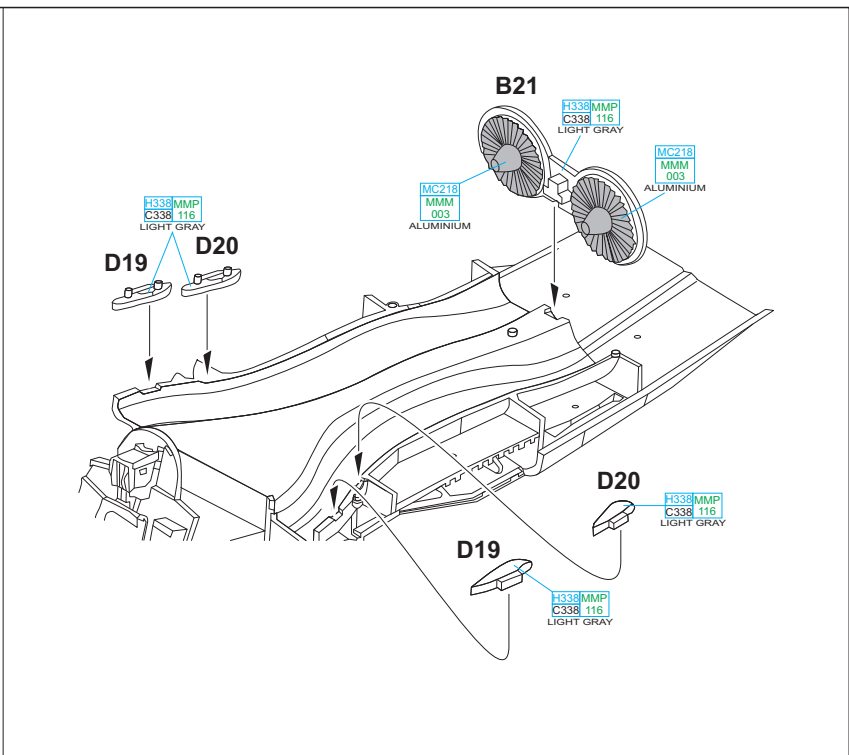
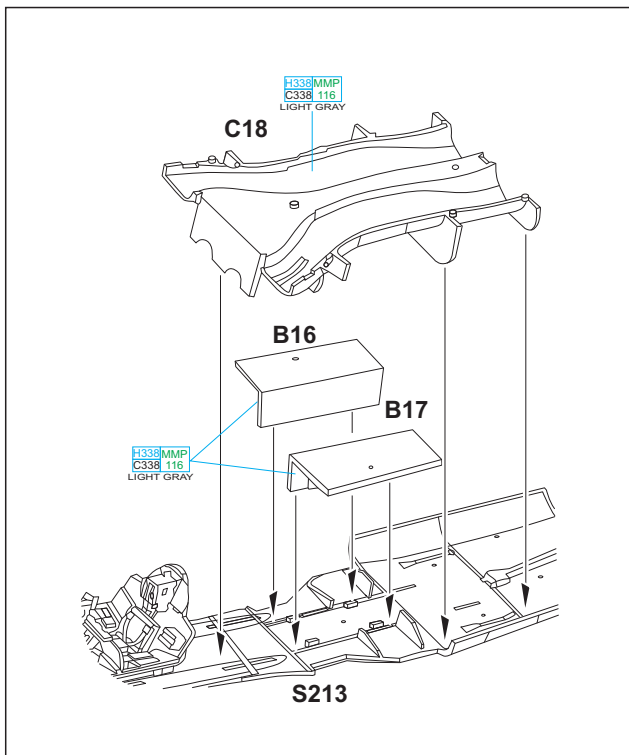
GSI Creos (GUNZE)		MISSION MODELS	
AQUEOUS	Mr.COLOR	PAINTS	
H332	C332		LIGHT AIRCRAFT GRAY
H334	C334	MMP-102	BARLEY GRAY
H335	C363	MMP-094	MEDIUM SEAGRAY
H338	C338	MMP-116	LIGHT GRAY
Mr.METAL COLOR		METALLICS	
MC213		MMM-006	STEEL
MC214		MMM-001	DARK IRON
MC218		MMM-001	ALUMINIUM
Mr.COLOR SUPER METALLIC		METALLICS	
SM01		MMC-001	SUPER CHROME
Mr.COLOR GX		METALLICS	
GX02			UENO BLACK



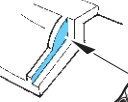

 R216 left ↔ R215 right
 PE17 left
 PE18 right
 OPTIONAL: decal 72 ↔ decal 73

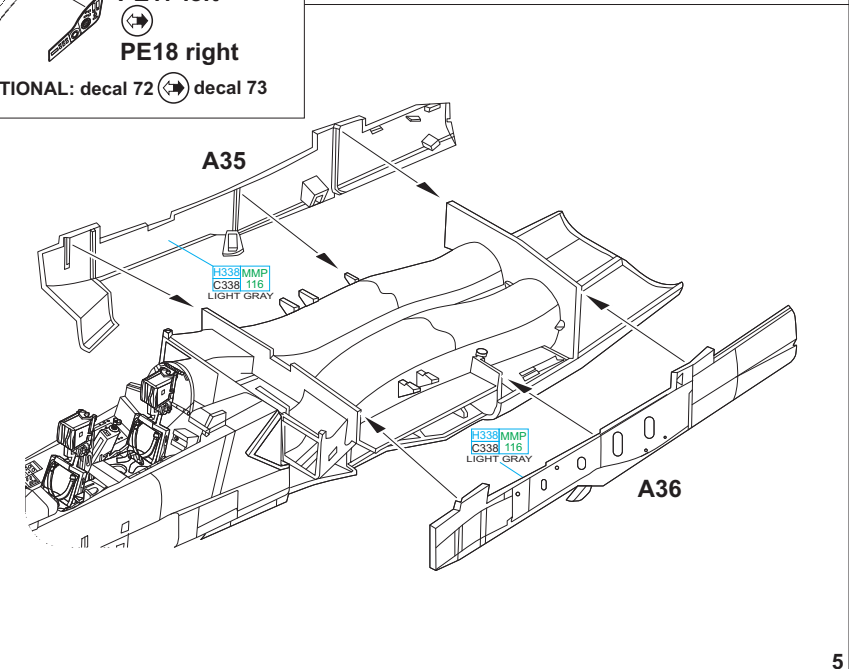
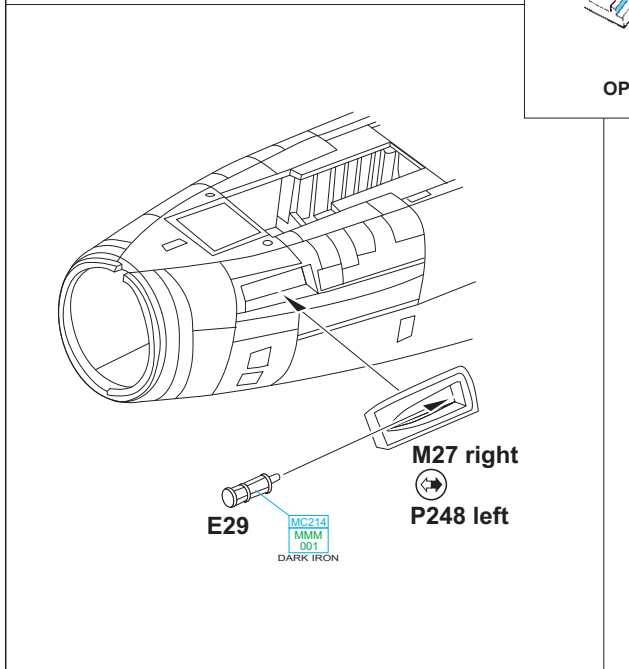

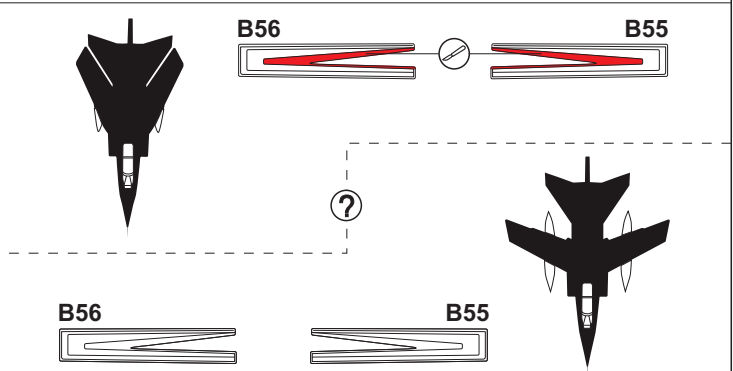
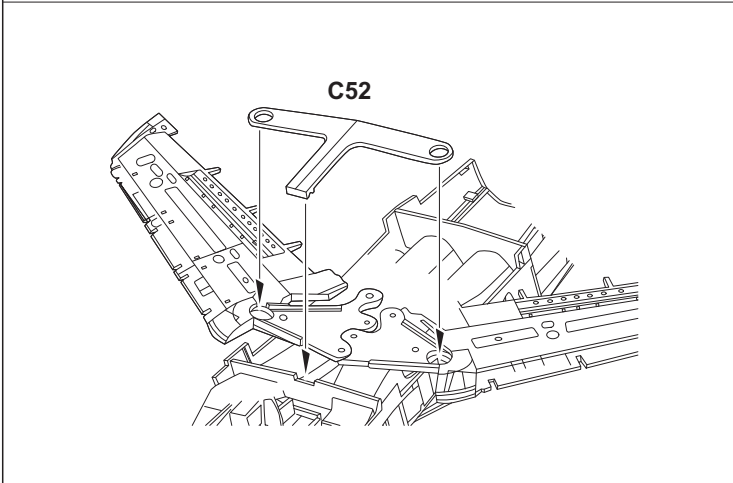
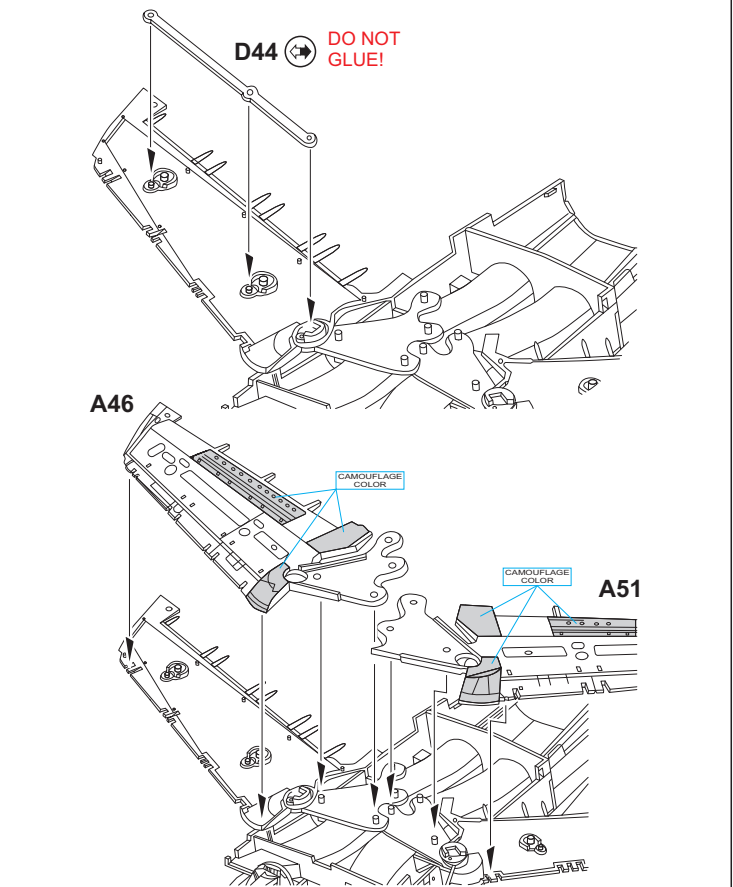
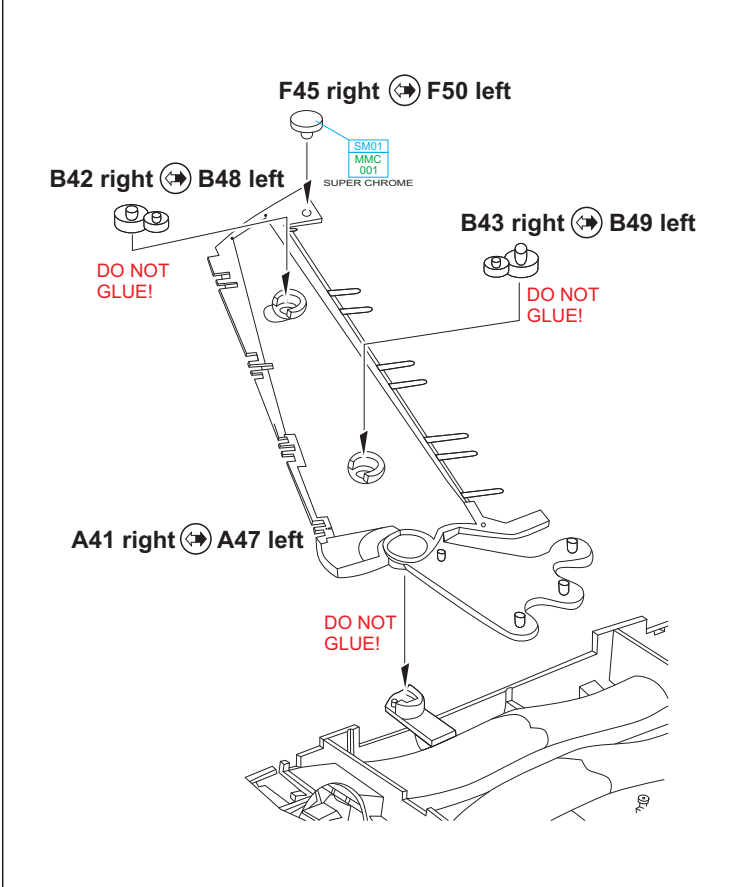
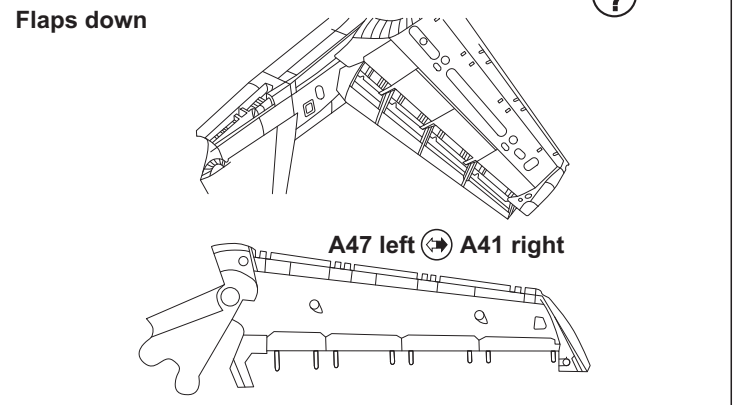
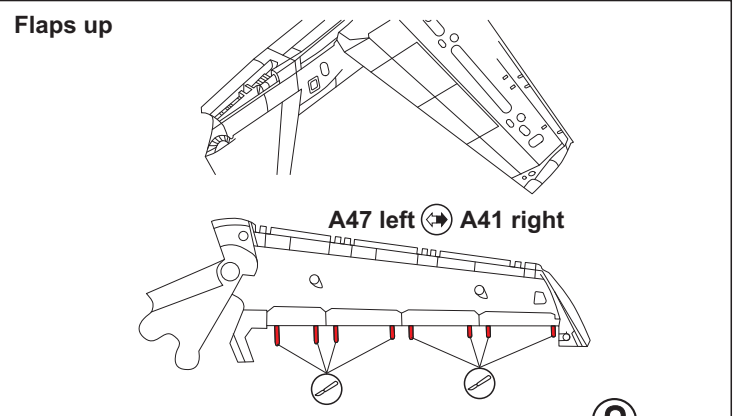
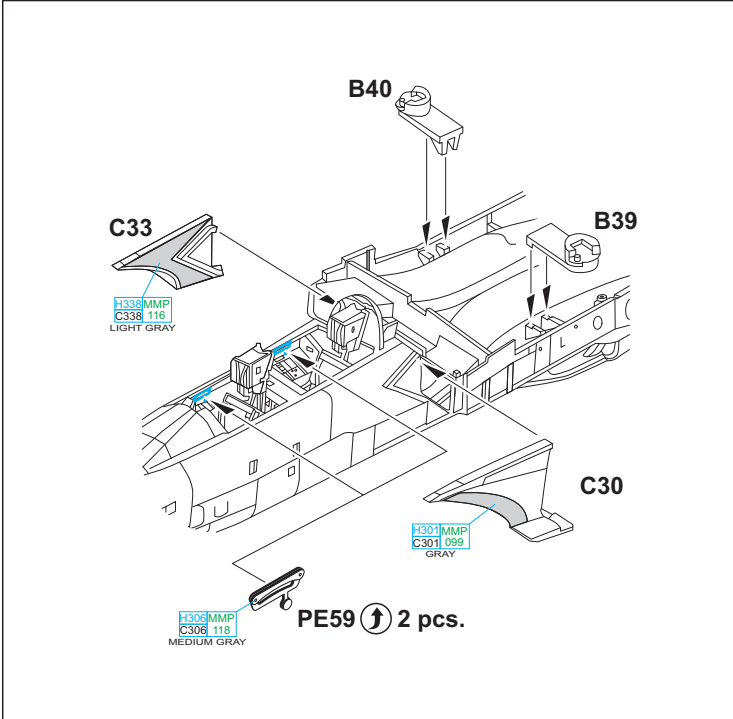

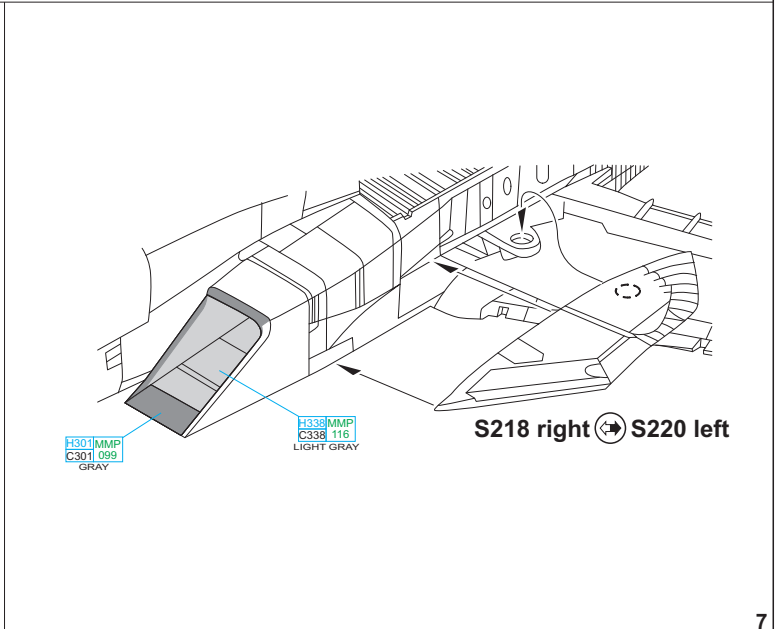
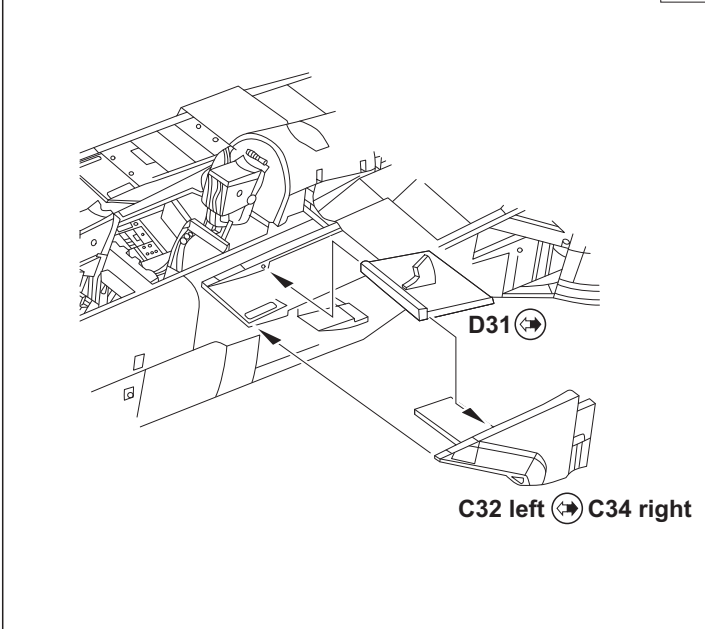
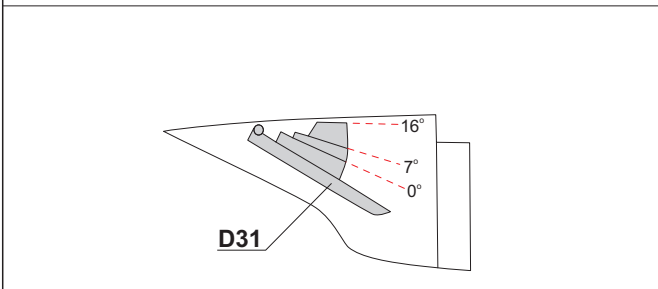
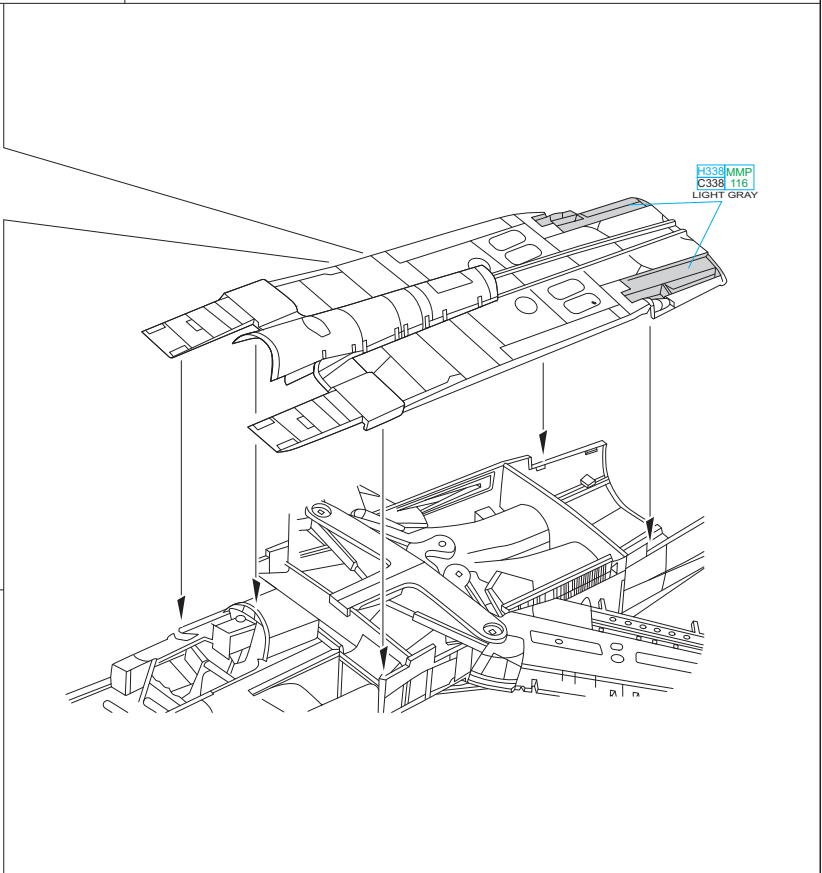
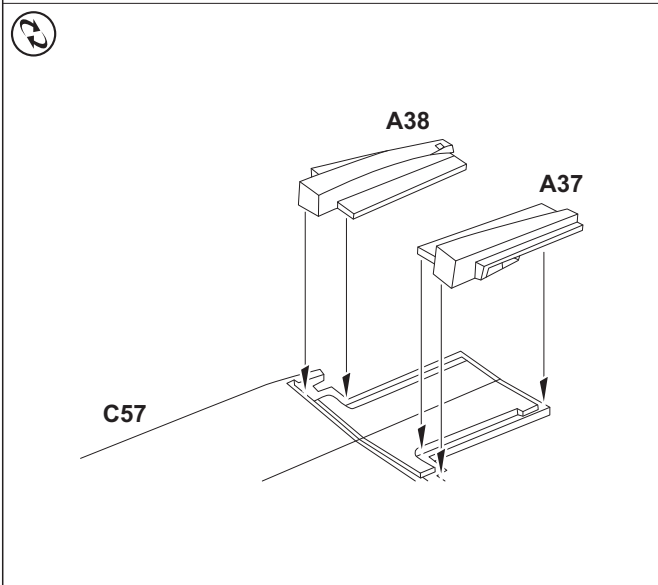
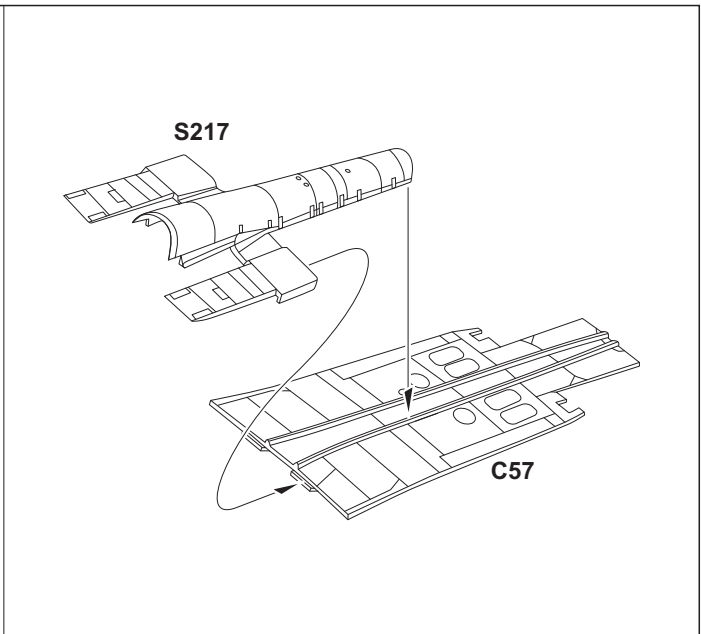
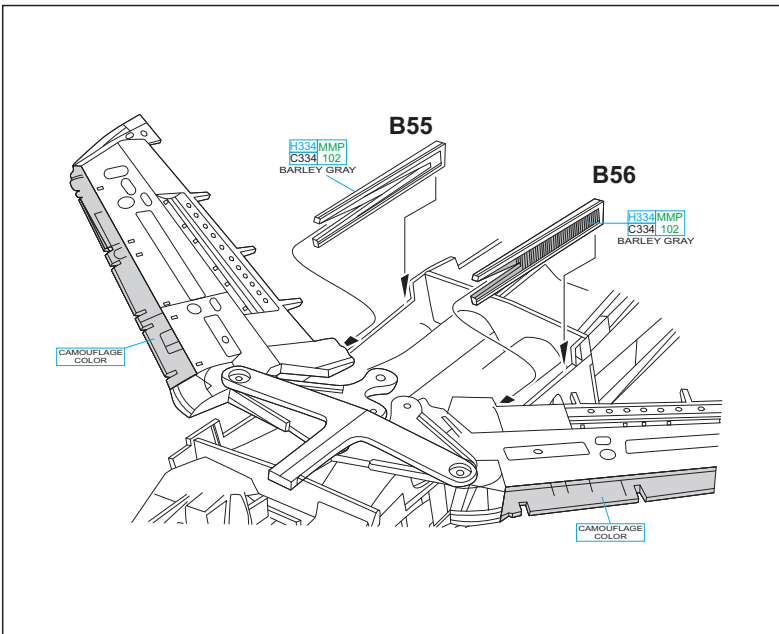

S221 left ↔ S219 right

DO NOT
GLUE!

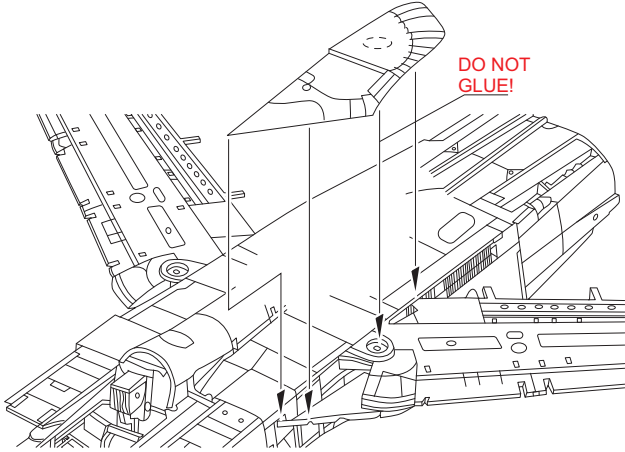

R223

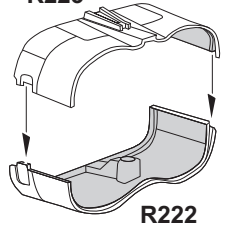

R222

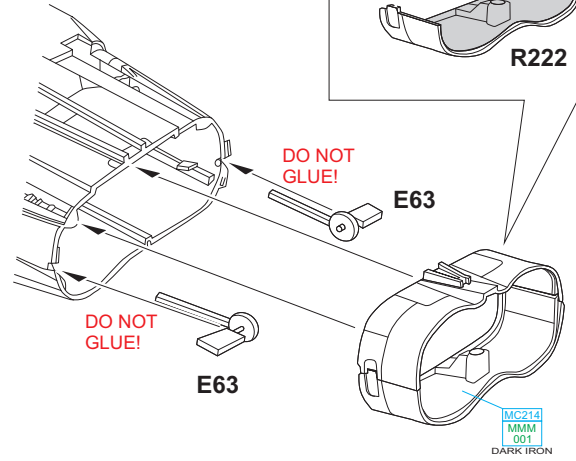

DO NOT
GLUE!

E63

MC214
MMM
001
DARK IRON

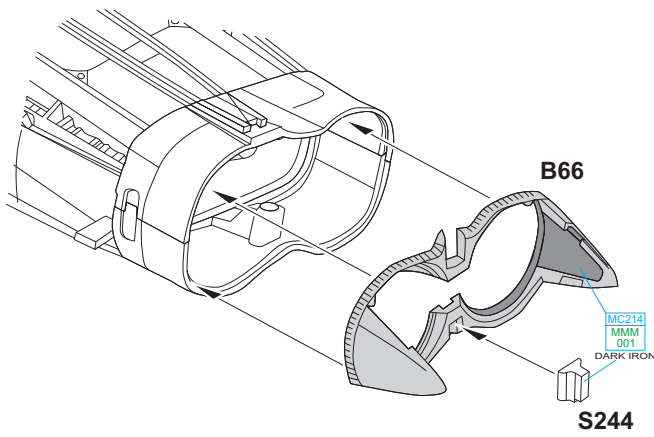

B66

S244

MC214
MMM
001
DARK IRON

S224

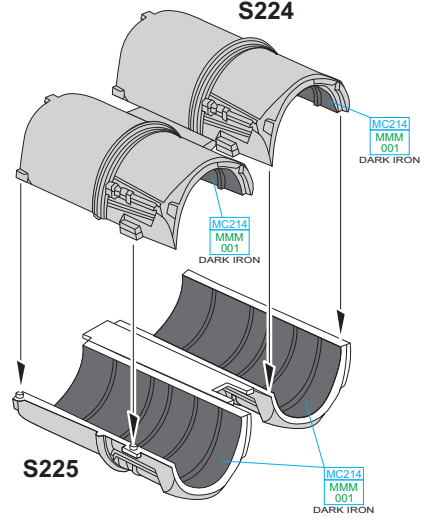

MC214
MMM
001
DARK IRON

MC214
MMM
001
DARK IRON

MC214
MMM
001
DARK IRON

S225

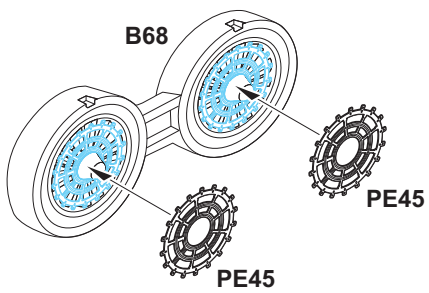

B68

PE45

PE45

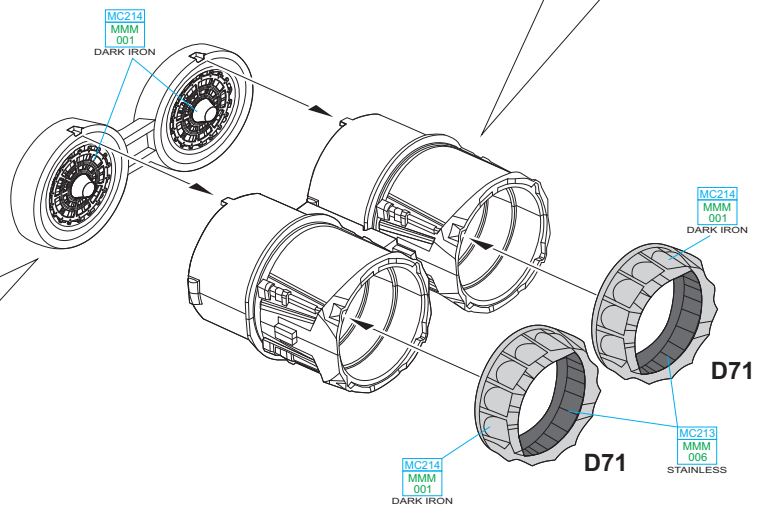

MC214
MMM
001
DARK IRON

MC214
MMM
001
DARK IRON

D71

MC213
MMM
005
STAINLESS

MC214
MMM
001
DARK IRON

D71

E

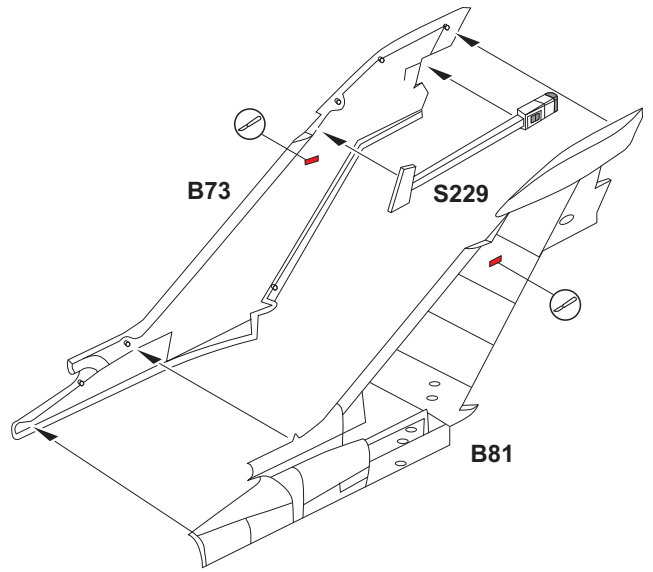
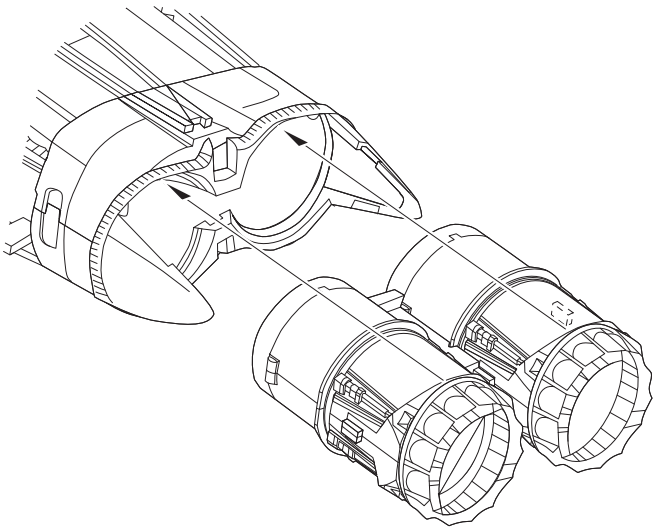

B73

S229

B81

F

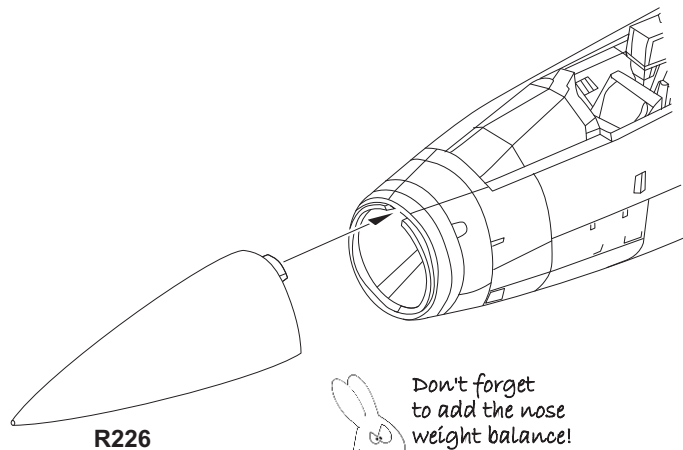

R226



Don't forget to add the nose weight balance!

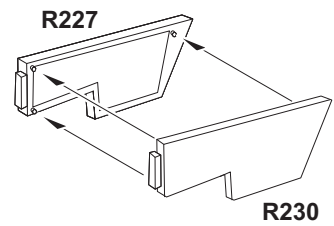

R227

R230

G

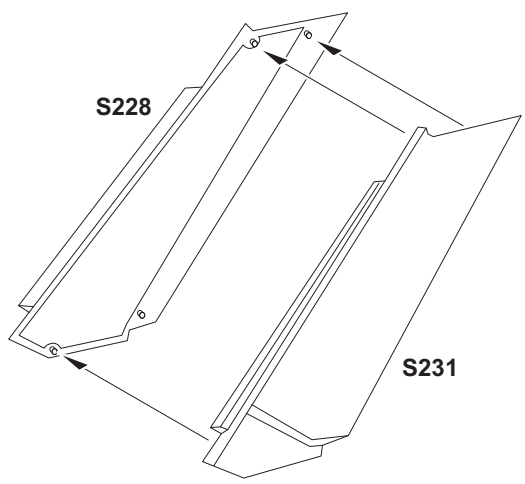

S228

S231

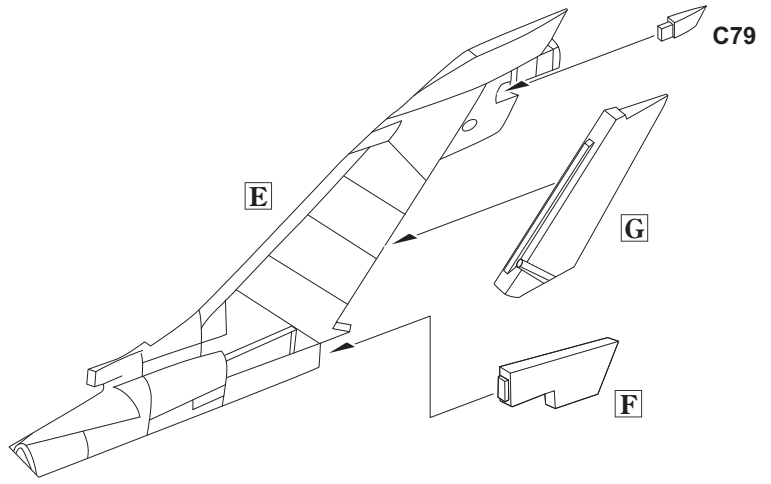

E

G

F

C79

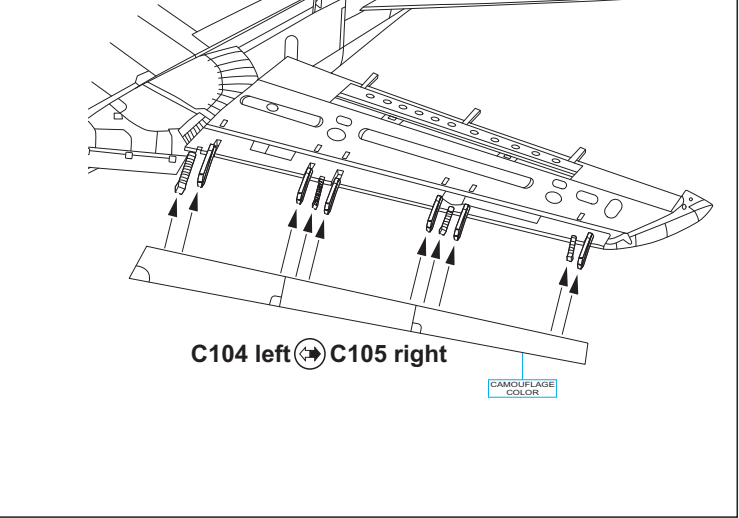
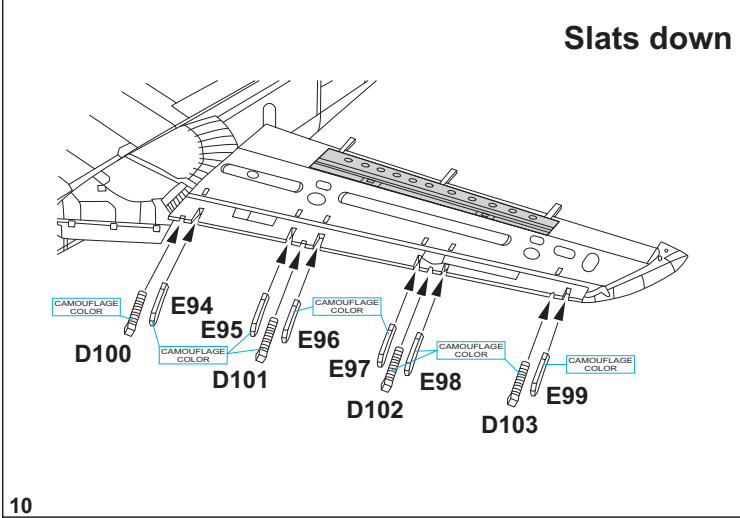
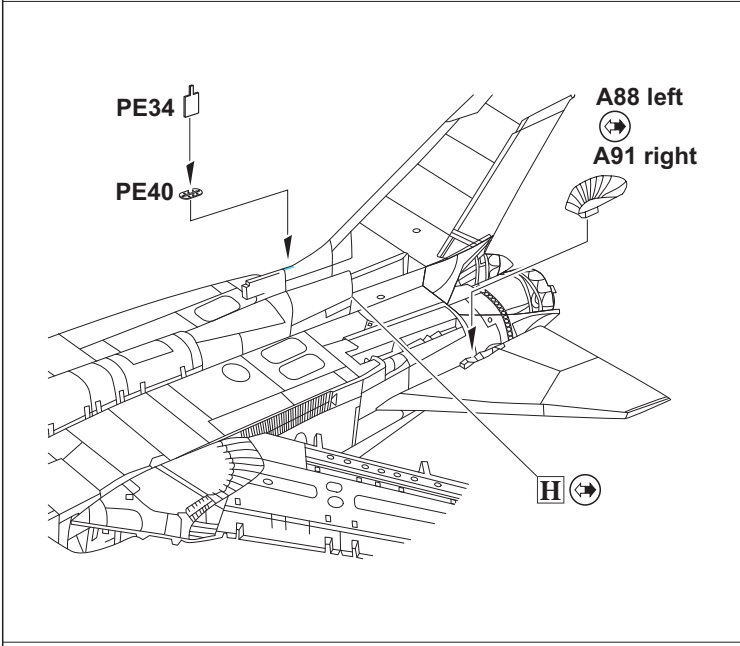
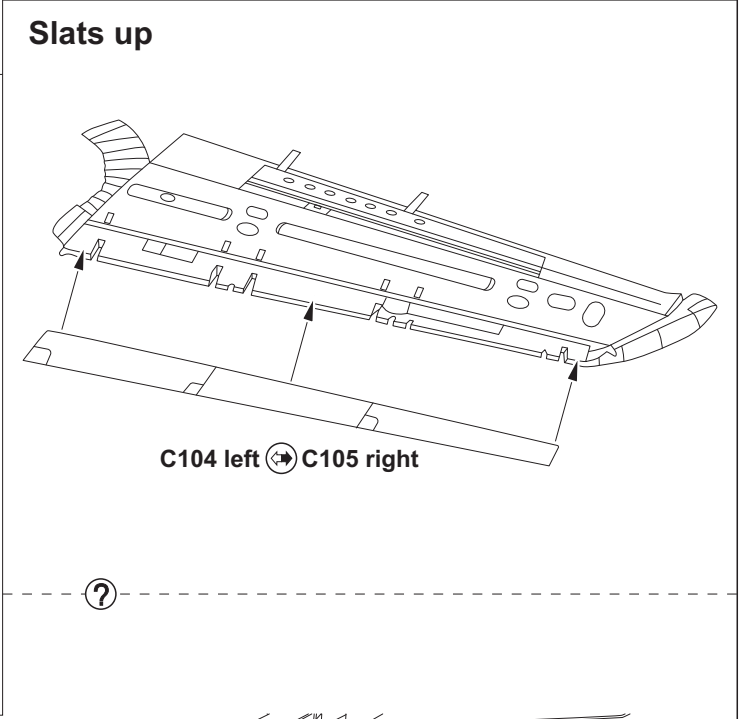
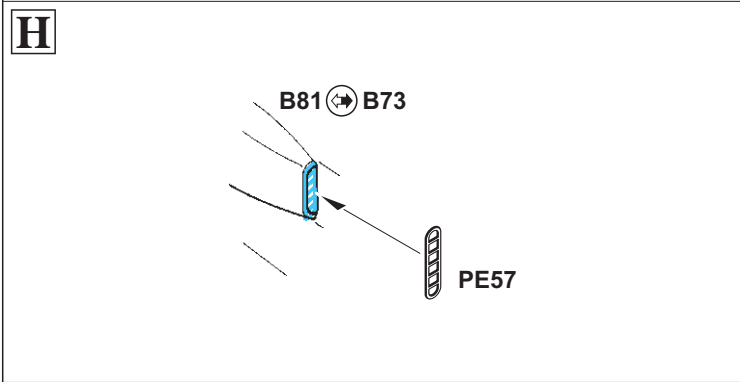
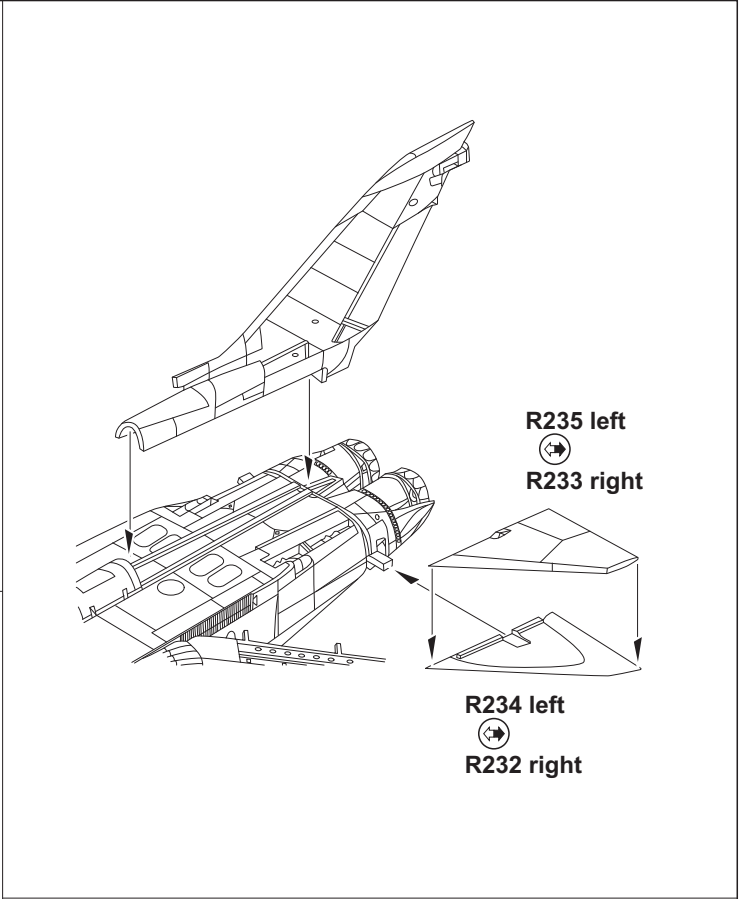
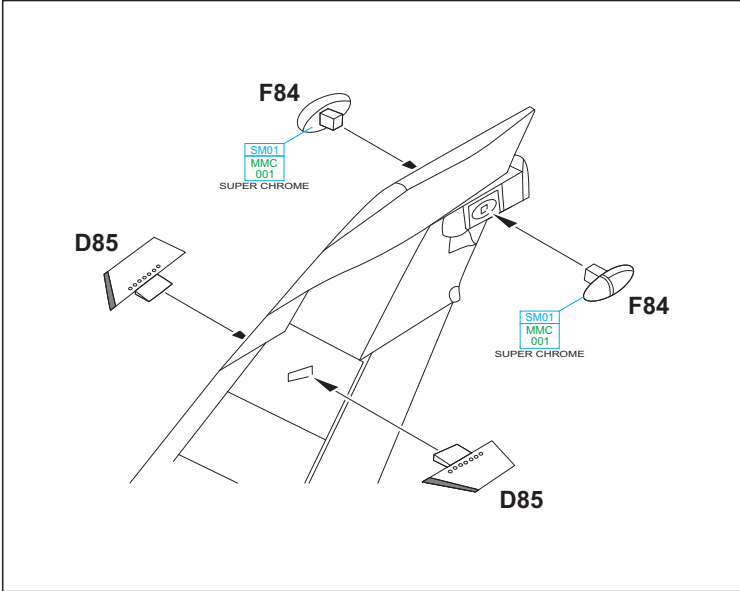

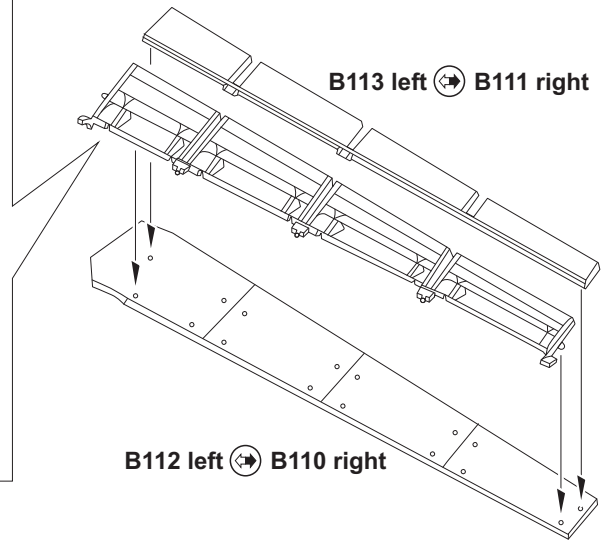
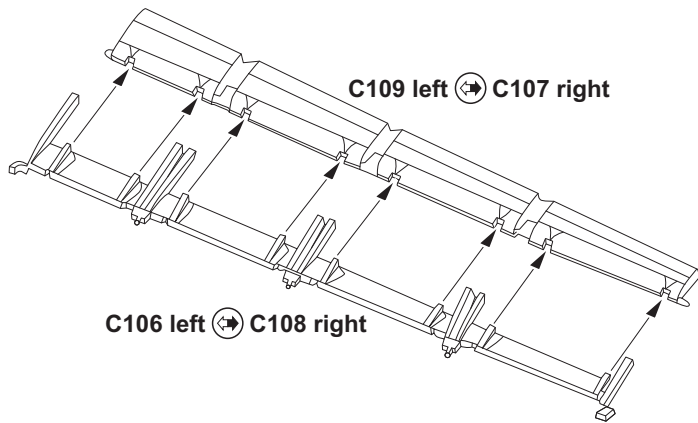

Flaps down

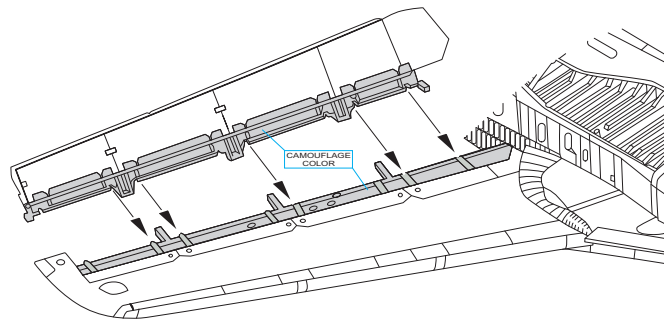

?

Flaps up

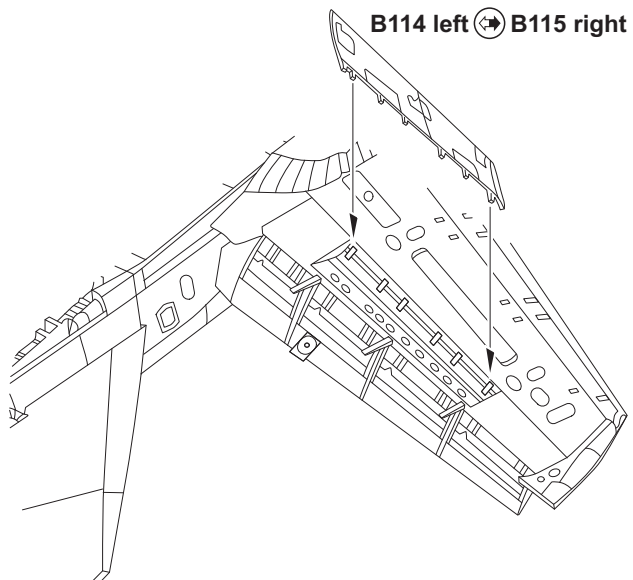
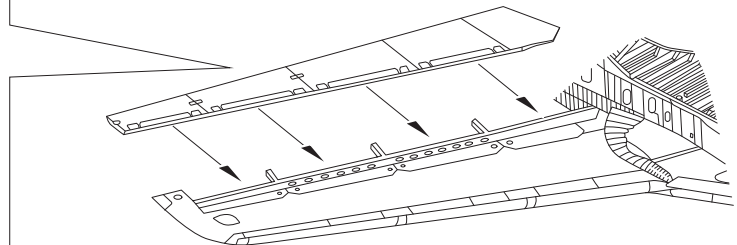
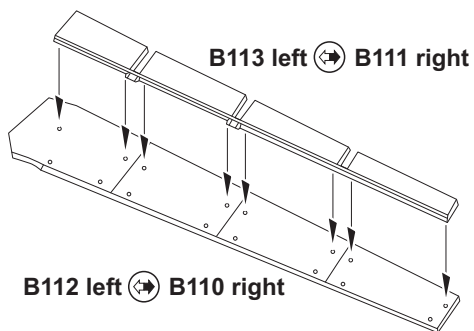

?

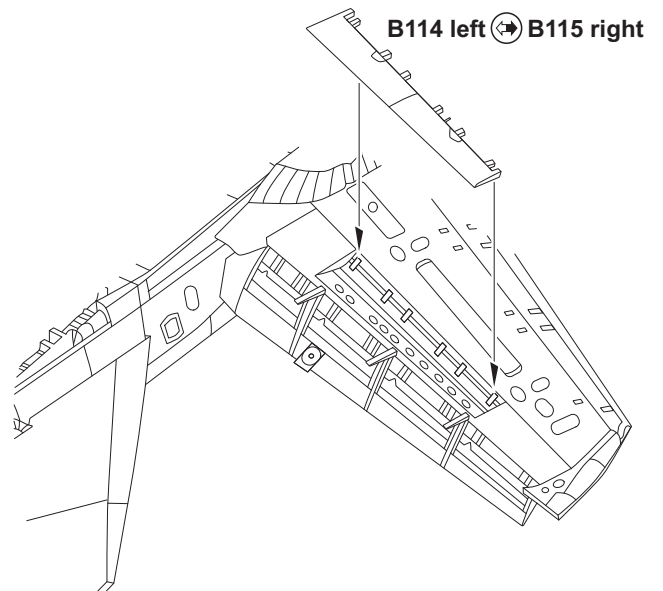

J

B119 right



B116 left

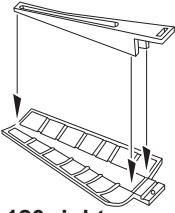

A120 right



A118 left

D117

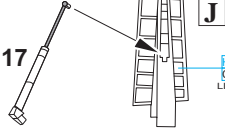

J

F338MMP
C338 116
LIGHT GRAY

SM01
MMC
001
SUPER CHROME

D117

F338MMP
C338 116
LIGHT GRAY

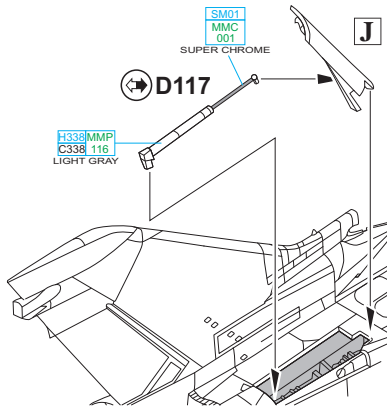

?

A120 right ↔ **A118 left**

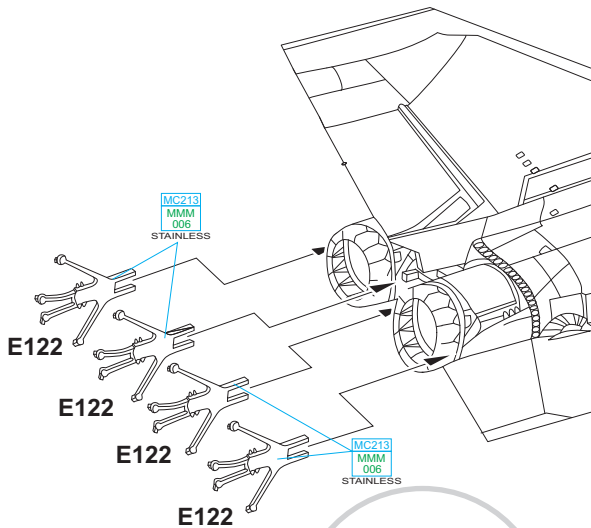
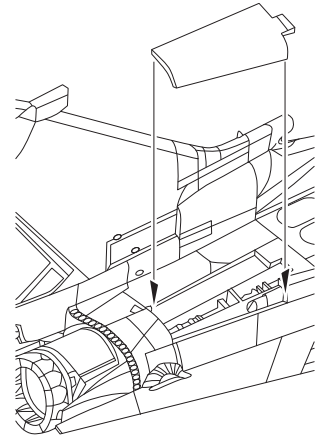

MC213
MMM
006
STAINLESS

E122

E122

E122

E122

MC213
MMM
006
STAINLESS

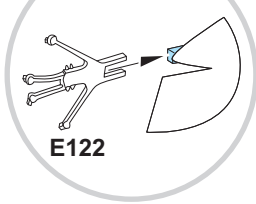

E122

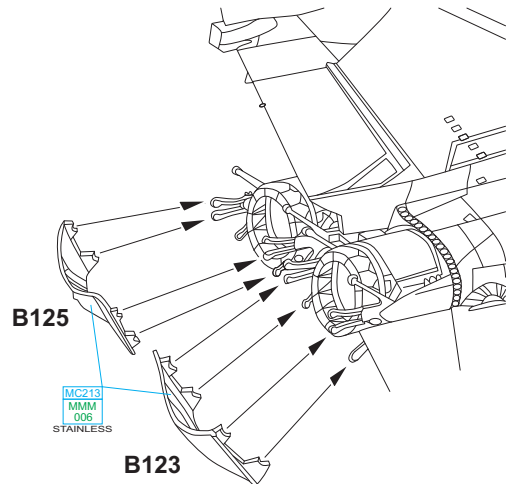

B125

MC213
MMM
006
STAINLESS

B123

?

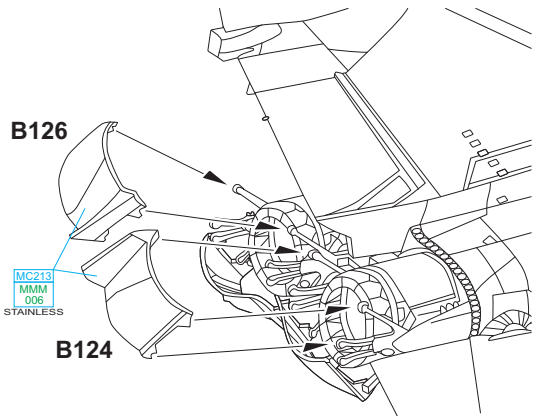

B126

MC213
MMM
006
STAINLESS

B124

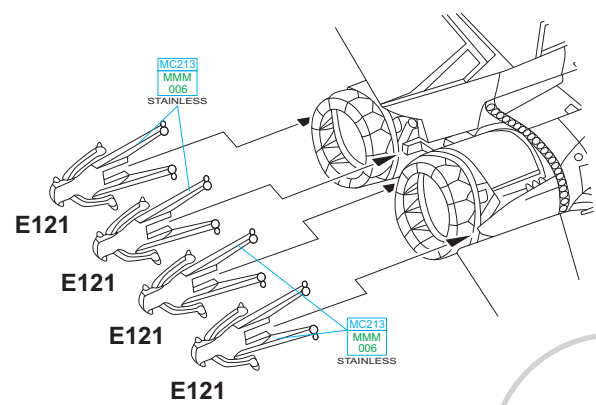

MC213
MMM
006
STAINLESS

E121

E121

E121

E121

MC213
MMM
006
STAINLESS

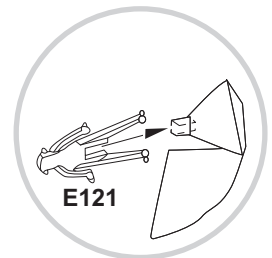

E121

K

B124 right → B126 left

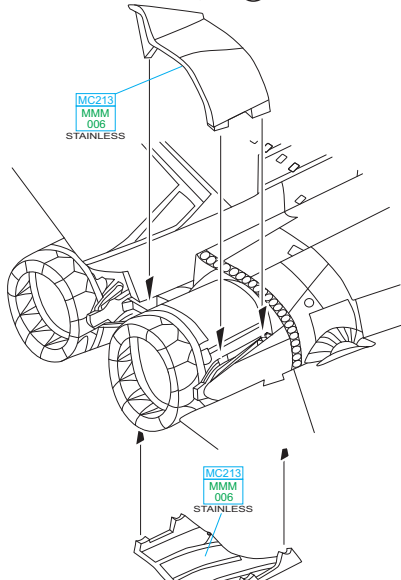

B123 right → B125 left

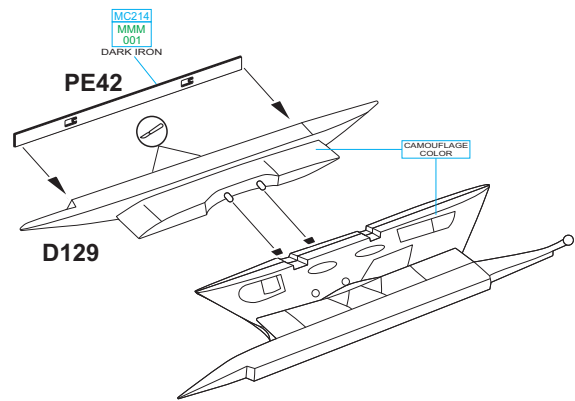
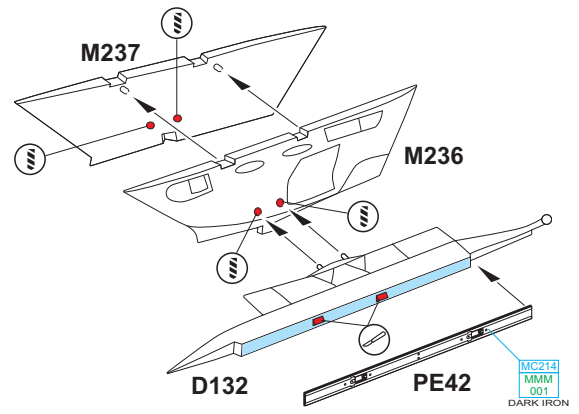
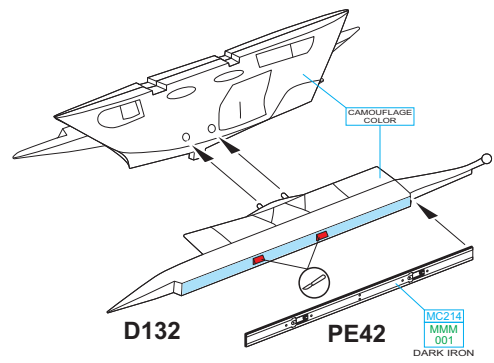
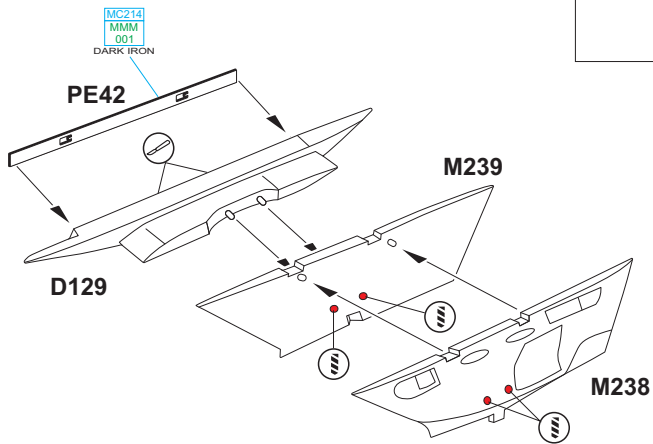
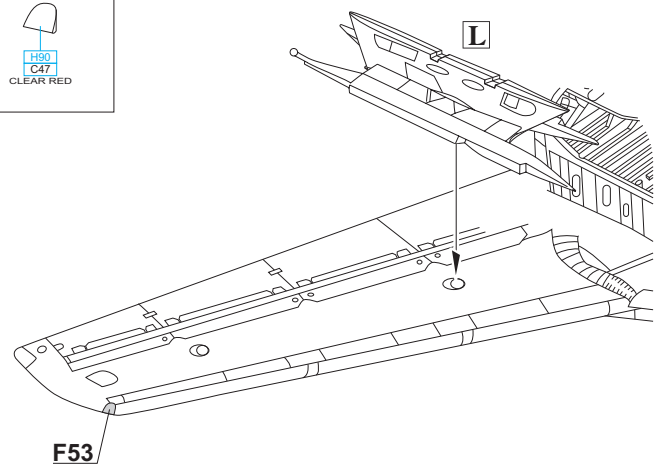
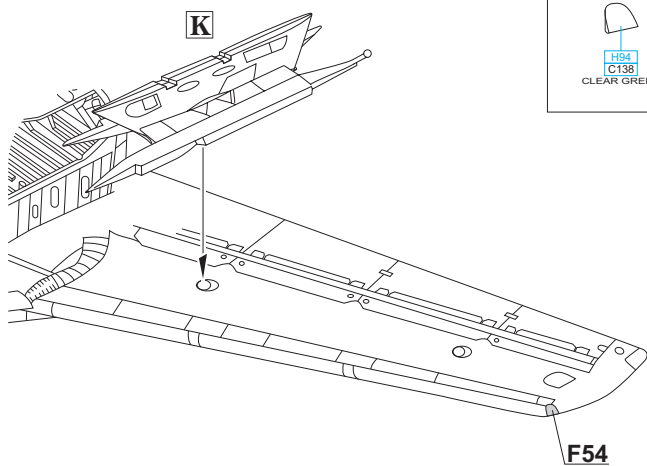
**L****F54**F54
C138
CLEAR GREEN**F53**F53
C47
CLEAR RED

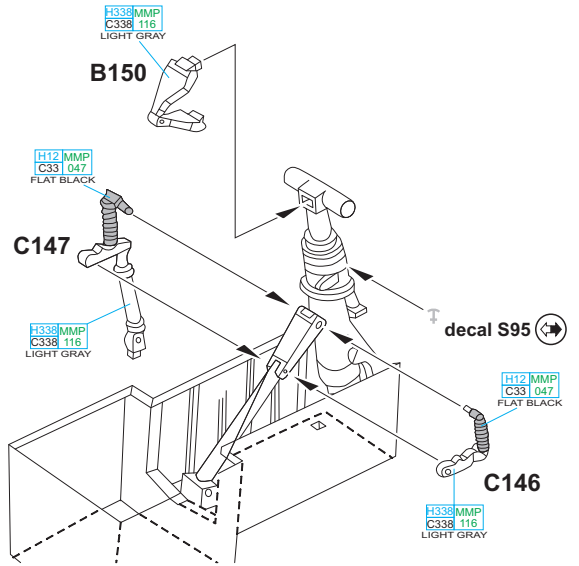
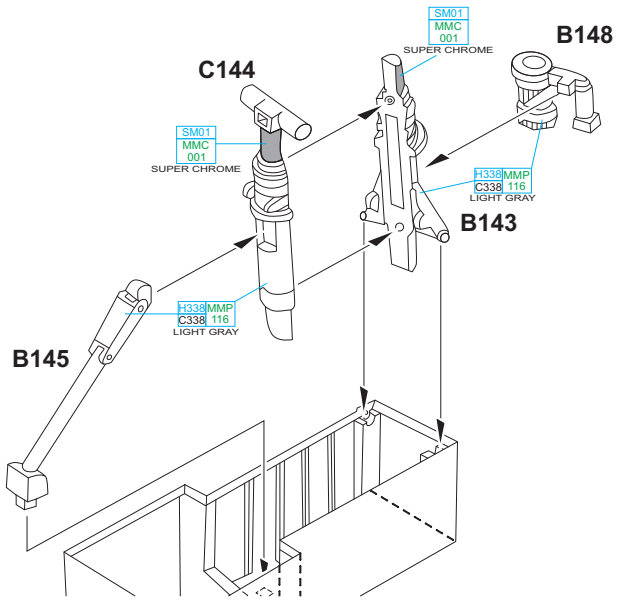

eduard
BRASSIN

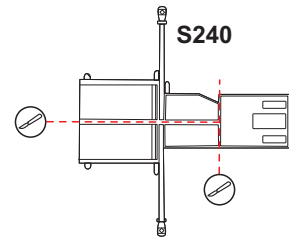
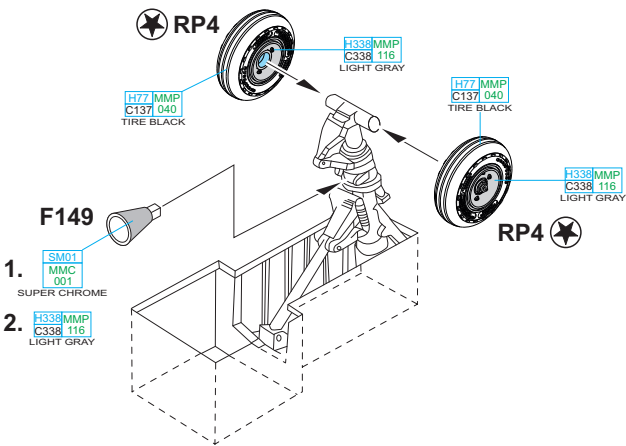

M **N**

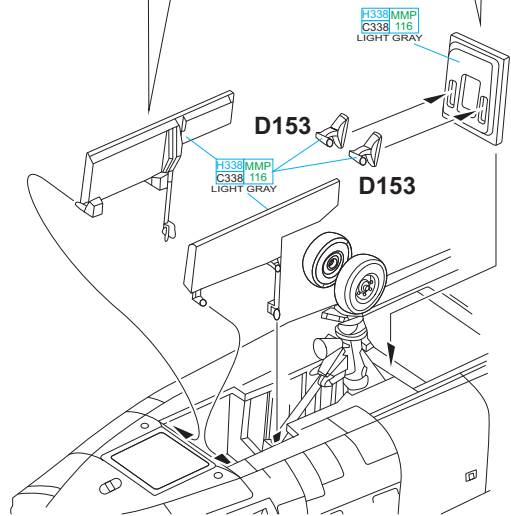
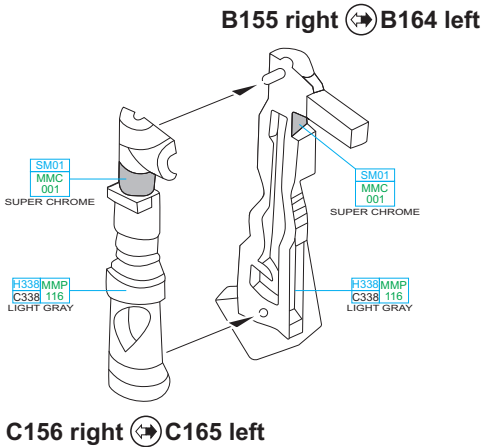

M N

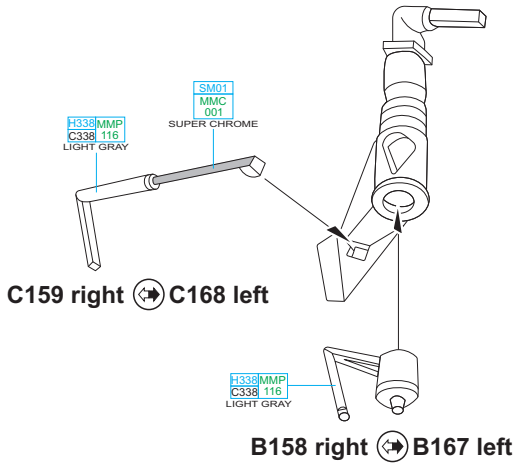

M N

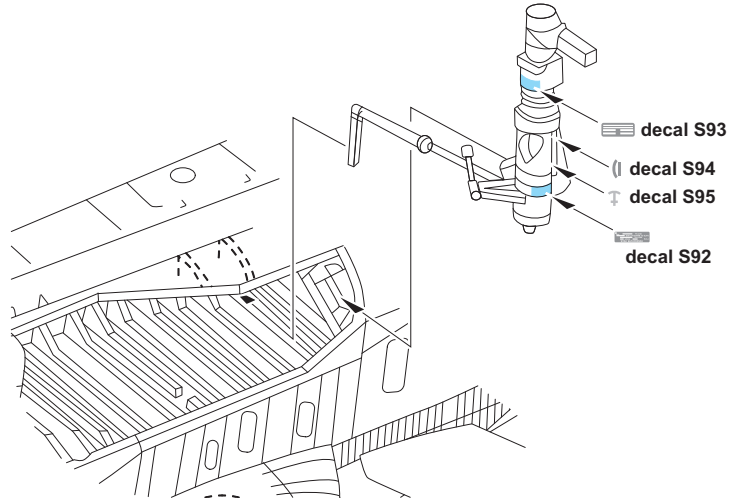

M N

B157 right ↔ B166 left

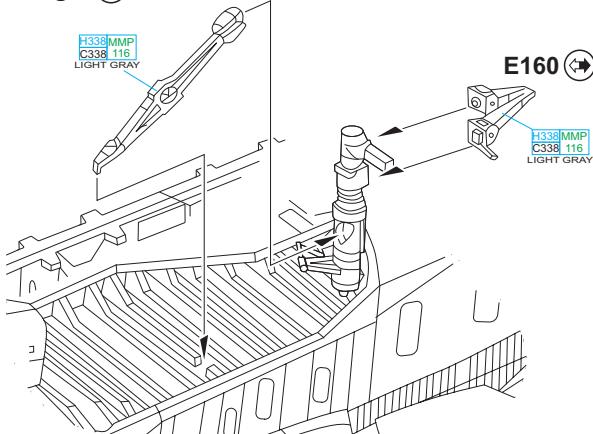

M N

eduard BRASSIN

RP1 ↔

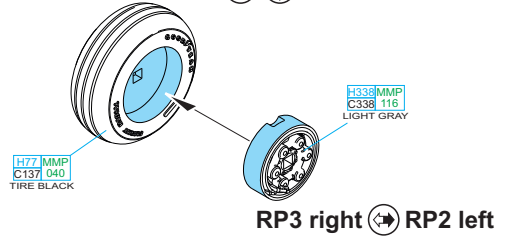

M N

M N

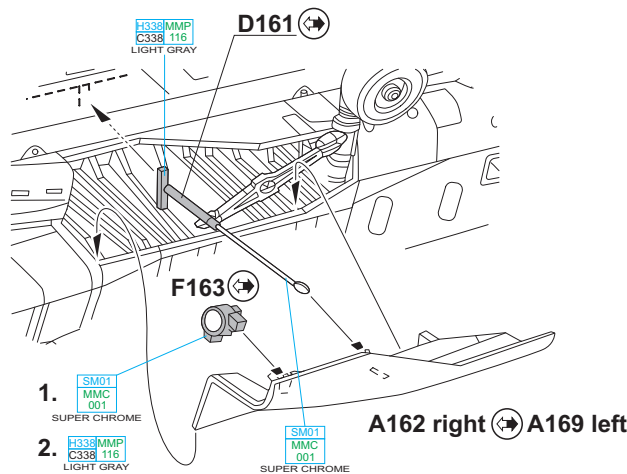

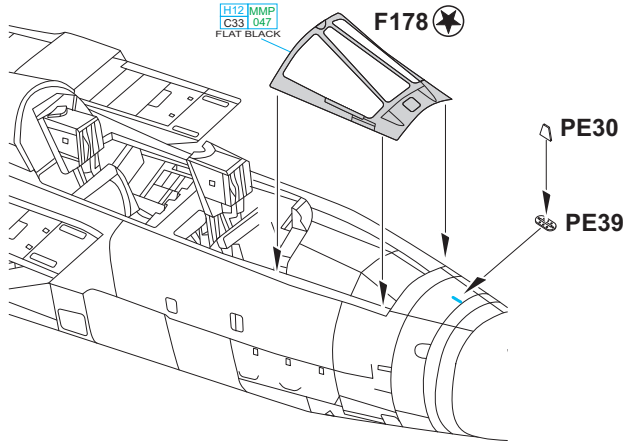

PE16 - MARKING B ONLY

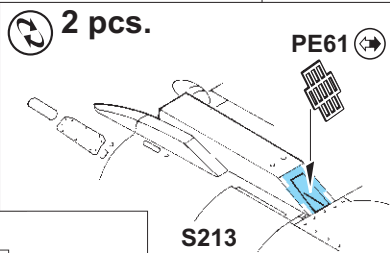
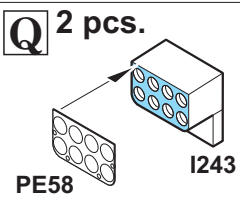
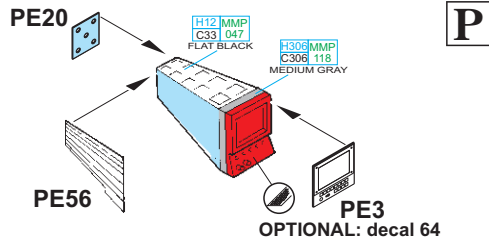
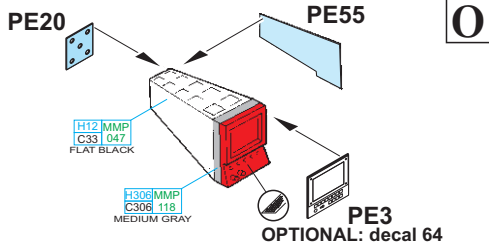
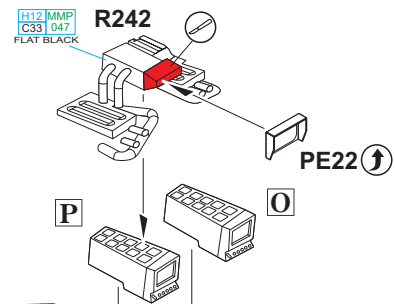
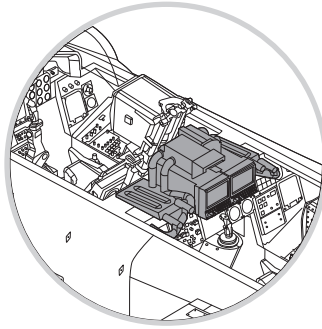
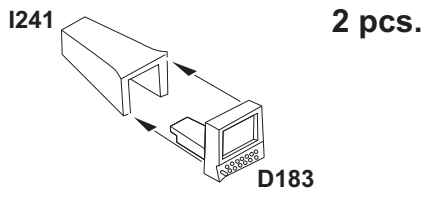
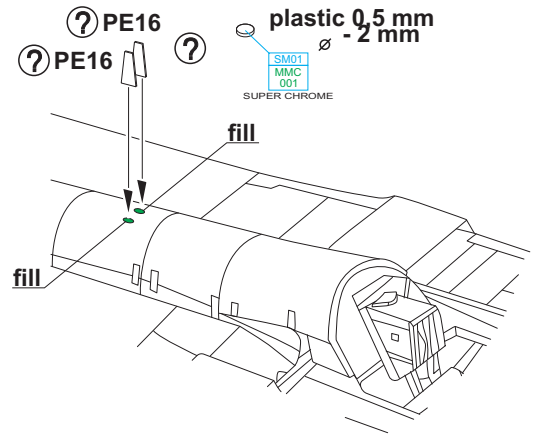

OPEN CANOPY

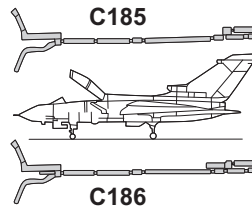

CLOSED CANOPY

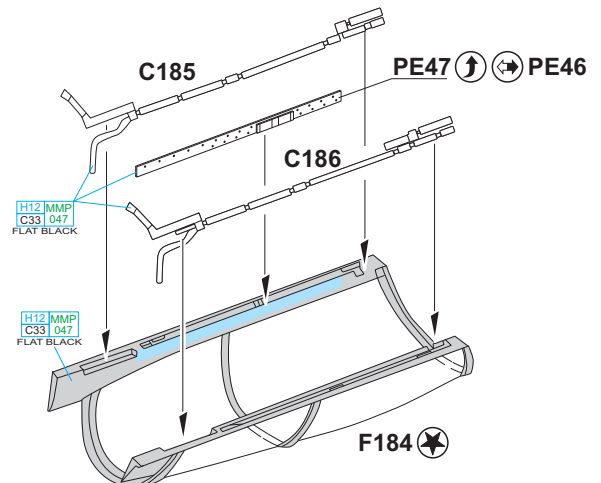
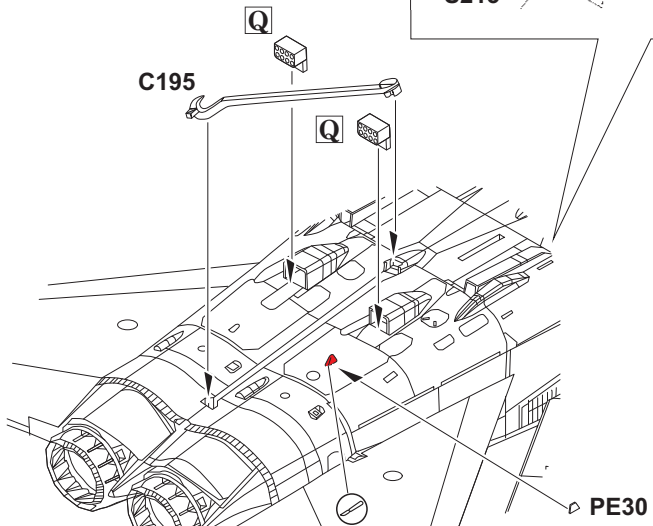
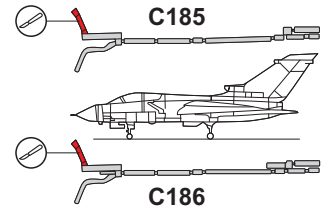

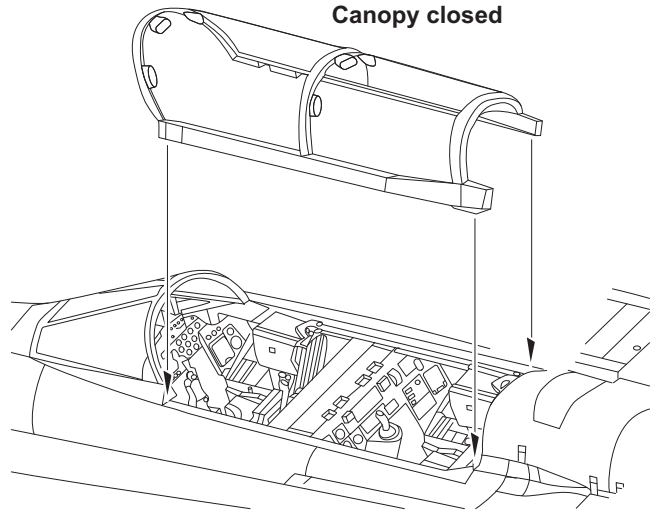
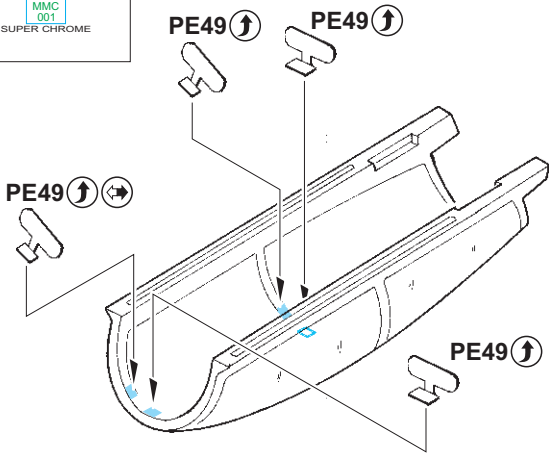
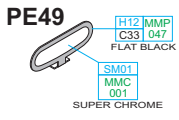

?

Canopy open

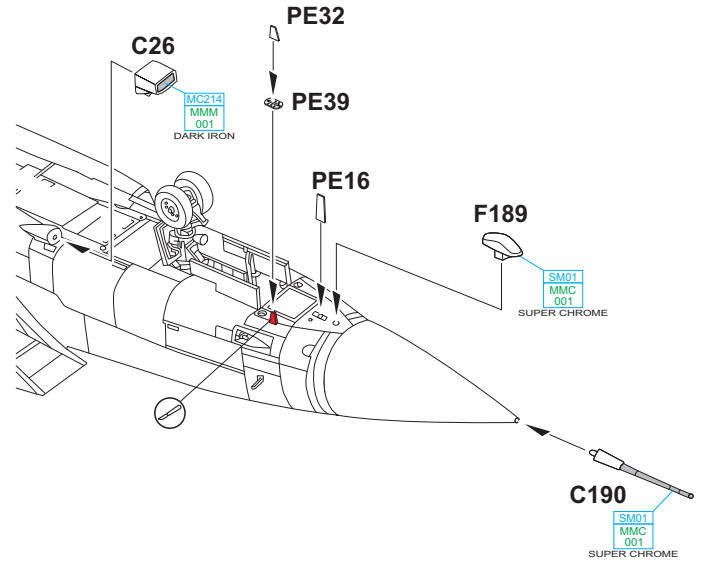
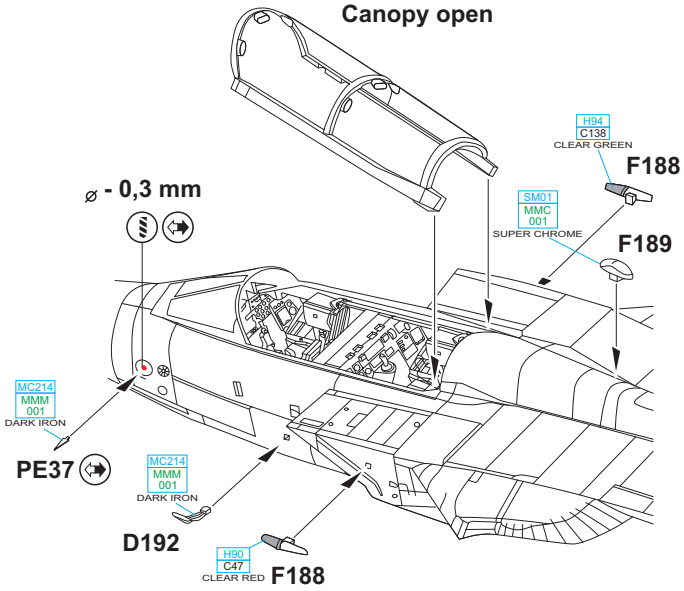

R 4 pcs.

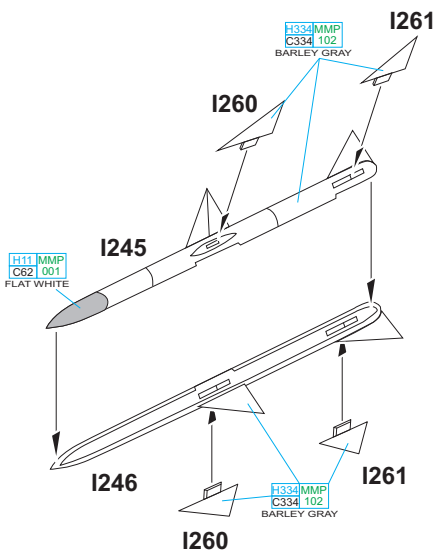

S 2 pcs.

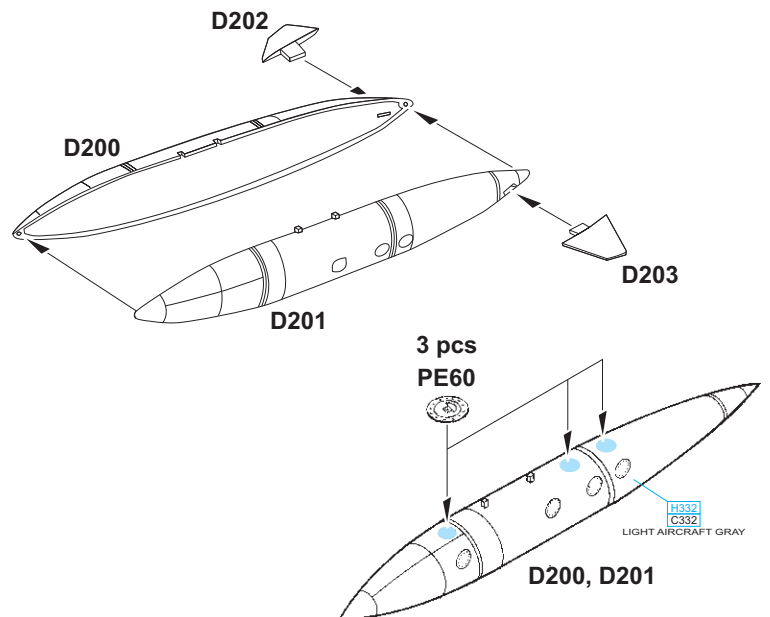

T 2 pcs.

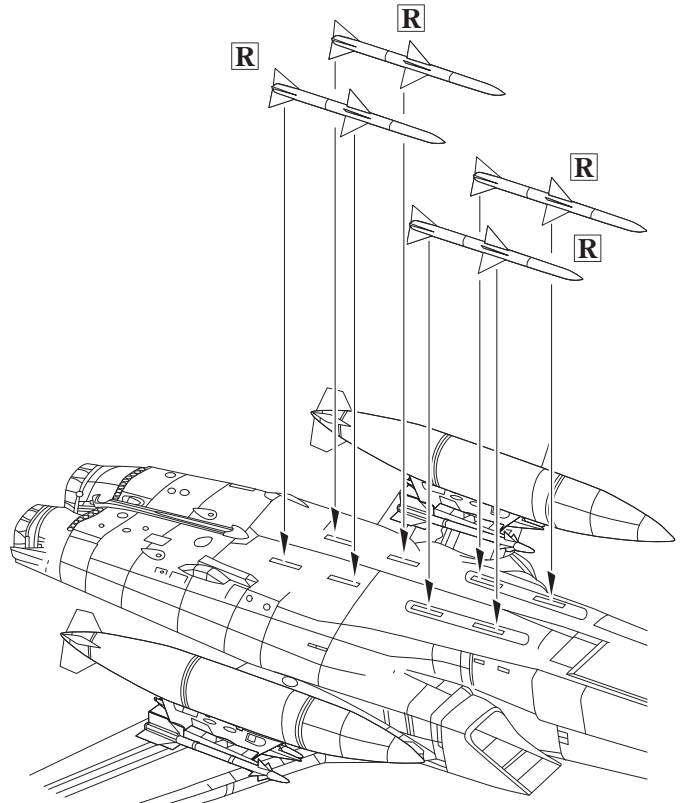
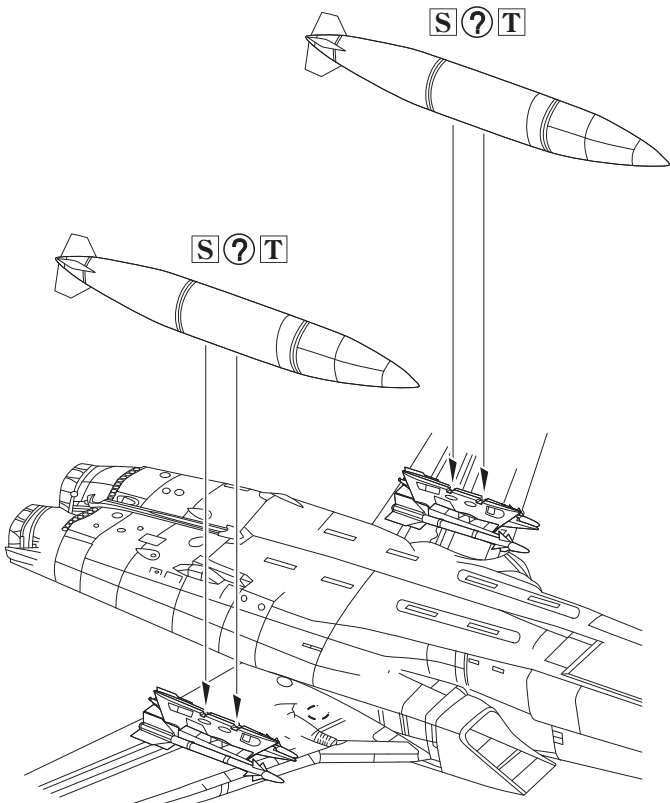
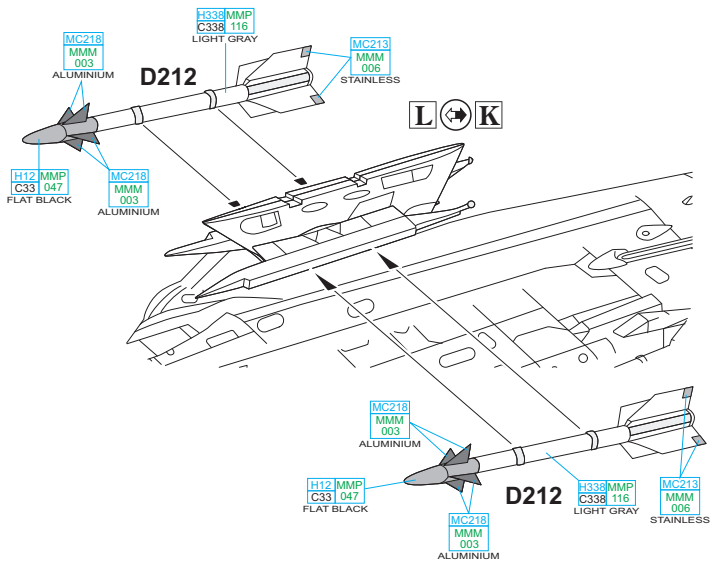
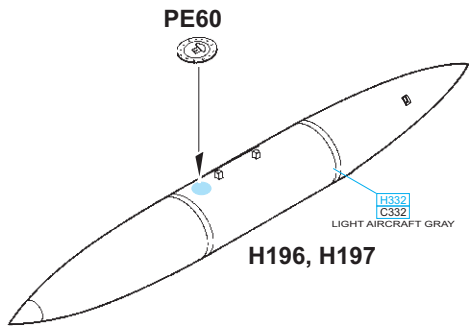
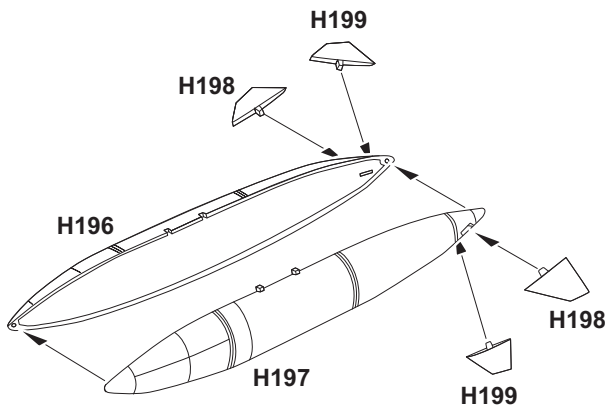

11126

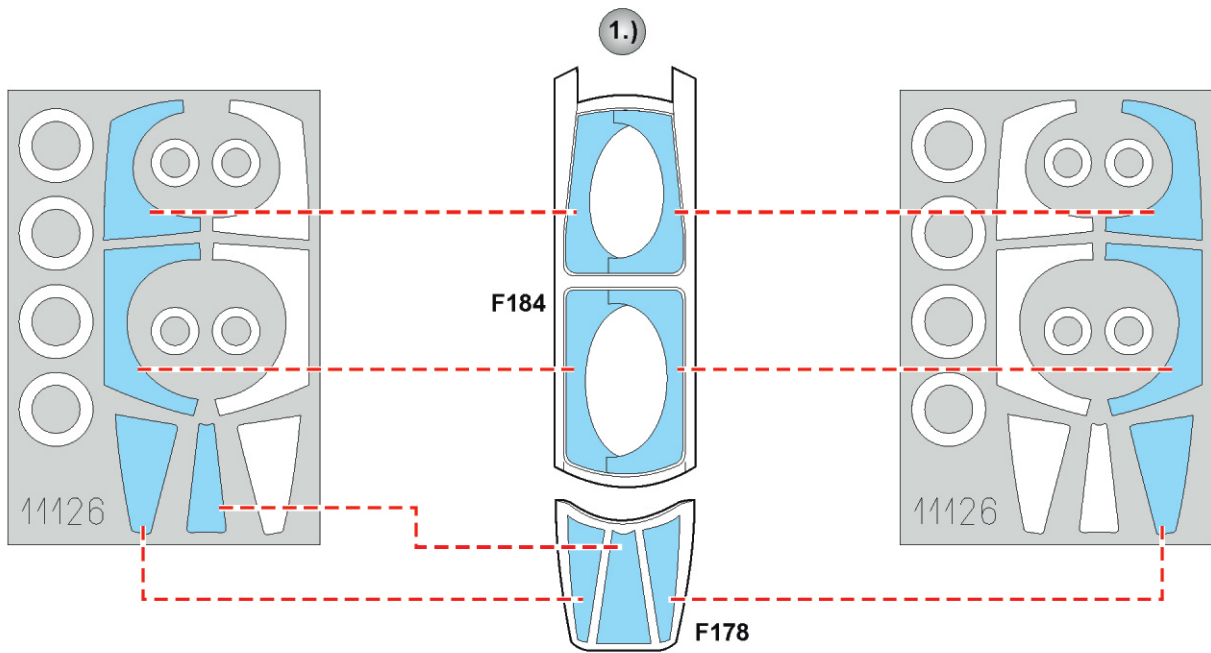
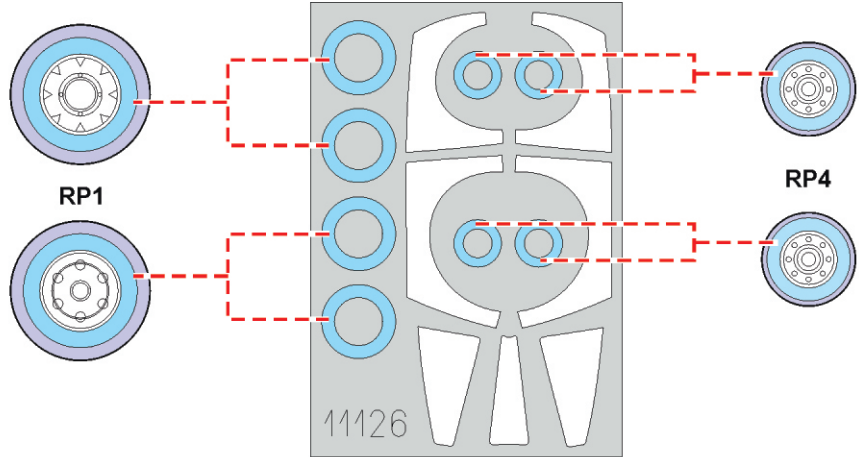
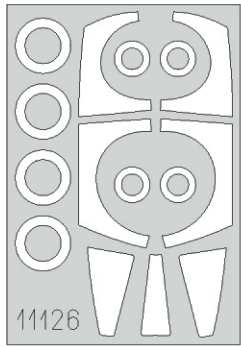

2.) LIQUID MASK

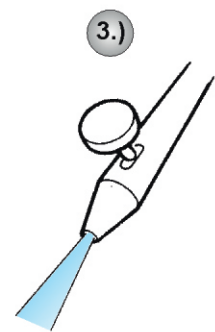
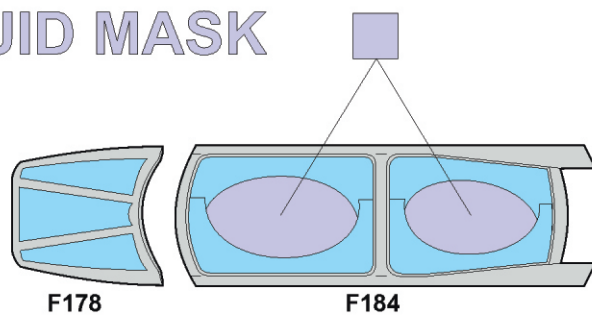

A ZG757, No. 43 Squadron, RAF Station Leuchars, Great Britain, 2006

The No. 43 Squadron aircraft proudly showed the overall glossy black finish, one of the special markings pointing towards the unit's tradition dating back to the WWI, complimented by the unit marking commemorating the unit's 90th anniversary, carried on the vertical tail surface. Later the black paint was removed from the nose and the following year only the fuselage spine and vertical tail surface remained painted black.

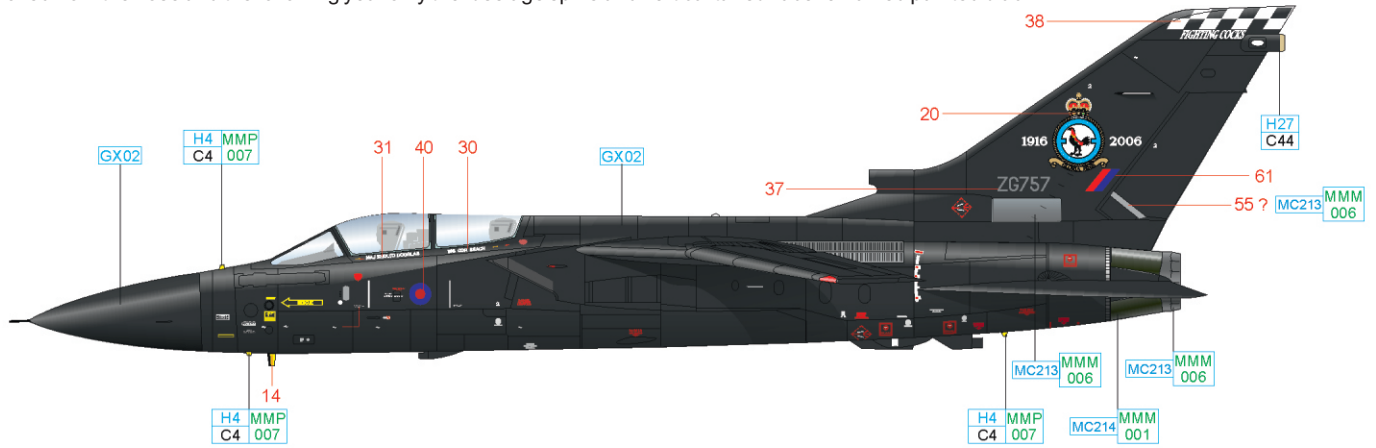

ČESKOU VERZI TEXTU NALEZNETE NA www.eduard.cz POD KATALOGOVÝM ČÍSLEM 11126

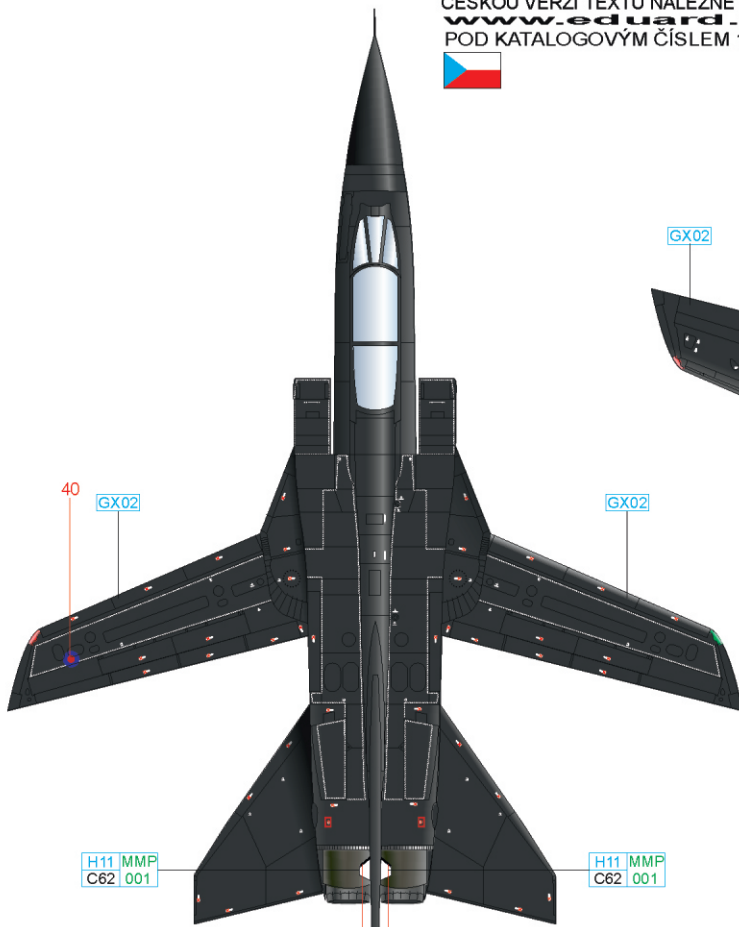

Special thanks to Andy Robinson and Squadron prints to cooperation on this project

Squadron Prints
www.squadronprints.com

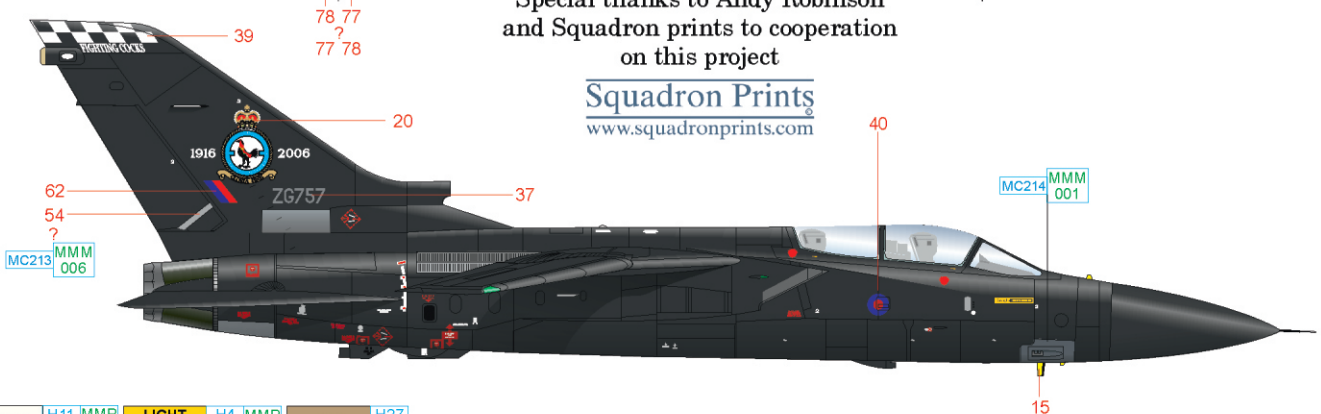

WHITE	H11 MMP C62 001	LIGHT YELLOW	H4 MMP C4 007	TAN	H27 C44
STEEL	MC213 MMM 006	DARK IRON	MC214 MMM 001	BLACK	GX02

B ZE339, No. 56 Squadron, RAF Station Coningsby, Great Britain, 2000

No. 56 Squadron, the unit with the rich history dating back to 1916, which equipment since 1976 was in the form of the Phantoms FGR Mk.2, was disbanded on July 1st, 1992. The name and tradition were adopted by No. 229 OCU, the unit tasked with the Tornados F.3 crews' transition training. In 2000, the aircraft ZE339 camouflage was complimented by the attractive elements related to the unit's name (Firebirds). In 2008, No. 56 Squadron was disbanded, and its name and tradition were adopted by the AIR C2ISR OEU unit located at Waddington airbase performing the operational tests of the Sentry AEW Mk.1, Sentinel R Mk.1 aircraft and all Nimrod operational versions.

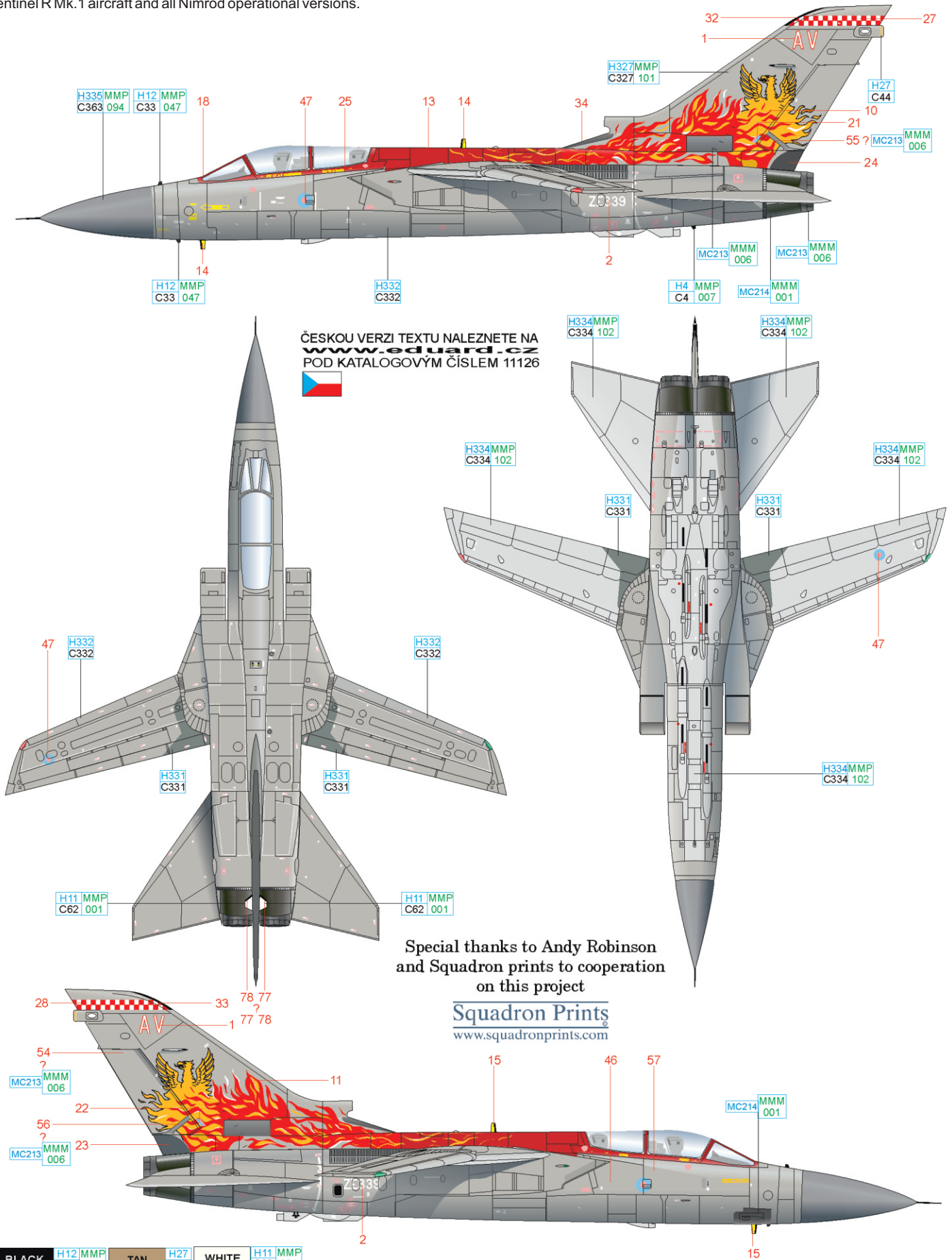

ČESKOU VERZI TEXTU NALEZNETE NA www.eduard.cz POD KATALOGOVÝM ČÍSLEM 11126



Special thanks to Andy Robinson and Squadron prints to cooperation on this project

Squadron Prints
www.squadronprints.com

BLACK	H12 MMP C33 047	TAN	H27 C44	WHITE	H11 MMP C62 001
BARLEY GRAY	H334 MMP C334 102	LIGHT AIR. GRAY	H332 C332	MEDIUM SEA GRAY	H335 MMP C363 094
				DARK SEA GRAY	H331 C331
				STEEL	MC213 MMM 006
					DARK IRON MC214 MMM 001

In the spring of 2003, the invasion of Iraq was launched under the codename Enduring Freedom. It was called Telic by the British ally. The British air power, supporting the allied troops from the Saudi Arabian bases, deployed besides Tornados GR.4 and Harriers GR.7 also Tornados F.3 from No. 25, 43 and 111 Squadron RAF. Tornados carried the camouflage in the Camouflage Grey on the upper surfaces and the Light Aircraft Grey on the lower surfaces. The ground personnel applied variety of the art on the aircraft noses. ZE758 for example featured a shark with an inscription Tremble, landing gear cover carried the name of the Australian WWII fighter ace Clive Caldwell.

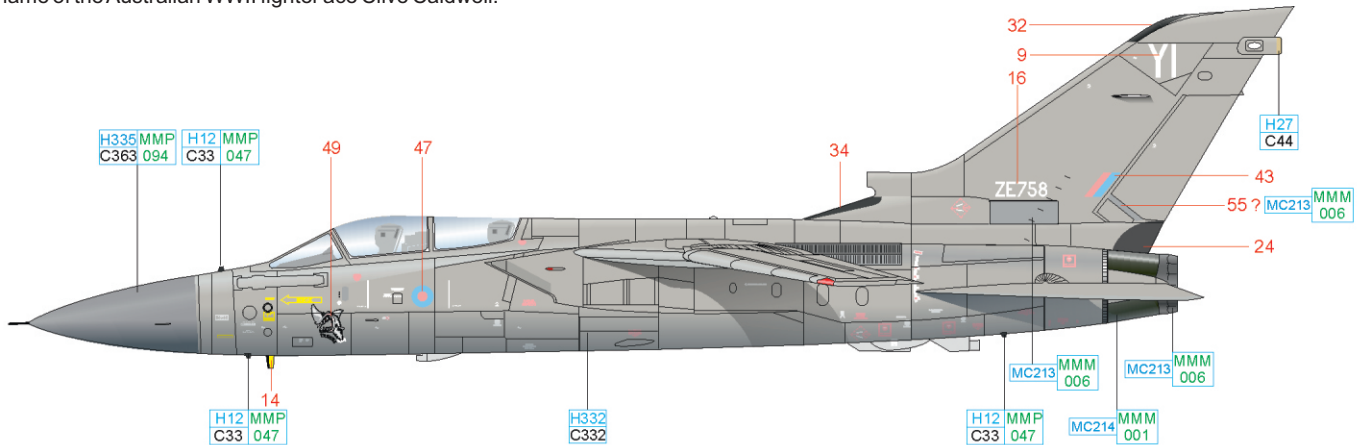

ČESKOU VERZI TEXTU NALEZNETE NA www.eduard.cz POD KATALOGOVÝM ČÍSLEM 11126

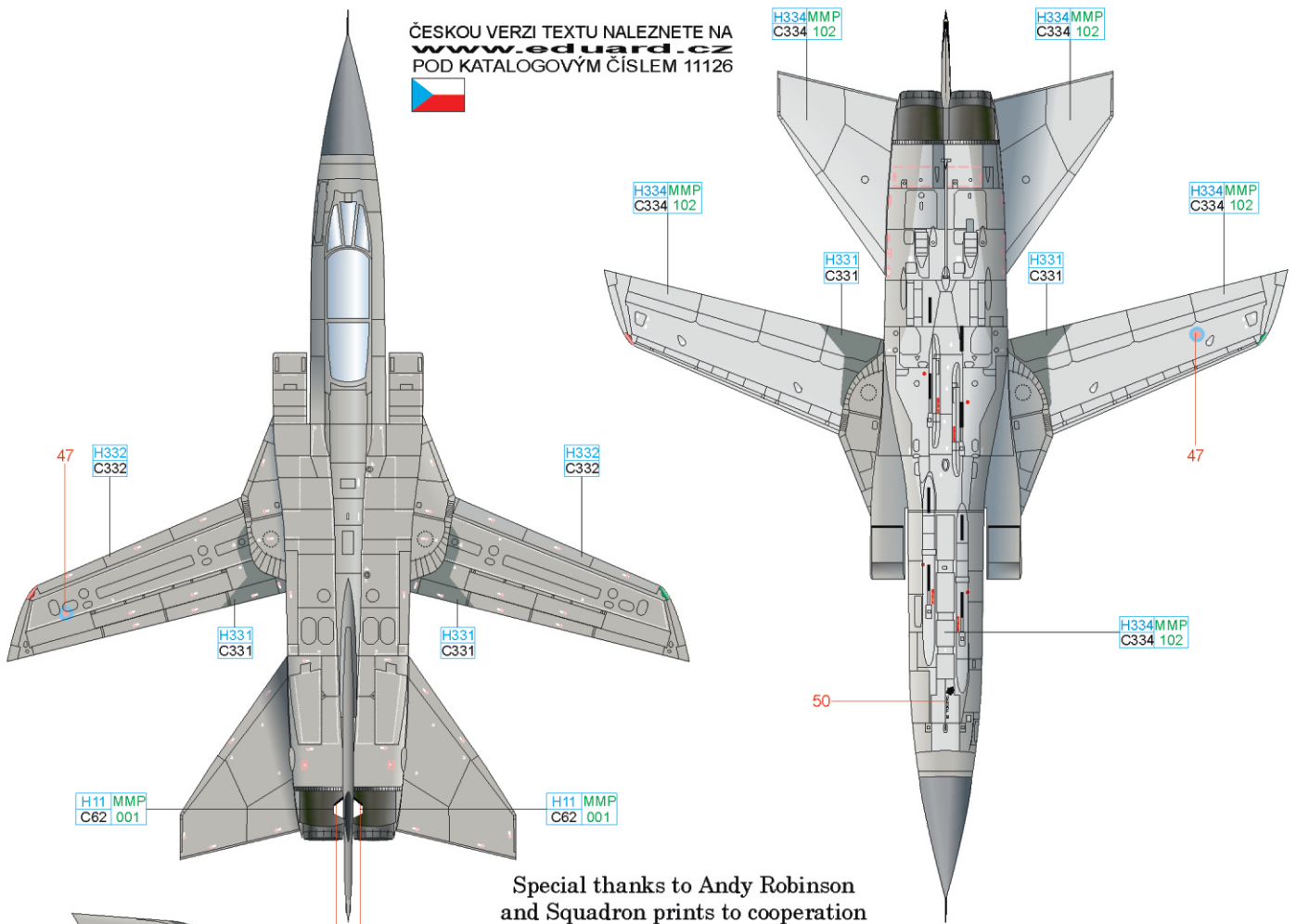

Special thanks to Andy Robinson and Squadron prints to cooperation on this project

Squadron Prints
www.squadronprints.com

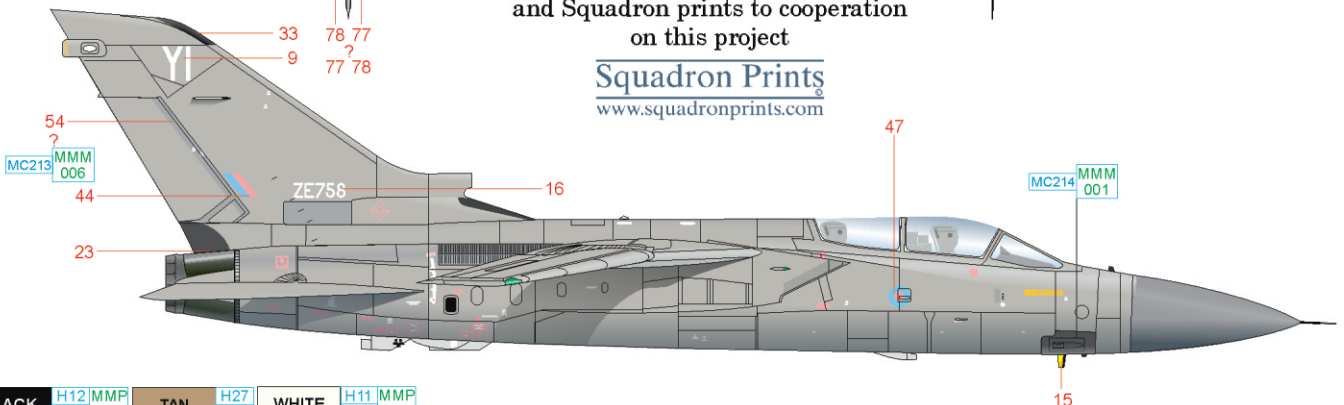

BLACK	H12 MMP C33 047	TAN	H27 C44	WHITE	H11 MMP C62 001
BARLEY GRAY	H334 MMP C334 102	LIGHT AIR. GRAY	H332 C332	MEDIUM SEA GRAY	H335 MMP C363 094
				DARK SEA GRAY	H331 C331
				STEEL	MC213 MMM 006
					DARK IRON MC214 MMM 001

D ZG753, No. 111 Squadron, RAF Station Leuchars, Great Britain, 2007

In 1989, No. 111 Squadron received its first Tornados F.3 as a replacement for the Phantoms FG.1 and operated them until March 22nd, 2011, when the unit was disbanded. Aircraft ZG753, manufactured in 1991, suffered the engine fire during the flight from Falklands Islands to Great Britain, 500 kilometers North of Ascension Island. During the emergency landing on this island the aircraft was damaged, transported back to Great Britain and after the inspection condemned as a source of the spare parts. The name O Bandeirante was used for the first time at Treble One in 1942. It appeared on a Spitfire to pay a homage to Brazilians and British citizens living in Brazil who had donated the funds to purchase Spitfires for the RAF.

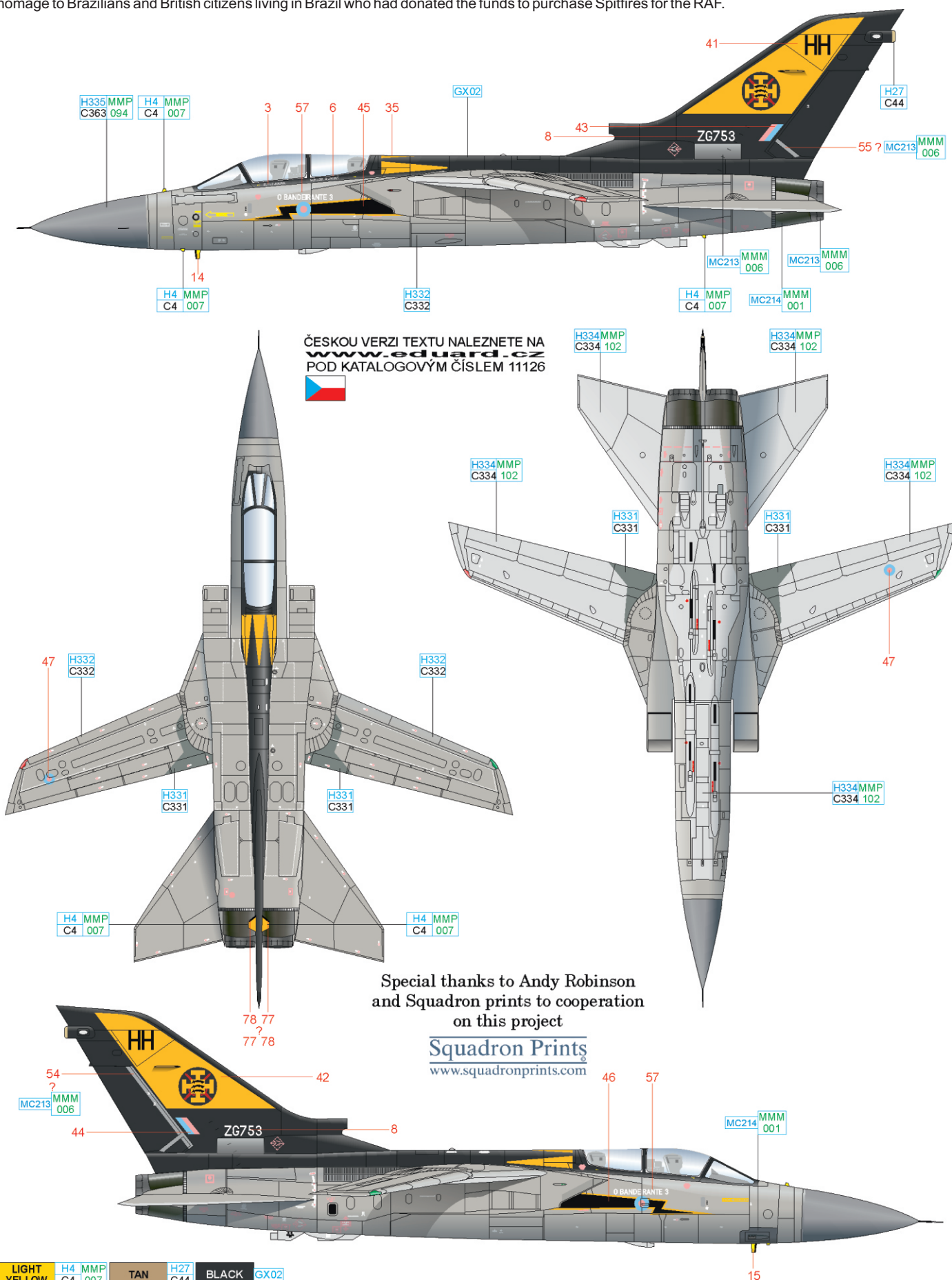

LIGHT YELLOW	H4 MMP C4 007	TAN	H27 C44	BLACK	GX02
BARLEY GRAY	H334MMP C334 102	LIGHT AIR. GRAY	H332 C332	MEDIUM SEA GRAY	H335MMP C363 094
				DARK SEA GRAY	H331 C331
				STEEL	MC213 MMM 006
					DARK IRON MC214 MMM 001

E ZE785, Operational Evaluation Unit, RAF Station Waddington, Great Britain, 2003

Since 1987, the performance evaluation and weapons and systems applications of the Tornado F.3 aircraft were conducted at OEU located at Waddington airbase. Operations of this unit facilitated the incorporation of this aircraft type into the combat units and its performance assessment continued during the routine unit operations with the objective to achieve the maximum utilization of its abilities. In 2003 decision was made to disband OEU and in the following year ZE785 became a "canvas" for the attractive marking created on the occasion of OEU operation's termination.

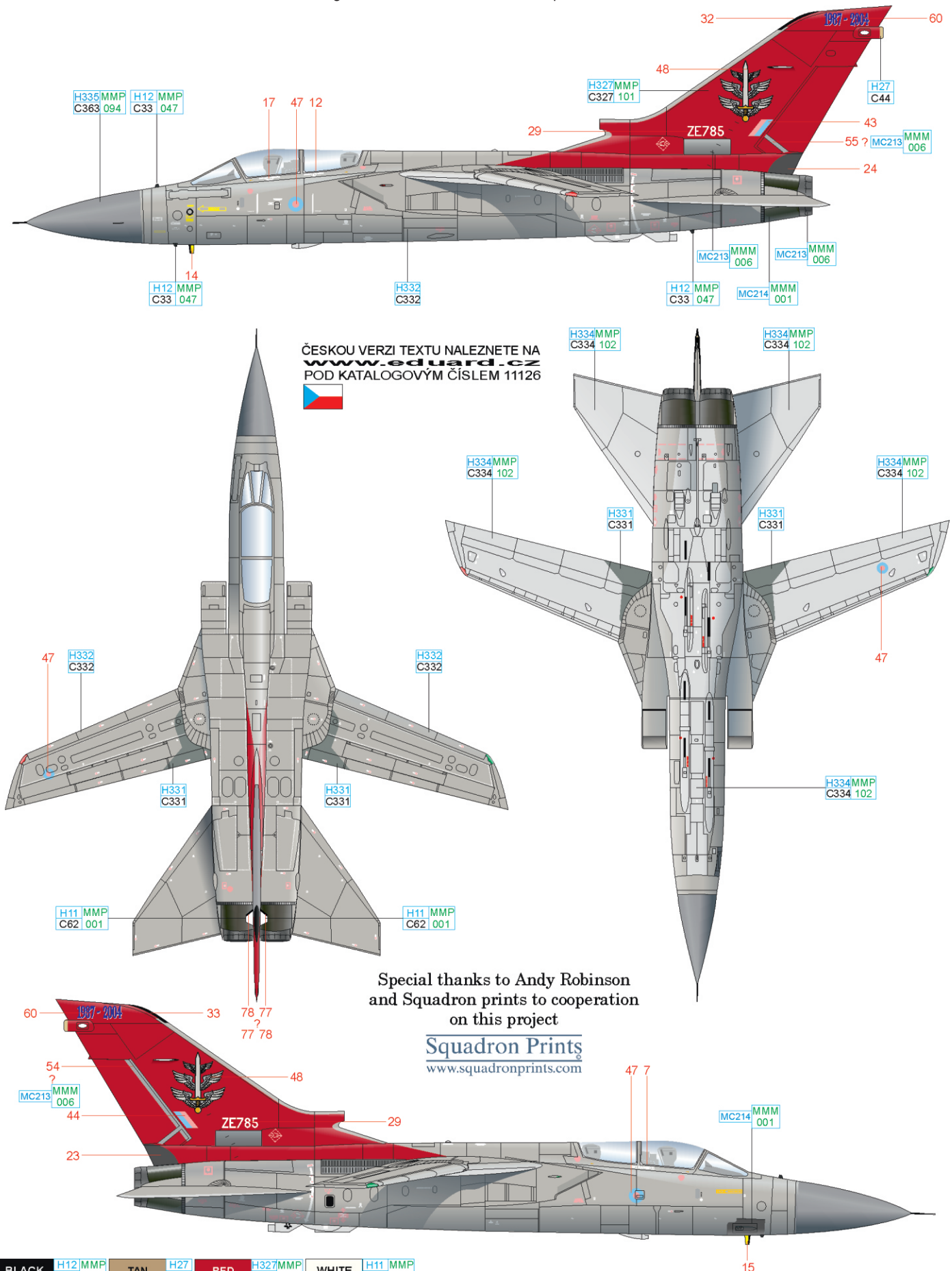

ČESKOU VERZI TEXTU NALEZNETE NA www.eduard.cz POD KATALOGOVÝM ČÍSLEM 11126



Special thanks to Andy Robinson and Squadron prints to cooperation on this project

Squadron Prints
www.squadronprints.com

BLACK	H12 MMP C33 047	TAN	H27 C44	RED	H327MMP C327 101	WHITE	H11 MMP C62 001
BARLEY GRAY	H334MMP C334 102	LIGHT AIR. GRAY	H332 C332	MEDIUM SEA GRAY	H335MMP C363 094	DARK SEA GRAY	H331 C331
						STEEL	MC213 MMM 006
							DARK IRON MC214 MMM 001

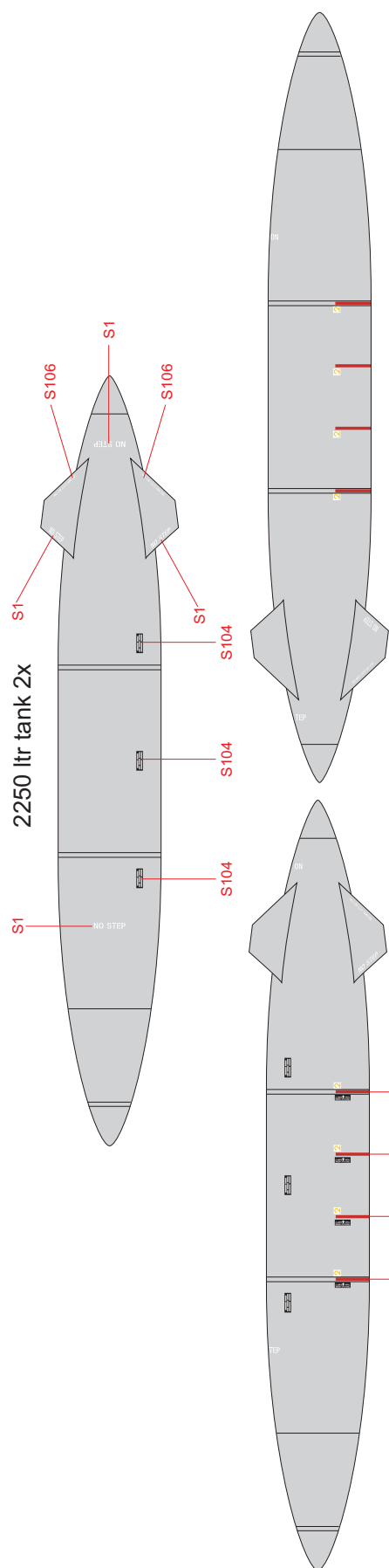

Right inboard wing pylon (outer face)

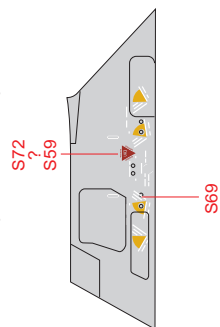

Right inboard wing pylon (inner face)

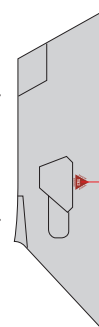

Left inboard wing pylon (outer face)

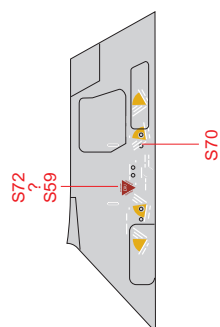

Left inboard wing pylon (inner face)

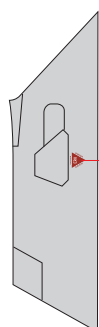

Sidewinder 4x

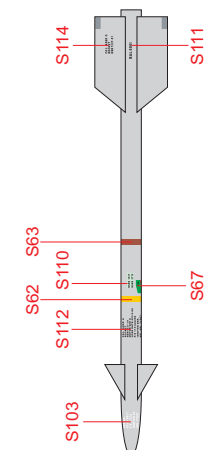

Skyflash 4x

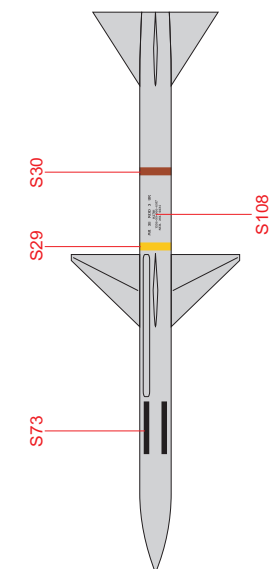

Sidewinder pylon 2+2

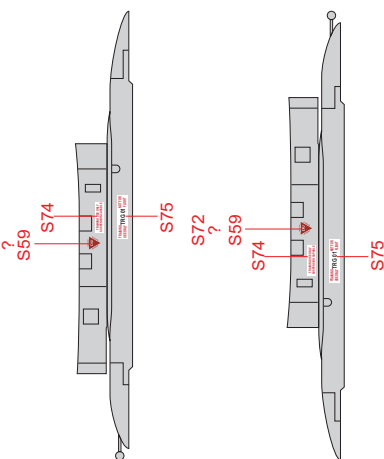

Tornado F.3 ADV

1/48

#11126

eduard
LIMITED EDITION

RELATED PRODUCTS for Tornado F.3 ADV:

- 48989 Tornado F.3 ADV upgrade set 1/48 (PE-Set)
- 49051 Remove before flight UK 1/48 (PE-Set)
- 49881 Tornado F.3 ADV undercarriage 1/48 (PE-Set)
- 648029 AIM-9M/L Sidewinder 1/48 (Brassin)
- 648084 AIM-120A/B AMRAAM (Brassin)
- EX575 Tornado F.3 ADV TFace 1/48 (Mask)

Cat. No. 49881

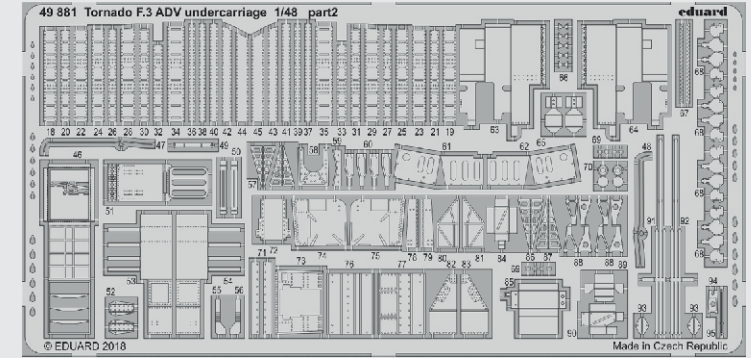
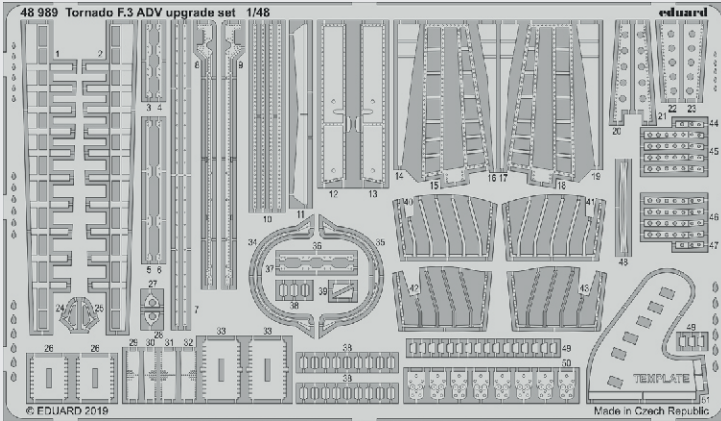
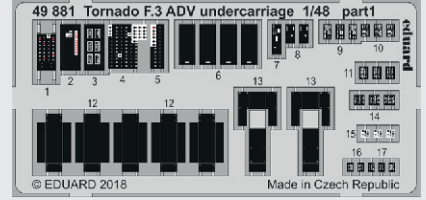

Cat. No. 49881

Cat. No. 48989

Cat. No. 648029

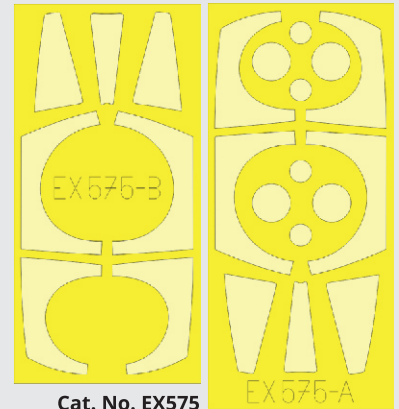
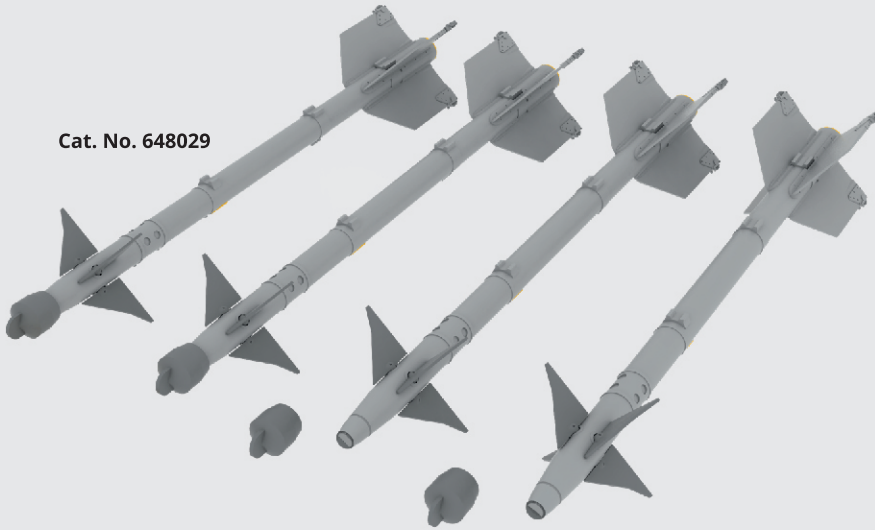

Cat. No. EX575

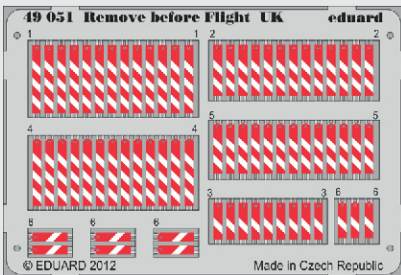

Cat. No. 49051

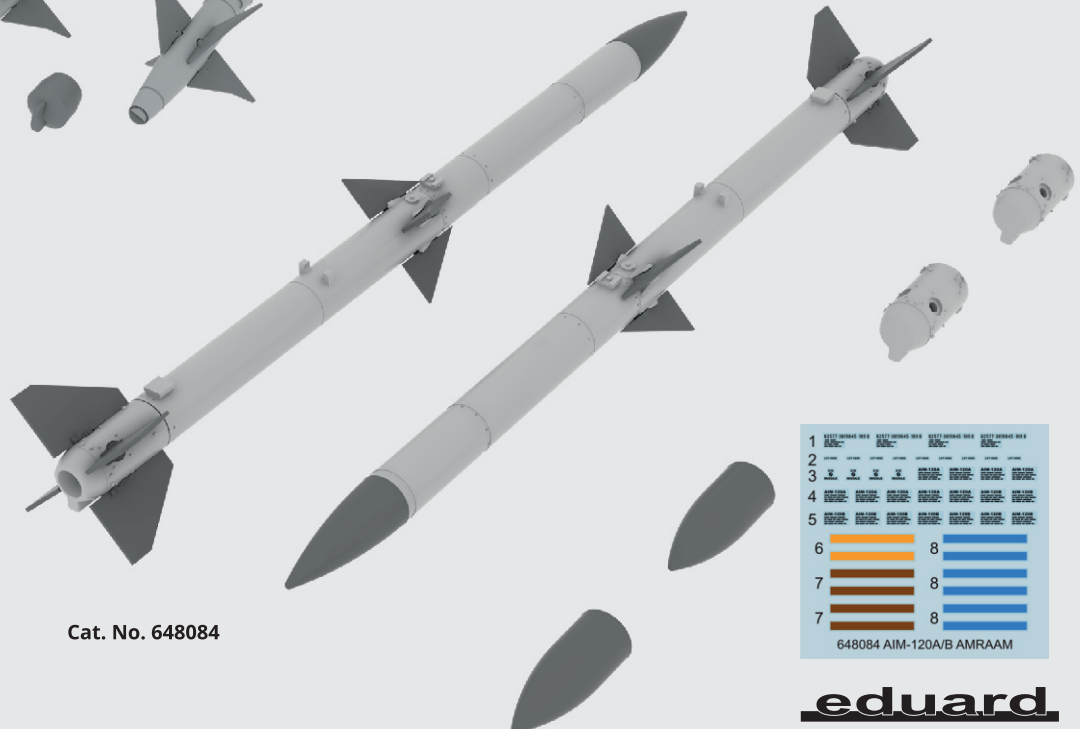

Cat. No. 648084

